



Meeting 2015 Apr 23

## COMMITTEE REPORT

**TO:** CHAIR AND MEMBERS  
FINANCE MANAGEMENT COMMITTEE

**DATE:** 2015 April 21

**FROM:** DIRECTOR PARKS, RECREATION &  
CULTURAL SERVICES

**SUBJECT:** CENTRAL PARK MEMORIAL TO DR. SUN YAT-SEN

**PURPOSE:** To update the design and obtain approval to complete a civic memorial to Dr. Sun Yat-Sen in Central Park

**RECOMMENDATIONS:**

1. **THAT** the Financial Management Committee request Council authorize the continuance of the detailed design through to complete construction of the Sun Yat-Sen Memorial, as outlined in this report.
2. **THAT** a copy of this report be advanced to the Parks, Recreation and Culture Commission for their information.
3. **THAT** a copy of this report be advanced to the International Relations & Friendship Cities Committee for their information.
4. **THAT** a copy of this report be sent to the Dr. Sun Yat-Sen Foundation for Peace and Education, c/o Mr. Kevin Shaoyi Xin.

**REPORT****1.0 INTRODUCTION**

At the request of the Financial Management Committee, Council authorized on 2014 June 26 an initial expenditure of \$40,000 from Gaming Funds for advancement of detailed design and coordination for the proposed Dr. Sun Yat-Sen Memorial in Central Park on the west side of Patterson Avenue just south of the BC Parkway and West Station House of the Patterson SkyTrain Station. The purpose of this report is to update design progress and seek the Committee's approval to construct the Dr. Sun Yat-Sen memorial as outlined in this report.

To: Finance and Civic Development Committee  
From: Director Parks, Recreation & Cultural Services  
Re: Dr. Sun Yat-Sen Memorial  
2015 April 21..... Page 2

**2.0 LOCATION**

The Sun Yat-Sen memorial location is at the crossroads of existing pedestrian travel into Central Park on existing compacted rock trails (Attachment #1). The memorial is approached from the east from Beresford Art Walk across Patterson Avenue, from the north at Patterson Skytrain Station and the BC Parkway and from the west Central Park Trail of Hope. The main feature of the memorial will include a bronze statue of Dr. Sun Yat-Sen, 230 cm (7.5 feet) in height, on a granite faced stepped concrete base, 170 cm (5.5 feet) in height. In total the memorial will stand 400cm (13 feet) tall. The granite base will include carved granite tablets with an inscription outlining the contributions of Dr. Sun Yat-Sen. Eight shade tolerant magnolias will be informally planted around the memorial to coincide with the time of the year that Sun Yat-Sen visited Burnaby in 1911.

**3.0 FUNDING**

Council authorized an initial expenditure of Gaming Funds in the amount of \$40,000 for preliminary design and survey work of the Sun Vat-Sen Memorial. The Foundation proposes to fund in kind \$20,000 for the supply and installation of the statue, concrete and granite podium including all inscription and plaque work as well as contribute \$20,000 to fund the remainder of costs associated with the project. These expenditures are included in the 2015-2019 Provisional Financial Plan. Project completion is anticipated at the end of summer 2015.

Details of the dedication ceremony and any items of protocol that arise from this project will be forwarded to Council through the International Relations & Friendship Cities Committee, as they become available.



Dave Ellenwood  
DIRECTOR PARKS, RECREATION & CULTURAL SERVICES

DE:mg

Attachment

P:\Admin\Clerical\Staff\Mindi Girm\Craig Collis\Commission\FMC report Sun Yat-Sen.docx

Copied to: City Manager

DR SUN YAT-SEN MEMORIAL

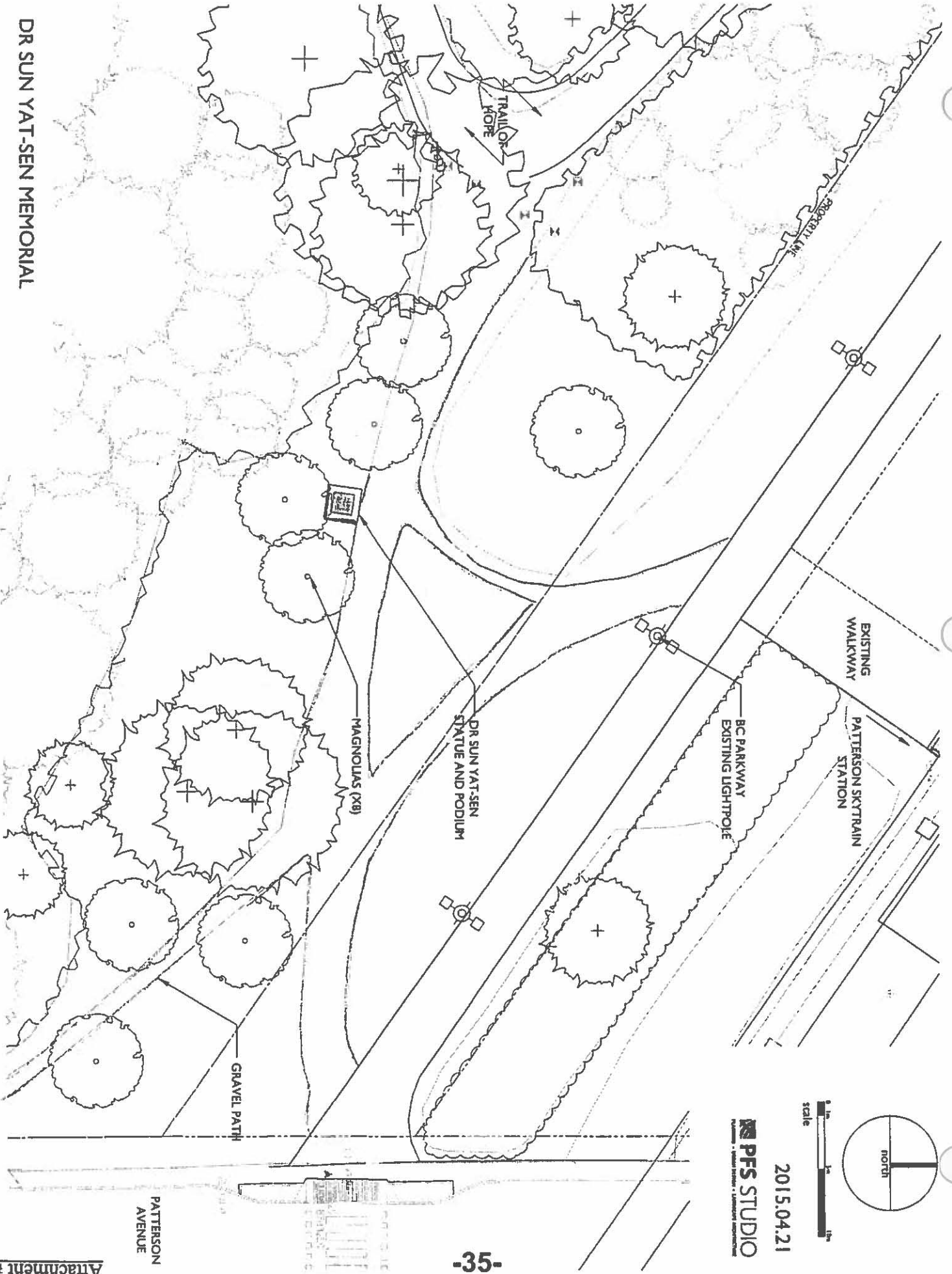

**PFS STUDIO**  
 2015.04.21