

TRAFFIC SAFETY COMMITTEE

*HIS WORSHIP, THE MAYOR
AND COUNCILLORS*

SUBJECT: 2015 LOCAL AREA SERVICE PROGRAM FOR SPEED HUMPS

RECOMMENDATIONS:

- 1. THAT Council advance the requested speed humps, as discussed and recommended in this report, to the 2015 LASP process.
- 2. THAT a copy of this report be sent to the residents who requested speed humps as part of the 2015 LASP.

REPORT

The Traffic Safety Committee, at its meeting held on 2014 December 02, received and adopted the *attached* report to review applications for the 2015 speed hump program and recommend streets that should proceed to the Local Area Service Program (LASP) process.

Respectfully submitted,

Councillor S. Dhaliwal
Chair

Councillor A. Kang
Vice Chair

Councillor P. Calendino
Member

Copied to:	City Manager Director Engineering
------------	--------------------------------------

TO: CHAIR AND MEMBERS
TRAFFIC SAFETY COMMITTEE

DATE: 2014 November 10

FROM: DIRECTOR ENGINEERING

FILE: 34500 01

SUBJECT: 2015 LOCAL AREA SERVICE PROGRAM FOR SPEED HUMPS

PURPOSE: To review applications for the 2015 speed hump program and recommend streets that should proceed to the Local Area Service Program (LASP) process.

RECOMMENDATIONS:

1. **THAT** The Committee recommend that Council advance the requested speed humps, as discussed and recommended in this report, to the 2015 LASP process.
2. **THAT** The Committee recommend that Council send a copy of this report to the residents who requested speed humps as part of the 2015 LASP.

REPORT**1.0 BACKGROUND**

The Traffic Safety Committee annually reviews all requests for speed humps for inclusion in the current year's Local Area Service Program (LASP). Over the course of 2014 City staff has responded to numerous inquiries from residents about the process for installing speed humps along their street. Of those, a total of 4 residents have expressed a desire to initiate the LASP process for installing speed humps this year.

2.0 REVIEW OF REQUESTS

A review of the 4 applications for the 2015 Speed Hump LASP was completed and all were found to meet the general guidelines of the program (local residential road, less than 8% grade, and requested by a registered property owner). Brief descriptions of the applications are provided below.

As part of the review, the Fire Department was consulted to ensure that the proposed speed humps would not adversely affect their emergency response time significantly. It should be noted that speed humps are only installed on local streets to limit the cumulative impact of speed humps on emergency response times. Local collectors and other higher order streets are not eligible for speed hump installations.

To: Traffic Safety Committee
From: Director Engineering
Re: 2015 LOCAL AREA SERVICE PROGRAM FOR
SPEED HUMPS

..... Page 2

The Fire Department and Coast Mountain Bus Company have no objection to the program proposed.

2.1 8200 block Burnlake Dr (Exhibit 1)

The 8200 block of Burnlake Dr between Government Rd & Woodlake Ct is fronted by single family homes and is constructed to an 8m wide finished standard with concrete curb and gutter. As several other streets are accessed off of Burnlake Dr at either Government Rd or Piper Ave, a wider consultation area is recommended to capture all residents potentially impacted.

It is recommended that the requested LASP for speed humps proceed.

2.2 100 & 200 blocks Carleton Ave (Exhibit 2)

The 100 & 200 blocks of Carleton Ave are constructed to an 8.5m wide finished standard with concrete curb and gutter; both are fronted by single family homes as well as a multiple dwelling on the 200 block of Carleton.

The installation of speed humps in the Burnaby Heights area will help address the ongoing traffic concerns of some residents in the neighbourhood. It is recommended that the requested LASP for speed humps proceed.

2.3 4000 block Irmin St (Exhibit 3)

The 4000 block of Irmin St between Patterson & Roseberry is fronted by single family homes on the south side and Ocean View Memorial Park on the north side. The road is constructed to an interim standard with 6m wide pavement and gravel shoulders. Installation of humps on this street may require the installation of concrete bull noses at the ends of the humps to prevent vehicles from driving around them.

It is recommended that the requested LASP for speed humps proceed.

2.4 7500 & 7600 block Kilrea Cr (Exhibit 4)

The 7500 & 7600 block of Kilrea Cr between Lawrence Dr & Kilrea Cr is fronted by single family homes and is constructed to an 8.5 m wide finished standard with concrete curb & gutter. A wider consultation area to include residents on Kilrea Place is recommended due to potential impacts.

It is recommended that the requested LASP for speed humps proceed.

To: *Traffic Safety Committee*
From: *Director Engineering*
Re: *2015 LOCAL AREA SERVICE PROGRAM FOR
SPEED HUMPS*

..... Page 3

3.0 RECOMMENDATION

Staff recommend that all of the above requested LASP for speed humps proceed as outlined in this report.



Leon A. Gous, P. Eng. MBA
DIRECTOR ENGINEERING

SP/ac

Enclosure

Copied to: City Manager

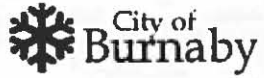

BURNLAKE DR (GOVERNMENT - WOODLAKE CT)

EXHIBIT 1

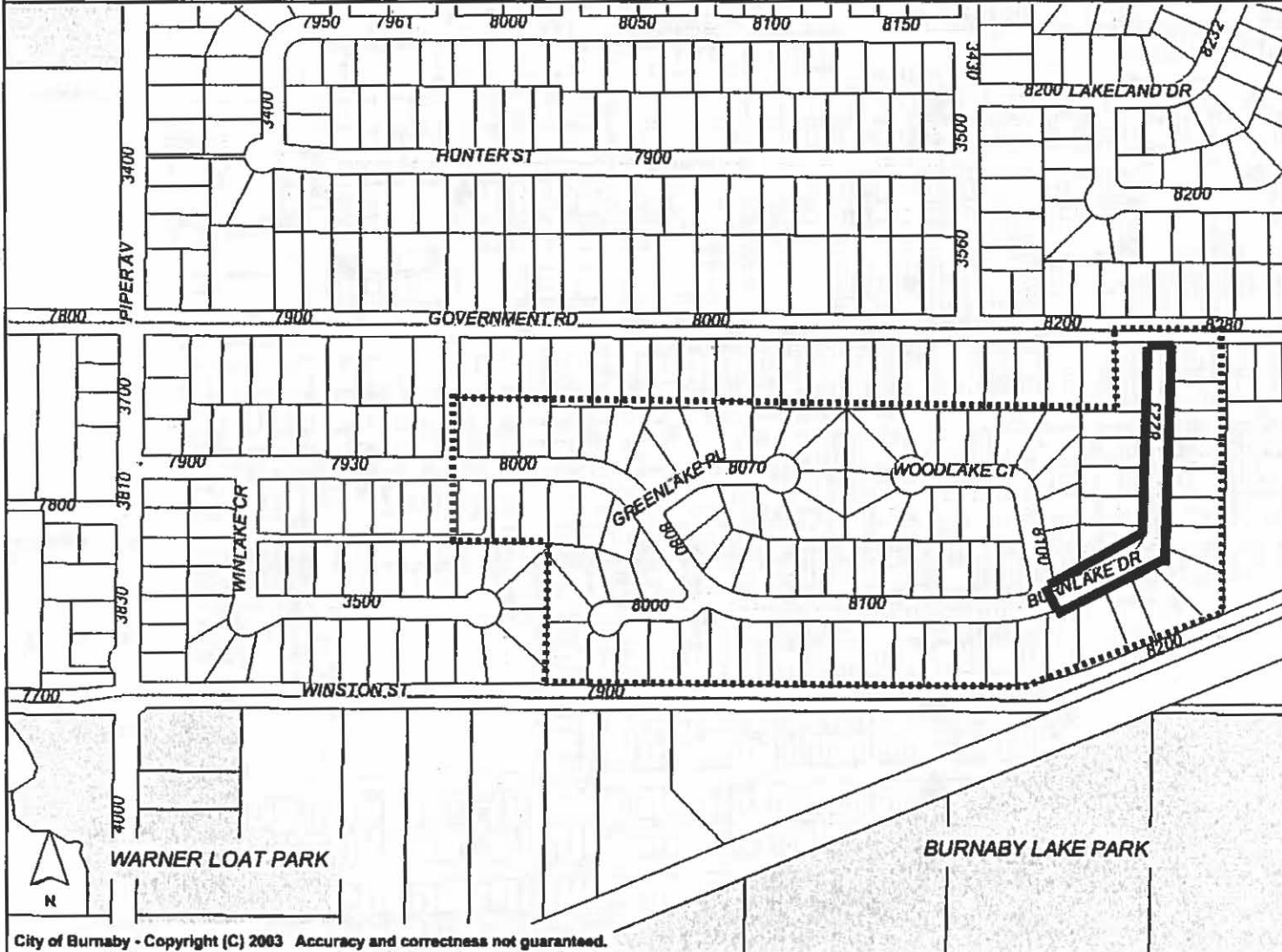

- Strata Units
- ⊙ Skytrain Stations
- Skytrain Lines
- Ⓐ Air Space
- Lot
- Right of Way
- Street Intersections
- Ⓜ Traffic Signal
- Ⓜ Speed Humps
- Ⓜ Speed Humps
- Hundred Blocks
- Roads
- Private
- Residential
- Collector
- Arterial
- Freeway
- Hydrology
- Parks
- Ⓜ Parkland To Be Acquired (cont)
- Parkland
- Boundary

City of Burnaby - Copyright (C) 2003 Accuracy and correctness not guaranteed.

This information has been gathered and assembled on the City of Burnaby's computer systems. Data provided herein is derived from a number of sources with varying levels of accuracy. The City of Burnaby disclaims all responsibility for the accuracy or completeness of information contained herein.



Consultation Area
Proposed location of Speed Humps

Map Scale
1 : 5000





CARLETON (ALBERT-TRIUMPH)

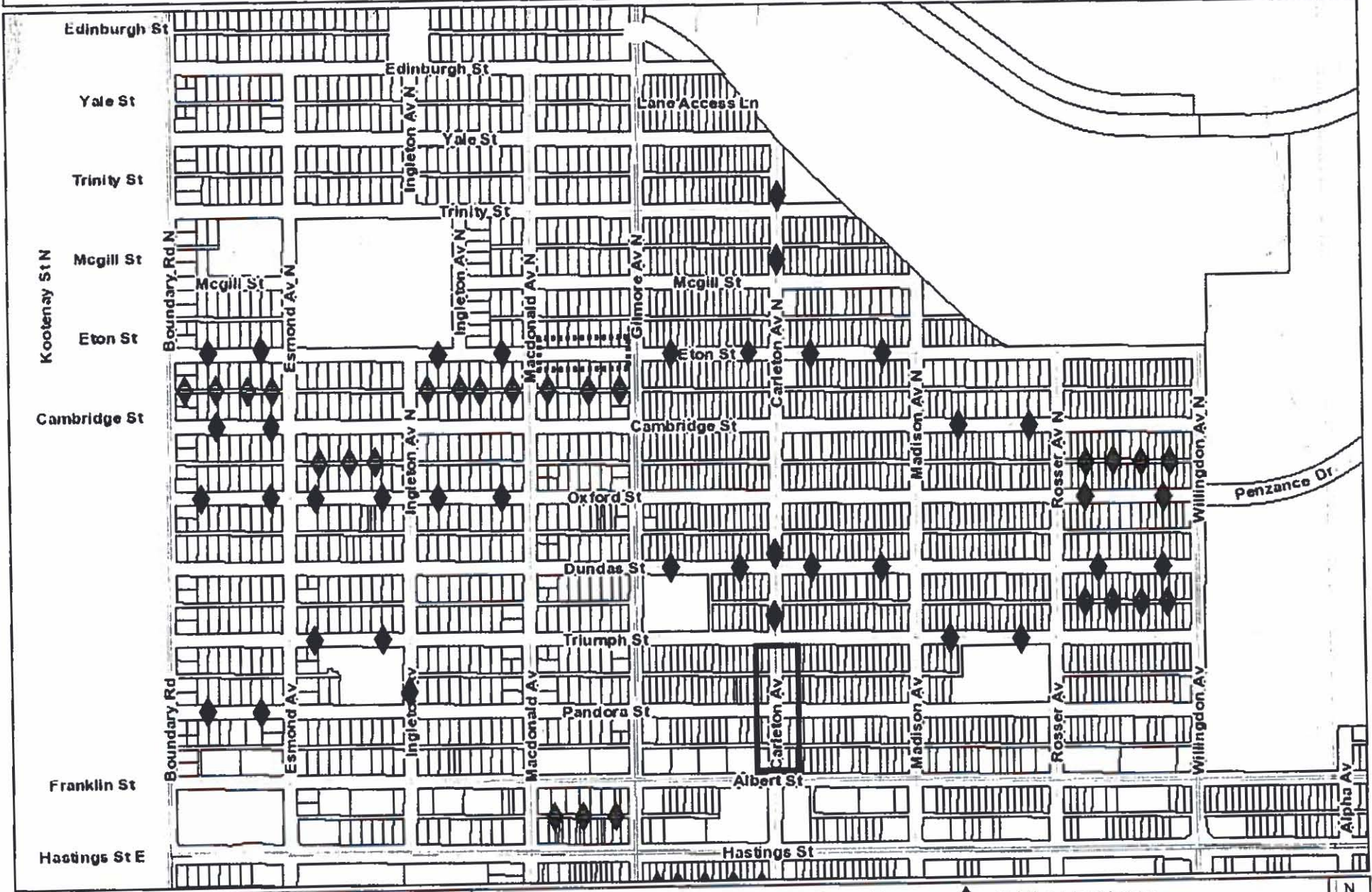

EXHIBIT 2

1.7.365



The information has been gathered and assembled on the City of Burnaby's computer systems. Data provided herein is derived from a number of sources with varying levels of accuracy. The City of Burnaby disclaims all responsibility for the accuracy or completeness of information contained herein.

 Proposed location of 2015 LASP speed humps
 2014 LASP speed humps

 Existing speed humps
 Existing rear lane speed humps



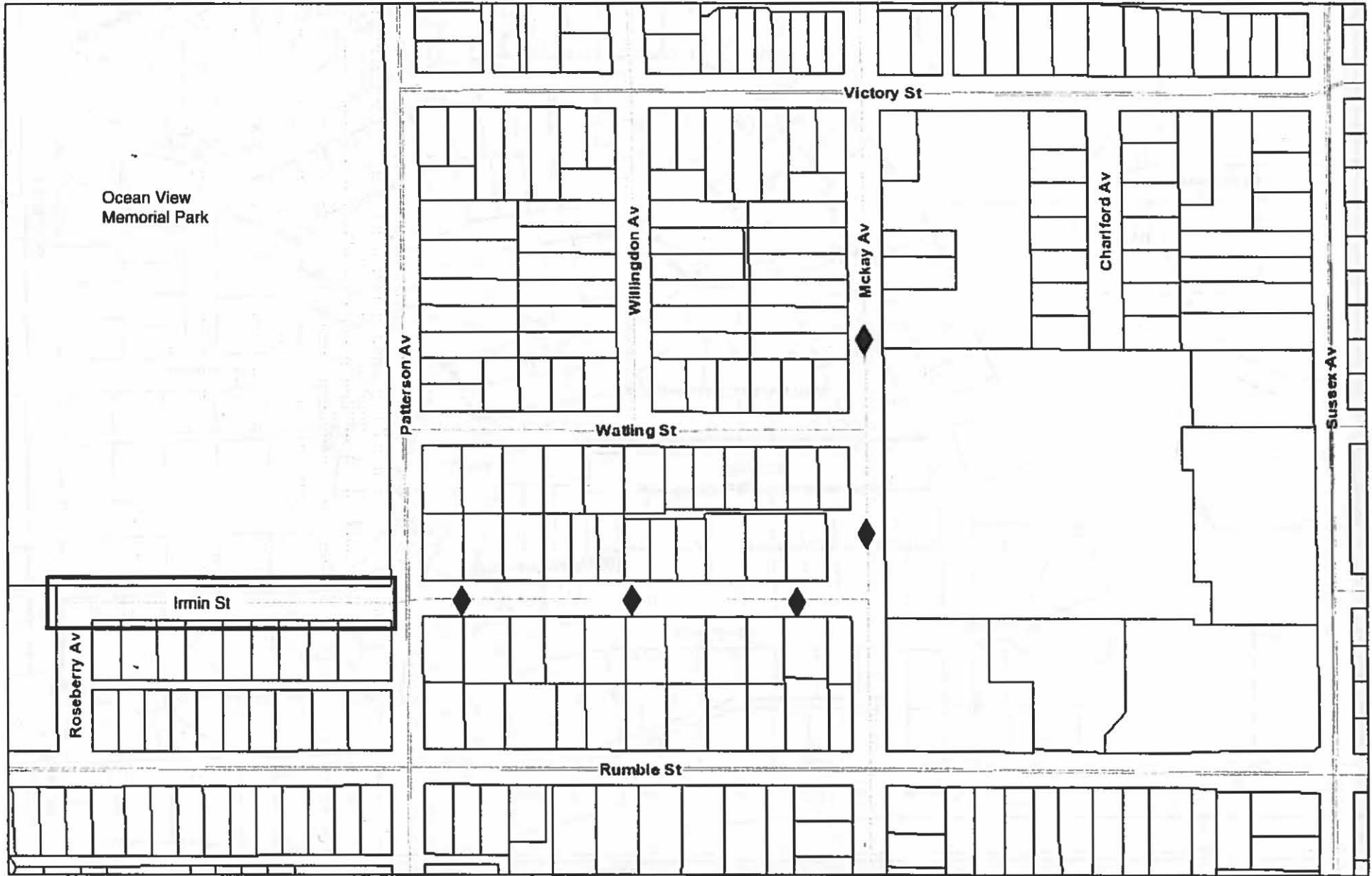

The information has been gathered and assembled on the City of Burnaby's computer systems. Data provided herein is derived from a number of sources with varying levels of accuracy. The City of Burnaby disclaims all responsibility for the accuracy or completeness of information contained herein.



Existing Speed Humps



Proposed speed hump location

N





KILREA CR (LAWRENCE DR - KILREA CR)

EXHIBIT 4

1:3,028



The information has been gathered and assembled on the City of Burnaby's computer systems. Data provided herein is derived from a number of sources with varying levels of accuracy. The City of Burnaby disclaims all responsibility for the accuracy or completeness of information contained herein.



Proposed speed hump location

Consultation Area

