

---

**TO:** CITY MANAGER **DATE:** 2014 February 12

**FROM:** DIRECTOR PLANNING AND BUILDING **FILE:** 87000 05  
*Reference:* **ROD #13-3**

**SUBJECT: ROAD CLOSURE REFERENCE #13-03**  
**X-REFERENCE: SUBDIVISION #13-14**  
**Proposed Closure of a 6.1 m Lane Adjacent 7422 Government Road**

**PURPOSE:** To obtain Council authority to introduce a Burnaby Highway Closure Bylaw for the closure, sale and consolidation of the adjacent unconstructed lane with 7422 Government Road

---

#### RECOMMENDATIONS:

1. **THAT** Council authorize the introduction of a Burnaby Highway Closure Bylaw for consolidation of the 6.1 m by 51.98 m (317.0 m<sup>2</sup>) unconstructed lane allowance with 7422 Government Road, as shown on the *attached* Sketch #1, subject to the conditions outlined in this Report.
2. **THAT** a copy of this report be sent to Mr. Pablo Su, 7422 Government Road, Burnaby, BC V5A 2C6.

#### REPORT

##### 1.0 INTRODUCTION

On 2013 March 26, a subdivision application was received for the closure and consolidation of a 6.1 m by 51.98 m (317.0 m<sup>2</sup>) lane adjacent 7422 Government Road from Mr. Pablo Su, owner of 7422 Government Road (see *attached* Sketch #1). The lane allowance is unconstructed and is considered to be redundant for City purposes. A 3.0 m wide statutory right-of-way along the western portion of the existing lane allowance is to be granted to the City to provide City access to an existing sewer right-of-way located to the south. The subject closure of an area of 317.0 m<sup>2</sup> will contribute 86.3 m<sup>2</sup> of additional permitted gross floor area potential and additional garden area for single family development of 7422 Government Road. The Legal and Lands Department has determined a market value of \$94,000.00 for the 317.0 m<sup>2</sup> closure area. The applicant has agreed to purchase the proposed road closure area at the established market value. The Planning and Building Department has provided a letter to the applicant stating that the sale of the lane closure area would be contingent upon Council approval and completion of the required conditions of the related subdivision and road closure applications.

To: City Manager  
From: Director Planning and Building  
Re: Road Closure Reference #13-03; 7422 Government Road  
2014 February 12..... Page 2

The Planning Department has received the written concurrence to the conditions of the subdivision, lane closure and land sale from the applicant.

On 2013 September 30, Council received a report for the subject Road Closure requesting authorization to introduce a Burnaby Highway Closure Bylaw for closure and consolidation of the lane allowance. The report was tabled and referred to the Community Development Committee.

In response to a request of the Community Development Committee on 2013 October 29, staff provided Council with a summary of City's policies and processes regarding consolidation of lane allowances. On this basis, this report re-introduces the subject road closure application for Council's consideration.

It is recommended that Council authorize the introduction of a Burnaby Highway Closure Bylaw to provide for the closure and consolidation of the subject redundant lane, as indicated on Sketch #1. Council authorization for the sale of the closure area, as indicated in this report, is also sought. With subsequent Council adoption of the bylaw, the subject lane area would be closed, sold and consolidated with the subject property as part of the completion of the applicable subdivision and road closure applications.



Lou Pelletier, Director  
PLANNING AND BUILDING

DI:hr

**Attachment**

cc: Director Engineering  
City Solicitor  
Deputy City Clerk

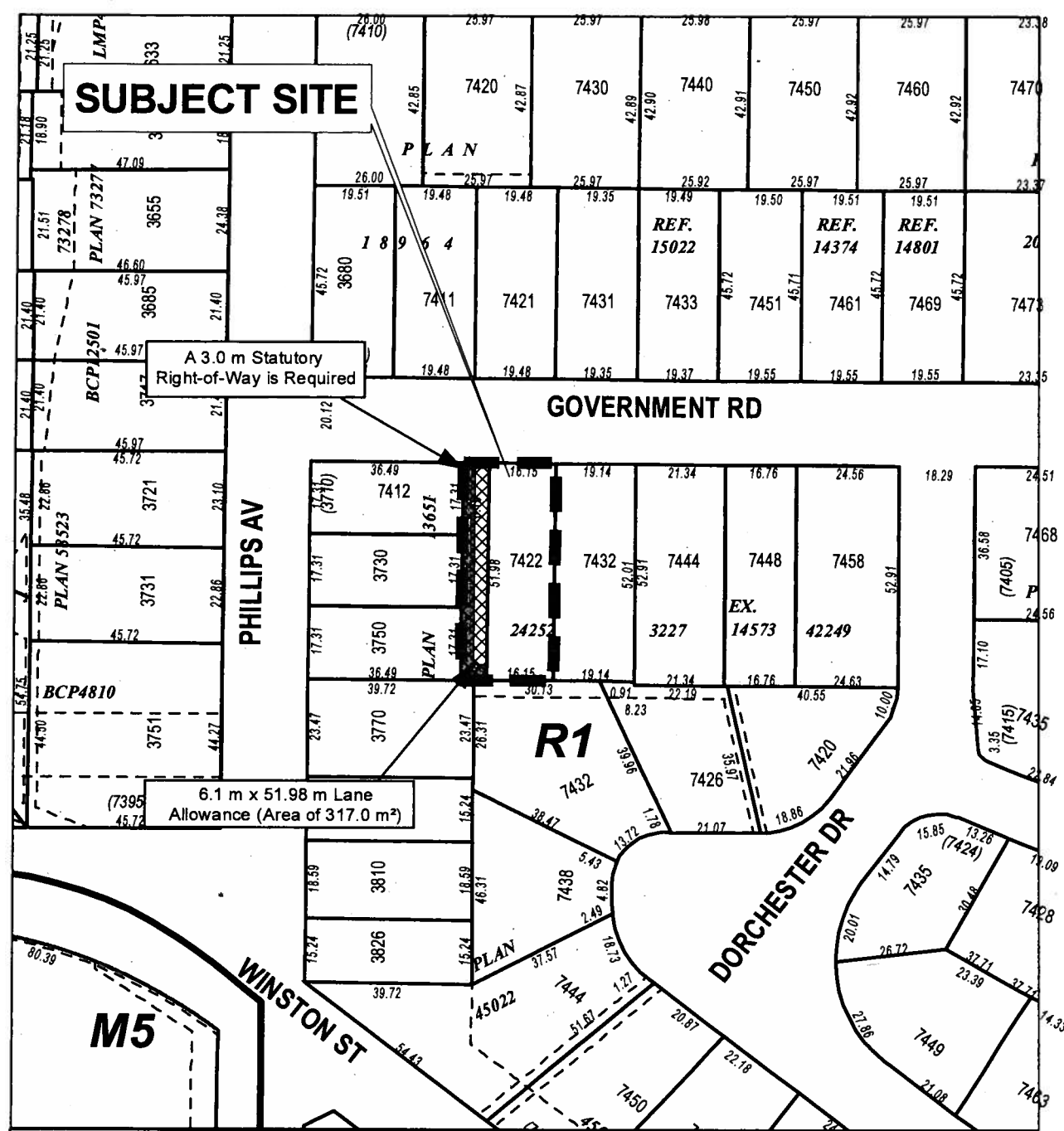

**SUBJECT SITE**

A 3.0 m Statutory Right-of-Way is Required

6.1 m x 51.98 m Lane Allowance (Area of 317.0 m<sup>2</sup>)



PLANNING & BUILDING DEPARTMENT



DATE:  
SEP 18 2013

SCALE:  
1:1,500

DRAWN BY:  
AY

**ROAD CLOSURE #13 - 3**  
**SUBDIVISION REFERENCE #13 - 14**  
**7422 GOVERNMENT ROAD AND ADJACENT LANE ALLOWANCE**

Subject Site    Proposed Road Closure    Right-of-Way

Sketch #1