

TO: CITY MANAGER **DATE:** 2013 June 18
FROM: ACTING DIRECTOR ENGINEERING **FILE:** 31000 12
SUBJECT: WILLINGDON PUMP STATION
**PROPOSED CHANGE TO PUMP STATION SERVICE AREA AND
 REGIONAL SANITARY SEWERAGE AREA BOUNDARY**

PURPOSE: To seek Council approval for a proposed amendment to Regional Sewer area boundaries, and proceed with a formal request to Metro Vancouver to approve the amendment.

RECOMMENDATION:

- 1. THAT** Council approve the proposed amendment of the Regional Sewer area boundaries as detailed in this report.

REPORT

Staff have recently completed a sanitary servicing strategy review for the Central Valley area of Burnaby including requirements for upgrading or replacing related pump stations. The servicing review was conducted to determine future works required to support growth in and around the area and to integrate these future works into capital renewal and rehabilitation plans.

The review identified that improvements would be required to the infrastructure in two sewer catchment areas to support the growth proposed in the Official Community Plan. Both the Willingdon Pump Station catchment area and the Beta Pump station catchment areas (Figure 1) would require improvements to pump stations and related sewer mains.

Figure 1. Willingdon and Beta Catchment Areas

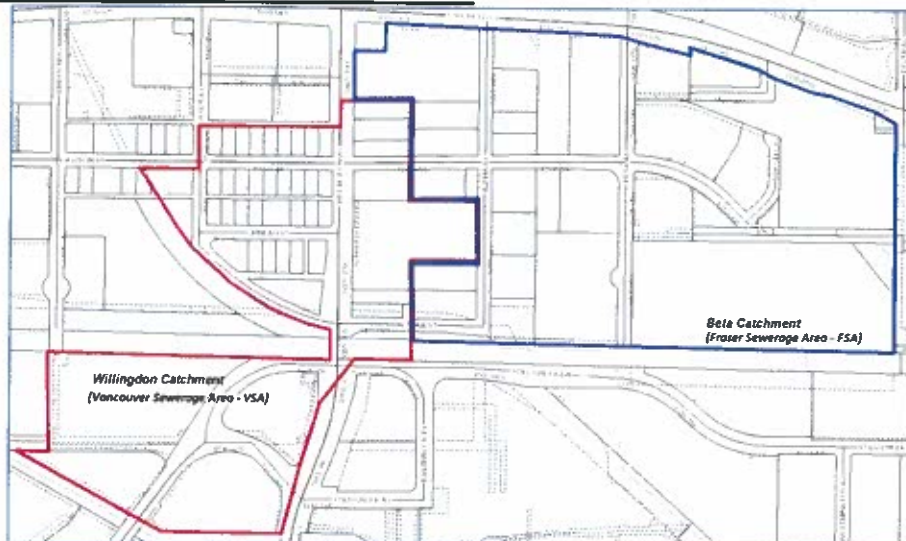

To: City Manager
From: Acting Director Engineering
Re: WILLINGDON PUMP STATION
PROPOSED CHANGE TO PUMP STATION SERVICE
AREA AND REGIONAL SANITARY SEWERAGE AREA
BOUNDARY

2013 June 19.....Page 2

The Beta Pump Station, located to the east of the Willingdon Pump Station catchment, will require upgrading within the next few years. Staff have identified an opportunity to implement a strategic diversion of a portion of the Willingdon Pump Station catchment to the Beta Pump Station catchment (Figure 2). This proposed diversion would eliminate the requirement to upgrade the Willingdon Pump Station for capacity purposes, as well as related sewer infrastructure. The Willingdon Pump Station catchment area is contained within the Vancouver Sewerage Area while the Beta Pumpstation catchment area is contained within the Fraser Sewer Area. This diversion of the catchment will require an amendment to the regional boundary and, consequently, approval from Metro Vancouver is required.

Figure 2. Proposed Diversion Area

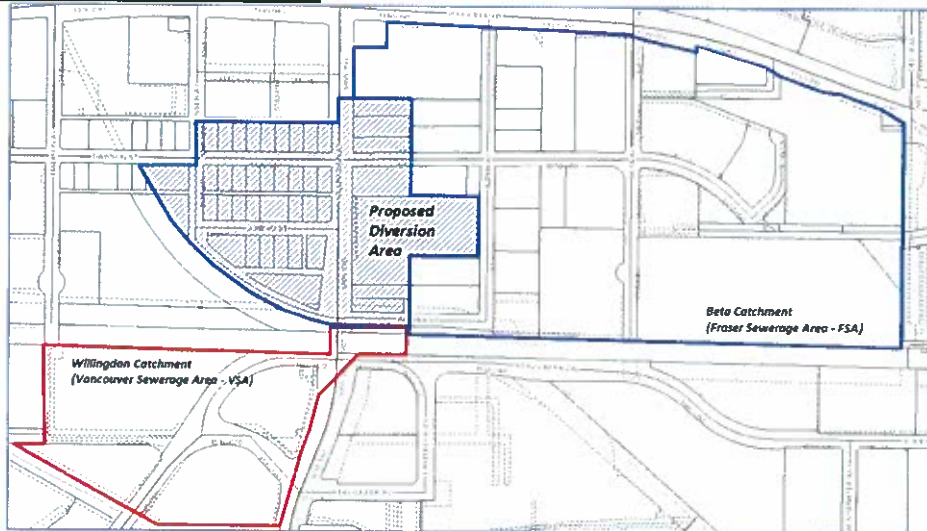

City staff have reviewed the proposed sewer area boundary change with Metro Vancouver staff and they are in general support of the proposal. Metro Vancouver requires Council approval of the recommended change in sewer area prior to preparing a formal report to the Metro Vancouver board to approve the change. Staff are recommending that Council approve this change in the servicing approach for the Willingdon and Beta sewer catchments. With Council approval, staff will prepare a formal request to Metro Vancouver for the adjustment to the regional sewerage area boundary.

B.C. Davis, P. Eng.
Acting Director Engineering

SSH/br

Copied to: Director Planning and Building