TO: CITY MANAGER **DATE:** 2006 January 06
FROM: DIRECTOR ENGINEERING **FILE:** Buckingham Dr
SUBJECT: VOLUME OF FILL, SLIDING DIRT AND ROCK ONTO PROPERTY AT
6216 BUCKINGHAM DR
PURPOSE: To provide Council information on the concerns raised by Mr. Campeotto, who
appeared as a delegation to the Open Council Meeting on 2005 November 28.

RECOMMENDATION:

1. **THAT** copies of this report be sent to:
 - a. Mr. & Mrs. Campeotto, 6216 Buckingham Dr
 - b. Mr. Simonyi-Gindele, 6236 Buckingham Dr

REPORT

Council at its meeting of 2005 November 28 received a delegation from Mr. & Mrs. Campeotto, 6216 Buckingham Dr who expressed concern that fill material deposited on the neighbouring property at 6236 Buckingham Dr had sloughed onto their property.

6216 and 6236 Buckingham Dr are two adjacent single family residential properties developed with existing houses. It should be noted that the home at 6236 Buckingham straddles two residential lots (see attached sketch).

Mr. Campeotto expressed concern when material placed on 6236 Buckingham Dr appeared to encroach onto his property and also resulted in a rock rolling onto Mr. Campeotto's landscaped slope. Staff have met with both Mr. Campeotto and his neighbour Mr. Simonyi-Gindele. The fill material deposited constituted, in part, material imported from off-site and, in part, material relocated from the rear of the property where some foundation and drainage repair work was taking place. In general the fill material relocation is part of a pre-grading exercise in preparation for a new landscape design and to add a possible second driveway to the (double) lot. Mr. Simonyi-Gindele has made restitution by pulling the material away from the property line and re-sloping the bank so that any future sloughing of material does not encroach over the property line.

To: City Manager
From: Director Engineering
Re: Volume of Fill, Sliding Dirt and Rock onto Property
at 6216 Buckingham Dr
2006 January 06..... Page 2

To assist in mitigating any further concerns, staff advised Mr. Simonyi-Gindele that a fill permit should be applied for before any further fill was brought onto site. Staff will continue to monitor the situation to ensure that any future operations are in accordance with City requirements. It is anticipated that regrading and landscaping of 6236 Buckingham Dr should proceed over the next year which should provide a permanent resolution to Mr. Campeotto's concern.

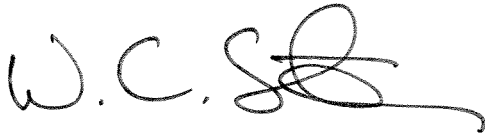

W.C. Sinclair, P. Eng.
DIRECTOR ENGINEERING

WCS:jb
Attachment

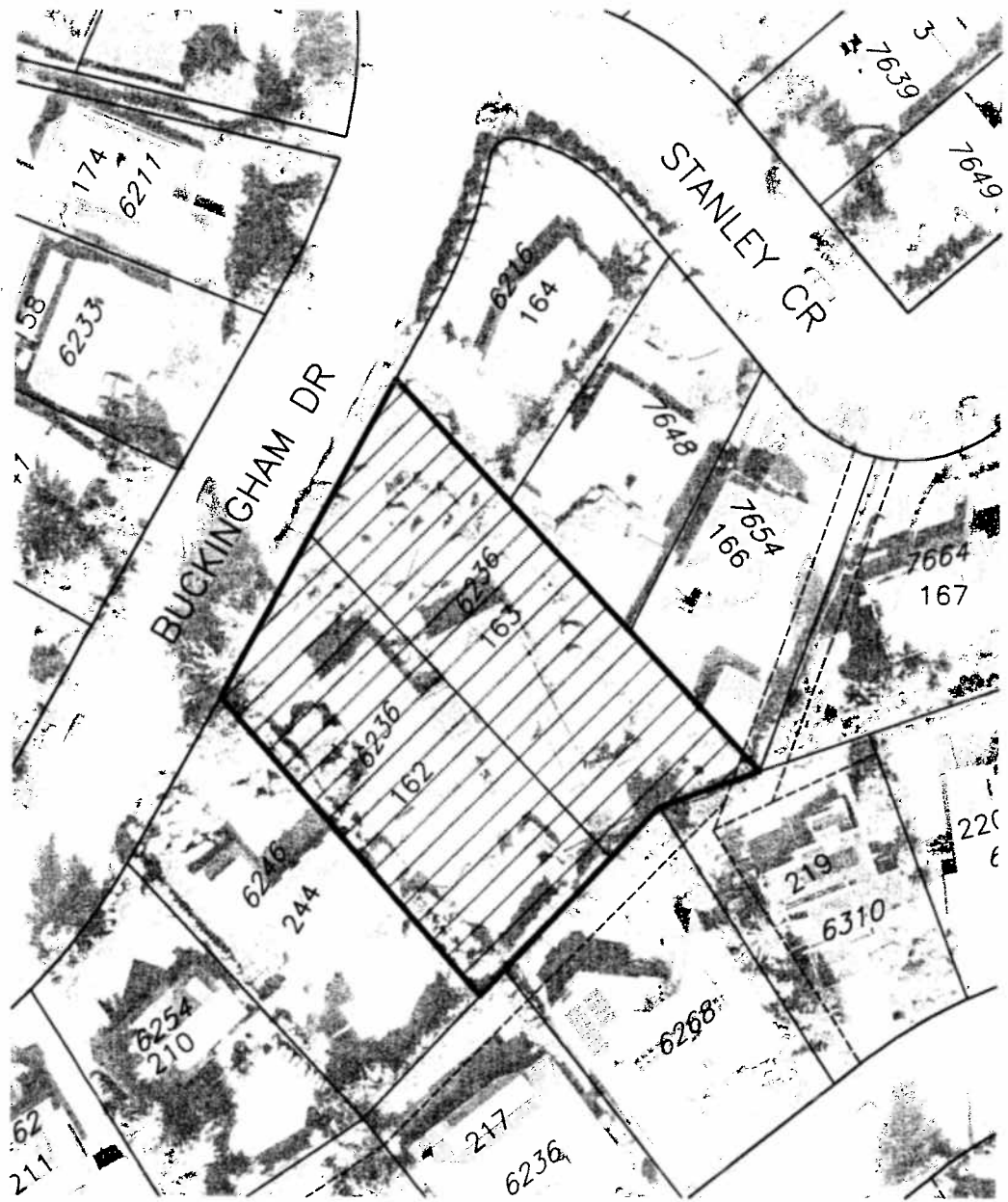
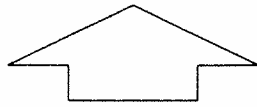

NO.	DATE	REVISION



SUBJECT PROPERTY
6236 BUCKINGHAM DR

DRAWN BY: HLOUIE	SCALE: N.T.S.	A 612
APPRV'D BY:	DATE: 2006-01-09	

