TO: CITY MANAGER **DATE:** 2006 May 10

FROM: DIRECTOR PLANNING AND BUILDING **FILE:** 46000.20
Reference *LLA #06-01*

SUBJECT: LIQUOR LICENCE APPLICATION #06-01
PROPOSED PATRON PARTICIPATION ENTERTAINMENT IN FOOD
PRIMARY ESTABLISHMENT
ROMANOFF'S RESTAURANT
2830 BAINBRIDGE AVENUE (SEE ATTACHED SKETCH)

PURPOSE: To provide Council with recommendations on the subject liquor licence application.

RECOMMENDATIONS:

1. **THAT** Council resolve to support this application for patron participation entertainment within the subject restaurant subject to the restriction that both patron participation entertainment and the serving of liquor end at midnight.
2. **THAT** a copy of this report be forwarded to the General Manager, Liquor Control and Licensing Branch (LCLB), P.O. Box 9292, Stn. Provincial Government, Victoria, BC V8W 9J8 and to the applicant, Rick Erdman, H.O.S.T. Consulting Ltd., 2975 Ash Street, Abbotsford, BC V2S 4G5.

REPORT

On 2006 April 10 Council adopted the recommendation in a submitted report seeking approval to advance a request for proposed patron participation entertainment in a food primary restaurant, Romanoff's Restaurant, 2830 Bainbridge Avenue (see attached sketch), to the necessary public input process. Council adopted the recommendation subject to an amendment to permit patron participation to midnight but not to extend the serving of liquor from midnight to 1 am.

The necessary sign was posted on the site from 2006 April 12 to 2006 April 26. Neither the City nor the applicant received any comments on the proposal that Romanoff's Restaurant wishes to provide patron participation entertainment (music and dancing) from 7:00 pm to 12:00 midnight, 7 days per week.

To: City Manager
From: Director Planning and Building
Re: LIQUOR LICENCE APPLICATION #06-01
Proposed Patron Participation Entertainment in
Food Primary Establishment
Romanoff's Restaurant
2830 Bainbridge Avenue (see attached sketch)
2006 May10..... Page 2

Given the lack of comment from the community, it is recommended that this liquor licence application be approved subject to the restriction that both patron participation entertainment and the serving of liquor end at midnight.



J.S. Belhouse
DIRECTOR PLANNING AND BUILDING

FA:gk
Attach

cc: City Clerk
RCMP, Burnaby Detachment
Environmental Services, Engineering Department

P:\Barry\Liquor Licence\LLA #06-01 Romanoff - First Report.doc

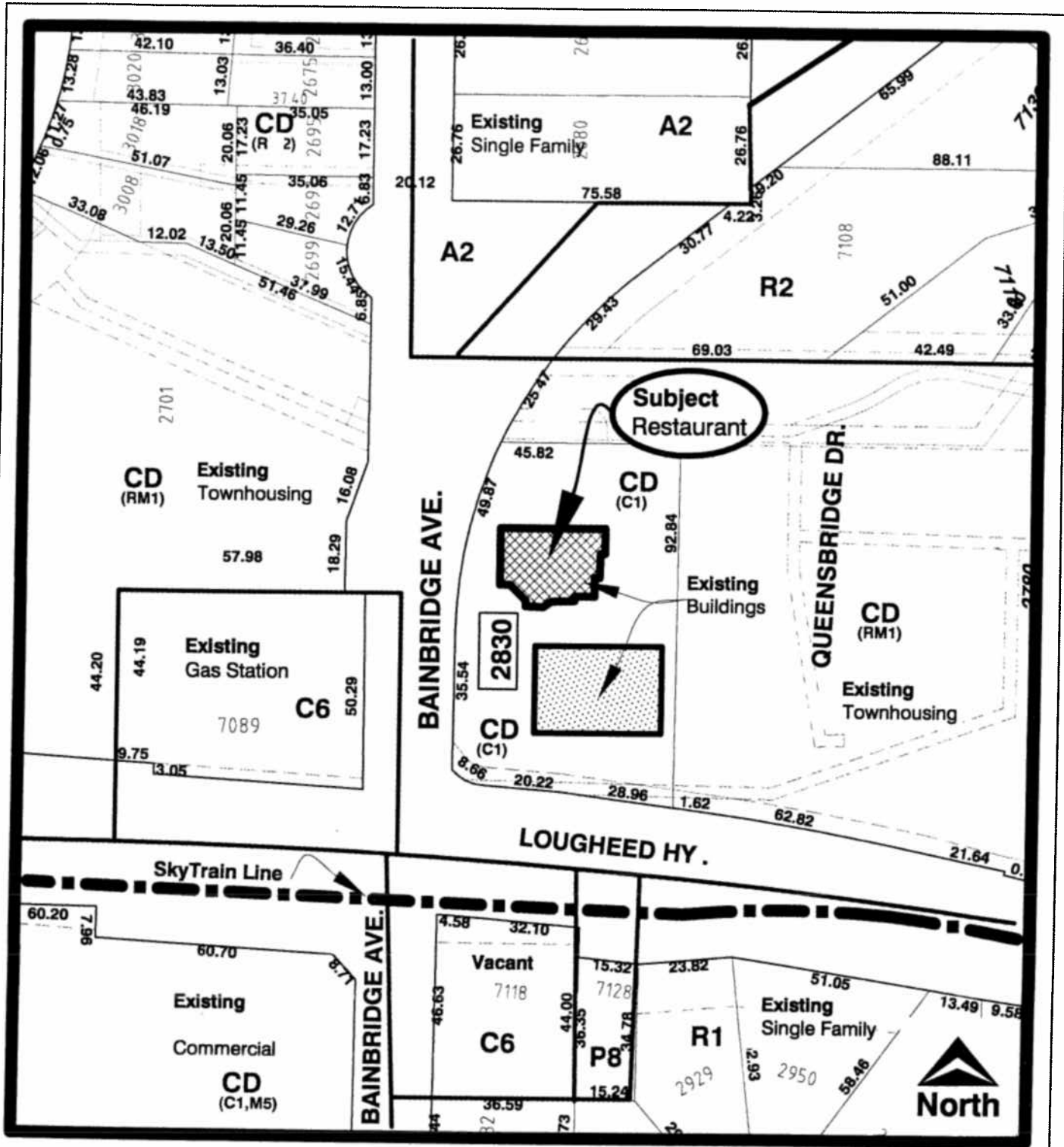

Planning and Building Department

Scale: 1 = 1500

Drawn By: J.P.C.

Date: March 2006

Liquor Licence Application # 06 --1
2830 Bainbridge Ave.

Sketch # 1

