

CITY OF BURNABY

TRAFFIC SAFETY COMMITTEE

E

*HIS WORSHIP, THE MAYOR
AND COUNCILLORS*

SUBJECT: 2003 LIP SPEED HUMP PROGRAM

RECOMMENDATIONS:

1. **THAT** Council approve the requests for speed humps as discussed in this report and summarized in Table 1 be advanced through the year 2003 LIP Program.
2. **THAT** a copy of this report be sent to the residents who requested inclusion of their street in the year 2003 LIP speed hump initiative.

REPORT

The Traffic Safety Committee, at its meeting held on 2003 March 04, received and adopted the *attached* report to review applications for the 2003 speed hump program and recommend streets that could proceed to LIP processing.

Respectfully submitted,

Councillor D. Evans
Chair

Councillor N. Volkow
Vice Chair

Councillor L. Rankin
Member

COPY: CITY MANAGER DIRECTOR ENGINEERING
--

City of Burnaby

INTER-OFFICE COMMUNICATION

TO: TRAFFIC SAFETY COMMITTEE **DATE:** 2003 02 20

FROM: ASST. DIRECTOR ENGINEERING,
TRAFFIC & ENGINEERING SYSTEMS

SUBJECT: 2003 LIP SPEED HUMP PROGRAM

PURPOSE: To review applications for the 2003 speed hump program and recommend streets that could proceed to LIP processing.

RECOMMENDATIONS:

1. **THAT** the requests for speed humps as discussed in this report and summarized in Table 1 be advanced through the year 2003 LIP Program.
2. **THAT** a copy of this report be sent to the residents who requested inclusion of their street in the year 2003 LIP speed hump initiative.

REPORT

1.0 INTRODUCTION

Over the course of 2003 staff have been contacted by a number of Burnaby residents inquiring about the installation of speed humps along their roadways and we have outlined the process for implementation to them. Of those, a total of 10 individuals have expressed a desire to initiate the LIP process.

Staff have contacted the Burnaby Fire Department to ensure that any of the proposed location for speed hump installation would not adversely affect Fire Department response. While they have not expressed direct opposition to the proposed speed hump installations noted above, they remain concerned with the effects such devices have on response times, and the potential for damage to department vehicles.

2.0 REVIEW

None of the roadways discussed below is classified in the Transportation Plan. Accordingly, they are eligible for the installation of speed humps given within installation guidelines. However, some question remain as to the appropriateness of installing humps on a number of the proposed roadways, given their minor collector function in local area road networks, as well as the expected level and type of traffic utilizing the road.

2.1 Abbey Ave (Exhibit A)

While Abbey Ave is classified as a residential roadway it also serves as the sole access for 25 residential properties on Saratoga Ct and Samara Ct. Given the potential impact speed humps would have on area residents it is recommended that wider consultation be conducted prior to the advancement of this LIP initiative.

2.2 Woodsworth St (Exhibit B)

This portion of Woodsworth St also provides an alternate access to Canada Way for residents of Dundonald Ave. Given the potential impact speed humps would have on area residents it is recommended that wider consultation be conducted prior to the advancement of this LIP initiative.

2.3 16th Ave (Exhibit C)

The area map shows that speed humps have been installed on 16th Ave from Canada Way to Mary. There are also speed hump installations to the south. Accordingly, this portion of 16th Ave remains as the sole outlet for a number of tributary streets. Given the potential impact speed humps would have on area residents it is recommended that wider consultation be conducted prior to the advancement of this LIP initiative.

2.4 15th Ave (Exhibit D)

Graham St, immediately north of this street, currently has speed humps and in this grid situation it would not be inappropriate for an installation on 15th Ave. Therefore it is recommended that this Speed Hump initiative be allowed to proceed.

2.5 Eastlake Dr (Exhibit E)

This section of Eastlake Dr is a cul-de-sac serving an adjacent residential development. It also provides a scope for drop off and pick up. The street is built to a wider standard to reflect the longstanding proposal to extend Eastlake Dr under Loughheed Hwy to link up with Government Rd. As this linkage is reaffirmed in the Loughheed Town Centre Plan, it would be inappropriate to promote a speed hump LIP.

2.6 Carrigan Ct (Exhibit F)

Although this section of roadway is currently identified as residential, there remains some question whether this section of road serves a greater function within this higher density neighbourhood traffic. Given the potential impact speed humps would have on area residents it is recommended that wider consultation be conducted prior to the advancement of this LIP initiative.

2.7 11th Ave (Exhibit G)

The installation of Speed Humps on 12th Ave (Cumberland St to Newcomb St) and 14th Ave (Cumberland St to Wright St) during the 2002 Speed Hump Program has triggered interest in speed humps on nearby streets including this section of 11th Ave. It is recommended that this speed hump initiative be allowed to proceed.

2.8 Georgia St (Exhibit H)

Notwithstanding an alternating stop sign scheme in this neighbourhood with a grid network of streets, there is a concern that the street network hierarchy is inappropriately used. If successful, we anticipate other speed hump initiatives from other blocks. However it is recommended that this Speed Hump initiative be allowed to proceed.

2.9 18th Ave (Exhibit I)

Unlike 18th Ave west of 18th St, which is designated as a Local Collector in the current Transportation Plan, this section of roadway is currently unclassified. None the less, given the existence of the traffic signal at the 18th Ave / Griffiths Dr intersection which provides a safe outlet for the neighbourhood, we believe this section of road serves a greater function within the neighbourhood traffic network and do not recommend it for advancement.

2.10 13th Ave (Exhibit J)

Similar to the proposed installation of Speed Hump 11th Ave, the initiative on 13th Ave appears to be in response to the installation of speed humps to 12th and 14th Avenue's in 2002. Give that this roadway's primary function is to provide access to abutting properties, we recommend that this initiative be allowed to proceed.

3.0 RECOMMENDATIONS

Staff recommend that 18th Ave, and Eastlake be excluded from the 2003 LIP Speed Hump Program, and that the initiatives on 11th Ave, 13th Ave, 15th Ave and Georgia St be advanced to the next stage of the process. We propose that the initiatives on Abbey Ave, Woodsworth St, 16th Ave and Carrigan Ct be advanced only following a supportive consultation of the wider neighbourhood potentially impacted by the proposed installation of speed humps.

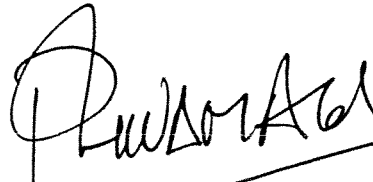

P. Liivamagi, P. Eng.
ASST. DIRECTOR ENGINEERING,
TRAFFIC & ENG. SYSTEMS

AE:
Attach.

cc: City Manager

TABLE 1: Proposed 2003 Lip Speed Hump Location

	Street	Limits		Diag	Recommend
2.1	Abbey Ave	Burke Str	Sardis St	A	YES*
2.2	Woodsworth St	Douglas Rd	Dundonald Ave	B	YES*
2.3	16th Ave	Mary St	Kingsway	C	YES*
2.4	15th Ave	6th St	4th St	D	YES
2.5	Eastlake Dr	Beaverbrook Dr	South End	E	NO
2.6	Carriagan Ct	Cardston Ct	North End	F	YES*
2.7	11th Ave	Cumberland St	Coquitlam St	G	YES
2.8	Georgia St	Esmond Ave	Ingleton Ave	H	YES
2.9	18th Ave	18th St	Leeside St	I	NO
2.10	13th Ave	Cumberland St	Wright St	J	YES

* Subject to consultation with other residents requiring this street for access.

TABLE 1: Proposed 2003 Lip Speed Hump Location

	Street	Limits		Diag	Recommend
2.1	Abbey Ave	Burke Str	Sardis St	A	YES*
2.2	Woodsworth St	Douglas Rd	Dundonald Ave	B	YES*
2.3	16th Ave	Mary St	Kingsway	C	YES*
2.4	15th Ave	6th St	4th St	D	YES
2.5	Eastlake Dr	Beaverbrook Dr	South End	E	NO
2.6	Carrigan Ct	Cardston Ct	North End	F	YES*
2.7	11th Ave	Cumberland St	Coquitlam St	G	YES
2.8	Georgia St	Esmond Ave	Ingleton Ave	H	YES
2.9	18th Ave	18th St	Leeside St	I	NO
2.10	13th Ave	Cumberland St	Wright St	J	YES

* Subject to consultation with other residents requiring this street for access.

BURKE ST.

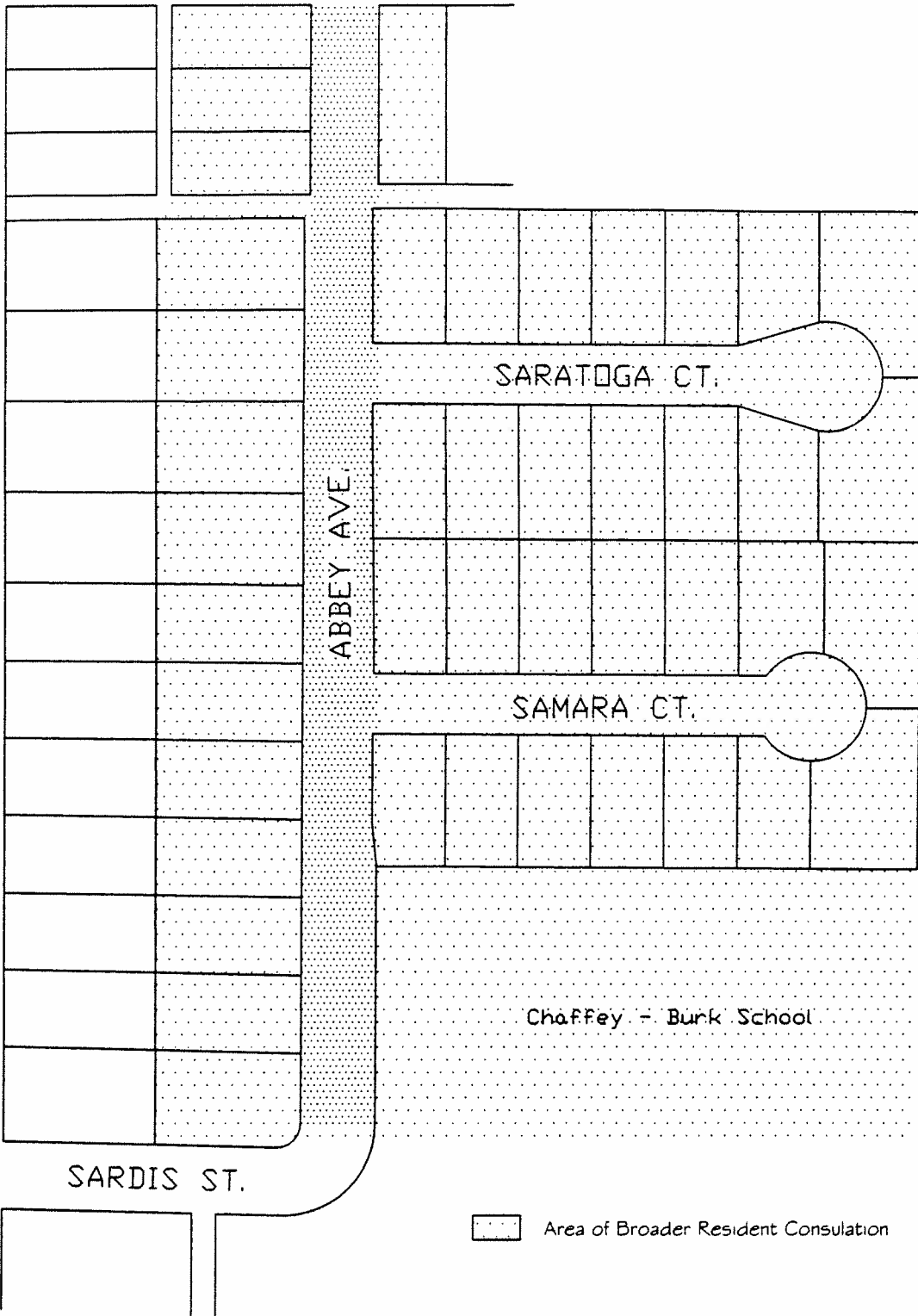

SARATOGA CT.

ABBEY AVE.

SAMARA CT.

Chaffey - Burk School

SARDIS ST.

Area of Broader Resident Consultation

CHAFFEY AVE.

48



A: Abbey Ave

DRAWN BY: A.K.E	SCALE: N.T.S.
APPRV'D BY: P.L.	DATE: 03/02/06

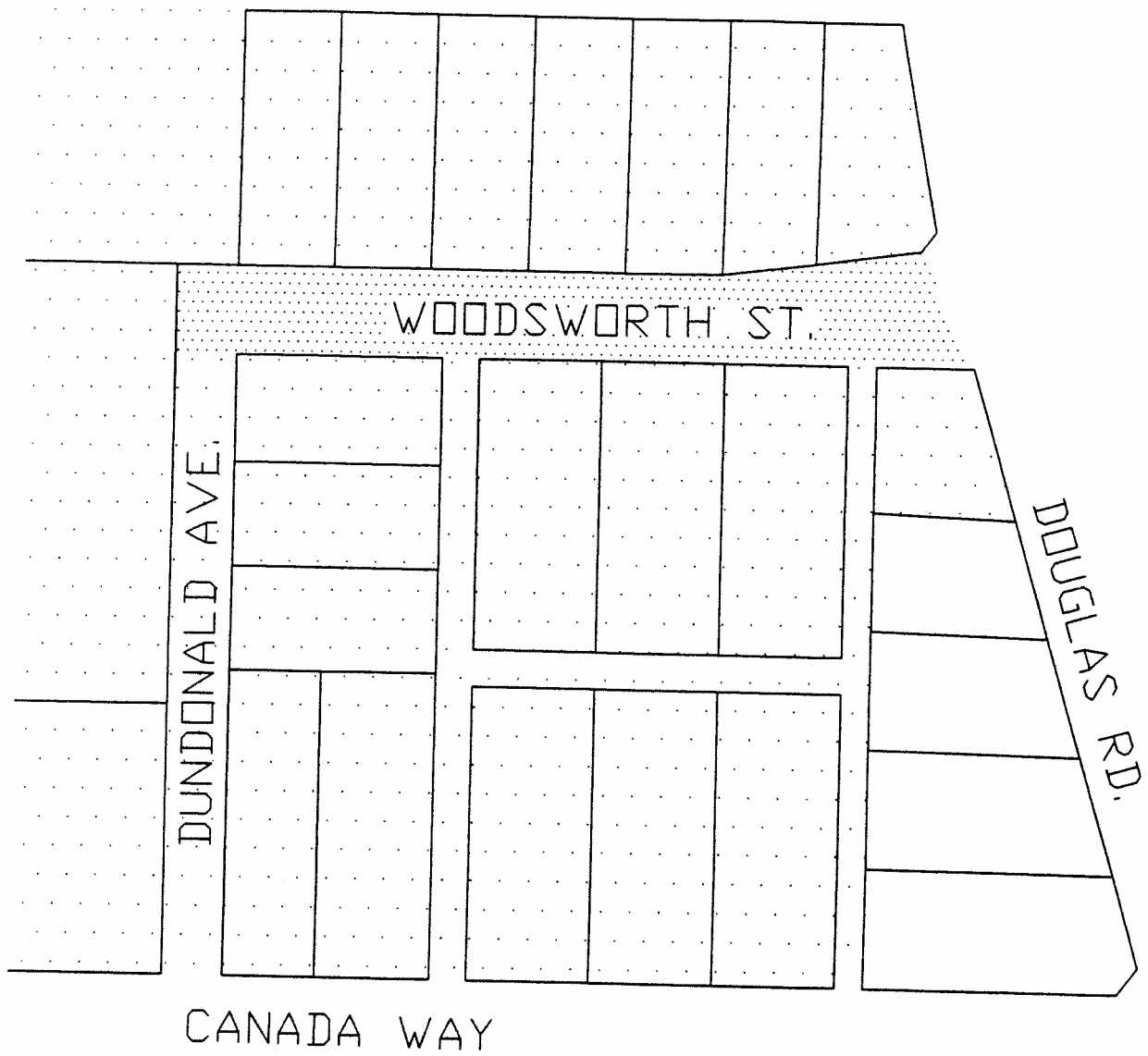



 Area of Broader Resident Consultation



B: Woodsworth St

DRAWN BY: A.K.E	SCALE: N.T.S.
APPRV'D BY: P.L.	DATE: 03/02/06



-  Existing Speed Hump
-  Area of Broader Resident Consultation

50



C: 16th Ave

DRAWN BY: A.K.E	SCALE: N.T.S.
APPRV'D BY: P.L.	DATE: 03/02/06

FOURTH ST.

7577	7581	FIFTEENTH AVE.	7998	7991
7990			7992	
7986			7986	
7980			7980	
7974	7973	7974	7974	7973
7968	7967	7968	7968	7967
7964	7963	7964	7964	7963
7958	7957	7958	7958	7957
7952	7953	7952	7952	7951
7946	7945	7946	7946	7945
7942	7941	7942	7942	7939
7936	7935	7936	7936	7937
7928	7929	7928	7930	7929
7924	7923	7924	7928	7923
7918	7917	7918	7604	7917
7550	7570	7580		7590

SIXTH ST.

51



D: 15th Ave

DRAWN BY: A.K.E	SCALE: N.T.S.
APPR'V'D BY: P.L.	DATE: 03/02/06

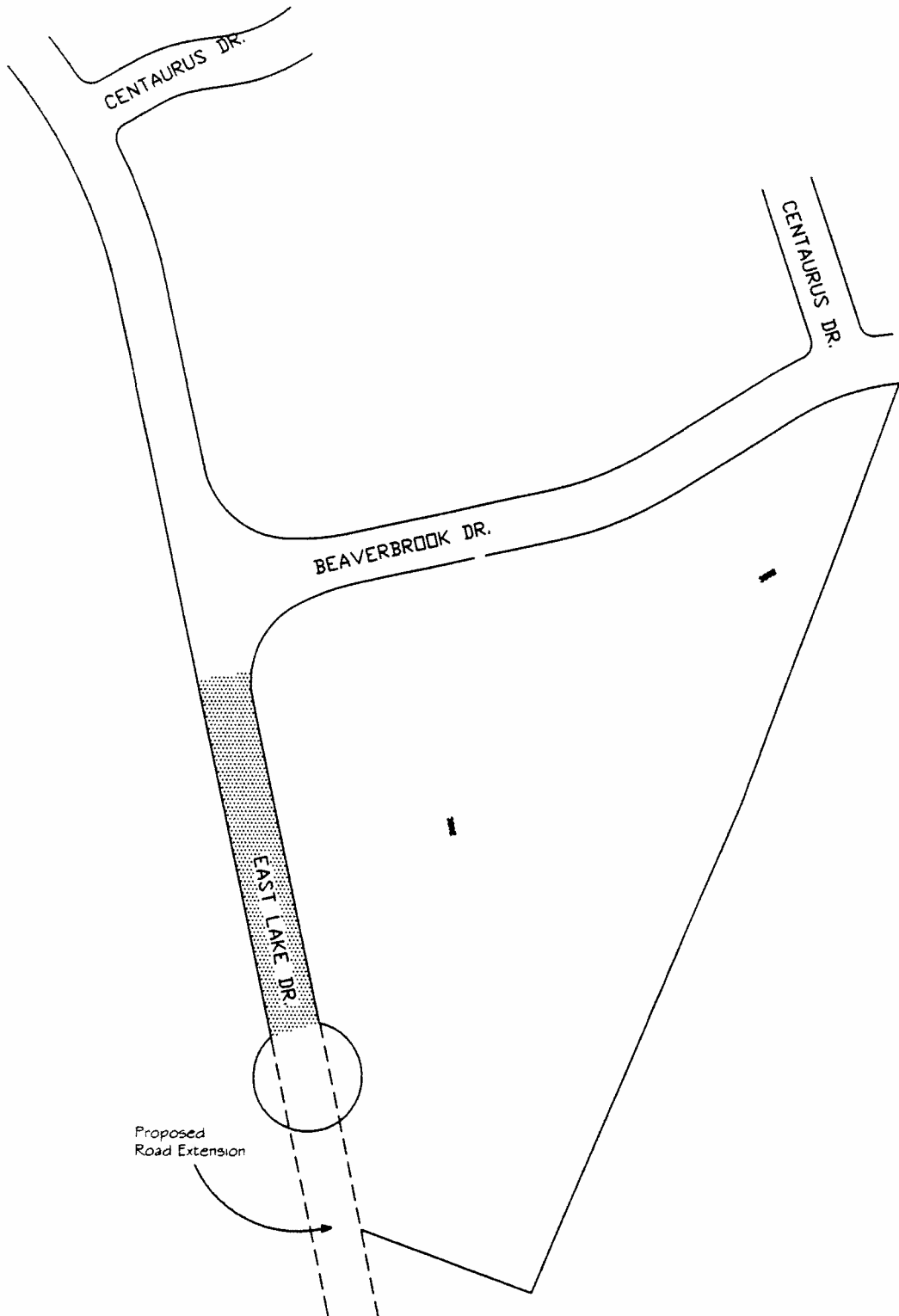

52



E: East Lake Drive

DRAWN BY: A.K.E	SCALE: N.T.S.
APPRV'D BY: P.L.	DATE: 03/02/06

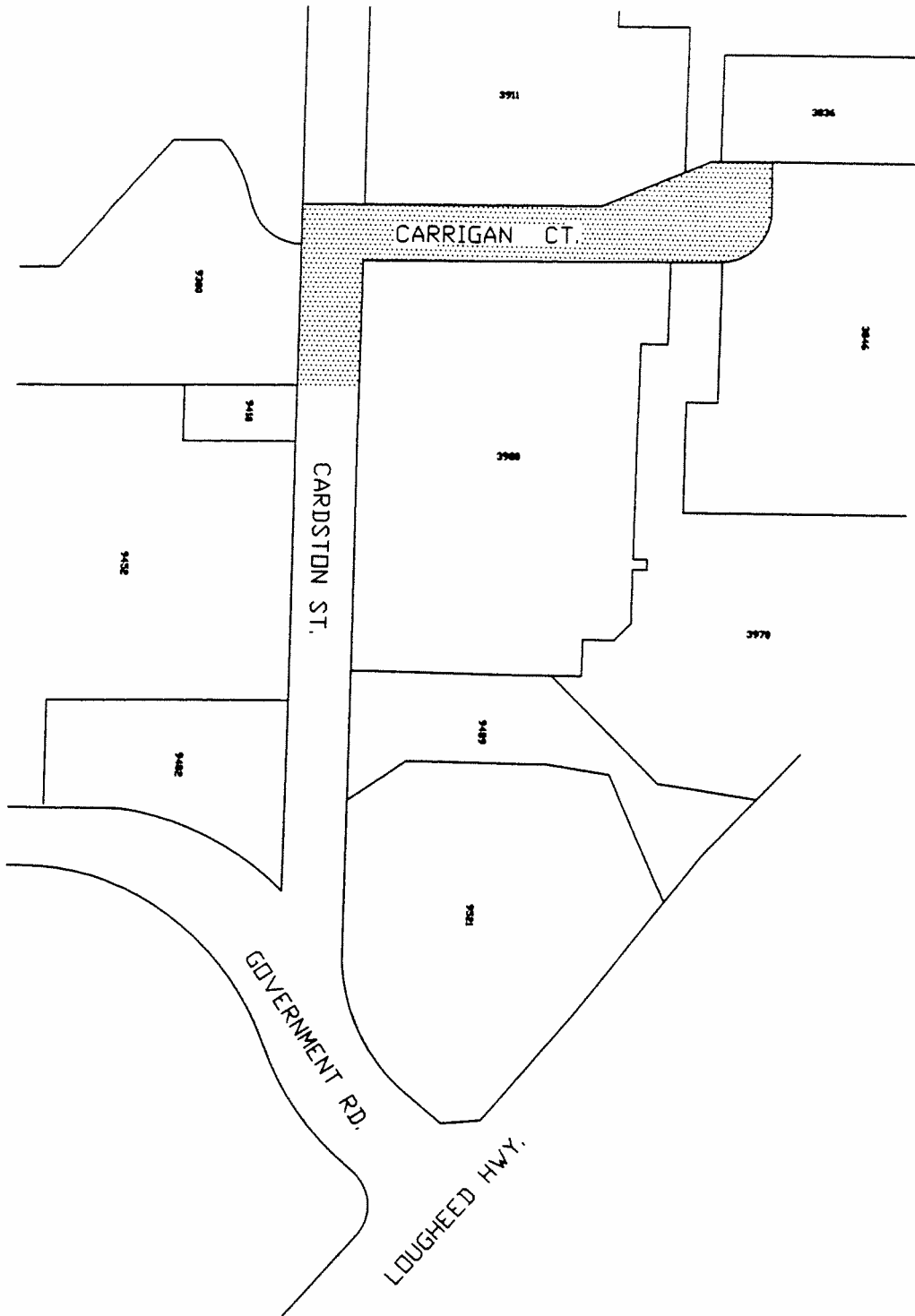

53



City of
Burnaby
ENGINEERING DEPARTMENT

F: Carrigan Court

DRAWN BY: A.K.E	SCALE: N.T.S.
APPR'V'D BY: P.L.	DATE: 03/02/06

COQUITLAM ST.

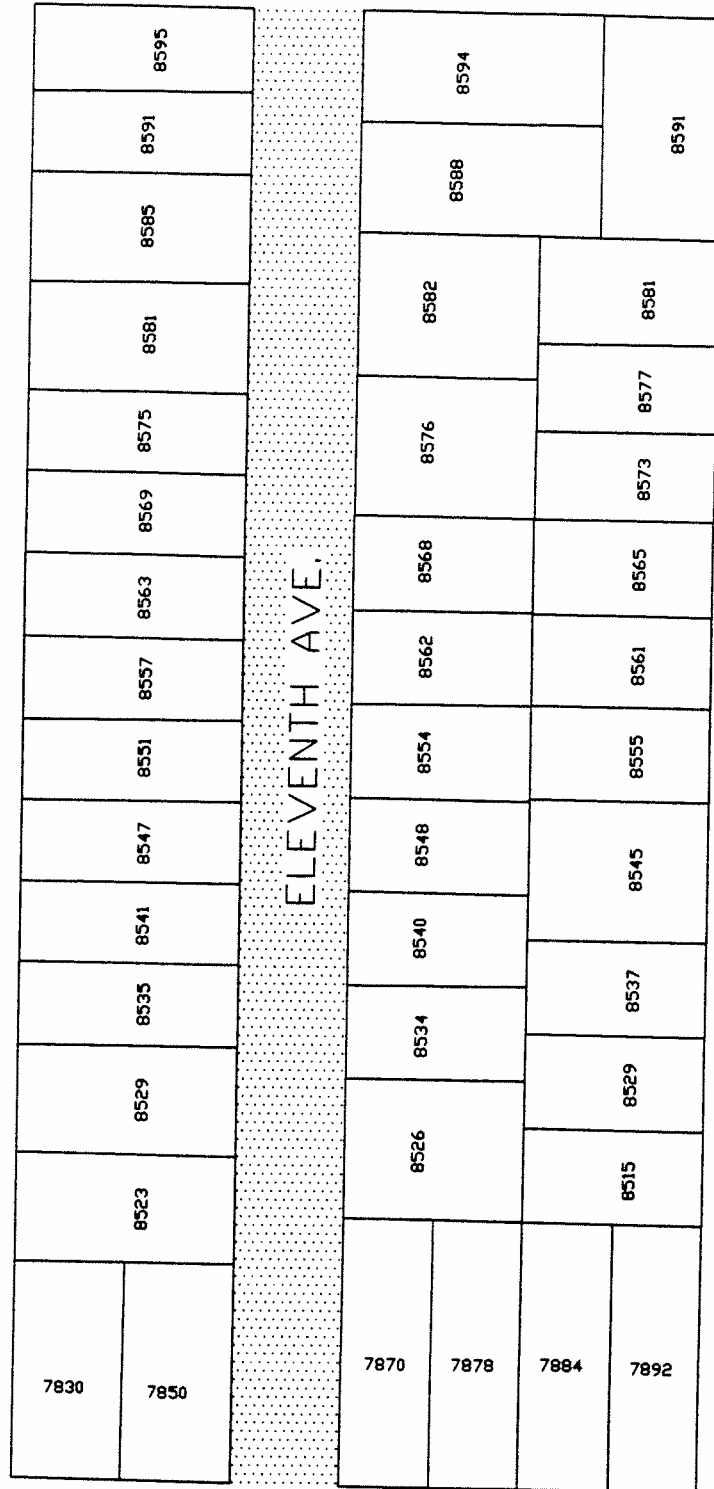

ELEVENTH AVE.

TENTH AVE.

CUMBERLAND ST.

54



G: 11th Ave

DRAWN BY: A.K.E

SCALE: N.T.S.

APPRV'D BY: P.L.

DATE: 03/02/06

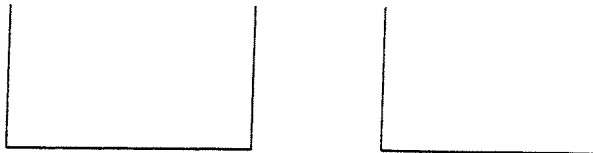

ESMOND AVE.

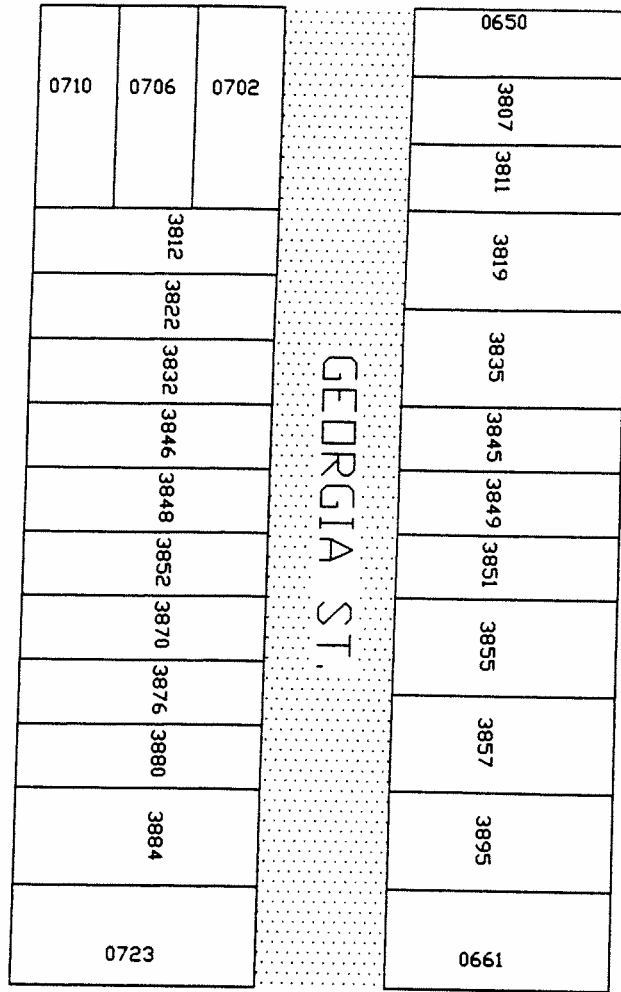

INGLETON AVE.

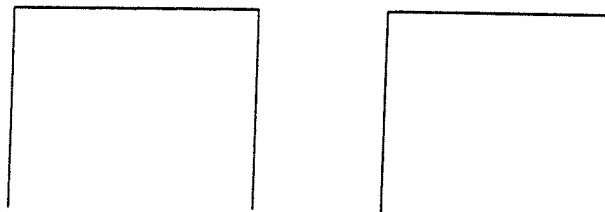

55



H: Georgia St

DRAWN BY: A.K.E	SCALE: N.T.S.
APPRV'D BY: P.L.	DATE: 03/02/06

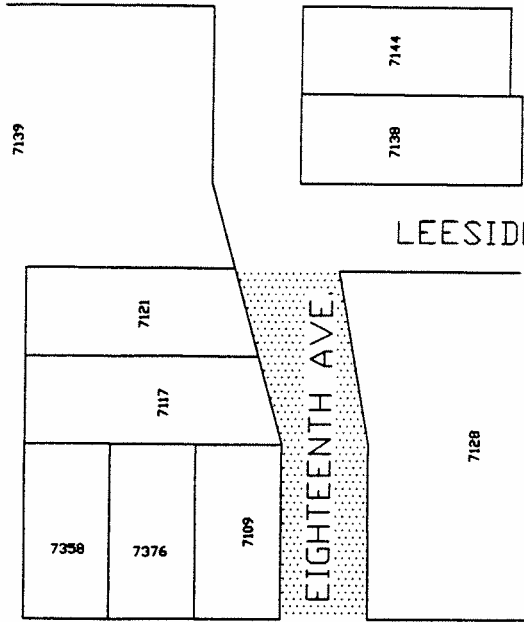

LEESIDE ST.

EIGHTEENTH ST.

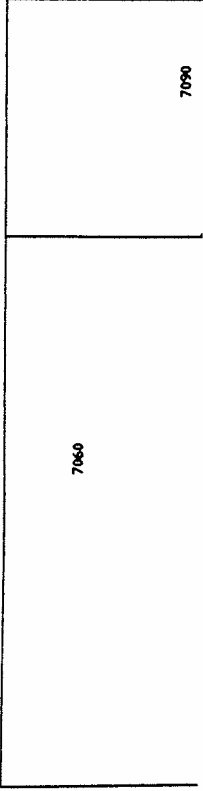
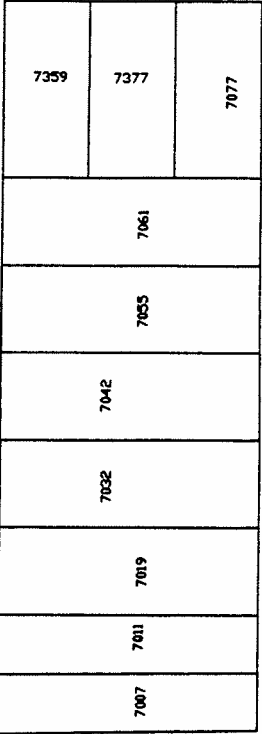

56

GIFFITHS DRIVE



City of
Burnaby
ENGINEERING DEPARTMENT

1: 18th Ave

DRAWN BY: A.K.E
APPRV'D BY: P.L.

SCALE: N.T.S.
DATE: 03/02/06

CUMBERLAND ST.

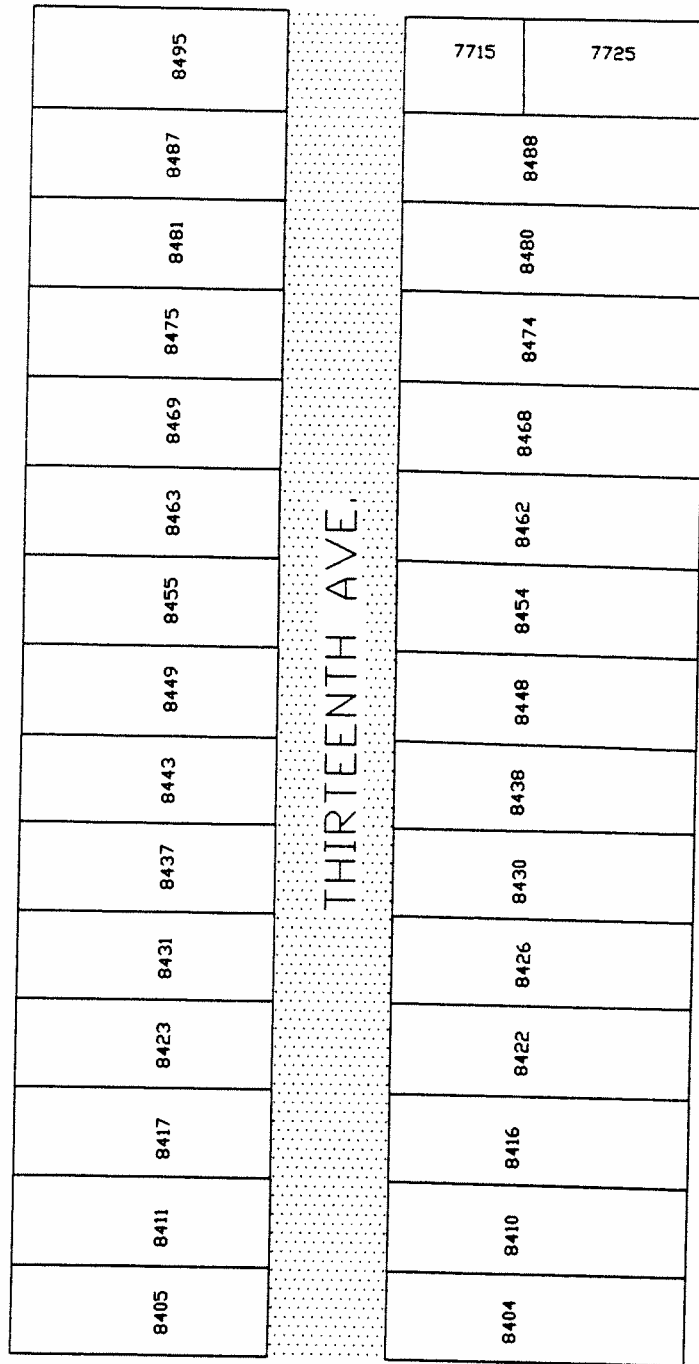

WRIGHT ST.

57



City of
Burnaby
ENGINEERING DEPARTMENT

J: 13th Ave

DRAWN BY: A.K.E

SCALE: N.T.S.

APPR'V'D BY: P.L.

DATE: 03/02/06

