

**TO:** CITY MANAGER

2002 September 04

**FROM:** DIRECTOR PLANNING AND BUILDING  
DIRECTOR PARKS, RECREATION AND CULTURAL SERVICES

**SUBJECT:** 2002 PARK DEDICATIONS  
MONTROSE PARK

**PURPOSE:** To request Council's approval for the purpose of a Park Dedication Bylaw for some City properties for Montrose Park for consideration by the electors at the Civic elections in 2002 November and for the wording of the 2002 Park Dedication Bylaw question for Montrose Park.

---

**RECOMMENDATIONS:**

1. **THAT** the City Solicitor be directed to prepare a Park Dedication Bylaw for those City properties for Montrose Park outlined in Section 2.0 of this report for consideration by the electors at the Civic elections in 2002 November.
2. **THAT** approval be given for the wording of the 2002 Park Dedication question for Montrose Park as outlined in Section 3.0 of this report.
3. **THAT** a copy of this report be sent to the Parks, Recreation and Culture Commission.

**REPORT**

**1.0 BACKGROUND**

Under the Local Government Act the City may by bylaw, with the assent of the electors, dedicate City lands for park and public use only, thus directly involving the community in the protection of parkland for future generations. Land so dedicated can only be undedicated through the assent of the electors.

In 1990, Council initiated a Park Dedication for a number of major park areas in the City. At the same time Council requested that other park and open space areas be considered for dedication in subsequent election years. As a result, park dedications were put before the electorate in 1993, 1996 and 1999. A total of 2,633.22 acres have been dedicated for park and public use since 1990.

In a report received by Council at its meeting of 2002 August 26, eight park areas totalling just under 45 acres were put forward to be considered for Park Dedication in 2002 November. Those lands proposed for dedication are in Deer Lake Park, Cameron Park, Eagle Creek Ravine Park, Lubbock's Woods Park, Taylor Park and three South Slope Ravine Parks including lands within Gray Creek Ravine Park, Froggers Creek Ravine Park and John Matthews Creek Ravine Park.

The purpose of this report is to recommend a number of park properties for an expansion to Montrose Park for inclusion in a Park Dedication Bylaw for the assent of the electors in 2002 November.

## 2.0 MONTROSE PARK PROPOSED FOR DEDICATION

Montrose Park is located in north Burnaby adjacent to the Burrard Inlet (see *attached* Sketch #1). The park is a naturally treed area with the Trans Canada Trail running through the park in a roughly east-west direction. In 1990, 15.65 acres of land were dedicated for Montrose Park. Portions of undeveloped road right-of-way, Ingleton Avenue, and a number of undeveloped lots form the remainder of the undedicated park lands. The Draft Burrard Inlet Foreshore & Upland Management Plan notes the desire to dedicate the City-owned properties to the south of the already dedicated park lands. Dedications are proposed at this time for 37 City-owned properties totalling 21,461.74 m<sup>2</sup> or 5.30 acres for Montrose Park.

When private lands are purchased for park purposes there is a payment from the Parkland Acquisition Fund in the amount of the subject land value. However, there are instances involving historically owned City lands, such as portions of Byrne Creek Ravine Park and upland portions of Burnaby Fraser Foreshore Park, where the transfer for park use has occurred without repayment. In this particular case, due to the historic City ownership of the subject properties and their long-standing public recognition as a natural forested area, it is proposed that the lands be transferred without repayment for park use for dedication as part of Montrose Park, to be maintained in a generally natural state.

Those lands proposed for dedication for Montrose Park are outlined in the following table:

MONTROSE PARK	
Address	Area (m <sup>2</sup> (acres))
3714 Montrose St.	566.71 (0.14)
3724 Montrose St.	566.71 (0.14)
3734 Montrose St.	566.71 (0.14)
3744 Montrose St.	566.71 (0.14)
3754 Montrose St.	566.71 (0.14)
3764 Montrose St.	566.71 (0.14)
3774 Montrose St.	566.71 (0.14)
3784 Montrose St.	566.71 (0.14)
3794 Montrose St.	566.71 (0.14)
3806 Montrose St.	566.71 (0.14)
3816 Montrose St.	566.71 (0.14)
3826 Montrose St.	566.71 (0.14)

<b>MONTROSE PARK</b>	
<b>Address</b>	<b>Area (m<sup>2</sup> (acres))</b>
3836 Montrose St.	566.71 (0.14)
3846 Montrose St.	566.71 (0.14)
3856 Montrose St.	566.71 (0.14)
3866 Montrose St.	566.71 (0.14)
3876 Montrose St.	566.71 (0.14)
3886 Montrose St.	566.71 (0.14)
3896 Montrose St.	566.71 (0.14)
3910 Montrose St.	566.71 (0.14)
3920 Montrose St.	566.71 (0.14)
3930 Montrose St.	566.71 (0.14)
3940 Montrose St.	566.71 (0.14)
3950 Montrose St.	566.71 (0.14)
3960 Montrose St.	566.71 (0.14)
3970 Montrose St.	566.71 (0.14)
3980 Montrose St.	566.71 (0.14)
3990 Montrose St.	566.71 (0.14)
4008 Montrose St.	566.71 (0.14)
4018 Montrose St.	566.71 (0.14)
4028 Montrose St.	566.71 (0.14)
4038 Montrose St.	566.71 (0.14)
4048 Montrose St.	566.71 (0.14)
4058 Montrose St.	566.71 (0.14)
4068 Montrose St.	566.71 (0.14)
4078 Montrose St.	566.71 (0.14)
4088 Montrose St.	1,060.18 (0.26)
<b>TOTAL AREA</b>	<b>21,461.74 m<sup>2</sup> (5.30 acres)</b>

It is recommended that Council approve the properties outlined in the above table for dedication by the electorate in the Civic elections in November.

### 3.0 PARK DEDICATION BYLAW QUESTION

At this Civic election a bylaw question has to be posted on the ballot. The City Clerk in consultation with staff from the Legal, Parks, Recreation and Cultural Services and Planning Departments are recommending that the following Bylaw question be approved by Council as the ninth question on the list of 2002 Park Dedication Bylaw Questions:

(9) MONTROSE PARK

The proposed dedication is an area of approximately 5.30 acres located in north Burnaby.

Do you assent to the dedication of the subject lands within MONTROSE PARK?

### 4.0 CONCLUSION

Burnaby is fortunate to have an extensive and diverse range of parks, conservation areas and public open spaces. Major natural landscapes and resources conserved include river estuary, marine foreshore, mountain and ravine forest, lakes and waterways. This Parks and Open Space system extends over about 5,275 acres representing about 24 percent of the total area of the City. This City and the electorate have previously taken significant steps to protect our irreplaceable park and natural areas for future generations through the park dedication process. The properties proposed for dedication in the 2002 Civic elections continues this process.

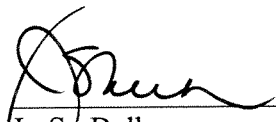
  
\_\_\_\_\_  
J. S. Belhouse  
Director Planning and Building

  
\_\_\_\_\_  
for Kate Friars  
Director Parks, Recreation and  
Cultural Services

JK:gk  
Attachment

cc. City Clerk  
City Solicitor  
City Surveyor  
Director Engineering  
Director Finance

P:\Jennifer\Miscellaneous\Montrose Park Report.wpd

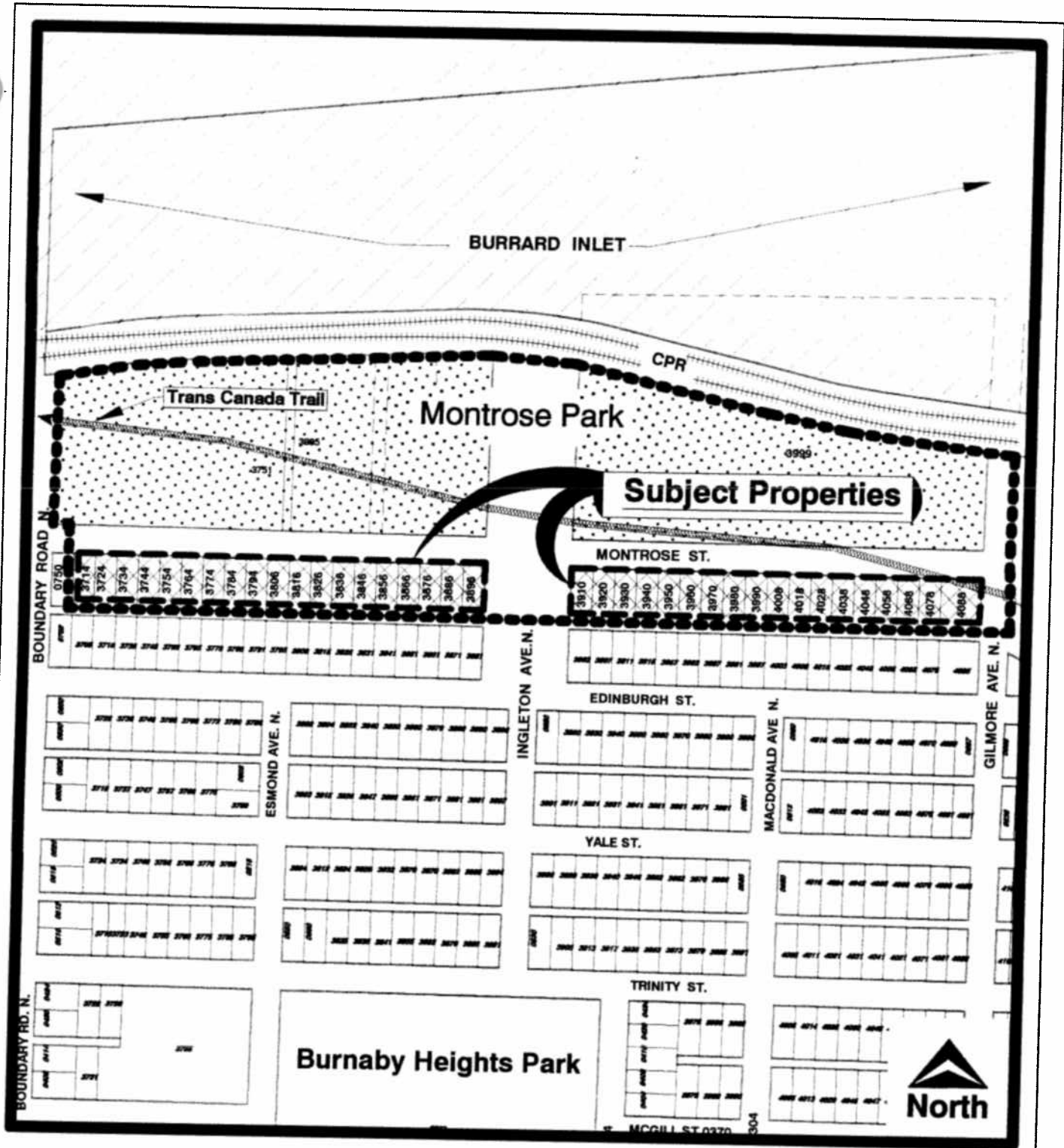

Planning And Building Department

Scale: 1 : 4000

Drawn By: J.P.C.

Date: Sept. 2002

Montrose Park



Dedicated In 1990



Proposed Properties for Dedication

Sketch # 1

