

**CITY OF BURNABY**

**CIVIC DEVELOPMENT COMMITTEE**

***HIS WORSHIP, MAYOR D. DRUMMOND  
AND COUNCILLORS***

**RE: YEAR 2000 BURNABY CAPITAL LEGACY PROJECT**

**RECOMMENDATIONS:**

1. ***THAT*** Council authorize the Year 2000 Capital Legacy Project to be pursued in two phases as described in this report, with the Phase I Millennium Garden being pursued for completion in 2000 and the Phase II City Hall Courtyard being further considered for completion in 2001.
2. ***THAT*** a Capital Reserves Expenditure Bylaw in the amount of \$850,000 (inclusive of 7% GST) be brought down to fund the Phase I Millennium Garden project.

**REPORT**

**1.0 BACKGROUND**

Council, at its regular meeting of 2000 February 21, approved the retention of Phillips Farevaag Smallemberg Landscape Architects Inc. for the design of the Year 2000 Burnaby Millennium Capital Legacy Project. The project proposes to construct a new Millennium Garden on the north side of Burnaby City Hall, and redevelop the City Hall courtyard and surrounding walkways primarily in response to safety and maintenance issues.

<p>:COPY - CITY MANAGER - DEP. CITY MGR.- CORP. SERV. - DIRECTOR ENGINEERING - DIRECTOR FINANCE - DIR. PLNG. &amp; BLDG. - DIR. PARKS, REC. &amp; CULT. SERV. - CHIEF BUILDING INSPECTOR</p>
--

The consultant has worked under the auspices of the Major Civic Building Project Coordination Committee in developing an appropriate design for the Millennium Capital Legacy Project. A presentation of the preliminary design concept has been made to the Civic Development Committee at which time other Council members were also invited to attend the presentation. This design concept meets the program requirements, addresses safety and maintenance concerns requiring the replacement of existing paving, and is appropriate to the civic setting of City Hall.

## **2.0 PROPOSED PHASED PROJECT**

It is proposed that the overall project be constructed in two parts - Phase I for construction in 2000 and Phase II for construction in 2001. Phasing will assure that appropriate public access to the City Hall can be maintained during each of the two phases of construction and will permit a large component of the project to be pursued and desirably completely constructed by the end of this year.

The two phases are briefly described as follows: (see attached sketch)

### **2.1 Phase I - Millennium Garden**

Phase I involves the Millennium Garden, north City Hall entrance and walkway areas on the north and east sides of the City Hall. Phase I components include:

- Millennium Garden proposed with wave-like rows of flowers, informal garden path, a small covered pavilion, seating, sculptural features, and a water feature.
- Walkways reconstructed along the north and east side of City Hall
- City Hall north entry steps realigned with an enhanced entry plaza
- Enhanced lighting provided.

Phase I is ready to be advanced through final designs towards the preparation of working drawings for tendering and a construction start this summer.

### **2.2 Phase II - City Hall Courtyard**

Phase II involves the courtyard area and the main existing working entry to the City Hall on the south and west sides of the City Hall as well as the West Building entrance area. The components of the preliminary design for Phase II include:

- Courtyard and City Hall entry paving reconstructed, with a covered pavilion, seating, landscaping and sculptural space-defining and screening features.
- Council parking area, fire access, building delivery area, and garbage container area retained but altered in layout.
- West Building entry paving reconstructed.

Further design work is being pursued by staff and the consultant on Phase II. Resolution is required of an option to enlarge the main courtyard public space to accommodate very large gatherings and the implications of this option will be studied further. The design options for Phase II will be further discussed by the Civic Development Committee.

### **3.0 PHASE I COST ESTIMATES AND FINANCING**

Sufficient Capital Reserves are available and the total cost of the 2000 Capital Legacy Project estimated at \$1.442 million is included under the 2000 City Hall Projects component of the 2000-2004 Annual Capital Program. The total project cost for Phase I is estimated at \$850,000 (inclusive of 7% GST). A Capital Reserves Expenditure Bylaw in the amount of \$125,000 (inclusive of 7% GST) is in place to fund the design aspects of the Year 2000 Burnaby Millennium Capital Legacy Program.

It is recommended that a Capital Reserves Expenditure Bylaw in the amount of \$850,000 be brought down to finance Phase I of the Millennium Garden project. Financing for Phase II will be determined upon the finalization of the Phase II design.

The City has also applied for a Community Spirit Grant for the Millennium Garden project which could provide up to 50% funding to a maximum of \$200,000 from the province's "B.C. 2000 - Marking the Millennium" grant program. A decision regarding the City's funding application is expected by mid-July 2000.

The Civic Development Committee recommends that the approach described herein be approved by Council for implementation of this project.

Respectfully submitted

Councillor Derek Corrigan  
Chair

Councillor Gary Begin  
Vice-Chair

Councillor Doug Evans  
Member

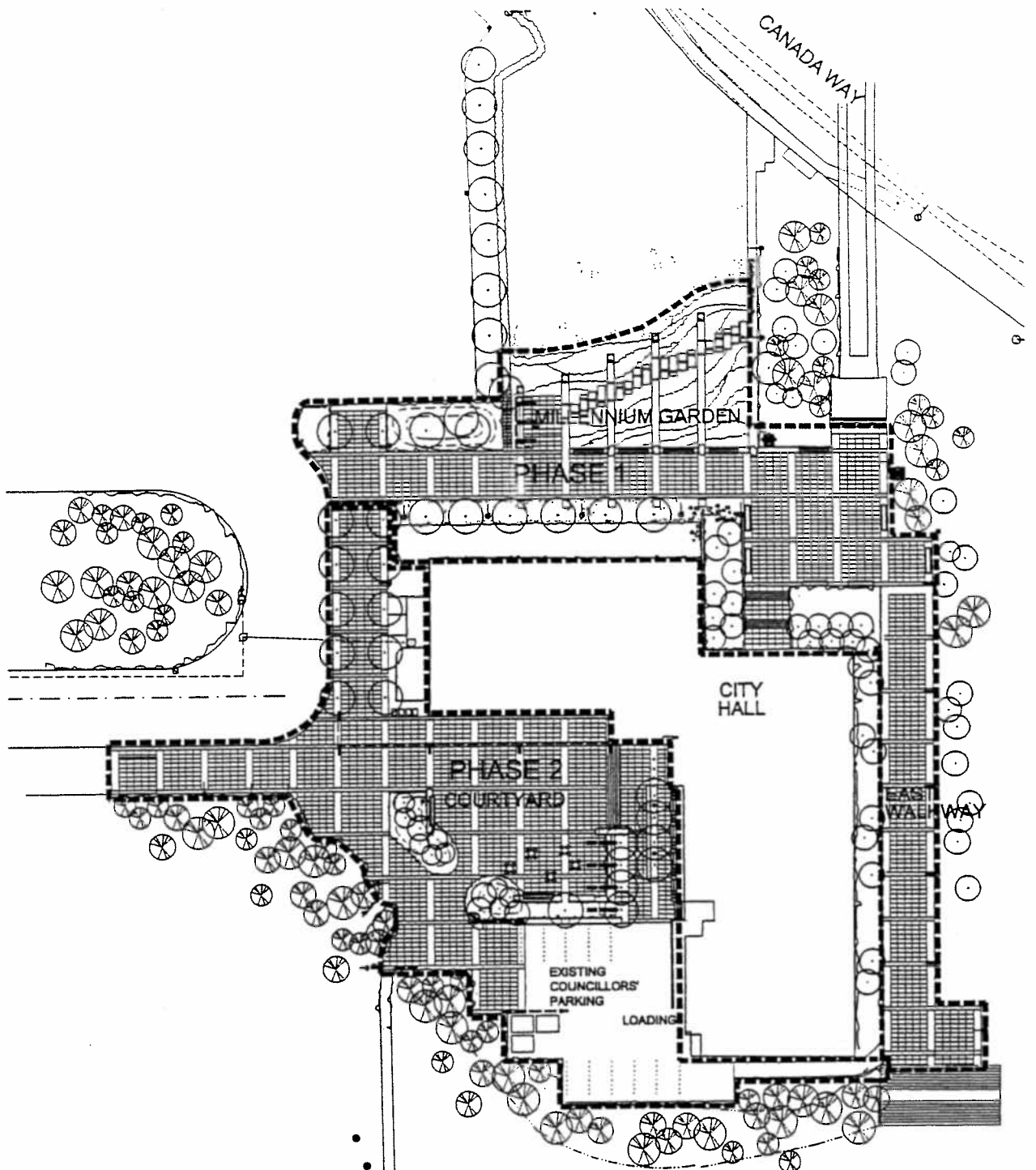

77

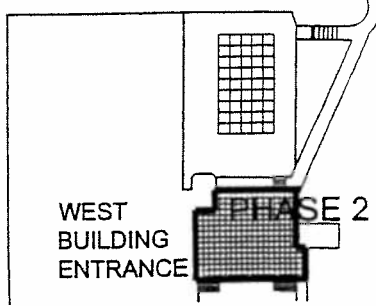

**Year 2000 Capital Legacy Project  
Preliminary Design Concept**

- Phase I - Millennium Garden
- Phase II - City Hall Courtyard

**Figure 1**