

CITY OF BURNABY

TRAFFIC AND TRANSPORTATION COMMITTEE
(TRAFFIC SAFETY DIVISION)

*HIS WORSHIP, THE MAYOR
AND COUNCILLORS*

Re: SFU MOCK ACCIDENT

RECOMMENDATION:

: COPY - CITY MANAGER
- DEP. MGR. - CORP. SERV.
- DIRECTOR ENGINEERING
- OFFICER-IN-CHARGE, R.C.M.P.
- CITY SOLICITOR
- FIRE CHIEF

1. **THAT** Council forward a letter in support of the SFU Mock Accident program as outlined in the attached correspondence.

REPORT

The Traffic and Transportation Committee (Traffic Safety Division), at its meeting held on 1999 March 02, received the attached correspondence outlining a proposal to make all individuals who come to the SFU campus aware of the extreme consequences of their driving habits.

The Traffic Safety Committee supports SFU's initiatives to increase driver awareness and traffic safety.

Mr. D. Berardine
Mr. K. Friederici
Mr. E. Fourchalk
Mr. P. Herring
Ms. L. Kapp
Mr. A. MacDonald
Mrs. D. Mumford
Mrs. R. Oostlander
Mr. J. Parminter
Mr. D. Richardson

Respectfully submitted,

Councillor J. Young
Chair

Councillor D. Evans
Member

Councillor N. Volkow
Member

SFU MOCK ACCIDENT

The driving habits of students, staff, and faculty have become a concern on the SFU campus. With the recent accident resulting in a fatality on the SFU campus and the accident prior to previous on Burnaby Mountain Park, just off the campus, also resulting in a fatality, the habits of drivers must be examined closely. This involves every staff member, student and faculty member because to arrive or leave the campus one must take the bus, drive, walk, bike, or car pool on or near the road.

The summer of 1997 and 1998 Speed Watch Programs both provide statistics that speeding does occur on the Simon Fraser University campus. Awareness of the driver's speed was the focus of both summers' projects. This proposal is to make all individuals who come to the campus aware of the extreme consequences of their driving habits. This can be achieved by the staging a mock accident and providing an information sheet to each vehicle passing the mock accident. A visual image of an accident will help to make the point, where a written article of an accident may not produce the same effect.

The mock accident scenario will focus on the consequences of speeding and therefore the mock accident will be already set up with emergency vehicles on site in designated areas. Having the mock accident site setup and not requiring the emergency vehicles to respond will reduce the risk of any more accidents.

Scenario:

Two individuals are leaving the SFU campus via University Drive East in the right lane travelling at approximately 70+km/h, in a 50km/h zone of a curved down hill section of the road (refer to Map A). The driver loses control of the vehicle, due to driving beyond the driver's capabilities and being distracted by the passenger, enters into the left lane and hits the curb. The momentum from the contact with the curb results in the vehicle flipping over onto the roof and finally landing upright. The passenger was thrown out of the vehicle due to no seat belt being worn. No alcohol or drugs were involved in this accident. The road conditions were dry, with no precipitation or frost present. The vehicle was in good operating condition. The driver's ability and unsafe speed were the contributing factors to the accident.

Those Involved:

SFU Traffic and Security will be involved as well as a number of Campus Student Patrollers will be six. ICBC has been contacted and invited to participate. ICBC can provide the use of a damaged vehicle for the staged mock accident. A towing company could be asked to help in the moving of the damaged vehicles, either BCAA, Mundy's or Coquitlum Towing. The attendance of the RCMP would make the mock accident scene more official. The Ambulance service should be contacted and can participate by attending to the injured confederate. The Burnaby fire department could also attend and use the Jaws of Life to make the scene more realistic in the removal of the injured confederate. BC transit will be contacted and informed of the mock accident.

Health Services can also aid by providing information as to the types of injuries that are common to the particulars of the mock accident. Burnaby City's Traffic and Safety Committee can be informed as to SFU's intentions. Members of the Contemporary Arts department could be involved with the make-up, provide the victims for the accident, and film and edit the mock accident.

All emergency vehicles will have a designated area to park their vehicle within the mock accident site (refer to Map A & B). All other vehicles will have designated parking areas as well (refer to Map A & B).

Information/Debriefing Sheet:

The information/debriefing sheet will be distributed to drivers away from the mock accident scene to alleviate some of the traffic congestion the mock accident will create (refer to Map ^B C). The information/debriefing sheet will provide the reader with the scenario of the accident, the factors that contributed to the accident, what injuries the parties could receive, and what the penalties for those responsible are. The sheet will also provide average speeds from the Speed Watch Programs for each location for specific days and for the week. The information/debriefing sheet will also provide the basics on the ongoing Speed Watch Program and the penalties that could be issued to the driver. The information/debriefing sheet will also state all groups that supported the mock accident in some way. Attached will be a fines and penalties pamphlet.

At the end of the sheet "Please Recycle" will be printed to help deal with clean up of the information sheets. Prior to the mock accident, a rough count of how many vehicles will pass the location so to know how many information

sheets to print. One information sheet will be provided for one vehicle. The printing costs for the sheets will be fair amount and will need to be paid for. Either a company can sponsor or donate some money to pay for the costs or fundraising will need to be conducted to raise the money.

Time and Location:

The time that the mock accident should occur would be on a dry day, so not to cause any other accidents, and on a Wednesday when a majority of the students have classes. The mock accident will occur in the morning when most students arrive between 0800-1000 hours. The tentative day will be March 24, 1999. The location will be on University Drive East, the vicinity will be east of the "G" series of parking lot "B" on the median island where the campus return road is situated (refer to Map A or B).

Other Benefits:

Media attention can be gained for the University by taking a proactive stance on the problem of speeding on campus. There can also be a positive image of cooperation between the various groups that participated. Better relations could be developed with the various organizations that participated as well. Film students from SFU could film the mock accident and create an entire production of this so that the CSP's, during Clubs Day, could replay this for promotion of Campus Security. The Film student could also use this as their assignment, a way to gain experience, and have positive contact with Security members. Members of the ambulance and Burnaby fire department would also get added practice with the mock accident.

Media:

The various media organizations that will be invited are as follows: BCTV; VTV; Global; Burnaby Now; The Province; The Sun; and CKNW. The Peak and the Simon Fraser News should be informed at the least since they serve the SFU community. Specific areas to park will be set aside for their vehicles if they attend (refer to Map A).

Emergency Vehicle Routes in case of a Real Emergency:

There will be routes for Emergency vehicles to leave in case of an actual emergency. The traffic controllers will know where to direct the emergency vehicles if they must leave and control the traffic for their departure.

Communication and Safety:

The use of the SFU Security radios will be used to keep all traffic controllers in contact and to relay any questions or problems to the mock accident coordinator. Each traffic controller will be equipped with a reflective traffic vest and radio and each individual will be designated a specific area to direct traffic for the duration of the event (refer to Map A & B). Traffic cones and Do Not Cross tape will be erected to maintain safe areas for vehicles to park and those involved to walk around (refer to Map A & B). Signs can be erected stating "Mock Accident in Progress," "Reduce Speed," and "Merging," (refer to Map A).

Clean Up:

The vehicles should be drained of all fluids prior to the moving of the vehicles. If any debris does remain brooms will be needed to sweep up the

remaining material. Clean up of the information sheets may be required, but with the "Please Recycle" on the sheet this may reduce the amount of paper wasted.

Costs:

The cost of the Student Patrollers for the time period will be approximately \$212.50, 21 @ \$8.50/hour. The actors will most likely volunteer their time. The individual(s) filming, if they could use this as a project for a course would not cost the department any money. The information/debriefing sheets will cost approximately \$100 for 1000 @ \$.10/copy, unless the Print Shop will discount the copies for the project. The makeup costs for the actors may be covered by the Contemporary Arts department, if they agree to volunteering their time. There will be some costs for the actual tape(s), approximately \$7-14 per high quality tape, the mock accident will be filmed on. The camera's can be signed out through the Instructional Media Center or through Contemporary Arts.

MAP A

MOCK CONTROLLER		MOCK
SECURITY VAN		TOW TRUCK
FIRE DEPARTMENT		AMBULANCE
POWERS		ACCIDENT VAN
		PLANNING OFFICE

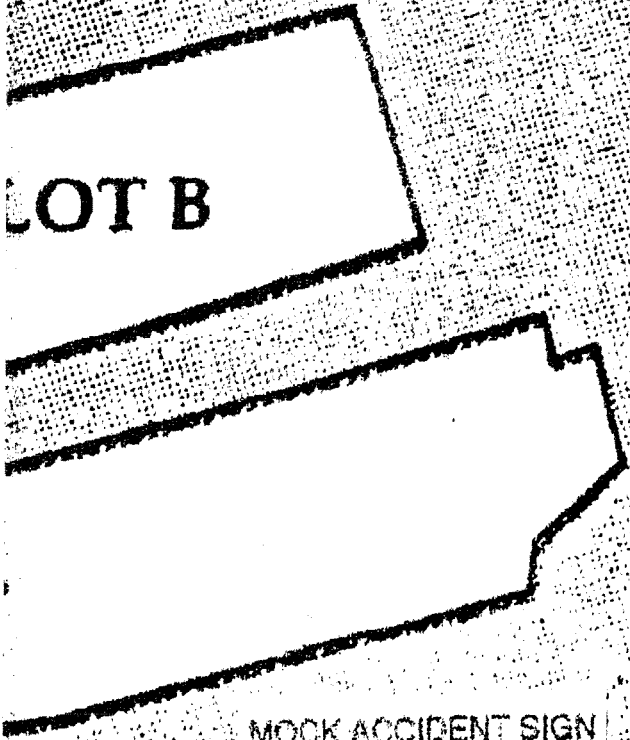

LOT B

MOCK ACCIDENT SIGN

MOCK ACCIDENT SIGN

44

MERGING SIGN

REDUCE SPEED SIGN

MAP B

2 INDIVIDUALS HANDING
OUT INFORMATION / DEBRIEFING
PACKAGE

