

CITY OF BURNABY

TRAFFIC AND TRANSPORTATION COMMITTEE  
(TRAFFIC SAFETY DIVISION)

*HIS WORSHIP, THE MAYOR  
AND COUNCILLORS*

**SCHOOL CROSSWALKS ASSOCIATED WITH THE AUBREY SCHOOL**

**RECOMMENDATIONS:**

1. **THAT** Council approve the installation of marked crosswalks at the Stratford/Aubrey and Kensington/Aubrey intersections.
2. **THAT** a copy of the *attached* report be sent to residents affected by the crosswalk installations, as well as the Aubrey School Parent Advisory Committee.

**REPORT**

The Traffic and Transportation Committee (Traffic Safety Division), at its meeting held on 1999 September 07, adopted the *attached* report responding to complaints about safety at this intersection.

Respectfully submitted,

Mr. D. Berardine  
Mr. K. Friederici  
Mr. E. Fourchalk  
Mr. P. Herring  
Ms. L. Kapp  
Mrs. D. Mumford  
Mrs. R. Oostlander  
Mr. J. Parminter  
Mr. D. Richardson

Councillor J. Young  
Chair

Councillor D. Evans  
Member

Councillor N. Volkow  
Member

COPY - CITY MANAGER  
- DIRECTOR ENGINEERING

City of Burnaby

INTER-OFFICE COMMUNICATION

**TO:** TRAFFIC SAFETY COMMITTEE **DATE:** 1999 08 18  
**FROM:** ASST. DIRECTOR ENGINEERING,  
TRAFFIC & ENGINEERING SYSTEMS **FILE:**  
**SUBJECT:** SCHOOL CROSSWALKS ASSOCIATED WITH THE AUBREY SCHOOL  
**PURPOSE:** To Recommend Two New School Crosswalks Proposed Through the Aubrey School "Way to Go" Program

---

RECOMMENDATION:

1. **THAT** marked crosswalks be installed at the Stratford / Aubrey and Kensington / Aubrey intersections.
2. **THAT** a copy of this report be sent to residents affected by the crosswalk installations, as well as the Aubrey School Parent Advisory Committee.

REPORT

Toward the end of the 1998/1999 school year, the Parent Advisory Committee (PAC) of Aubrey School took initial steps to develop a 'Way to Go' program for the upcoming school year. Aubrey Street from Stratford Avenue to Kensington Avenue has been identified as a desirable pedestrian connection for students en-route to the school.

In order to help create this pedestrian route, marked school crosswalks would be desirable at the intersections of Stratford / Aubrey and Kensington / Aubrey. Diagram #1 illustrates the proposed crossing locations and related parking restrictions.

Staff have contacted residents affected by approach and departure parking restrictions required when installing a marked crosswalk. To date one resident at each location has logged objections. However, in both cases, the parking restrictions only prohibit a portion of the current parking available to them on street. These residents have been informed of the approval process for the proposed crosswalk installations and the date that the issue is being brought to the committee.

The objections from two affected residents must be balanced against the need to provide a safe environment for children walking to and from school. Again we note that the proposed parking restrictions would remove only a portion of existing on street parking adjacent to the concerned residents' properties. Accordingly, it is recommended that the installation of marked crosswalks at the Kensington/Aubrey and Stratford/Aubrey intersections be approved.

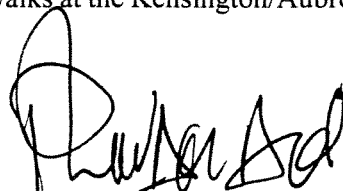

ASST. DIRECTOR ENGINEERING,  
TRAFFIC & ENG. SYSTEMS

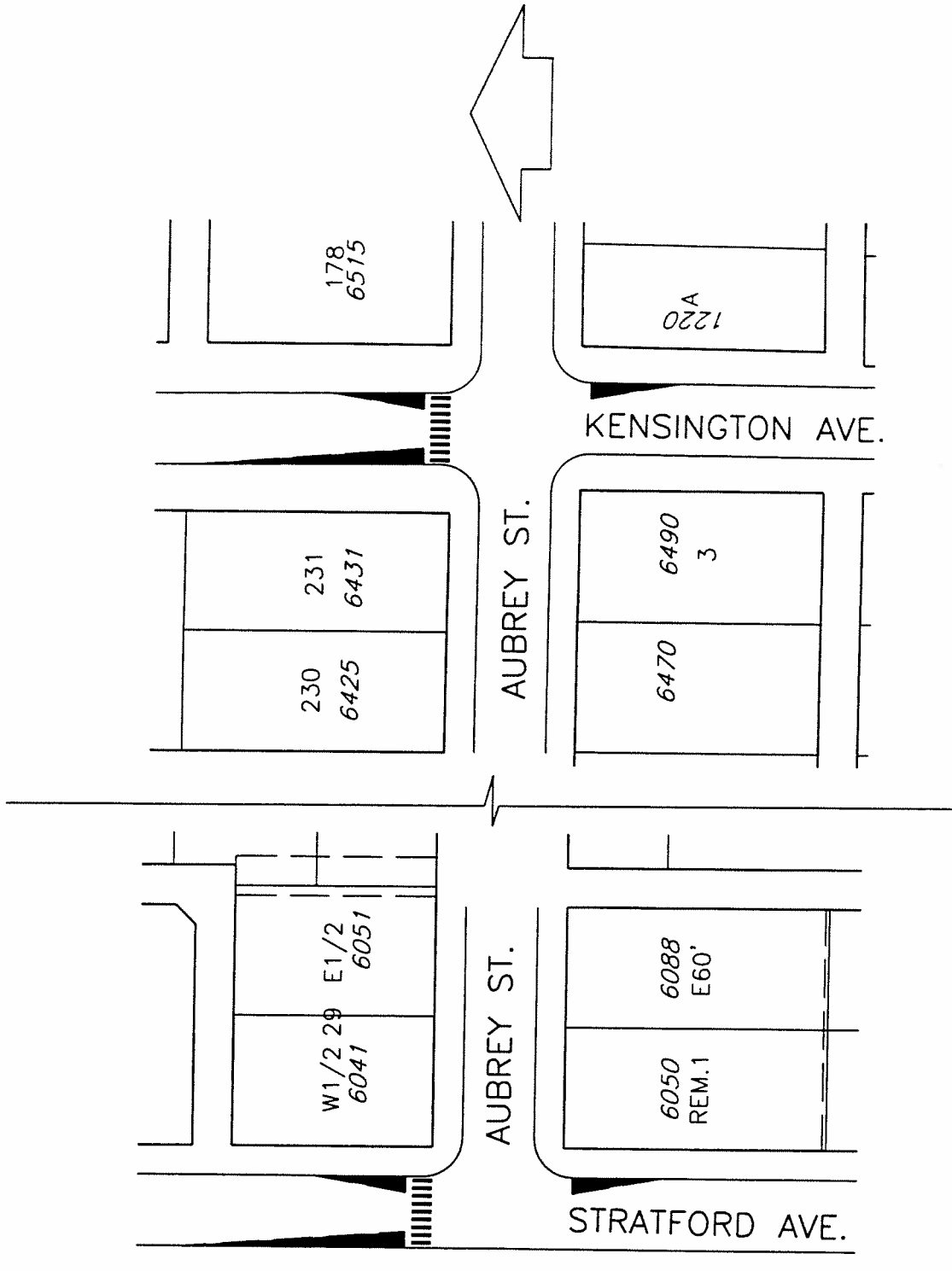

 PROPOSED PARKING PROHIBITION  
 PROPOSED SCHOOL CROSSWALK'S

29

NO.	DATE	REVISION



**AUBREY SCHOOL PEDESTRIAN CROSSING**  
 STRATFORD AVE & AUBREY ST  
 KENSINGTON AVE & AUBREY ST

DRAWN BY: HLOUIE	SCALE: N.T.S.	<b>A</b> 515
APPRV'D BY: CDL	DATE: 99-08-24	

