

TO: CITY MANAGER

1998 August 28

FROM: DIRECTOR PLANNING AND BUILDING

SUBJECT: GRIFFITHS AVENUE REALIGNMENT

PURPOSE: To seek Council authority for the dedication of land for road improvements on Griffiths Avenue adjacent to City Parklands.

RECOMMENDATIONS:

1. **THAT** Council authorize the dedication for road right-of-way of the required portions of 7438, 7462, 7488 Griffiths Avenue, part of 6970 Beresford Street, part of 6931 21st Avenue, all of 6949 Griffiths Avenue, all of 6919 21st Avenue, and the following non-addressed properties: Parcel "A" (Plan with Bylaw filed 37305) of Lot 27, District Lots 95 and 96, Group 1, N.W.D., Plan 3907; and Part (Plan with Bylaw filed 37305) of Lot 32, District Lot 95, Group 1, N.W.D., Plan 2751, as indicated on the **attached** Sketch #1.

REPORT

The City Surveyor, while preparing the required plans for the previously approved road widenings on the east side of Powerhouse Park associated with Rezoning Reference # 12/97 and Subdivision Reference # 23/97 (southwest corner of Griffiths Avenue and Beresford Street), also prepared a second reference plan of road dedication to the south as a matter of "house-keeping".

The subject City-owned properties including parts of 7438, 7462, 7488 Griffiths Avenue, part of 6970 Beresford Street, part of 6931 21st Avenue, all of 6949 Griffiths Avenue, all of 6919 21st Avenue and the non-addressed properties: Parcel "A" (Plan with Bylaw filed 37305) of Lot 27,

CITY MANAGER
GRIFFITHS AVENUE REALIGNMENT
1998 AUGUST 28.....PAGE 2

District Lots 95 and 96, Group 1, N.W.D., Plan 3907; and Part (Plan with Bylaw filed 37305) of Lot 32, District Lot 95, Group 1, N.W.D., Plan 2751 were acquired for road and parks purposes. The portions of these properties that have been used to accommodate the realignment of the Griffiths-19th Street Connector which was constructed several years ago have yet to be formally dedicated for this purpose. It is therefore recommended that the required portions of these City-owned land parcels, as shown on attached Sketch #1, be dedicated for road.



D.G. Stenson
Director Planning and Building

EK

Attach.

cc: Deputy City Manager
Director Engineering
City Solicitor
Director Parks, Recreation and Cultural Services

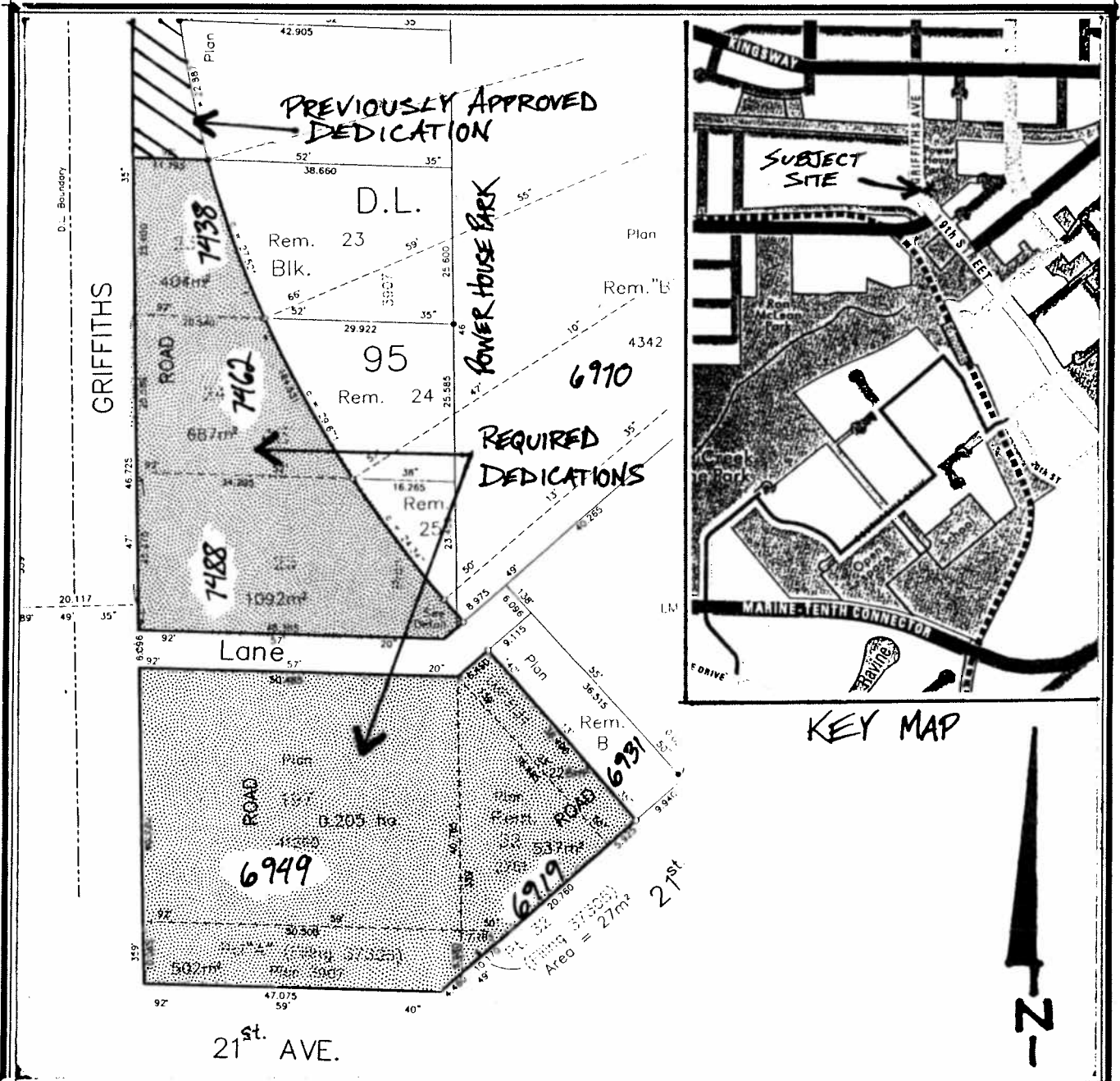

Date:
AUGUST 1998

Scale:
1:1000

Drawn By:
E.K.

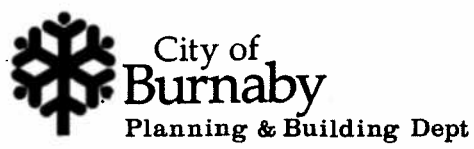

SKETCH #1

CITY OWNED LAND TO BE DEDICATED FOR ROAD

