

**TO:** CITY MANAGER 1995 AUGUST 16  
**FROM:** DIRECTOR PLANNING AND BUILDING  
**SUBJECT:** REZONING REFERENCE #32/95  
GARDEN VILLAGE AREA R10 REZONING  
**PURPOSE:** To seek Council authority to forward this application to a Public Hearing on 1995 September 26

---

**RECOMMENDATION:**

1. **THAT** a Rezoning Bylaw be prepared and advanced to First Reading on 1995 September 12 and to a Public Hearing on 1995 September 26 at 7:30 p.m.

**R E P O R T**

**1.0 GENERAL INFORMATION:**

- 1.1 Applicant: City of Burnaby
- 1.2 Subject: Application for the rezoning of:  
Legal: See attached Schedule "A"  
Addresses: See attached Schedule "A"  
From: R2 Residential District  
To: R10 Residential District

- 1.3 The subject site is generally located north of Burke Street and east of Patterson Avenue, with a park strip south of Alderwood Crescent serving as the north boundary and Gilpin and Barker Crescents are the easterly boundary (see attached Sketch #3). The rezoning involves 259 residential lots.

**1.4 Rezoning Purpose:**

The purpose of the proposed rezoning bylaw amendment is to limit the permitted bulk of single-family dwellings.

**2.0 NEIGHBOURHOOD CHARACTERISTICS:**

- 2.1** The Garden Village neighbourhood is primarily a 1950's subdivision and is zoned R2 Residential District. The lots are commonly around 60 feet in width and 110 feet in depth. The original houses have one storey and a basement and range between 2,200 and 2,800 sq.ft. in total floor area. The housing character in this area is quite homogenous.

The residential areas surrounding the Garden Village Study Area consist of housing stock which is relatively similar to the study area, but generally is less uniform with greater variety in the dwellings and more single-family dwellings with greater bulk. There are also some two family dwellings to the north and east of Garden Village.

**3.0 BACKGROUND INFORMATION:**

- 3.1** At its meeting on 1994 May 30, the Housing Committee received a petition signed by the owners of 124 properties in the Garden Village area (see Sketch #1). The petition requested a change in zoning in order to limit houses to one storey and a basement.

In response to the petition, a questionnaire was sent to property owners and residents in October 1994. The purpose of the questionnaire was to obtain general opinions on how development should be regulated in this neighbourhood. The findings of the questionnaire revealed an insufficient level of support to limit new houses to one storey and a basement. However, the findings did indicate that there was some support to change the current R2 District zoning to limit the bulk of houses to a greater extent. Based on these results, Council, at its meeting on 1995 January 16, authorized staff to undertake a review of the R10 and R11 zoning regulations with a group of property owners as a first step in the area rezoning process.

- 3.2** In April 1995, three meetings took place with a group of property owners representing various views on development and different areas of the neighbourhood. As a result of these discussions and the findings of the neighbourhood questionnaire in October 1994, a zoning proposal based on the R10 District was sent to property owners and residents at the end of May. This report provides the findings of a questionnaire included with the proposal.

**4.0 GENERAL DISCUSSION:**

- 4.1** The R10 District was developed in 1991 for the Brentwood Park area. It limits the building bulk by restricting the height of a house to 24.9 feet and by reducing the size and shape of the above grade floor area. The maximum gross floor area permitted is 3,982 sq.ft. In contrast, the R2 District permits a building height of 29.5 feet and there is no restriction on how much of the above grade floor area can be located on the second storey. The maximum gross floor area permitted under the R2 District is the lesser of .60 of the lot area or 4,736 sq.ft. As a result, lots greater than 6,638 sq.ft. in area would be permitted less floor area under the R10 District than they would under the R2 District.
- 4.2** There are 396 residential properties zoned R2 District in Garden Village. Of the 331 property owners responding to the questionnaire, 188 (56.8%) were in favour of an area rezoning to the R10 District, 131 (39.6%) were opposed and 12 (3.6%) were undecided. Since the 188 properties in favour of the rezoning represent only 47.5% of the total number of properties, it was determined that there was insufficient support to rezone the entire neighbourhood.
- 4.3** However, in analyzing support within sub-areas of the neighbourhood, it was evident that support for the area rezoning was strongest in the western sub-area (see *Sketch #2*). The following table provides the results of the questionnaire for each sub-area.

**Table 1: Zoning Preference Among Property Owners in Three Sub-Areas**

| Sub-Area          | No. of Lots | Support for Rezoning to R10<br>(out of total number of respondents for each sub-area) |       |         |       |           |      | Total No. of Respondents |
|-------------------|-------------|---|-------|---------|-------|-----------|------|--------------------------|
|                   |             | In Favour   |       | Against |       | Undecided |      |                          |
| Northern Sub-Area | 34          | 14  | 50%   | 12      | 42.9% | 2         | 7.1% | 28                       |
| Eastern Sub-Area  | 103         | 38  | 46.9% | 41      | 50.6% | 2         | 2.5% | 81                       |
| Western Sub-Area  | 259         | 136   | 61.3% | 78      | 35.1% | 8         | 3.6% | 222                      |
| <b>TOTAL</b>      | 396         | 188   | 56.8% | 131     | 39.6% | 12        | 3.6% | 331                      |

There are 259 properties in the Western sub-area, of which 222 property owners responded to the questionnaire for a response rate of 85.7%. Of these owners, 194 were residents of the neighbourhood and 28 were absentee owners. Of the 222 property owners, 136 (61.3%) were in favour of an area rezoning to the R10 District, 78 (35.1%) were opposed and 8 (3.6%) were undecided. In relation to the total number of properties within the western sub-area, 52.5% (136 out of 259 properties) were in favour of the area rezoning to the R10 District. Given this level of support, it is recommended that this sub-area be considered for an area rezoning to the R10 District.

**5.0 CONCLUSION:**

- 5.1** The overall results of the survey indicate an insufficient level of support to rezone the entire Garden Village neighbourhood to the R10 District. Of the 331 property owners responding to the questionnaire, 188 (56.8%) were in favour of the area rezoning. However, these respondents represent only 47.5% of the total number of properties and therefore do not meet the requirement that at least 50% of the properties be in support of the area rezoning.

It was determined that a sufficient level of support for an area rezoning to the R10 District was demonstrated in the western sub-area of the neighbourhood. A high percentage (85.7%) of the 259 property owners in this sub-area responded to the questionnaire. Of the 222 respondents (owners only), 136 (61.3%) were in favour of an area rezoning to the R10 District. This means that 52.5% of all the properties within the western sub-area support the rezoning to the R10 District.

- 5.2** Upon receiving a report from the Housing Committee on 1995 August 14 containing the above information, Council directed staff to initiate an area rezoning of the western sub-area of Garden Village, as outlined on *Sketch #3* of this report, from the R2 Residential District to the R10 Residential District. In order to proceed with the process initiated to limit the bulk of single-family dwellings in the area and to seek further input on rezoning to the R10 District, it is recommended that a rezoning bylaw be forwarded to the 1995 September 26 Public Hearing.

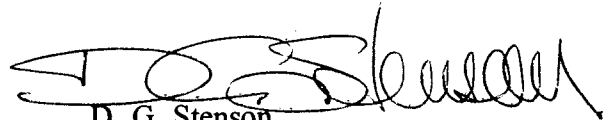

D. G. Stenson  
Director Planning and Building

BW/gk  
Attach  
cc: City Clerk  
Chief Building Inspector

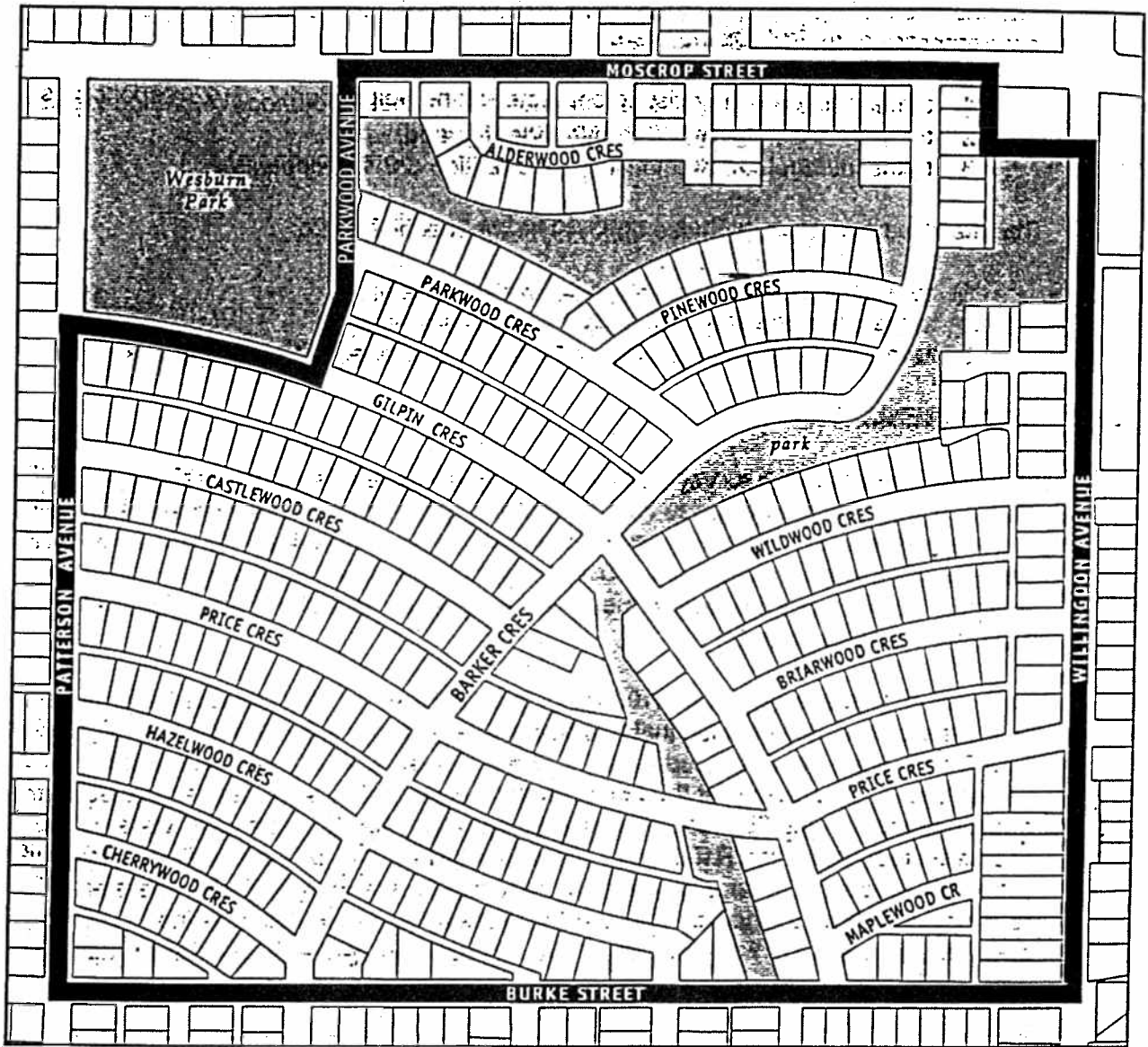

Garden Village Study Area



Sketch #1

| NORTHERN SUB-AREA                            |            |
|--|------------|
| Number of Lots                               | 34         |
| Number of owners responding to questionnaire | 28         |
| Rezone to R10?                               |            |
| yes  | 14 (50%)   |
| no   | 12 (42.9%) |
| undecided                                    | 2 (7.1%)   |

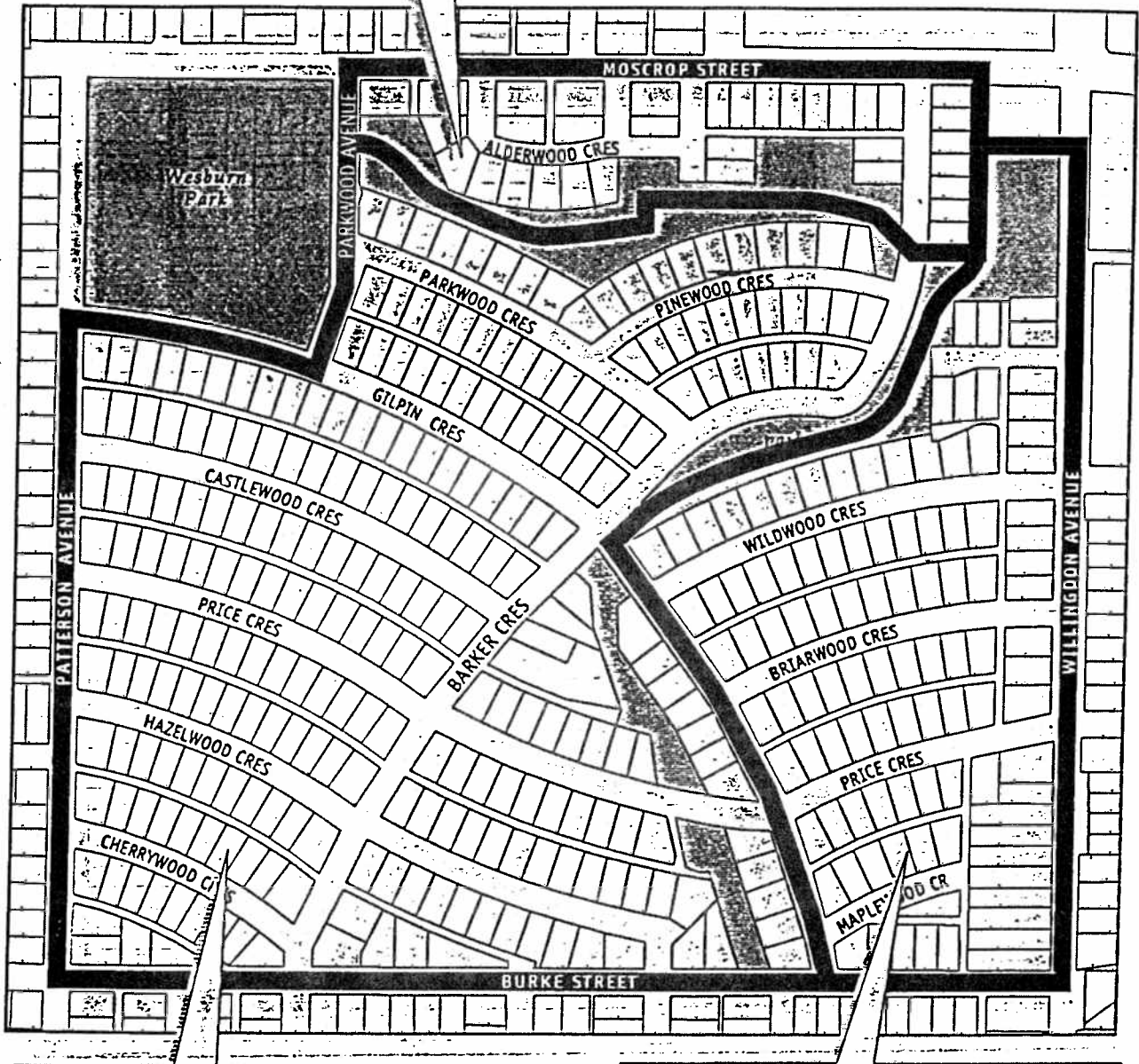

| WESTERN SUB-AREA                             |             |
|--|-------------|
| Area Proposed for Rezoning to R10            |             |
| Number of Lots                               | 259         |
| Number of owners responding to questionnaire | 222         |
| Rezone to R10?                               |             |
| yes  | 136 (61.3%) |
| no   | 78 (35.1%)  |
| undecided                                    | 8 (3.6%)    |

| EASTERN SUB-AREA                             |            |
|--|------------|
| Number of Lots                               | 103        |
| Number of owners responding to questionnaire | 81         |
| Rezone to R10?                               |            |
| yes  | 38 (46.9%) |
| no   | 41 (50.6%) |
| undecided                                    | 2 (2.5%)   |



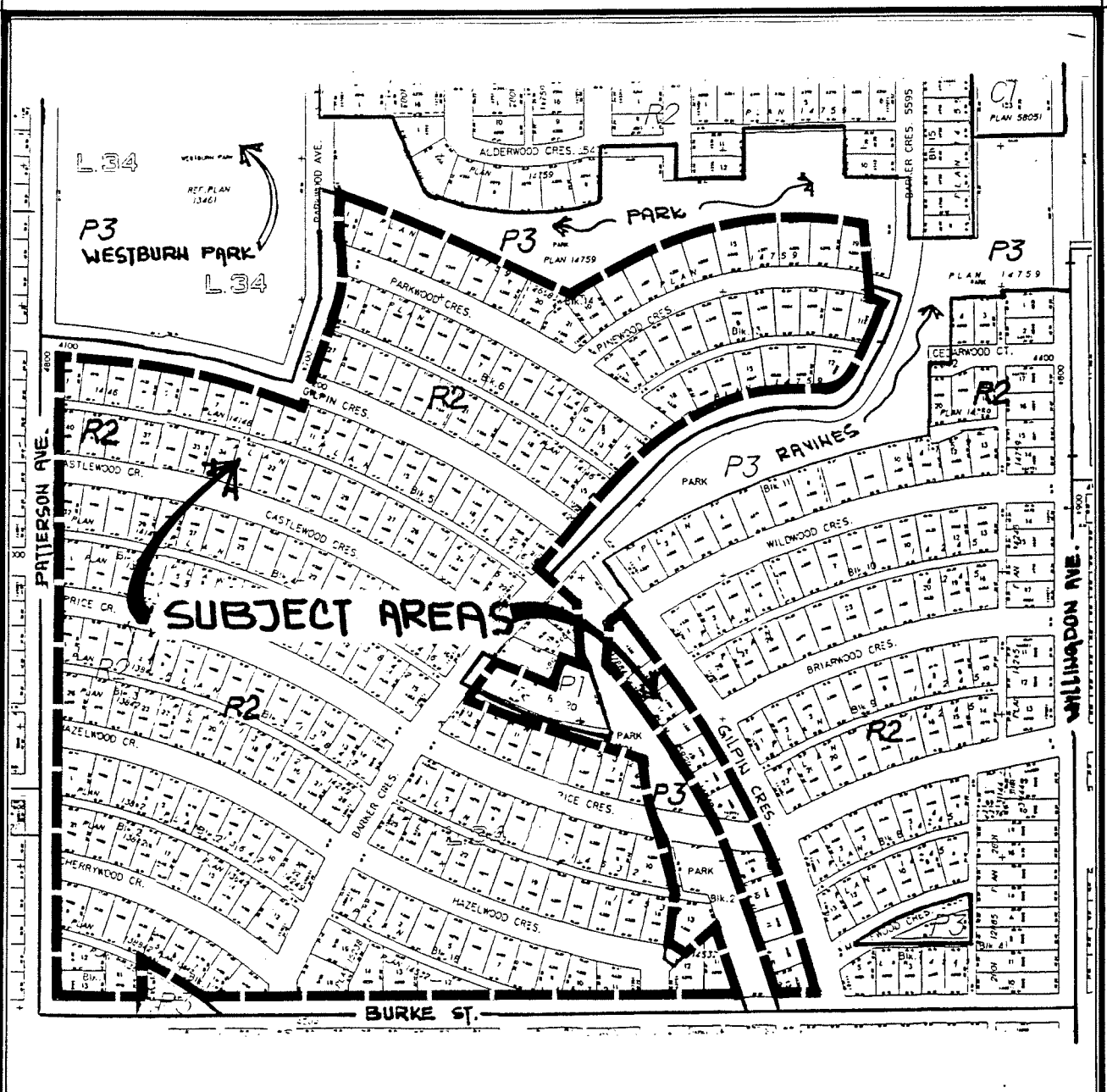

Date:  
 AUGUST 1995

Scale:  
 N.T.S.

Drawn By:  
 J.P.C.



Planning & Building Dept.



**REZONING REFERENCE # 32/95**

SKETCH # 3

**SCHEDULE "A"**  
**REZONING REFERENCE #32/95**

1. **4205 Parkwood Crescent**  
Lot 1, Blk 14, D.L. 34, Grp 1, NWD Plan 14759
2. **4206 Parkwood Crescent**  
Lot 1, Blk 6, D.L. 34, Grp 1, NWD Plan 14146
3. **4215 Parkwood Crescent**  
Lot 2, Blk 14, D.L. 34, Grp 1, NWD Plan 14759
4. **4216 Parkwood Crescent**  
Lot 2, Blk 6, D.L. 34, Grp 1, NWD Plan 14146
5. **4225 Parkwood Crescent**  
Lot 3, Blk 14, D.L. 34, Grp 1, NWD Plan 14759
6. **4228 Parkwood Crescent**  
Lot 3, Blk 6, D.L. 34, Grp 1, NWD Plan 14146
7. **4235 Parkwood Crescent**  
Lot 4, Blk 14, D.L. 34, Grp 1, NWD Plan 14759
8. **4236 Parkwood Crescent**  
Lot 4, Blk 6, D.L. 34, Grp 1, NWD Plan 14146
9. **4246 Parkwood Crescent**  
Lot 5, Blk 6, D.L. 34, Grp 1, NWD Plan 14146
10. **4247 Parkwood Crescent**  
Lot 5, Blk 14, D.L. 34, Grp 1, NWD Plan 14759
11. **4255 Parkwood Crescent**  
Lot 6, Blk 14, D.L. 34, Grp 1, NWD Plan 14759
12. **4258 Parkwood Crescent**  
Lot 6, Blk 6, D.L. 34, Grp 1, NWD Plan 14146
13. **4265 Parkwood Crescent**  
Lot 7, Blk 14, D.L. 34, Grp 1, NWD Plan 14759
14. **4266 Parkwood Crescent**  
Lot 7, Blk 6, D.L. 34, Grp 1, NWD Plan 14146
15. **4276 Parkwood Crescent**  
Lot 8, Blk 6, D.L. 34, Grp 1, NWD Plan 14146
16. **4277 Parkwood Crescent**  
Lot 20, D.L. 34, Grp 1, NWD Plan 26583
17. **4286 Parkwood Crescent**  
Lot 9, Blk 6, D.L. 34, Grp 1, NWD Plan 14146
18. **4295 Parkwood Crescent**  
Lot 21, D.L. 34, Grp 1, NWD Plan 26583
19. **4269 Parkwood Crescent**  
Lot 10, Blk 6, D.L. 34, Grp 1, NWD Plan 14146
20. **4306 Parkwood Crescent**  
Lot 11, Blk 6, D.L. 34, Grp 1, NWD Plan 14146
21. **4316 Parkwood Crescent**  
Lot 12, Blk 6, D.L. 34, Grp 1, NWD Plan 14146
22. **4326 Parkwood Crescent**  
Lot 13, Blk 6, D.L. 34, Grp 1, NWD Plan 14146
23. **4335 Parkwood Crescent**  
Lot 18, Blk 13, D.L. 34, Grp 1, NWD Plan 14759
24. **4305 Pinewood Crescent**  
Lot 10, Blk 14, D.L. 34, Grp 1, NWD Plan 14759
25. **4306 Pinewood Crescent**  
Lot 1, Blk 13, D.L. 34, Grp 1, NWD Plan 14759



Schedule "A"  
Rezoning Reference #32/95  
Page 2

26. **4313 Pinewood Crescent**  
Lot 11, Blk 14, D.L. 34, Grp 1, NWD Plan 14759
27. **4318 Pinewood Crescent**  
Lot 2, Blk 13, D.L. 34, Grp 1, NWD Plan 14759
28. **4321 Pinewood Crescent**  
Lot 12, Blk 14, D.L. 34, Grp 1, NWD Plan 14759
29. **4322 Pinewood Crescent**  
Lot 3, Blk 13, D.L. 34, Grp 1, NWD Plan 14759
30. **4331 Pinewood Crescent**  
Lot 13, Blk 14, D.L. 34, Grp 1, NWD Plan 14759
31. **4332 Pinewood Crescent**  
Lot 4, Blk 13, D.L. 34, Grp 1, NWD Plan 14759
32. **4339 Pinewood Crescent**  
Lot 14, Blk 14, D.L. 34, Grp 1, NWD Plan 14759
33. **4340 Pinewood Crescent**  
Lot 5, Blk 13, D.L. 34, Grp 1, NWD Plan 14759
34. **4349 Pinewood Crescent**  
Lot 15, Blk 14, D.L. 34, Grp 1, NWD Plan 14759
35. **4350 Pinewood Crescent**  
Lot 6, Blk 13, D.L. 34, Grp 1, NWD Plan 14759
36. **4357 Pinewood Crescent**  
Lot 16, Blk 14, D.L. 34, Grp 1, NWD Plan 14759
37. **4358 Pinewood Crescent**  
Lot 7, Blk 13, D.L. 34, Grp 1, NWD Plan 14759
38. **4364 Pinewood Crescent**  
Lot 8, Blk 13, D.L. 34, Grp 1, NWD Plan 14759
39. **4365 Pinewood Crescent**  
Lot 17, Blk 14, D.L. 34, Grp 1, NWD Plan 14759
40. **4375 Pinewood Crescent**  
Lot 18, Blk 14, D.L. 34, Grp 1, NWD Plan 14759
41. **4376 Pinewood Crescent**  
Lot 9, Blk 13, D.L. 34, Grp 1, NWD Plan 14759
42. **4383 Pinewood Crescent**  
Lot 19, Blk 14, D.L. 34, Grp 1, NWD Plan 14759
43. **4384 Pinewood Crescent**  
Lot 10, Blk 13, D.L. 34, Grp 1, NWD Plan 14759
44. **4106 Gilpin Crescent**  
Lot 1, Blk 5, D.L. 34, Grp 1, NWD Plan 14146
45. **4116 Gilpin Crescent**  
Lot 2, Blk 5, D.L. 34, Grp 1, NWD Plan 14146
46. **4126 Gilpin Crescent**  
Lot 3, Blk 5, D.L. 34, Grp 1, NWD Plan 14146
47. **4136 Gilpin Crescent**  
Lot 4, Blk 5, D.L. 34, Grp 1, NWD Plan 14146
48. **4146 Gilpin Crescent**  
Lot 5, Blk 5, D.L. 34, Grp 1, NWD Plan 14146
49. **4156 Gilpin Crescent**  
Lot 6, Blk 5, D.L. 34, Grp 1, NWD Plan 14146
50. **4166 Gilpin Crescent**  
Lot 7, Blk 5, D.L. 34, Grp 1, NWD Plan 14146

51. **4176 Gilpin Crescent**  
Lot 8, Blk 5, D.L. 34, Grp 1, NWD Plan 14146
52. **4186 Gilpin Crescent**  
Lot 9, Blk 5, D.L. 34, Grp 1, NWD Plan 14146
53. **4196 Gilpin Crescent**  
Lot 10, Blk 5, D.L. 34, Grp 1, NWD Plan 14146
54. **4205 Gilpin Crescent**  
Lot 27, Blk 6, D.L. 34, Grp 1, NWD Plan 14146
55. **4206 Gilpin Crescent**  
Lot 11, Blk 5, D.L. 34, Grp 1, NWD Plan 14146
56. **4213 Gilpin Crescent**  
Lot 26, Blk 6, D.L. 34, Grp 1, NWD Plan 14146
57. **4216 Gilpin Crescent**  
Lot 12, Blk 5, D.L. 34, Grp 1, NWD Plan 14146
58. **4221 Gilpin Crescent**  
Lot 25, Blk 6, D.L. 34, Grp 1, NWD Plan 14146
59. **4222 Gilpin Crescent**  
Lot 13, Blk 5, D.L. 34, Grp 1, NWD Plan 14146
60. **4229 Gilpin Crescent**  
Lot 24, Blk 6, D.L. 34, Grp 1, NWD Plan 14146
61. **4232 Gilpin Crescent**  
Lot 14, Blk 5, D.L. 34, Grp 1, NWD Plan 14146
62. **4237 Gilpin Crescent**  
Lot 23, Blk 6, D.L. 34, Grp 1, NWD Plan 14146
63. **4240 Gilpin Crescent**  
Lot 15, Blk 5, D.L. 34, Grp 1, NWD Plan 14146
64. **4241 Gilpin Crescent**  
Lot 22, Blk 6, D.L. 34, Grp 1, NWD Plan 14146
65. **4249 Gilpin Crescent**  
Lot 21, Blk 6, D.L. 34, Grp 1, NWD Plan 14146
66. **4250 Gilpin Crescent**  
Lot 16, Blk 5, D.L. 34, Grp 1, NWD Plan 14146
67. **4255 Gilpin Crescent**  
Lot 20, Blk 6, D.L. 34, Grp 1, NWD Plan 14146
68. **4258 Gilpin Crescent**  
Lot 17, Blk 5, D.L. 34, Grp 1, NWD Plan 14146
69. **4263 Gilpin Crescent**  
Lot 19, Blk 6, D.L. 34, Grp 1, NWD Plan 14146
70. **4266 Gilpin Crescent**  
Lot 18, Blk 5, D.L. 34, Grp 1, NWD Plan 14146
71. **4269 Gilpin Crescent**  
Lot 18, Blk 6, D.L. 34, Grp 1, NWD Plan 14146
72. **4276 Gilpin Crescent**  
Lot 19, Blk 5, D.L. 34, Grp 1, NWD Plan 14146
73. **4277 Gilpin Crescent**  
Lot 17, Blk 6, D.L. 34, Grp 1, NWD Plan 14146
74. **4285 Gilpin Crescent**  
Lot 16, Blk 6, D.L. 34, Grp 1, NWD Plan 14146
75. **4286 Gilpin Crescent**  
Lot 20, Blk 5, D.L. 34, Grp 1, NWD Plan 14146

76. **4296 Gilpin Crescent**  
Lot 21, Blk 5, D.L. 34, Grp 1, NWD Plan 14146
77. **4326 Gilpin Crescent**  
Lot 21 Except: Parcel "A" (Expl. Pl. 39913), D.L. 34, Grp 1, NWD Plan 17884
78. **4346 Gilpin Crescent**  
Parcel "A" (Expl. Pl. 39918), Lots 20 & 21, D.L. 34, Grp 1, NWD Plan 17884
79. **4356 Gilpin Crescent**  
Lot 17, D.L. 34, Grp 1, NWD Plan 15929
80. **4366 Gilpin Crescent**  
Lot 18, D.L. 34, Grp 1, NWD Plan 15929
81. **4376 Gilpin Crescent**  
Lot 19, D.L. 34, Grp 1, NWD Plan 15929
82. **4386 Gilpin Crescent**  
Lot 7, Blk 21, D.L. 34, Grp 1, NWD 14532
83. **4396 Gilpin Crescent**  
Lot 8, Blk 21, D.L. 34, Grp 1, NWD 14532
84. **4410 Gilpin Crescent**  
Lot 10, Blk 21, D.L. 34, Grp 1, NWD 14532
85. **4416 Gilpin Crescent**  
Lot 11, Blk 21, D.L. 34, Grp 1, NWD 14532
86. **4422 Gilpin Crescent**  
Lot 12, Blk 21, D.L. 34, Grp 1, NWD 14532
87. **4430 Gilpin Crescent**  
Lot 13, Blk 21, D.L. 34, Grp 1, NWD 14532
88. **4105 Castlewood Crescent**  
Lot 40, Blk 5, D.L. 34, Grp 1, NWD Plan 14146
89. **4108 Castlewood Crescent**  
Lot 32, Blk 4, D.L. 34, Grp 1, NWD Plan 14146
90. **4115 Castlewood Crescent**  
Lot 39, Blk 5, D.L. 34, Grp 1, NWD Plan 14146
91. **4120 Castlewood Crescent**  
Lot 31, Blk 4, D.L. 34, Grp 1, NWD Plan 14146
92. **4127 Castlewood Crescent**  
Lot 38, Blk 5, D.L. 34, Grp 1, NWD Plan 14146
93. **4132 Castlewood Crescent**  
Lot 30, Blk 4, D.L. 34, Grp 1, NWD Plan 14146
94. **4137 Castlewood Crescent**  
Lot 37, Blk 5, D.L. 34, Grp 1, NWD Plan 14146
95. **4140 Castlewood Crescent**  
Lot 29, Blk 4, D.L. 34, Grp 1, NWD Plan 14146
96. **4149 Castlewood Crescent**  
Lot 36, Blk 5, D.L. 34, Grp 1, NWD Plan 14146
97. **4156 Castlewood Crescent**  
Lot 28, Blk 4, D.L. 34, Grp 1, NWD Plan 14146
98. **4159 Castlewood Crescent**  
Lot 35, Blk 5, D.L. 34, Grp 1, NWD Plan 14146
99. **4168 Castlewood Crescent**  
Lot 27, Blk 4 D.L. 34, Grp 1, NWD Plan 14146
100. **4171 Castlewood Crescent**  
Lot 34, Blk 5, D.L. 34, Grp 1, NWD Plan 14146

101. **4180 Castlewood Crescent**  
Lot 26, Blk 4, D.L. 34, Grp 1, NWD Plan 14146
102. **4181 Castlewood Crescent**  
Lot 33, Blk 5, D.L. 34, Grp 1, NWD Plan 14146
103. **4192 Castlewood Crescent**  
Lot 25, Blk 4, D.L. 34, Grp 1, NWD Plan 14146
104. **4193 Castlewood Crescent**  
Lot 32, Blk 5, D.L. 34, Grp 1, NWD Plan 14146
105. **4202 Castlewood Crescent**  
Lot 24, Blk 4, D.L. 34, Grp 1, NWD Plan 14146
106. **4205 Castlewood Crescent**  
Lot 31, Blk 5, D.L. 34, Grp 1, NWD Plan 14146
107. **4213 Castlewood Crescent**  
Lot 30, Blk 5, D.L. 34, Grp 1, NWD Plan 14146
108. **4214 Castlewood Crescent**  
Lot 23, Blk 4, D.L. 34, Grp 1, NWD Plan 14146
109. **4222 Castlewood Crescent**  
Lot 22, Blk 4, D.L. 34, Grp 1, NWD Plan 14146
110. **4223 Castlewood Crescent**  
Lot 29, Blk 5, D.L. 34, Grp 1, NWD Plan 14146
111. **4228 Castlewood Crescent**  
Lot 21, Blk 4, D.L. 34, Grp 1, NWD Plan 14146
112. **4229 Castlewood Crescent**  
Lot 28, Blk 5, D.L. 34, Grp 1, NWD Plan 14146
113. **4236 Castlewood Crescent**  
Lot 20, Blk 4, D.L. 34, Grp 1, NWD Plan 14146
114. **4237 Castlewood Crescent**  
Lot 27, Blk 5, D.L. 34, Grp 1, NWD Plan 14146
115. **4242 Castlewood Crescent**  
Lot 19, Blk 4, D.L. 34, Grp 1, NWD Plan 14146
116. **4245 Castlewood Crescent**  
Lot 26, Blk 5, D.L. 34, Grp 1, NWD Plan 14146
117. **4252 Castlewood Crescent**  
Lot 18, Blk 4, D.L. 34, Grp 1, NWD Plan 14146
118. **4253 Castlewood Crescent**  
Lot 25, Blk 5, D.L. 34, Grp 1, NWD Plan 14146
119. **4256 Castlewood Crescent**  
Lot 17, Blk 4, D.L. 34, Grp 1, NWD Plan 14146
120. **4263 Castlewood Crescent**  
Lot 24, Blk 5, D.L. 34, Grp 1, NWD Plan 14146
121. **4268 Castlewood Crescent**  
Lot 16, Blk 4, D.L. 34, Grp 1, NWD Plan 14146
122. **4269 Castlewood Crescent**  
Lot 23, Blk 5, D.L. 34, Grp 1, NWD Plan 14146
123. **4277 Castlewood Crescent**  
Lot 22, Blk 5, D.L. 34, Grp 1, NWD Plan 14146
124. **4107 Price Crescent**  
Lot 1, Blk 4, D.L. 34, Grp 1, NWD Plan 13842
123. **4108 Price Crescent**  
Lot 1, Blk 3, D.L. 34, Grp 1, NWD Plan 13842

Schedule "A"

Rezoning Reference #32/95

Page 6

- 124. **4119 Price Crescent**  
Lot 2, Blk 4, D.L. 34, Grp 1, NWD Plan 13842
- 125. **4122 Price Crescent**  
Lot 2, Blk 3, D.L. 34, Grp 1, NWD Plan 13842
- 126. **4131 Price Crescent**  
Lot 3, Blk 4, D.L. 34, Grp 1, NWD Plan 13842
- 127. **4132 Price Crescent**  
Lot 3, Blk 3, D.L. 34, Grp 1, NWD Plan 13842
- 128. **4143 Price Crescent**  
Lot 4, Blk 4, D.L. 34, Grp 1, NWD Plan 13842
- 129. **4144 Price Crescent**  
Lot 4, Blk 3, D.L. 34, Grp 1, NWD Plan 13842
- 130. **4155 Price Crescent**  
Lot 5, Blk 4, D.L. 34, Grp 1, NWD Plan 13842
- 131. **4156 Price Crescent**  
Lot 5, Blk 3, D.L. 34, Grp 1, NWD Plan 13842
- 132. **4167 Price Crescent**  
Lot 6, Blk 4, D.L. 34, Grp 1, NWD Plan 13842
- 133. **4168 Price Crescent**  
Lot 6, Blk 3, D.L. 34, Grp 1, NWD Plan 13842
- 134. **4179 Price Crescent**  
Lot 7, Blk 4, D.L. 34, Grp 1, NWD Plan 13842
- 135. **4180 Price Crescent**  
Lot 7, Blk 3, D.L. 34, Grp 1, NWD Plan 13842
- 136. **4191 Price Crescent**  
Lot 8, Blk 4, D.L. 34, Grp 1, NWD Plan 13842
- 137. **4192 Price Crescent**  
Lot 8, Blk 3, D.L. 34, Grp 1, NWD Plan 13842
- 138. **4205 Price Crescent**  
Lot 9, Blk 4, D.L. 34, Grp 1, NWD Plan 13842
- 139. **4206 Price Crescent**  
Lot 9, Blk 3, D.L. 34, Grp 1, NWD Plan 13842
- 140. **4213 Price Crescent**  
Lot 10, Blk 4, D.L. 34, Grp 1, NWD Plan 13842
- 141. **4218 Price Crescent**  
Lot 10, Blk 3, D.L. 34, Grp 1, NWD Plan 13842
- 142. **4222 Price Crescent**  
Lot 11, Blk 3, D.L. 34, Grp 1, NWD Plan 13842
- 143. **4223 Price Crescent**  
Lot 11, Blk 4, D.L. 34, Grp 1, NWD Plan 13842
- 144. **4229 Price Crescent**  
Lot 12, Blk 4, D.L. 34, Grp 1, NWD Plan 13842
- 145. **4232 Price Crescent**  
Lot 12, Blk 3, D.L. 34, Grp 1, NWD Plan 13842
- 146. **4237 Price Crescent**  
Lot 13, Blk 4, D.L. 34, Grp 1, NWD Plan 13842
- 147. **4238 Price Crescent**  
Lot 13, Blk 3, D.L. 34, Grp 1, NWD Plan 13842
- 148. **4245 Price Crescent**  
Lot 14, Blk 4, D.L. 34, Grp 1, NWD Plan 13842

- 149.    **4253 Price Crescent**  
      Lot 15, Blk 4, D.L. 34, Grp 1, NWD Plan 13842
- 150.    **4260 Price Crescent**  
      Lot 2, Blk 19, D.L. 34, Grp 1, NWD Plan 14532
- 151.    **4263 Price Crescent**  
      Lot 13, Blk 20, D.L. 34, Grp 1, NWD Plan 14532
- 152.    **4269 Price Crescent**  
      Lot 12, Blk 20, D.L. 34, Grp 1, NWD Plan 14532
- 153.    **4272 Price Crescent**  
      Lot 3, Blk 19, D.L. 34, Grp 1, NWD Plan 14532
- 154.    **4277 Price Crescent**  
      Lot 11, Blk 20, D.L. 34, Grp 1, NWD Plan 14532
- 155.    **4278 Price Crescent**  
      Lot 4, Blk 19, D.L. 34, Grp 1, NWD Plan 14532
- 156.    **4285 Price Crescent**  
      Lot 10, Blk 20, D.L. 34, Grp 1, NWD Plan 14532
- 157.    **4286 Price Crescent**  
      Lot 5, Blk 19, D.L. 34, Grp 1, NWD Plan 14532
- 158.    **4293 Price Crescent**  
      Lot 9, Blk 20, D.L. 34, Grp 1, NWD Plan 14532
- 159.    **4294 Price Crescent**  
      Lot 6, Blk 19, D.L. 34, Grp 1, NWD Plan 14532
- 160.    **4307 Price Crescent**  
      Lot 8, Blk 20, D.L. 34, Grp 1, NWD Plan 14532
- 161.    **4310 Price Crescent**  
      Lot 7, Blk 19, D.L. 34, Grp 1, NWD Plan 14532
- 162.    **4321 Price Crescent**  
      Lot 7, Blk 20, D.L. 34, Grp 1, NWD Plan 14532
- 163.    **4322 Price Crescent**  
      Lot 8, Blk 19, D.L. 34, Grp 1, NWD Plan 14532
- 164.    **4333 Price Crescent**  
      Lot 6, Blk 20, D.L. 34, Grp 1, NWD Plan 14532
- 165.    **4334 Price Crescent**  
      Lot 9, Blk 19, D.L. 34, Grp 1, NWD Plan 14532
- 166.    **4346 Price Crescent**  
      Lot 10, Blk 19, D.L. 34, Grp 1, NWD Plan 14532
- 167.    **4376 Price Crescent**  
      Lot 9, Blk 21, D.L. 34, Grp 1, NWD Plan 14532
- 168.    **4107 Hazelwood Crescent**  
      Lot 26, Blk 3, D.L. 34, Grp 1, NWD Plan 13842
- 169.    **4108 Hazelwood Crescent**  
      Lot 1, Blk 2, D.L. 34, Grp 1, NWD Plan 13842
- 170.    **4119 Hazelwood Crescent**  
      Lot 25, Blk 3, D.L. 34, Grp 1, NWD Plan 13842
- 171.    **4122 Hazelwood Crescent**  
      Lot 2, Blk 2, D.L. 34, Grp 1, NWD Plan 13842
- 172.    **4131 Hazelwood Crescent**  
      Lot 24, Blk 3, D.L. 34, Grp 1, NWD Plan 13842
- 173.    **4136 Hazelwood Crescent**  
      Lot 3, Blk 2, D.L. 34, Grp 1, NWD Plan 13842

- 174.    **4143 Hazelwood Crescent**  
      Lot 23, Blk 3, D.L. 34, Grp 1, NWD Plan 13842
- 175.    **4152 Hazelwood Crescent**  
      Lot 4, Blk 2, D.L. 34, Grp 1, NWD Plan 13842
- 176.    **4155 Hazelwood Crescent**  
      Lot 22, Blk 3, D.L. 34, Grp 1, NWD Plan 13842
- 177.    **4164 Hazelwood Crescent**  
      Lot 5, Blk 2, D.L. 34, Grp 1, NWD Plan 13842
- 178.    **4167 Hazelwood Crescent**  
      Lot 21, Blk 3, D.L. 34, Grp 1, NWD Plan 13842
- 179.    **4178 Hazelwood Crescent**  
      Lot 6, Blk 2, D.L. 34, Grp 1, NWD Plan 13842
- 180.    **4179 Hazelwood Crescent**  
      Lot 20, Blk 3, D.L. 34, Grp 1, NWD Plan 13842
- 181.    **4191 Hazelwood Crescent**  
      Lot 19, Blk 3, D.L. 34, Grp 1, NWD Plan 13842
- 182.    **4192 Hazelwood Crescent**  
      Lot 7, Blk 2, D.L. 34, Grp 1, NWD Plan 13842
- 183.    **4205 Hazelwood Crescent**  
      Lot 18, Blk 3, D.L. 34, Grp 1, NWD Plan 13842
- 184.    **4206 Hazelwood Crescent**  
      Lot 8, Blk 2, D.L. 34, Grp 1, NWD Plan 13842
- 185.    **4213 Hazelwood Crescent**  
      Lot 17, Blk 3, D.L. 34, Grp 1, NWD Plan 13842
- 186.    **4214 Hazelwood Crescent**  
      Lot 9, Blk 2, D.L. 34, Grp 1, NWD Plan 13842
- 187.    **4221 Hazelwood Crescent**  
      Lot 16, Blk 3, D.L. 34, Grp 1, NWD Plan 13842
- 188.    **4222 Hazelwood Crescent**  
      Lot 10, Blk 2, D.L. 34, Grp 1, NWD Plan 13842
- 189.    **4229 Hazelwood Crescent**  
      Lot 27, D.L. 34, Grp 1, NWD Plan 14249
- 190.    **4232 Hazelwood Crescent**  
      Lot 22, D.L. 34, Grp 1, NWD Plan 14249
- 191.    **4237 Hazelwood Crescent**  
      Lot 28, D.L. 34, Grp 1, NWD Plan 14249
- 192.    **4242 Hazelwood Crescent**  
      Lot 1, Blk 18, D.L. 34, Grp 1, NWD Plan 14532
- 193.    **4245 Hazelwood Crescent**  
      Lot 25, Blk 19, D.L. 34, Grp 1, NWD Plan 14532
- 194.    **4252 Hazelwood Crescent**  
      Lot 2, Blk 18, D.L. 34, Grp 1, NWD Plan 14532
- 195.    **4253 Hazelwood Crescent**  
      Lot 24, Blk 19, D.L. 34, Grp 1, NWD Plan 14532
- 196.    **4260 Hazelwood Crescent**  
      Lot 3, Blk 18, D.L. 34, Grp 1, NWD Plan 14532
- 197.    **4263 Hazelwood Crescent**  
      Lot 23, Blk 18, D.L. 34, Grp 1, NWD Plan 14532
- 198.    **4266 Hazelwood Crescent**  
      Lot 4, Blk 18, D.L. 34, Grp 1, NWD Plan 14532

199. **4269 Hazelwood Crescent**  
Lot 22, Blk 19, D.L. 34, Grp 1, NWD Plan 14532
200. **4276 Hazelwood Crescent**  
Lot 5, Blk 18, D.L. 34, Grp 1, NWD Plan 14532
201. **4277 Hazelwood Crescent**  
Lot 21, Blk 19, D.L. 34, Grp 1, NWD Plan 14532
202. **4284 Hazelwood Crescent**  
Lot 6, Blk 18, D.L. 34, Grp 1, NWD Plan 14532
203. **4285 Hazelwood Crescent**  
Lot 20, Blk 19, D.L. 34, Grp 1, NWD Plan 14532
204. **4293 Hazelwood Crescent**  
Lot 19, Blk 19, D.L. 34, Grp 1, NWD Plan 14532
205. **4294 Hazelwood Crescent**  
Lot 7, Blk 18, D.L. 34, Grp 1, NWD Plan 14532
206. **4306 Hazelwood Crescent**  
Lot 8, Blk 18, D.L. 34, Grp 1, NWD Plan 14532
207. **4307 Hazelwood Crescent**  
Lot 18, Blk 19, D.L. 34, Grp 1, NWD Plan 14532
208. **4315 Hazelwood Crescent**  
Lot 17, Blk 19, D.L. 34, Grp 1, NWD Plan 14532
209. **4316 Hazelwood Crescent**  
Lot 9, Blk 18, D.L. 34, Grp 1, NWD Plan 14532
210. **4325 Hazelwood Crescent**  
Lot 16, Blk 19, D.L. 34, Grp 1, NWD Plan 14532
211. **4328 Hazelwood Crescent**  
Lot 10, Blk 18, D.L. 34, Grp 1, NWD Plan 14532
212. **4335 Hazelwood Crescent**  
Lot 15, Blk 19, D.L. 34, Grp 1, NWD Plan 14532
213. **4338 Hazelwood Crescent**  
Lot 11, Blk 18, D.L. 34, Grp 1, NWD Plan 14532
214. **4345 Hazelwood Crescent**  
Lot 14, Blk 19, D.L. 34, Grp 1, NWD Plan 14532
215. **4105 Cherrywood Crescent**  
Lot 21, Blk 2, D.L. 34, Grp 1, NWD Plan 13842
216. **4106 Cherrywood Crescent**  
Lot 1, Blk 1, D.L. 34, Grp 1, NWD Plan 13842
217. **4115 Cherrywood Crescent**  
Lot 20, Blk 2, D.L. 34, Grp 1, NWD Plan 13842
218. **4116 Cherrywood Crescent**  
Lot 2, Blk 1, D.L. 34, Grp 1, NWD Plan 13842
219. **4125 Cherrywood Crescent**  
Lot 19, Blk 2, D.L. 34, Grp 1, NWD Plan 13842
220. **4128 Cherrywood Crescent**  
Lot 3, Blk 1, D.L. 34, Grp 1, NWD Plan 13842
221. **4135 Cherrywood Crescent**  
Lot 18, Blk 2, D.L. 34, Grp 1, NWD Plan 13842
222. **4138 Cherrywood Crescent**  
Lot 4, Blk 1, D.L. 34, Grp 1, NWD Plan 13842
223. **4145 Cherrywood Crescent**  
Lot 17, Blk 2, D.L. 34, Grp 1, NWD Plan 13842



- 224. **4150 Cherrywood Crescent**  
Lot 5, Blk 1, D.L. 34, Grp 1, NWD Plan 13842
- 225. **4155 Cherrywood Crescent**  
Lot 16, Blk 2, D.L. 34, Grp 1, NWD Plan 13842
- 226. **4165 Cherrywood Crescent**  
Lot 15, Blk 2, D.L. 34, Grp 1, NWD Plan 13842
- 227. **4168 Cherrywood Crescent**  
Lot 6, Blk 1, D.L. 34, Grp 1, NWD Plan 13842
- 228. **4172 Cherrywood Crescent**  
Lot 7, Blk 1, D.L. 34, Grp 1, NWD Plan 13842
- 229. **4175 Cherrywood Crescent**  
Lot 14, Blk 2, D.L. 34, Grp 1, NWD Plan 13842
- 230. **4182 Cherrywood Crescent**  
Lot 14, D.L. 34, Grp 1, NWD Plan 14204
- 231. **4185 Cherrywood Crescent**  
Lot 13, Blk 2, D.L. 34, Grp 1, NWD Plan 13842
- 232. **4194 Cherrywood Crescent**  
Lot 15, D.L. 34, Grp 1, NWD Plan 14204
- 233. **4195 Cherrywood Crescent**  
Lot 12, Blk 2, D.L. 34, Grp 1, NWD Plan 13842
- 234. **4135 Burke Street**  
Lot 11, Blk 1, D.L. 34, Grp 1, NWD Plan 13842
- 235. **4229 Burke Street**  
Lot 14, Blk 18, D.L. 34, Grp 1, NWD Plan 14532
- 236. **4249 Burke Street**  
Lot 13, Blk 18, D.L. 34, Grp 1, NWD Plan 14532
- 237. **4271 Burke Street**  
Lot 12, Blk 18, D.L. 34, Grp 1, NWD Plan 14532
- 238. **4365 Burke Street**  
Lot 12, Blk 19, D.L. 34, Grp 1, NWD Plan 14532
- 239. **4375 Burke Street**  
Lot 11, Blk 19, D.L. 34, Grp 1, NWD Plan 14532
- 240. **5178 Patterson Avenue**  
Lot 12, Blk 1, D.L. 34, Grp 1, NWD Plan 13842
- 241. **5192 Patterson Avenue**  
Lot 13, Blk 1, D.L. 34, Grp 1, NWD Plan 13842
- 242. **4815 Barker Crescent**  
Lot 11, Blk 13, D.L. 34, Grp 1, NWD Plan 14759
- 243. **4825 Barker Crescent**  
Lot 12, Blk 13, D.L. 34, Grp 1, NWD Plan 14759
- 244. **4833 Barker Crescent**  
Lot 13, Blk 13, D.L. 34, Grp 1, NWD Plan 14759
- 245. **4839 Barker Crescent**  
Lot 14, Blk 13, D.L. 34, Grp 1, NWD Plan 14759
- 246. **4847 Barker Crescent**  
Lot 15, Blk 13, D.L. 34, Grp 1, NWD Plan 14759
- 247. **4853 Barker Crescent**  
Lot 16, Blk 13, D.L. 34, Grp 1, NWD Plan 14759
- 248. **4861 Barker Crescent**  
Lot 17, Blk 13, D.L. 34, Grp 1, NWD Plan 14759

- 249. **4881 Barker Crescent**  
Lot 14, Blk 6, D.L. 34, Grp 1, NWD Plan 14146
- 250. **4891 Barker Crescent**  
Lot 15, Blk 6, D.L. 34, Grp 1, NWD Plan 14146
- 251. **4930 Barker Crescent**  
Lot 75, D.L. 34, Grp 1, NWD Plan 34642
- 252. **4936 Barker Crescent**  
Lot 76, D.L. 34, Grp 1, NWD Plan 34642
- 253. **4942 Barker Crescent**  
Lot 73, D.L. 34, Grp 1, NWD Plan 31689
- 254. **5044 Barker Crescent**  
Lot 1, Blk 19, D.L. 34, Grp 1, NWD Plan 14532
- 255. **5045 Barker Crescent**  
Lot 14, Blk 3, D.L. 34, Grp 1, NWD Plan 13842
- 256. **5150 Barker Crescent**  
Lot 19, D.L. 34, Grp 1, NWD Plan 15238
- 257. **5190 Barker Crescent**  
Lot 18, D.L. 34, Grp 1, NWD Plan 15238