

ITEM	2
MANAGER'S REPORT NO.	2
COUNCIL MEETING	95/01/16

TO: CITY MANAGER

DATE: 1995 01 10

FROM: DIRECTOR ENGINEERING

FILE: 41-05-08

SUBJECT: CAPITOL HILL SANITARY SEWER SYSTEM

PURPOSE: To respond to a petition presented by a group of residents in the Capitol Hill area requesting the installation of sanitary sewers to serve their properties.

RECOMMENDATION:

1. THAT a copy of this report be sent to each petitioner.

REPORT

Appearing elsewhere in this agenda is correspondence from four citizens on North Glynde Avenue petitioning sanitary sewer service to each of their properties.

Council, at its meeting of 1992 May 25, received a report from the Environment & Waste Management Committee detailing the need to provide sanitary sewer service to 42 properties on the north west part of Capitol Hill (see attached sketch). The report encompassed the four properties identified in the current petition.

Although the report identified several options for sewer servicing, Council adopted a preliminary concept based on a conventional gravity sewer system and authorized detailed design of the project.

Subsequently, at its meeting of 1993 June 14, Council received a further report from the Environment & Waste Management Committee and adopted a two phase approach to the sewer construction program. Phase I was constructed 1993/94. Phase II, which includes the four properties under petition, was included as part of the City's application for Federal/Provincial Infrastructure Renewal Program funding.

ITEM	2
MANAGER'S REPORT NO.	2
COUNCIL MEETING	95/01/16

The City received notification in 1994 November that its application for infrastructure funding had been approved. This project has been included in the 1995 Provisional Capital Budget. It is anticipated that Phase II construction will commence in 1995.

As stated previously, the sewer design is predicated on a gravity system concept which is the most common and cost effective method of sewer servicing where sufficient grades exist for gravity flow. Due to the steep topography of Capitol Hill, acquisition of easements through private property is necessary in some locations to provide gravity outfalls.

Staff are currently negotiating all necessary easements to provide sewer service to the properties encompassed within the Phase II area. In the event that the City is unsuccessful in securing all easements, staff will investigate alternative design concepts to provide a sanitary sewer collection system for all unserved properties on Capitol Hill.

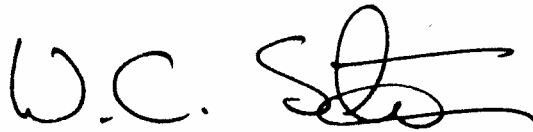
DIRECTOR ENGINEERING

WCS:jb
Attach.

cc: Director Finance

ITEM	2
MANAGER'S REPORT NO.	2
COUNCIL MEETING	95/01/16

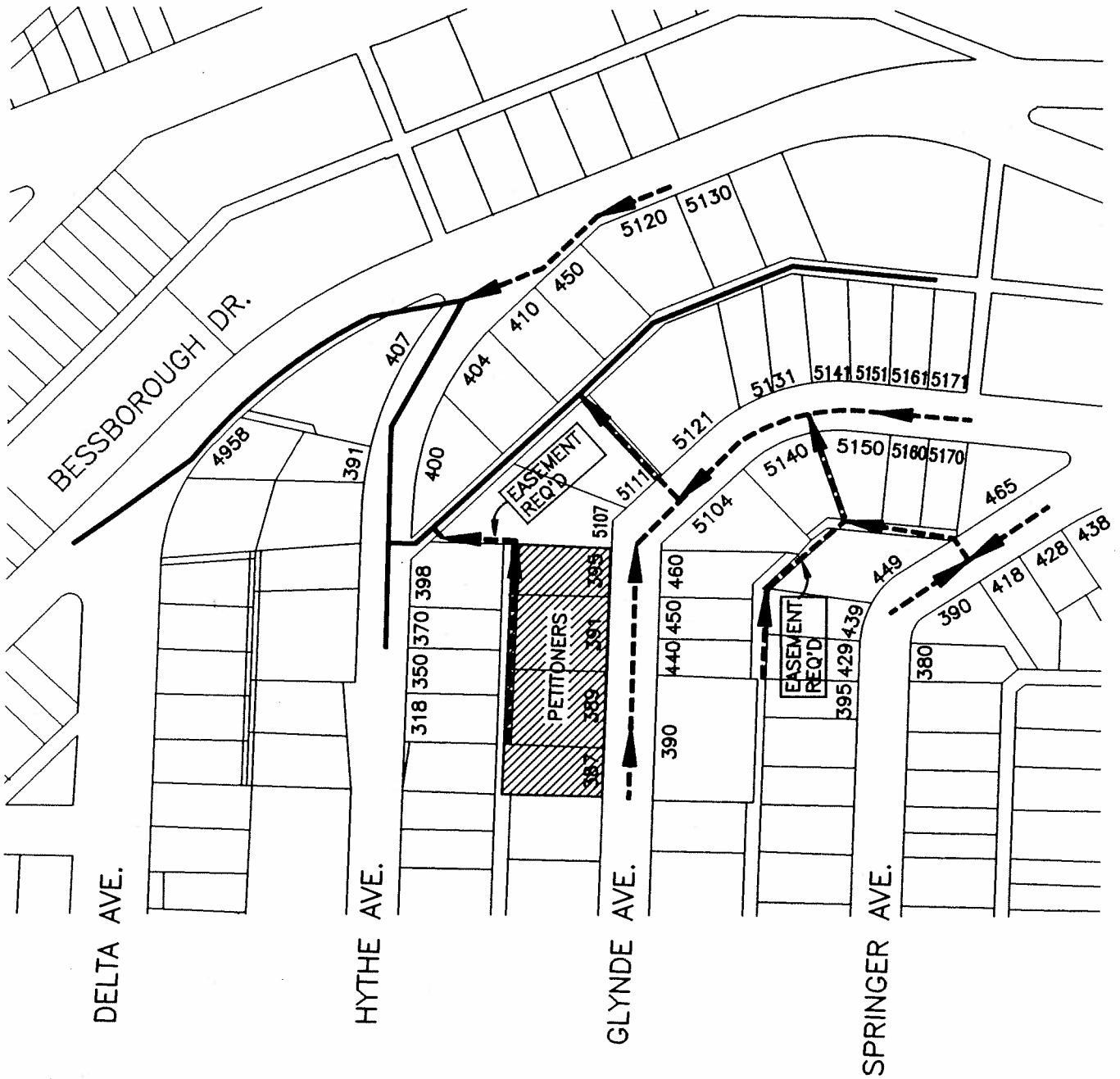
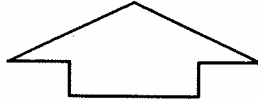

————— PHASE I (COMPLETED IN 1993)
 - - - - - PHASE II (CONSTRUCTION 1995)

NO.	DATE	REVISION



CAPITOL HILL
SANITARY SEWER AREA 110

DRAWN BY: H.LOUIE	SCALE: N.T.S.	A 337
APPR'V'D BY:	DATE: 95-01-11	

