

ITEM	6
MANAGER'S REPORT NO.	32
COUNCIL MEETING	94/05/16

TO: CITY MANAGER 1994 MAY 12

FROM: DIRECTOR PLANNING AND BUILDING

SUBJECT: TREE PRESERVATION AT 6950 HASTINGS STREET

PURPOSE: To respond to a letter from Janice E. Bobic regarding the preservation of trees on the City-owned property at 6950 Hastings Street.

RECOMMENDATION:

1. THAT Janice E. Bobic of 990 Cliff Avenue, Burnaby, V5A 2J5 be sent a copy of this report.

R E P O R T

1.0 BACKGROUND

At the regular Council meeting 1994 May 02 a letter was received from Janice Bobic requesting that existing trees on the City-owned property at 6950 Hastings Street be retained.

The letter also provided information regarding the history of the property which had been owned by her parents from 1944 to 1963. Ms. Bobic indicated that her father had planted a number of trees and shrubs on the property during that time and specifically referred to a 50 year old walnut tree that is of special interest and value for preservation.

As indicated on the attached Sketch, the subject site is adjacent to the Westridge School/Park and is partially treed. The treed areas consist primarily of native alder, poplar and associated understory vegetation. In addition there are a variety of ornamental trees and fruit trees located in the vicinity of the former home as referred to in the letter. The walnut tree described in the letter is approximately 50 feet in height, 33 inches in trunk diameter, and appears to be in good health.

The subject property is not currently designated as a park however the intended use of the site is for green space associated with the development of an urban trail through this area. This use supports the desire to preserve the amenity value of the existing treed areas on the site.

2.0 DEMOLITION OF CITY OWNED BUILDINGS

The house and outbuildings on site were demolished in 1993 December. Various small trees and shrubs which were growing in very close proximity to the building foundations were also removed to facilitate the demolition work. Also at that time, repairs to a damaged underground pipeline (located on easement crossing the site) were carried out which have resulted in further impact to some existing vegetation along the pipeline easement on City property.

To complete the building demolition work, the excavated area would need to be backfilled and several unsafe smaller trees close to the excavation would be removed in the process. During the course of the required cleanup work, the placement of temporary fencing will be made to protect the walnut tree and other significant vegetation located outside the disturbed area.

3.0 IMPACTS OF PROPOSED SITE DEVELOPMENT

Planned urban trail developments on the site include a feature rest stop area adjacent Cliff Avenue and a trail connection between Cliff Avenue and Invergarry Avenue. These developments will be located in existing open areas and thus will not affect existing trees. Additional trees will be planted as a component of the urban trail improvements.

A pedestrian/cyclist overpass is planned for the site to cross over Hastings Street at Invergarry Avenue. This will have some impact on existing trees due to the space required for construction of the proposed spiral access ramp structure to be located generally within the open area created by the removal of the house, out-buildings and former driveway on the subject site. This concept minimizes the impact on existing trees and will provide for functional access to both Westridge School and the urban trail.

The Ministry of Transportation and Highways' Barnet/Hastings project requires widening of Hastings Street and development of a new sidewalk fronting the site. This will have some impact on trees on the north edge of the existing wooded area of the site but does not appear to require removal of the walnut tree which will remain on City property.

TREE RETENTION
6950 HASTINGS STREET
1994 MAY 12 - PAGE 3

ITEM	6
MANAGER'S REPORT NO.	32
COUNCIL MEETING	94/05/16

To minimize the impact of the proposed overpass, road widening and sidewalk projects on the existing treed areas, a tree survey will be prepared for the site. The survey will identify and locate the significant trees on site for coordination with the detailed design of the proposed development projects. While it is recognised that some trees may be affected by these projects, staff will require contractors to take reasonable measures as necessary to retain and protect significant trees (including the walnut tree) during the construction of these proposed site developments.

4.0 SUMMARY

In summary, the existing treed areas at 6950 Hastings Street are recognized as a valuable amenity that will enhance the character of the urban trail and increase the enjoyment of those using the trail and related facilities at this location.

Staff will initiate measures as outlined in this report to protect the walnut tree and other significant trees at 6950 Hastings Street which can be reasonably retained in conjunction with the various works associated with development of this site.

Staff has contacted Janice Bobic to discuss the preservation of existing trees on the site and have informed her of the proposed actions outlined in this report. It is recommended that a copy of this report be forwarded to Ms. Bobic for information.



D. G. STENSON
DIRECTOR
PLANNING AND BUILDING

KR/lf
Attachment

cc: Director Engineering
Chief Environmental Health Officer
Director Recreation & Cultural Services
City Solicitor

ITEM	6
MANAGER'S REPORT NO.	32
COUNCIL MEETING	94/05/16

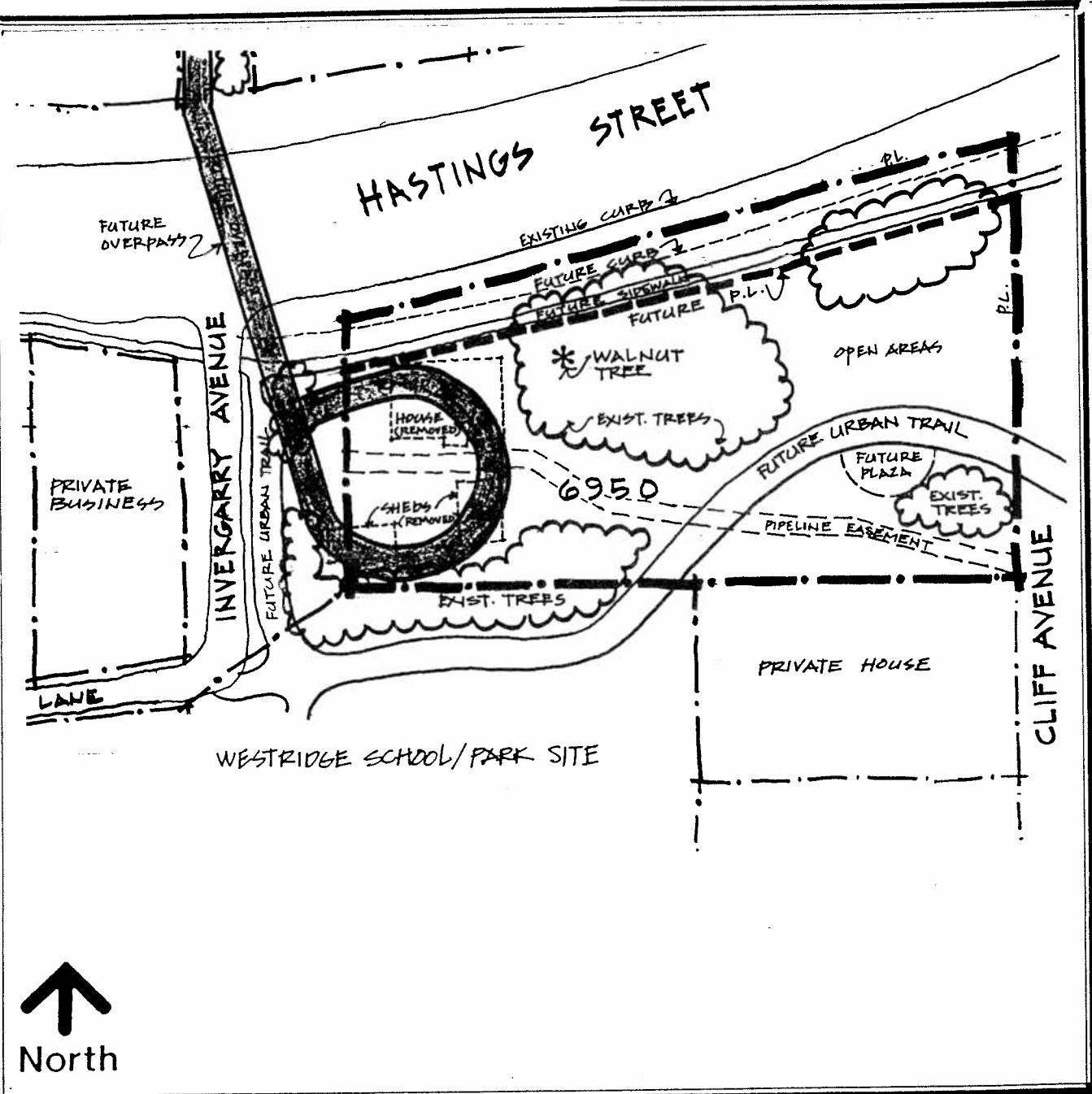

Date: 94 May 11

Scale: NTS
PLAN

Drawn By: KR

SKETCH

City of
Burnaby
Planning & Building Dept.

6950 HASTINGS STREET
- SHOWING PROPOSED FUTURE DEVELOPMENTS