

TO: MUNICIPAL MANAGER 1990 November 20

FROM: DIRECTOR PLANNING & BUILDING INSPECTION Our file: 15.312.1

SUBJECT: INFORMATION ON DEVELOPMENT PLAN CONCEPT RELATED TO
SOUTH-WEST CORNER OF ROYAL OAK AVENUE AND DOVER STREET
METROTOWN - AREA 5

PURPOSE: To provide Council with requested background information on lands at the south-west corner of Royal Oak Avenue and Dover Street.

=====

RECOMMENDATION:

1. THAT this report be received for information purposes.

R E P O R T

At its meeting of 1990 August 13, Council requested that staff provide background information on the Development Plan Concept previously approved, in principle, by Council related to lands at the south-west corner of Royal Oak Avenue and Dover Street. The request arose out of Council's consideration of the proposed acquisition of property at 5116 Dover Street for the purposes of road upgrading and widening and intersection channelization of Dover Street west of Royal Oak Avenue as it relates to the Metrotown core-related road system.

The proposed acquisition of property along this stretch of Dover Street also assists in achieving the Development Plan Concept approved in principle by Council on 1986 June 09. A copy of the concept plan (Sketch 6) is attached for the information of Council. The Development Plan Concept is compatible with and supportive of the Urban Trail System for Burnaby in the vicinity of the Royal Oak Avenue and Dover Street intersection, which was recently approved in principle by Council on 1990 June 18.

This is for the information of Council.



A. L. Parr
DIRECTOR PLANNING &
BUILDING INSPECTION

KI:lf

Attachment

11-L-M
 MANAGER'S REPORT NO. 20
 COUNCIL MEETING 37
 60/90/98

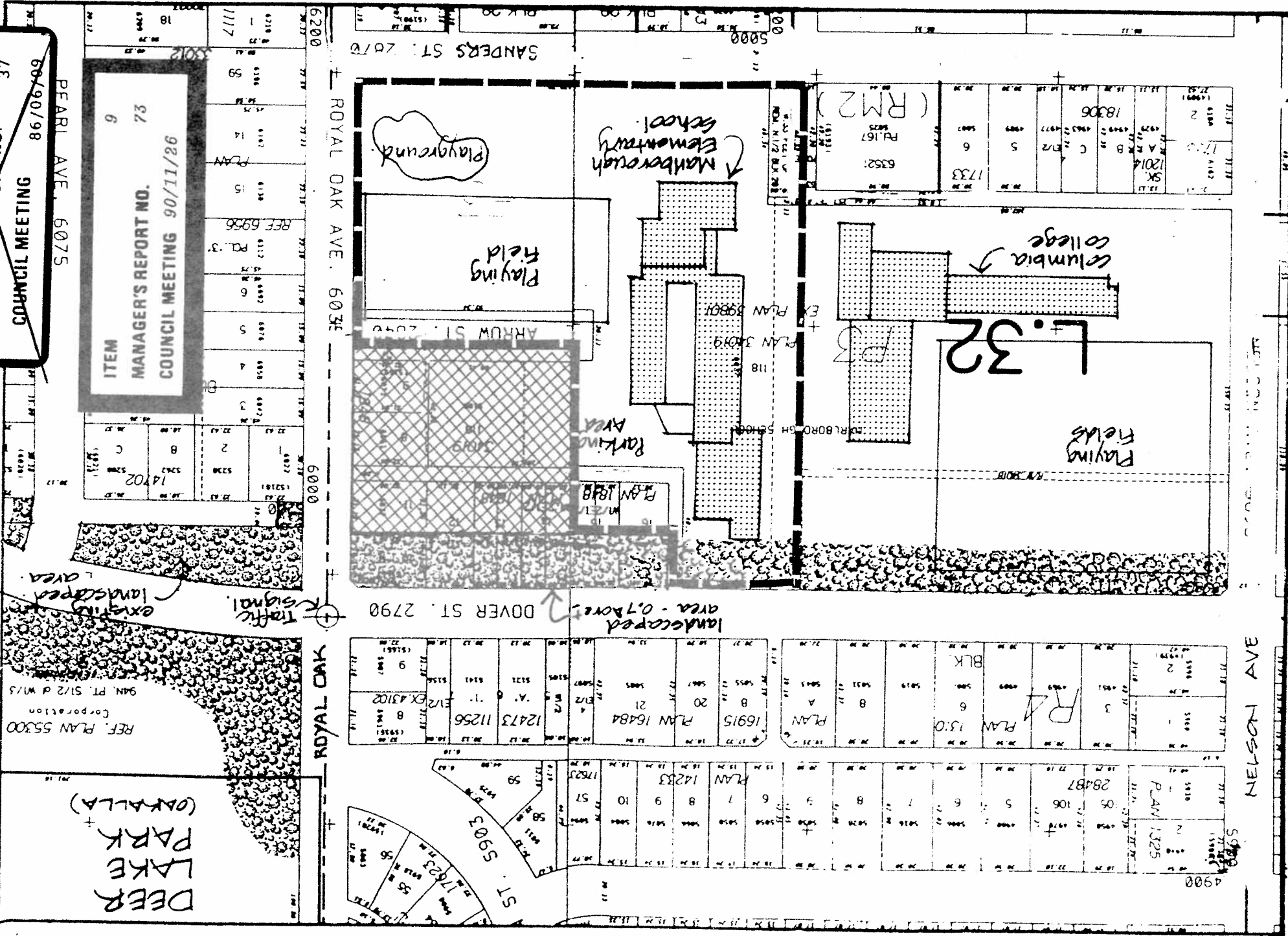
ITEM 9
 MANAGER'S REPORT NO. 73
 COUNCIL MEETING 90/11/26



Date
 APR. 1986
 Scale
 1 : 2000
 Drawn By

SKETCH 6
 Burnaby Planning Department
 Possible Development Alternative
 South-west corner of Dover/Royal Oak. ← NORTH
 Possible CD (RM2)
 2.2 Acres ±
 Monborough School Site
 (Possible revised configuration)