

ITEM 22
MANAGER'S REPORT NO. 40
COUNCIL MEETING 90/06/11

RE: ROAD CLOSURE REFERENCE NO. 13/89
LANE ALLOWANCE NORTH OF 7037 CANADA WAY

MUNICIPAL MANAGER'S RECOMMENDATION:

1. THAT the recommendation of the Approving Officer be adopted.

* * * * *

TO: MUNICIPAL MANAGER 1990 June 06
FROM: APPROVING OFFICER
SUBJECT: ROAD CLOSURE REFERENCE #13/89
LANE ALLOWANCE NORTH OF 7037 CANADA WAY
PURPOSE: To request Council authority to close and sell a redundant lane allowance.

RECOMMENDATION:

1. THAT Council authorize the closure and sale of the subject lane allowance, subject to the conditions outlined in this report.

R E P O R T

1.0 BACKGROUND:

As a result of an enquiry from the owner of 7037 Canada Way, the Planning & Building Inspection Department reviewed the existing 10 foot lane allowance north of their lot (see attached sketch). The allowance is undeveloped and is considered to be redundant for lane use.

Reports of the proposed closure were circulated to the various agencies having an interest in the subject lane. There are no utilities that will be affected by the proposed closure. There are, however, a number of mature evergreen trees located within the closure area and staff are currently investigating means whereby these trees may be protected.

2.0 CURRENT SITUATION:

When all reports were received, the Planning & Building Inspection Department sent a letter to the owner of 7037 Canada Way stating that the proposed closure would be contingent upon completion of the following conditions:

1. Consolidation of the allowance with 7037 Canada Way.
2. Payment of compensation to the Corporation in the amount of \$5.50 per square foot for the area being closed. This does not include the required property purchase tax.
3. Submission of all necessary road closing bylaw plans and consolidation plans to our department.
4. Execution of all necessary documents involved with the closure and transfer.
5. Payment of all legal and survey costs by the applicant.

ITEM	22
MANAGER'S REPORT NO.	40
COUNCIL MEETING	90/06/11

The Planning & Building Inspection Department has received the owner's written concurrence with the above conditions.

177

AD:hr
Att.
cc: Municipal Solicitor
Director Engineering



A. L. Parr
APPROVING OFFICER

ITEM 22
 MANAGER'S REPORT NO. 40
 COUNCIL MEETING 90/06/11

R.C. REF. # 13/89

D.L. 30

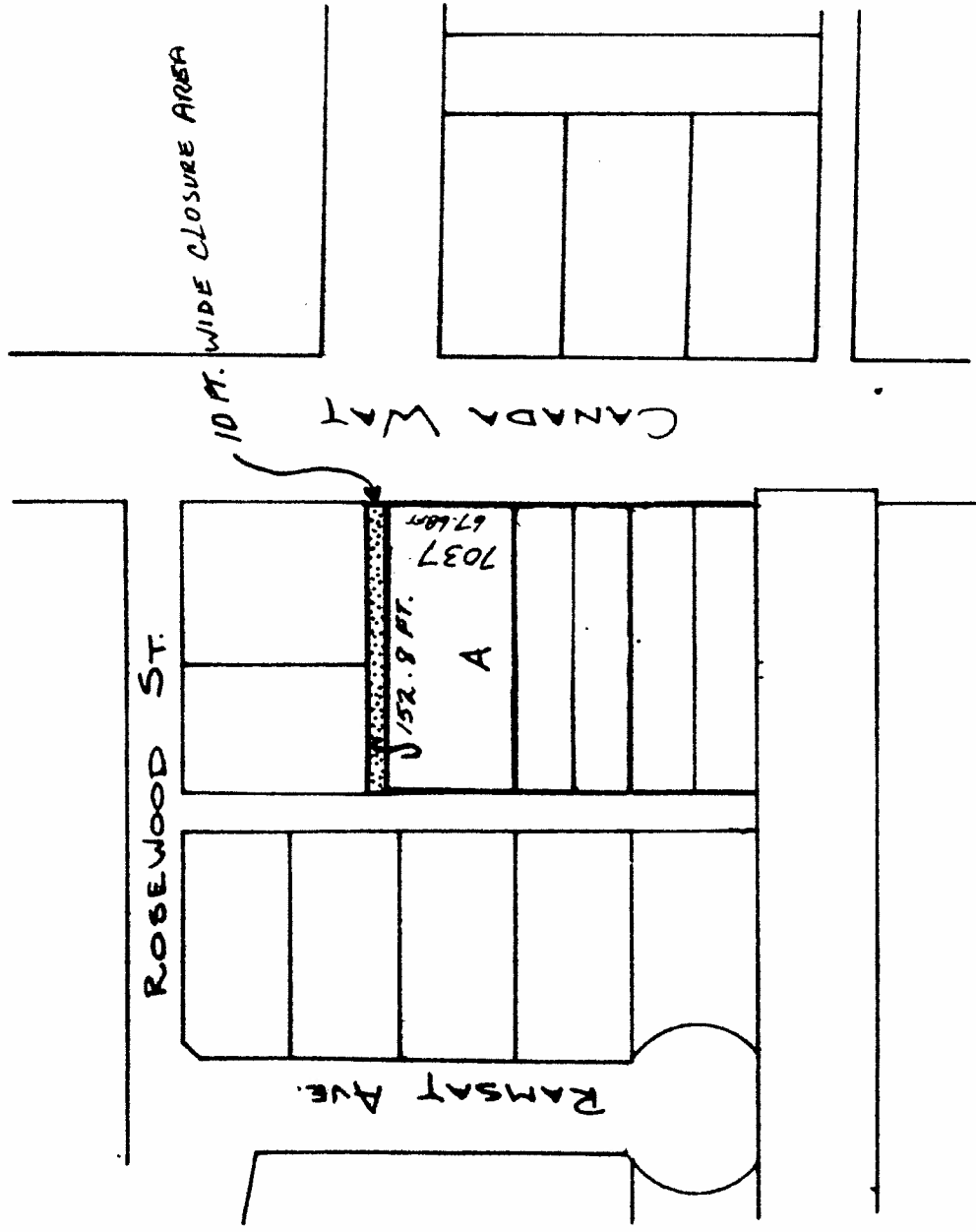
ZONE: R5



LANE CLOSURE AREA

(SOUTH OF ROSEWOOD ST.
 AND WEST OF CANADA WAY)

SCALE - 1:1000
 1989 APRIL AD.

