

ITEM 16
MANAGER'S REPORT NO. 34
COUNCIL MEETING 89/05/08

RE: CRIME PREVENTION EFFORTS IN THE KINGSWAY/EDMONDS AREA

ACTING MUNICIPAL MANAGER'S RECOMMENDATION:

1. THAT the recommendation of the Director Planning & Building Inspection be adopted.

* * * * *

TO: ACTING MUNICIPAL MANAGER 1989 MAY 02

FROM: DIRECTOR PLANNING & BUILDING INSPECTION Our File: 17.901

SUBJECT: CRIME PREVENTION EFFORTS IN THE KINGSWAY/EDMONDS AREA

PURPOSE: The purpose of this report is to respond to a request from Council to provide information on the possibility of implementing Crime Prevention Through Environmental Design (C.P.T.E.D.) techniques in the Kingsway/Edmonds area to discourage criminal activity.

=====

RECOMMENDATION:

1. THAT this report be received and referred to the Crime Prevention Committee for information purposes.

REPORT

1.0 BACKGROUND

At its meeting of 1989 April 10, Municipal Council adopted the following motion:

"THAT staff prepare a report on the possibility of implementing 'Crime Prevention Through Environmental Design' techniques in the Edmonds area to discourage criminal activity."

The motion was precipitated by the increasing criminal activity and nuisance behaviour being reported in the Kingsway/Edmonds area - particularly in the vicinity of the Corners commercial complex at the northeast corner of Kingsway and Edmonds.

This report responds to Council's motion, presenting information on Crime Prevention Through Environmental Design (C.P.T.E.D.) techniques that have been employed in the Kingsway/Edmonds area. The report also identifies other non-design actions being undertaken by the R.C.M.P. to reduce crime in the area. It concludes that the combination of C.P.T.E.D. and police activities employed to date appear to have been effective in reducing criminal activity in Kingsway/Edmonds, but that the problems could re-emerge in other areas if positive alternatives are not provided for the youths and young adults frequenting Kingsway/Edmonds.

2.0 CRIME PREVENTION THROUGH ENVIRONMENTAL DESIGN (C.P.T.E.D.) ACTIONS

2.1 The Corners Commercial Complex

The Corners commercial complex at the northeast corner of Kingsway and Edmonds contains a 7-11 convenience store, a Baskin-Robbins ice cream parlour, a dry cleaner, and a donut shop. For several months, the complex had been known to the R.C.M.P. and local community as one of Burnaby's prime "hot spots" for youths and young adults to congregate. According to the R.C.M.P., the youths and young adults were creating a nuisance and intimidating customers by their presence. Also, several had been apprehended on drug-related charges.

A particular concern was the passageway running between the shops (see Figure 1 attached). The passageway was concealed from the street and provided a discreet place for drug deals to take place.

Steel gates were recently installed to prevent access to the passageway. The R.C.M.P. believe this C.P.T.E.D. or "target hardening" measure, in conjunction with increased police activity, has been an effective deterrent to criminal activity in the Corners complex. After the gates were installed, the R.C.M.P. report that the youths and young adults moved to other locations (e.g. the Middlegate Mall/McDonalds/Pac's Confectionery section of Kingsway, Richmond Park, "Alligator Alley", and other areas of Burnaby).

2.2 "Alligator Alley"

Another youth "hangout" which was causing problems for local merchants, residents, and the R.C.M.P. was a site situated behind the commercial buildings at the corner of Kingsway and Edmonds. The site is known as "Alligator Alley" (see Figure 2 attached). Prior to two weeks ago, it had trees and brush which provided cover and hiding places for the youths (similar to the passageway at the Corners complex). It was also impenetrable by police vehicles.

The owner of the property began clearing the site in mid-April. This clearing activity has had two results. First, it has made "Alligator Alley" less attractive to youths. According to the R.C.M.P. and others contacted by staff, the youths who frequented the site have since moved elsewhere - as they did after the steel gates were installed at the Corners complex. Second, the clearing activity has made "Alligator Alley" more accessible to the R.C.M.P. The R.C.M.P. are now able to drive their cars through the area, which has improved their ability to conduct routine patrols and, when necessary, pursue offenders trying to escape on foot.

2.3 Future Plan Review

Planning & Building Inspection staff are conscious of the potential benefits of encouraging potential inclusion of C.P.T.E.D. principles in future developments in Kingsway/Edmonds and other areas of Burnaby. To this end, staff will consider the crime prevention aspects of new development proposals, consulting with the R.C.M.P. as necessary.

3.0 POLICE PATROLS

The R.C.M.P. regard Kingsway/Edmonds as the top priority area in Burnaby for police activity. To this end, the R.C.M.P. have been allocating extensive manpower resources to the area. In the last two weeks of April, the force assigned eleven members to Kingsway/Edmonds. During this period, twenty-four drug and two criminal code charges were laid. As well, eleven sets of drugs were found and over 400 people were checked.

ITEM	16
MANAGER'S REPORT NO.	34
COUNCIL MEETING	89/05/08

The R.C.M.P. report that their increased presence and activity has reduced the criminal activity in Kingsway/Edmonds dramatically. For example, in the first week of their two-week blitz of the area, the police laid twenty drug charges. In the second week, they laid only four.

The R.C.M.P. are currently assigning four members to patrol Kingsway/Edmonds. All plainclothes officers have also been instructed to pass through the area during their shifts. The R.C.M.P. intend to maintain a high profile in Kingsway/Edmonds to ensure that the area does not re-emerge as a "hot spot" for criminal activity.

4.0 DISPLACEMENT

As noted, after C.P.T.E.D. measures were introduced at the Corners complex and "Alligator Alley", and police pressure was increased, the youths and young adults who had frequented those places moved to other locations. Initially, many moved westward along Kingsway, to the vicinity of McDonalds Restaurant, Pac's Confectionery, and Middlegate Mall. With continued pressure from the police however, most of the "problem" youths and young adults have either moved out of the Kingsway/Edmonds area altogether, or have decided to maintain a low profile for awhile. The R.C.M.P. do not know where these people have or will move, but are committed to addressing any "transplanted" criminal activity when and where it emerges.

5.0 CONCLUSION

The combination of C.P.T.E.D. measures and increased police activity in Kingsway/Edmonds appears, for the time being, to have been successful in reducing criminal activity and nuisance behaviour in the area.

Despite this apparent success however, two cautions should be noted. First, the C.P.T.E.D. measures and police activity may improve the situation in Kingsway/Edmonds, but they will not necessarily improve the situation in Burnaby or the region as a whole. As noted, the criminal activity in Kingsway/Edmonds may be displaced or "transplanted" to other areas of the municipality.

Second, the C.P.T.E.D. measures and police activities address the symptoms of the youth/young adult problem, not the underlying causes (e.g. boredom, peer pressure, unemployment, family difficulties). Unless positive alternatives are provided for the youths and young adults, the chances of the C.P.T.E.D. measures and police activities succeeding will be diminished. Staff are optimistic that the Burnaby Youth Services Review, which is nearing completion at the time of this writing, will recommend strategies for developing such alternatives. Staff will be forwarding the Youth Services Review, as well as a report regarding the document's findings and recommendations, to Council before the end of May.

This is for the information of Council.

JF/jp

Attachments

cc: Director Administrative &
Community Services
O.I.C., R.C.M.P.

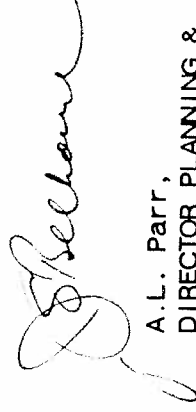

A.L. Parr,
DIRECTOR PLANNING &
BUILDING INSPECTION

ITEM 16
 MANAGER'S REPORT NO. 34
 COUNCIL MEETING 89/05/08

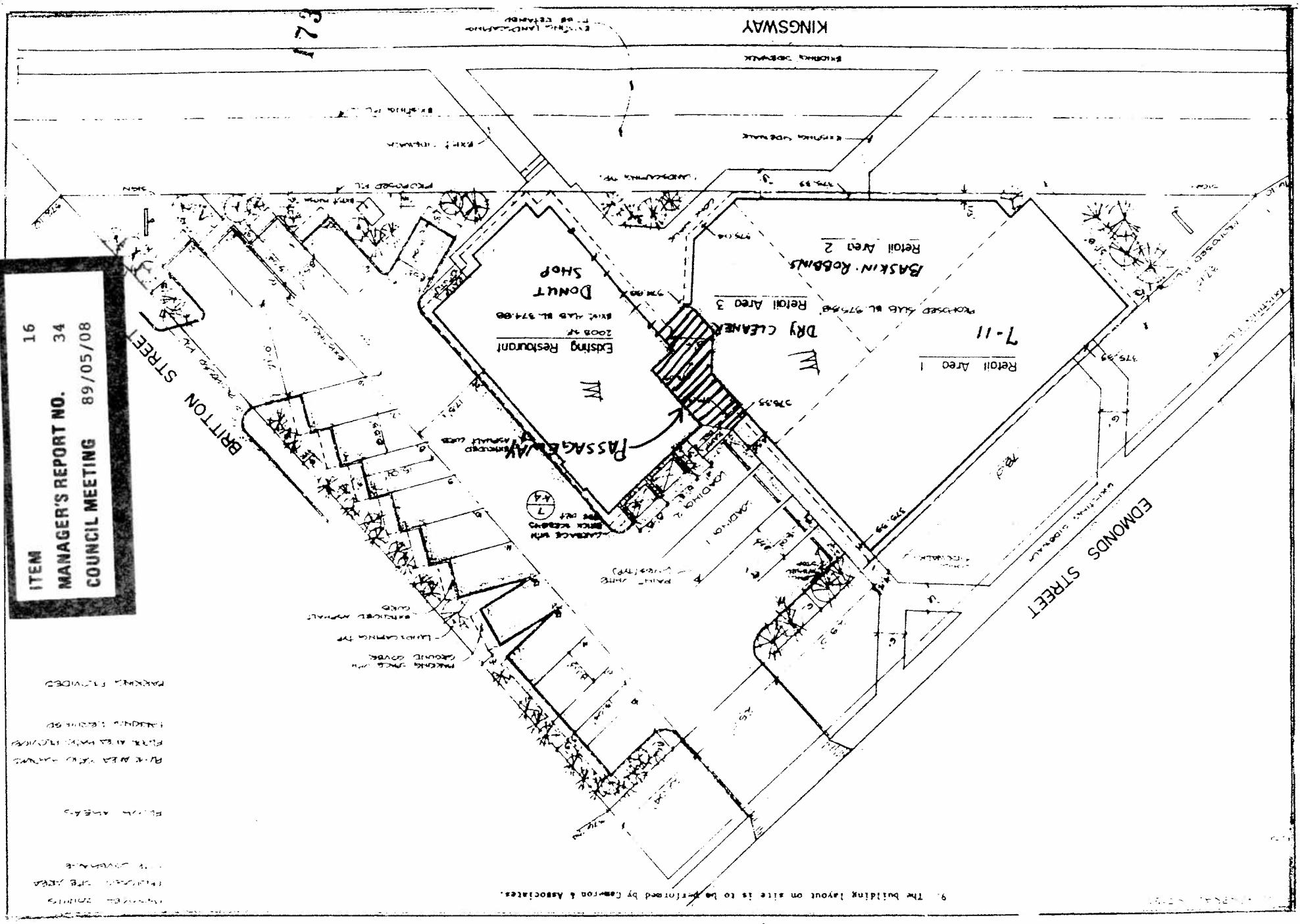

BURNABY
 Planning &
 Building Inspection
 Department

FIGURE 1 -
 SITE PLAN FOR
 CORNERS COMMERCIAL
 COMPLEX

Date:	
Scale:	
Drawn By:	

9. The building layout on site is to be performed by Cameron & Associates.

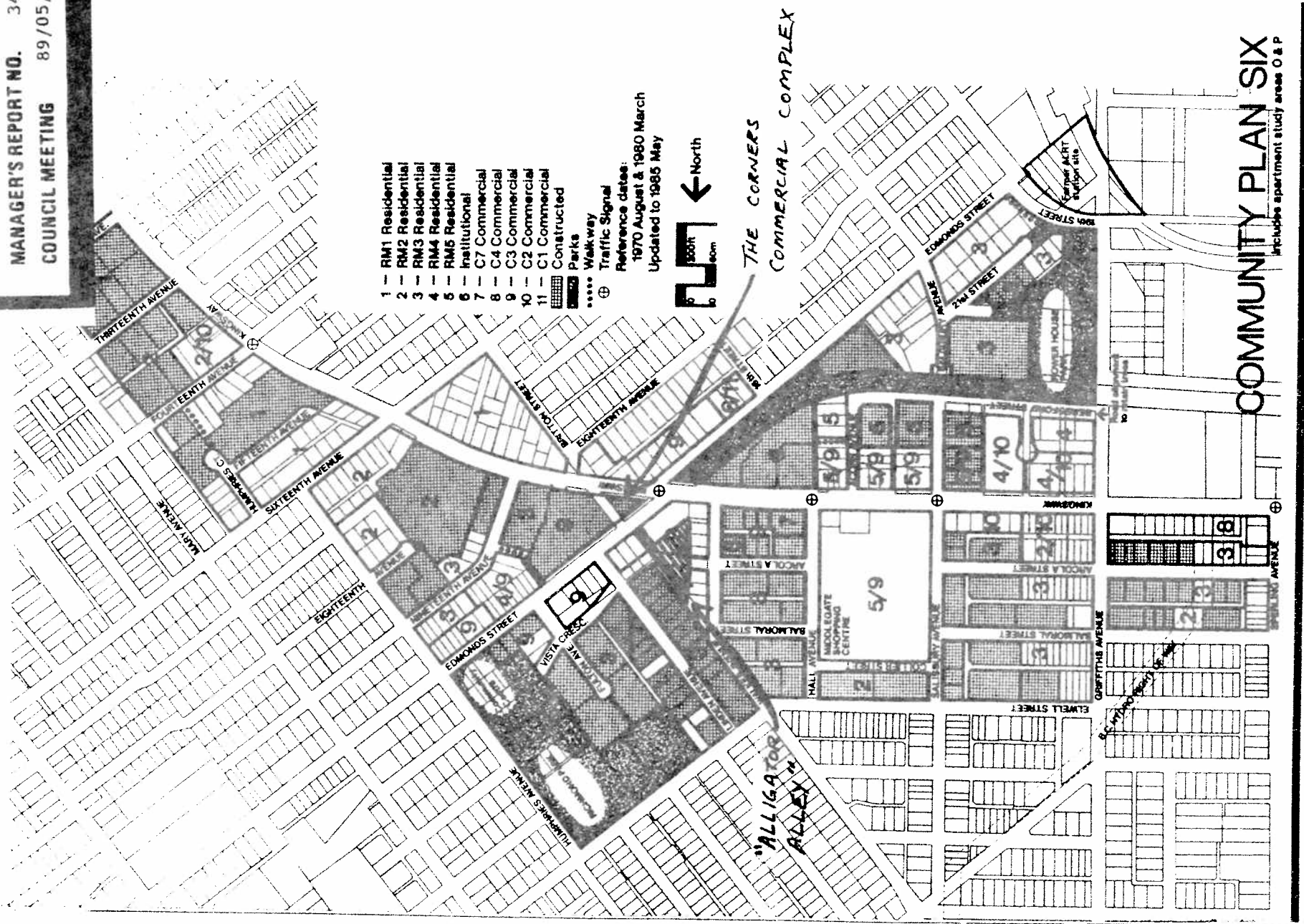

Date: _____

Scale: _____

Drawn By: _____

*FIGURE 2 -
 Community PLAN 6*

