

ITEM 11
MANAGER'S REPORT NO. 16
COUNCIL MEETING 1989 02 27

D.L. 98
LOT 21 OF 14
PLAN 2066
LOT F
PLAN 1088L

SUBDIVISION REF. # 8/89

X-REFERENCE: R.Z. # 72/88
R.C. # 14/88

ZONE: PROPOSED CD (RMS) 140

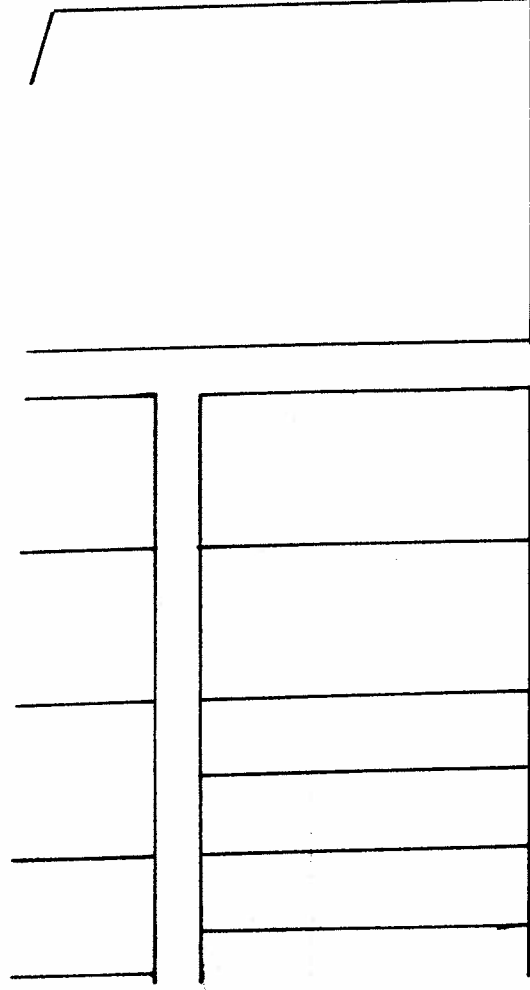

VICTORY ST. (ROAD 'A')

R.Z. # 91/86

1.

LANE DEDICATION

M^o PHERSON PARK/SCHOOL



BERESFORD ST.

ANTRIM AVE. (ROAD 'B')

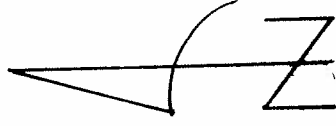
R.Z. # 73/88



NOTE: SERVICING AGREEMENT REQUIRED.

 - LANE CLOSURE } VIA HIGHWAY EXCHANGE
 - LANE DEDICATION }

SCALE - 1:1000
1989 FEB. A.D.