

THE CORPORATION OF THE DISTRICT OF BURNABY

REPORT OF THE TRANSPORTATION COMMITTEE

HIS WORSHIP, THE MAYOR
AND MEMBERS OF COUNCIL

DATE: 1988 March 14

Madam/Gentlemen:

Re: Cariboo Heights Development Plan - Alignment of Local
Residential Collector Between Cariboo Road and Holmes Street

=====

RECOMMENDATION:

1. THAT Council adopt the revised alignment for the local residential collector road connecting Cariboo Road and Holmes Street as shown on the attached Figure B.
2. THAT the Traffic and Safety Committee be requested to review possible improvements to the access and egress to Marion High School from Sapperton Avenue, including peak time drop-off and pick-up needs.

R E P O R T

1.0 BACKGROUND

Council, on 1987 October 05 considered Item No. 10, Municipal Manager's Report No. 58 and adopted an amended recommendation #1 as follows:

1. THAT Council adopt the revised concept plan for the Cariboo Study Area as shown on Figure B excepting the alignment of Sapperton Avenue which will be the subject of a further report.

The matter of the alignment of Sapperton Avenue, which was the subject of a delegation of residents from the local area, was forwarded to the Transportation Committee for its consideration and recommendation.

INTERNAL DISTRIBUTION:

- : - AGENDA 1988 MARCH 21
- : - COPY - MUNICIPAL MANAGER
- DIRECTOR PLANNING & BUILDING INSPECTION
- DIRECTOR ENGINEERING

HIS WORSHIP, THE MAYOR
AND MEMBERS OF COUNCIL

Re: Cariboo Heights Development Plan -
Alignment of Local Residential Collector
Between Cariboo Road and Holmes Street

1988 March 14 Page 2

The 1987 October 07 report reflected the results of a series of actions in relation to the road pattern for the area. An initial Open House concerned with the Cariboo Heights plan resulted in changes to the internal road network adjacent to Sapperton Avenue (see Figure A attached). Subsequently, staff attended a further public meeting and had several working meetings with a residents' subcommittee concerned with the Sapperton Avenue alignment. As a result of this consultation and further work, the proposed central residential collector involving a portion of the existing Sapperton roadway was recommended for revision as shown on Figure B attached.

2.0 THE REVIEW

The Transportation Committee met with the residents' committee on 1988 February 16 to hear their concerns. The residents' committee proposed that the revised configuration (as shown on Figure B) be further modified by eliminating any connection to Sapperton Avenue (see Figure C attached).

Prior to its making a decision on this matter, the Transportation Committee made a site visit on 1988 February 23 to review the alternate proposals. At its subsequent meeting, the Committee resolved to submit a recommendation endorsing the re-alignment of the local collector as shown on Figure B. This reflected the Committee's view that this configuration is superior in relation to the access and circulation needs of the Cariboo Heights area. The Transportation Committee further resolved that the Traffic and Safety Committee be requested to review possible improvements to the access and egress situation at Marion High School from Sapperton Avenue, including peak hour drop-off and pick-up needs. It is felt that improvements to this situation will result in short and long term benefits to the immediately adjacent neighbourhood and the intended functioning of Sapperton Avenue as a local residential collector.

The Transportation Committee met with the residents' committee on 1988 March 14 to inform them of their decision.

Respectfully submitted,

Alderman R.G. Begin
Chairman

Alderman F.G. Randall
Member

Alderman J. M. Sawicki
Member

Mr. R. Jarling
Member

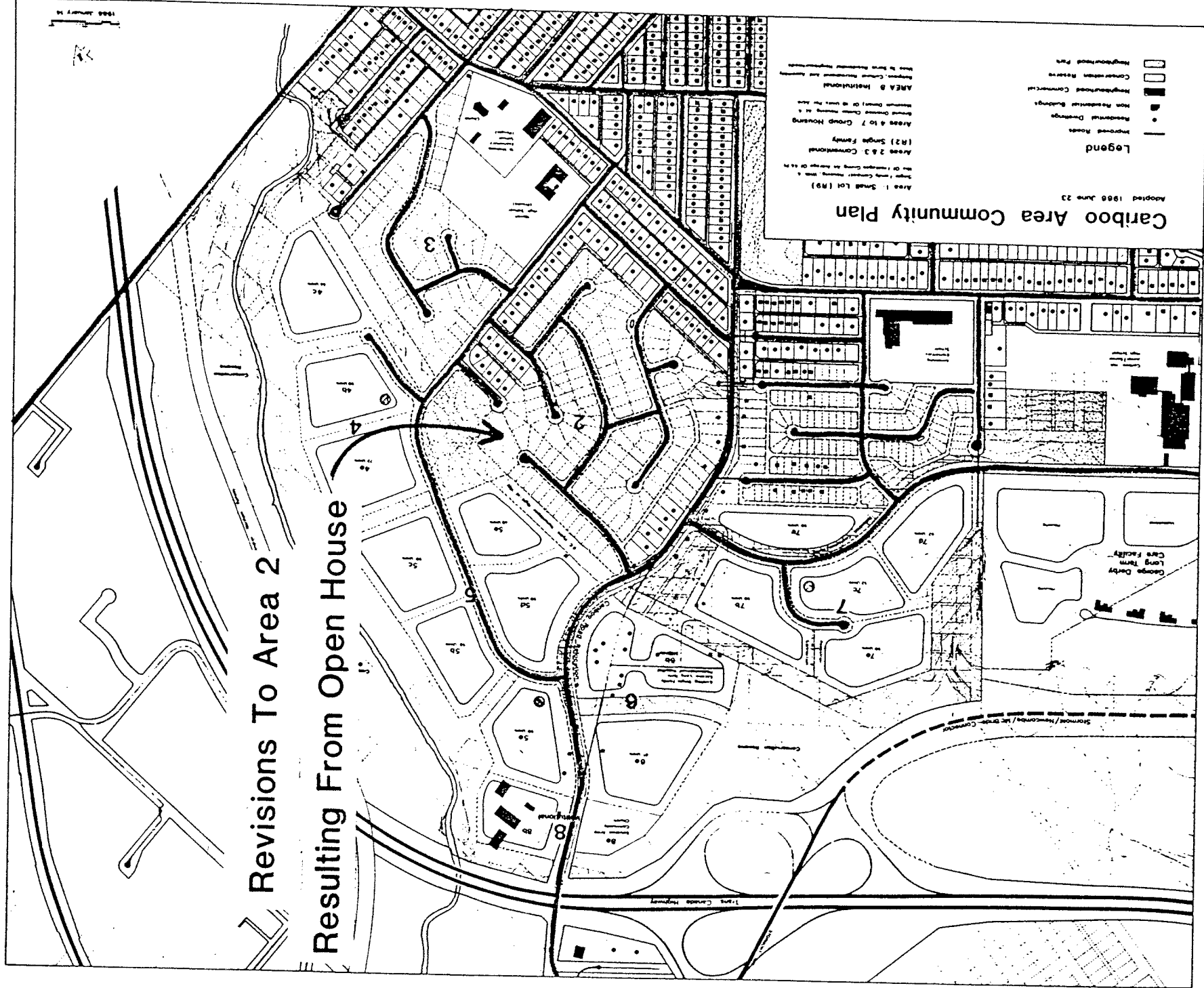

1986 June 23 Adopted Community Plan

Figure A

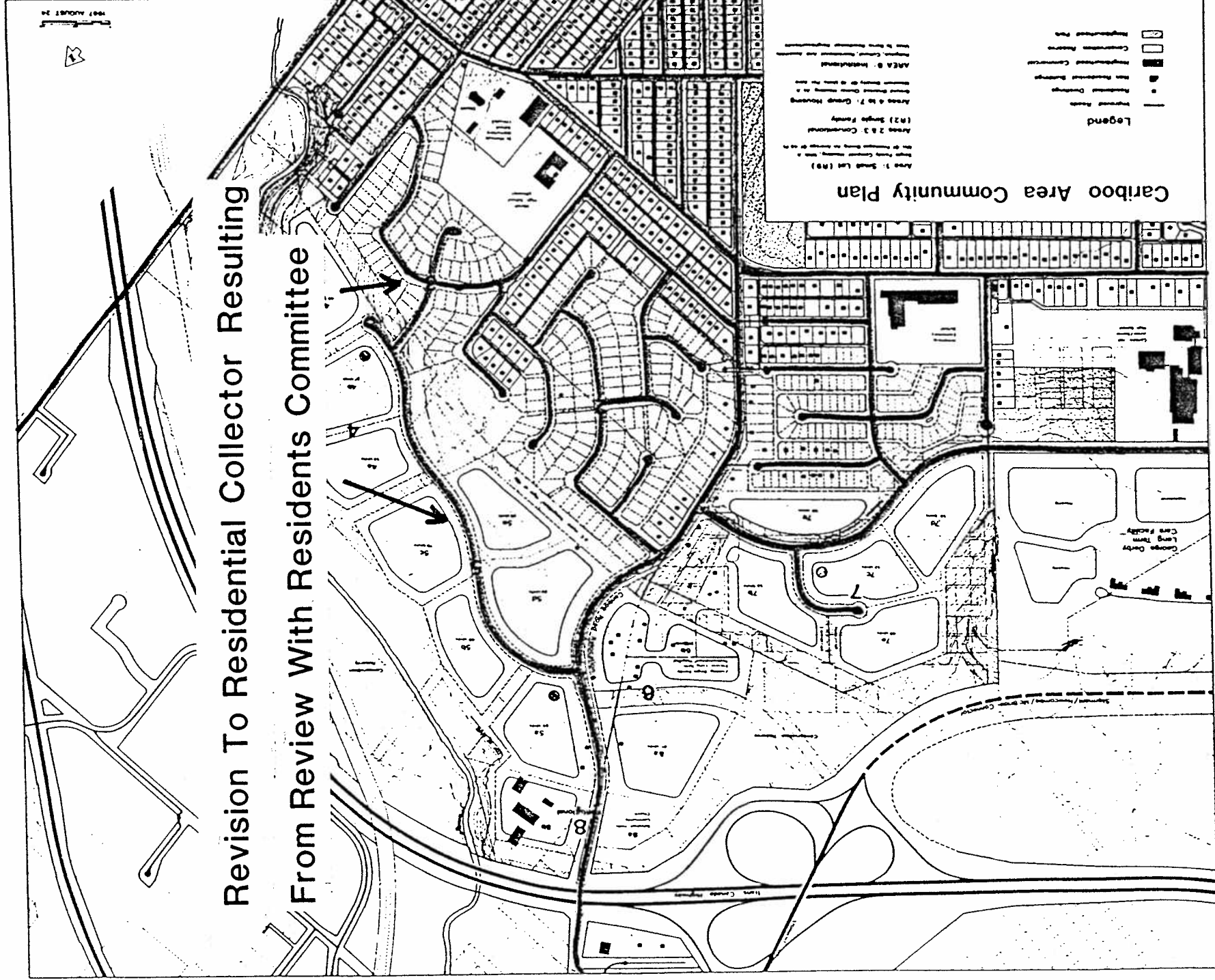

1987 August 24 Revised Community Plan

Figure B

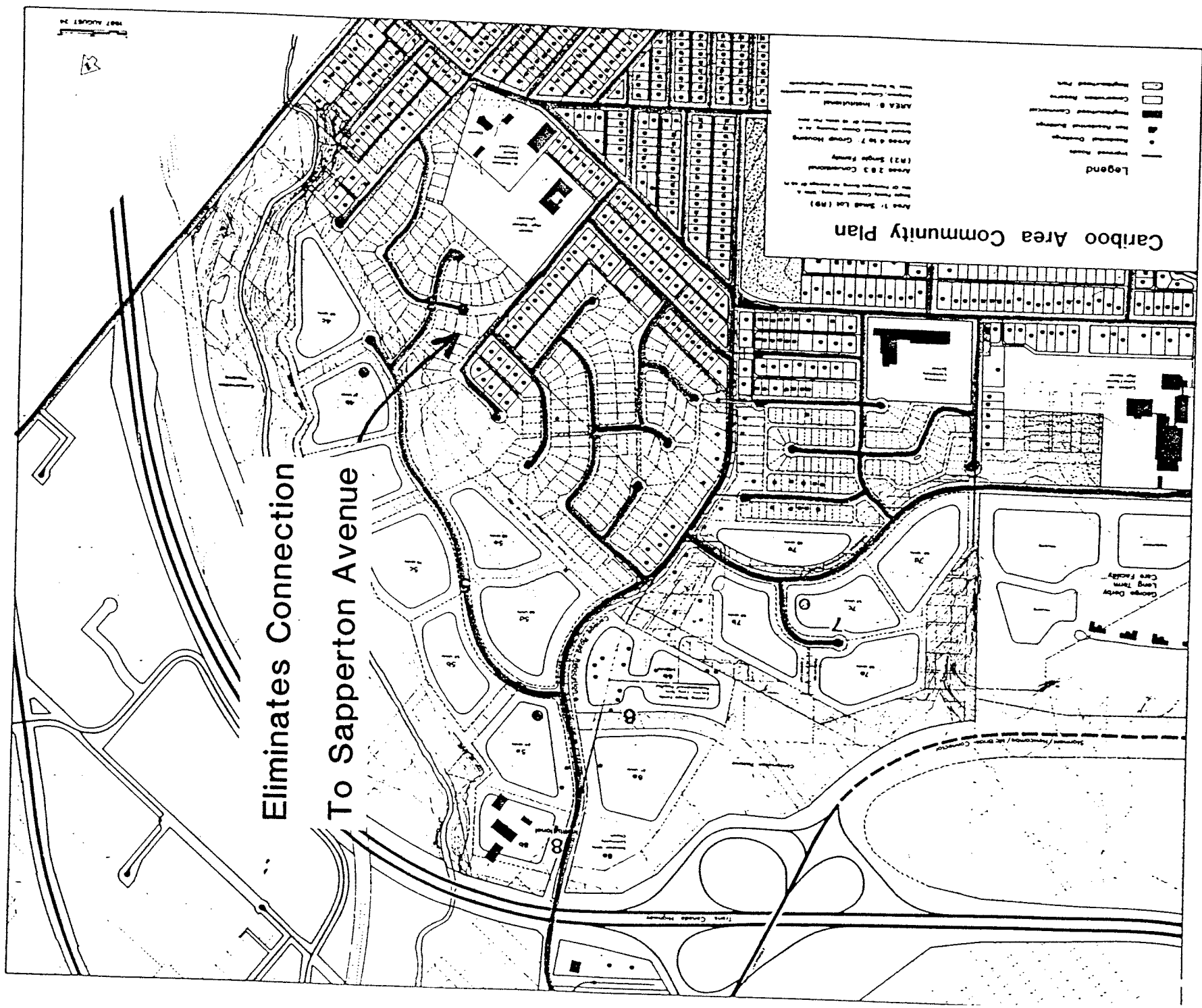

Residents' Proposal

