

RE: DEMOLITION OF BUILDINGS - METROTOWN AREA 14
SOUTH OF KINGSBOROUGH STREET

MUNICIPAL MANAGER'S RECOMMENDATION:

1. THAT the recommendation of the Director Planning & Building Inspection be adopted.

* * * * *

TO: MUNICIPAL MANAGER 1988 APRIL 28

FROM: DIRECTOR PLANNING & BUILDING INSPECTION

SUBJECT: DEMOLITION OF BUILDINGS - METROTOWN AREA 14
SOUTH OF KINGSBOROUGH STREET

=====

RECOMMENDATION:

1. THAT the Director Engineering be authorized to demolish the buildings on the thirteen (13) properties at 6108/6132/6144/6154/6168 Willingdon Avenue and 6097/6106/6107/6116/6119/6138/6150/6155 Cassie Avenue as soon as possible after vacancy.

R E P O R T

In order to pursue and accommodate the development of the Metrotown Area 14 civic facilities including the rezoning of the site, the closure of Cassie Avenue between Kingsborough Street and Central Boulevard, the registration of consolidation survey plans, and construction of the facilities, it is necessary that any remaining existing buildings within the designated site and affected by the proposed procedures be demolished after they are vacated. There are thirteen (13) properties remaining as outlined on the attached sketch which require demolition.

The tenants of the following eight (8) Corporation-owned properties have now been served with notices to vacate effective 1988 June 30:

- a) 6108/6132/6144/6154/6168 Willingdon Avenue.
- b) 6119/6150/6155 Cassie Avenue.

The former owners of the following five (5) Corporation-owned properties have, as previously agreed to at the time of purchase, a rent-free possession period to 1988 June 30:

- a) 6097/6106/6107/6116/6138 Cassie Avenue.

Council approval is needed to demolish the buildings (dwellings) on these properties as they become vacant. It is possible that some of the tenants in these dwellings will vacate of their own volition prior to 1988 June 30; and, if it should so transpire, Council approval should already be in place to demolish these buildings at that time.

The removal of trees is not part of the terms of reference for the demolition of buildings.

AKP

KI:lf

Attachment

cc: Director Engineering
Director Finance
Municipal Solicitor
Chief Building Inspector

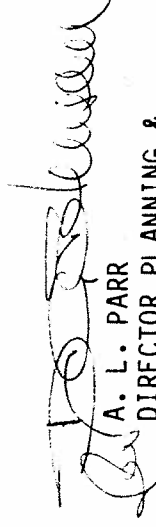
A. L. PARR
DIRECTOR PLANNING &
BUILDING INSPECTION

ITEM 15
 MANAGER'S REPORT NO. 32
 COUNCIL MEETING 88/05/02

145

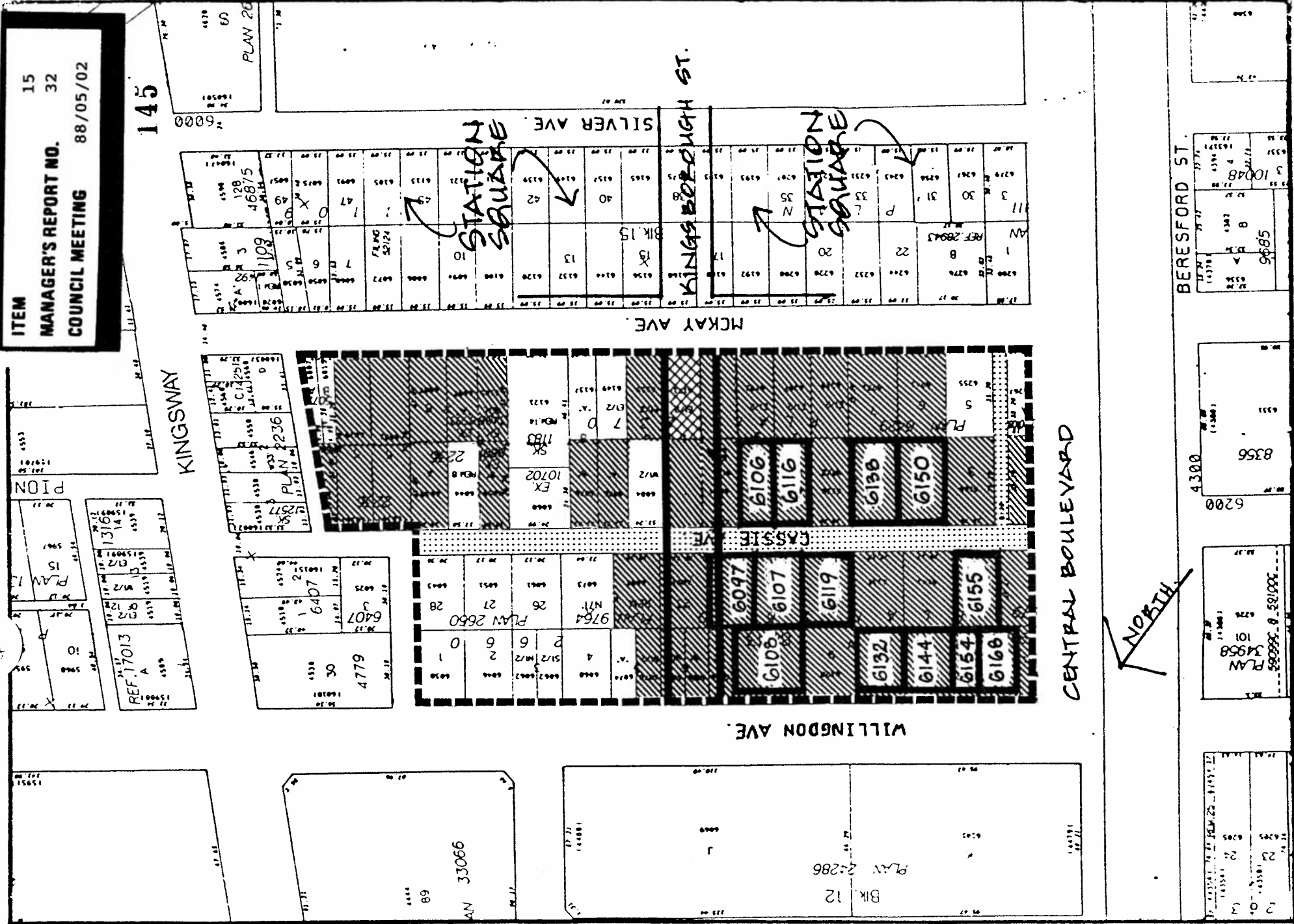

MUNICIPAL PROPERTY ACQUISITION INITIATIVE
METROTOWN AREA 14

Burnaby Planning Department

PRECINCT FOR PROPOSED MUNICIPAL
 PROPERTY ACQUISITION TOTAL - 36,302 m² (19.0 ac).
 PROPERTY REQ'D FOR
 - KINGSBOROUGH ST. RIGHT-OF-WAY - 2,836 m² (0.7 ac).
 TOTAL R/W [2,836 m² (0.7 ac)]

DEMOLITION OF
 ITEM: BUILDINGS
 MARKED

Date FEB. 1987

Scale 1:2000

Drawn By

- MUNICIPALLY OWNED PROPERTIES.

- EXISTING RIGHTS-OF-WAY. SKETCH 1