

RE: SUBDIVISION REFERENCE NO. 8/88
ROAD CLOSURE REFERENCE NO. 1/88
METROTOWN CIVIC COMPLEX - Highway Exchange Bylaw & Site Consolidation

MUNICIPAL MANAGER'S RECOMMENDATION:

1. THAT the recommendations of the Director Planning & Building Inspection be adopted.

* * * * *

TO: MUNICIPAL MANAGER 1988 April 26

FROM: DIRECTOR PLANNING & BUILDING INSPECTION

SUBJECT: SUBDIVISION REFERENCE #8/88
ROAD CLOSURE REFERENCE #1/88
METROTOWN CIVIC COMPLEX
Highway Exchange Bylaw
Site Consolidation

RECOMMENDATIONS:

1. THAT Council authorize the introduction of a Highway Exchange Bylaw involving the closure of a portion of Cassie Avenue and a lane allowance within the subject site in exchange for the dedication of Kingsborough Street, Willingdon Avenue and Central Boulevard road allowances, subject to the conditions outlined in this report.
2. THAT Council authorize the preparation of the highway exchange bylaw plans and consolidation plans by the Director Engineering.

R E P O R T

1.0 BACKGROUND

The assembly of the properties to contain the proposed Metrotown resource library, public parking facility and civic square will involve the closure of a portion of Cassie Avenue and a lane allowance within the proposed site and the dedication of land for Kingsborough Street, Willingdon Avenue and Central Boulevard road allowance purposes as shown on the attached Sketch #1. This may be accomplished via Highway Exchange Bylaw.

Reports of the proposed highway exchange were circulated to the various agencies and departments having an interest in these matters. The details are now available and are provided as follows.

METROTOWN CIVIC COMPLEX
Highway Exchange Bylaw
Site Consolidation



2.0 CURRENT SITUATION

Closure of that portion of Cassie Avenue between Kingsborough Street and Central Boulevard, as well as a portion of the abutting lane is subject to fulfillment of the following conditions by the Municipality:

123

- (a) Dedication of land for Kingsborough Street, Willingdon Avenue and Central Boulevard road allowance purposes. The one lot, not yet acquired but required for the Kingsborough Street right-of-way, will be dedicated once it is acquired.
- (b) Consolidation of the road and lane closure areas with abutting municipally-owned lots into one parcel as shown on the attached Sketch #1.
- (c) Relocation of any existing utilities within the closure areas on to the perimeter roads.
- (d) Preparation of all necessary highway exchange bylaw plans and consolidation plans by the Director Engineering.
- (e) Execution of all necessary documents and plans involved with the highway exchange and consolidation.



A. L. Parr
DIRECTOR PLANNING &
BUILDING INSPECTION

CMM:hr

Atts.

cc: Municipal Solicitor
Director Engineering
Director Finance

D.L. 153.

SD REF # 0/00
X REF FC REF # 1/00

ITEM	10
MANAGER'S REPORT NO.	32
COUNCIL MEETING	88/05/02

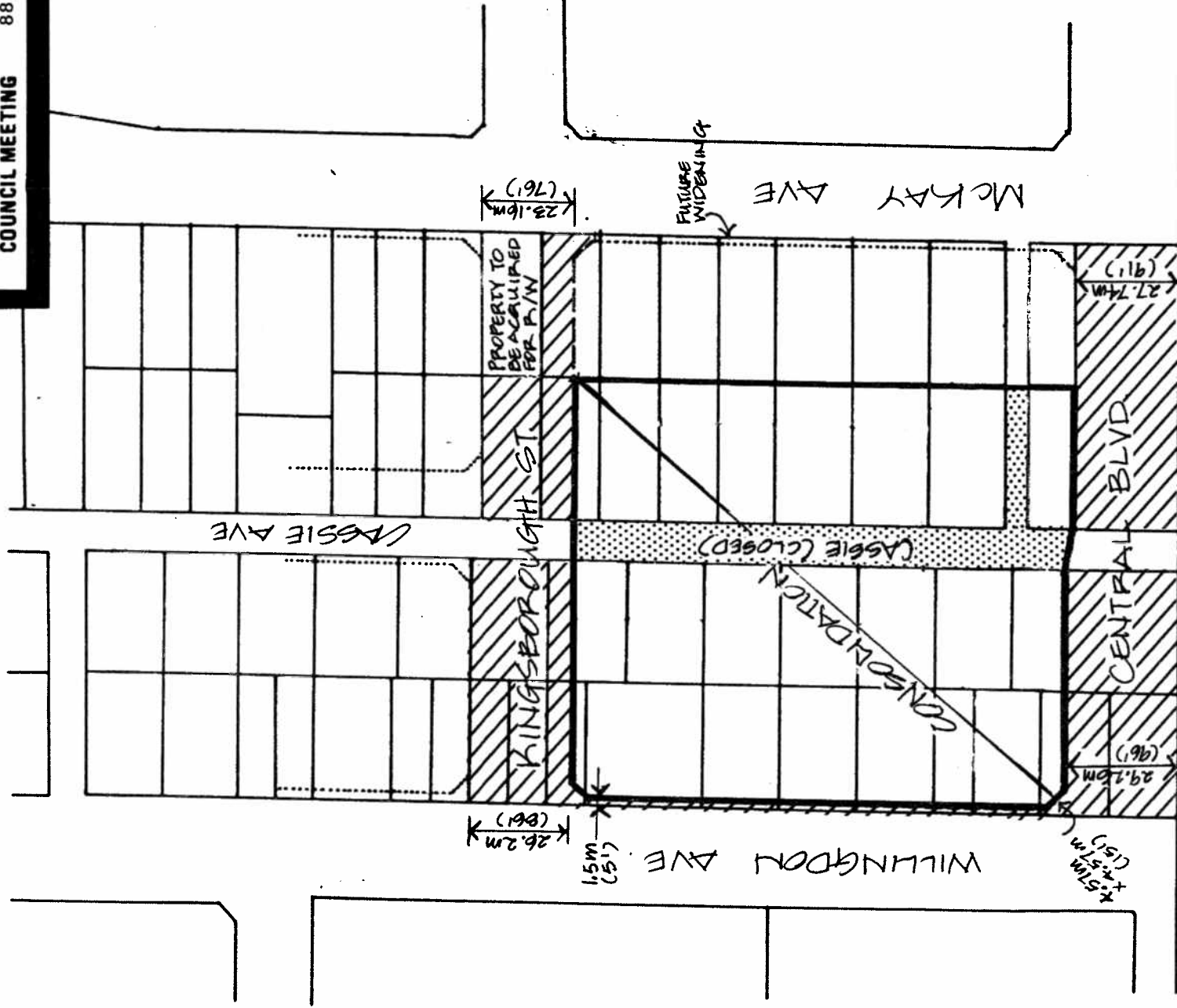

SKETCH # 1
SCALE: 1:1500
1988 APRIL.

