

ITEM 2
MANAGER'S REPORT NO. 13
COUNCIL MEETING 87/02/23

RE: SUBDIVISION REFERENCE NO. 14/87
LOT 4, DL 85, PLAN 21942
5265 CANADA WAY

MUNICIPAL MANAGER'S RECOMMENDATION:

1. THAT the recommendation of the Approving Officer be adopted.

* * * * *

TO: MUNICIPAL MANAGER 1987 FEBRUARY 17
FROM: APPROVING OFFICER
RE: SUBDIVISION REFERENCE #14/87
LOT 4, D.L. 85, PLAN 21942 - 5265 CANADA WAY

RECOMMENDATION:

1. THAT this report be received for the information of Council.

REPORT

We are in receipt of an application to subdivide the above referenced privately-owned property.

One of the conditions of subdivision approval will be the dedication of the full road allowance for the east/west section of Rugby Street at this time as shown on the attached sketch. However, because of the various directional traffic barricades which have been installed in the area to protect the neighbourhood from Canada Way traffic, we are prepared to accept the subject subdivision without completion of the east/west road link. Instead, it is proposed that two hammerheads be constructed, with a connecting fire truck emergency access, to provide for access to the new lots, as well as for suitable traffic turnaround purposes. Because we would obtain the full road allowance at this time, the Municipality could complete the road link between the two hammerheads if the need for such a connection arose in the future. However, the cost of this link would then have to be borne by the Municipality.

Unless otherwise directed by Council, we will process the subdivision application under the conditional approval of provision, by the subdivider, of two hammerheads and the fire truck emergency access and dedication of the full road allowance, as described above.

This report is submitted for the information of Council.

CWM:ad
Att.
cc: Director Engineering
Fire Chief

A.L. PARR,
APPROVING OFFICER

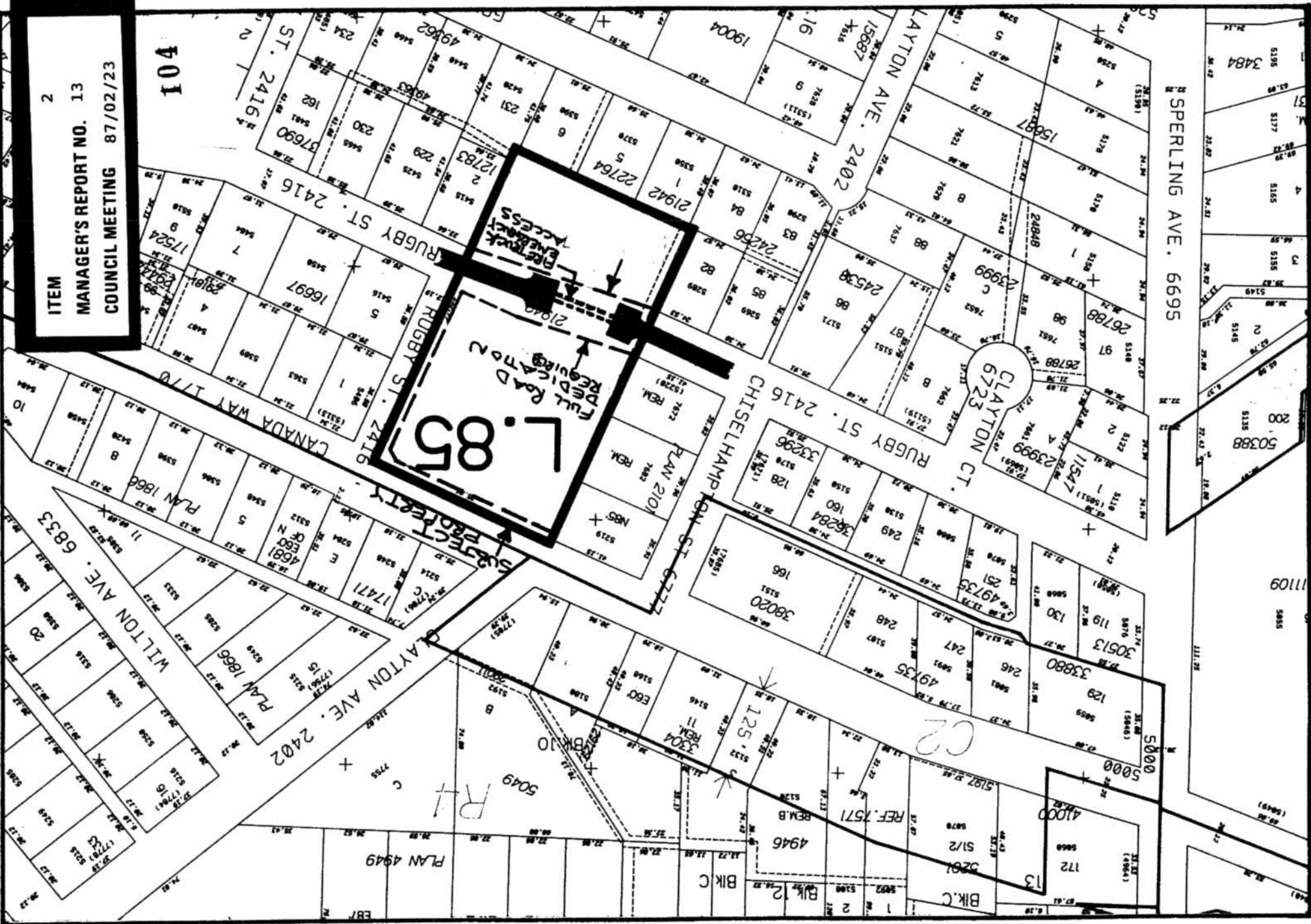

ITEM 2
 MANAGER'S REPORT NO. 13
 COUNCIL MEETING 87/02/23

10A

L.85

Full Road Dedication



THE CORPORATION OF
BURNABY
 Planning &
 Building Inspection
 Department



Date 1987 FEB.
 Scale 1:2000M
 Drawn By C.M.M.

S.D. REF. # 14/87

D.L. 85

LOT 4

PLAN 2194Z

ZONING: R1