

RE: SALE OF LOT 1, DL 125, GRP 1, PLAN 71964
M2 INDUSTRIAL LOT LOCATED SOUTH OF DOUGLAS ROAD AT SPRINGER AVENUE
(Item 14, Report No. 31, 1986 May 05)

MUNICIPAL MANAGER'S RECOMMENDATION:

1. THAT the recommendation of the Municipal Solicitor be adopted.

* * * * *

TO: MUNICIPAL MANAGER
FROM: MUNICIPAL SOLICITOR
RE: SALE OF LOT 1, DISTRICT LOT 125, GROUP 1, PLAN 71964
M2 INDUSTRIAL LOT LOCATED SOUTH OF DOUGLAS
ROAD AT SPRINGER AVENUE
JULY 2, 1986

RECOMMENDATION:

1. THAT the bid for the above captioned lot be accepted.

R E P O R T

On May 5, 1986, Item 14, Manager's Report No. 31, Council approved the sale of Lot 1, District Lot 125, Group 2, Plan 71964 (formerly Lot F, Block 8, District Lot 125, Plan 14404 and Part of Ref. Plan with Bylaw Filed 38453 of Lot D, Block 8, District Lot 125, Plan 3436) by public tender.

The lot was advertised in the June 13th and June 20th, 1986 weekend editions of The Vancouver Sun and The Province newspapers. Bids closed on Friday, June 27, 1986 which resulted in a single bid.

The lot was advertised with a reserve price of \$235,580 (\$5.50 per square foot) and JRA Investments Ltd. of 2293 Douglas Road, Burnaby, B.C. submitted a sealed bid for \$235,680 (\$5.52 per square foot).

ITEM 13
MANAGER'S REPORT NO. 42
COUNCIL MEETING 86/07/07

Sale of Lot 1, District Lot 125
July 2, 1986 Page 2

142

Since JRA Investments Ltd. bid satisfies the requirements of the advertised sale, the Legal Department recommends acceptance of their bid.



Patricia W. Olieger
Municipal Solicitor

DS:bi

cc: Director Administrative & Community Services
Director Engineering
Director Finance
Director Planning & Building Inspection
Director Recreation & Cultural Services

Sketch attached

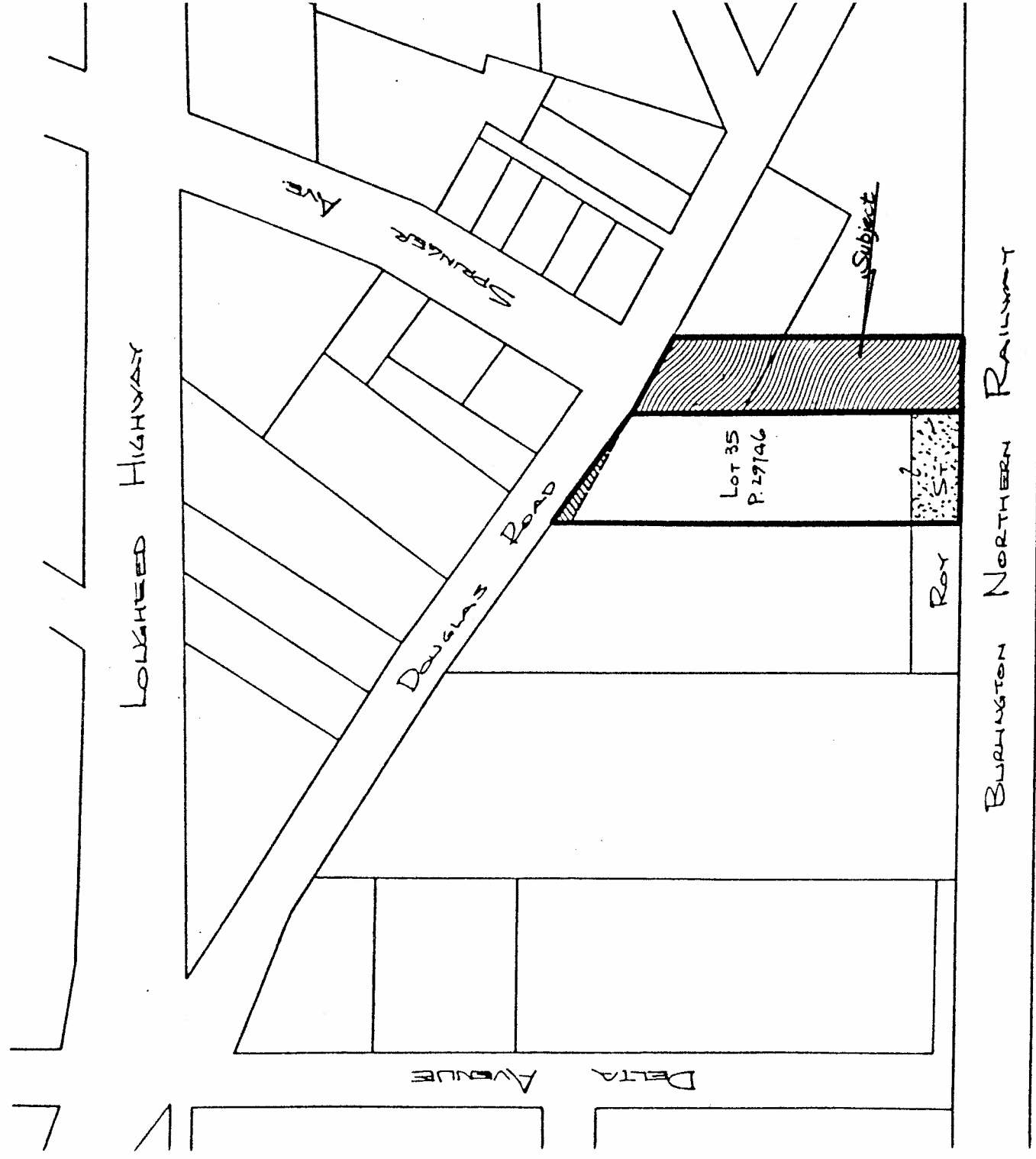
ITEM 13
 MANAGER'S REPORT NO. 42
 COUNCIL MEETING 86/07/07



SPRING AVE. ROAD ALLOWANCE WHICH HAS BEEN CLOSED AND WHICH WILL BE RETAINED BY MUNICIPALITY FOR FUTURE DISPOSITION.



ROY STREET ROAD ALLOWANCE WHICH IS TO BE CLOSED VIA HIGHWAY EXCHANGE AND CONSOLIDATED WITH LOT 35, PLAN 29746



DOUGLAS ROAD WIDENING WHICH IS TO BE DEDICATED VIA HIGHWAY EXCHANGE.

143

1" = 200' PB
 1983 APR. 13

SKETCH #1

