

ITEM 13  
MANAGER'S REPORT NO. 66  
COUNCIL MEETING 86/11/03

RE: SUBDIVISION SERVICING AGREEMENT  
SUBDIVISION REFERENCE NO. 40/86  
PHILLIPS AVENUE/LYNNDALE CRESCENT

MUNICIPAL MANAGER'S RECOMMENDATION:

1. *THAT the recommendation of the Approving Officer be adopted.*

\* \* \* \* \*

TO: MUNICIPAL MANAGER 1986 OCTOBER 30  
FROM: APPROVING OFFICER  
RE: SUBDIVISION SERVICING AGREEMENT  
SUBDIVISION REFERENCE #40/86  
PHILLIPS AVENUE/LYNNDALE CRESCENT

RECOMMENDATION:

1. THAT Council authorize the preparation and execution of the servicing agreement for Subdivision Reference #40/86.

REPORT

The Planning and Building Inspection Department reports that the subdiv-  
ider has completed requirements leading to final approval of the above  
referenced subdivision, as shown on the attached plan. The following  
information is provided for inclusion in the servicing agreement.

Servicing Agree-  
ment Section No.

Subdivider

W. Stokes and R. Nosella,  
210 - 7342 Winston Street,  
Burnaby, B.C.

Legal Description of all properties within the sub-  
division

Lot 2, Blk. 17, Plan 3454, Lot 1, Plan 7391, N.80' of  
Lot 2, Plan 7391 and Lot 2, exc. N.80', Plan 7391, all  
of D.L. 44, Gp. 1, N.W.D.

3. Description of Services to be installed by subdivider

According to schedule attached (Note: this schedule is prepared by the Engineering Department based on the engineering design drawings. The engineering design drawings showing the required servicing described in this report are available for perusal in the Engineering Department.)

4. Completion Date  
The 14th day of November, 1986
12. Contractor  
Big Blue Construction Ltd.,  
2215 - 164th Street,  
Surrey, B.C.  
V4B 4Z5
- Contract Price  
\$65,800.00
8. Insurance  
Copies of all insurance policies as required in the body of the servicing agreement are to be deposited with the Municipal Solicitor. (Note: these cover: Comprehensive General Liability, Subdivider's Contingency Liability, Completed Operations Liability, Contractual Liability, and Automobile Liability. The contractor's insurance policies are acceptable if he is doing the work for the subdivider.)
9. Inspection Fee  
4% of full contract price: \$2,632.00
10. Irrevocable Letter of Credit or Cash Bond posted with Municipality  
\$65,800.00

CMM:ad  
Att.  
cc: Municipal Solicitor  
Director Engineering  
Director Finance

  
A. L. PARR,  
APPROVING OFFICER

ITEM	13
MANAGER'S REPORT NO.	66
COUNCIL MEETING	86/11/03

BUFFALO DR.

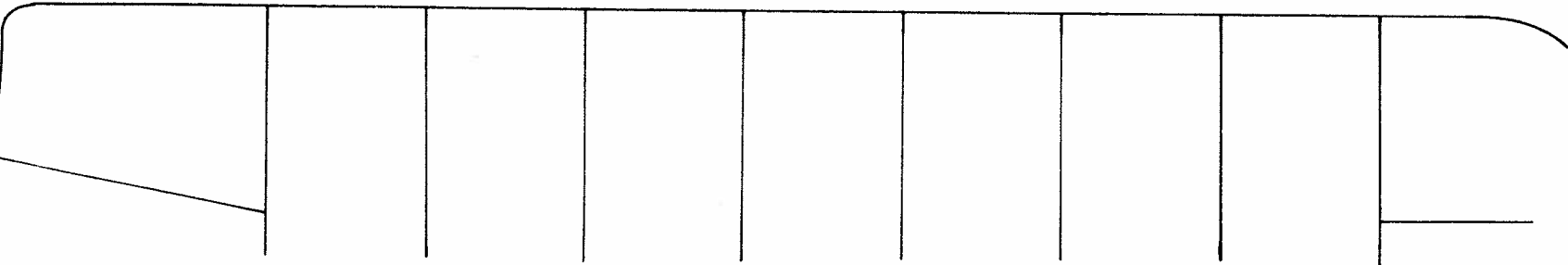

LYNDALE CRESC. ROAD 'A'

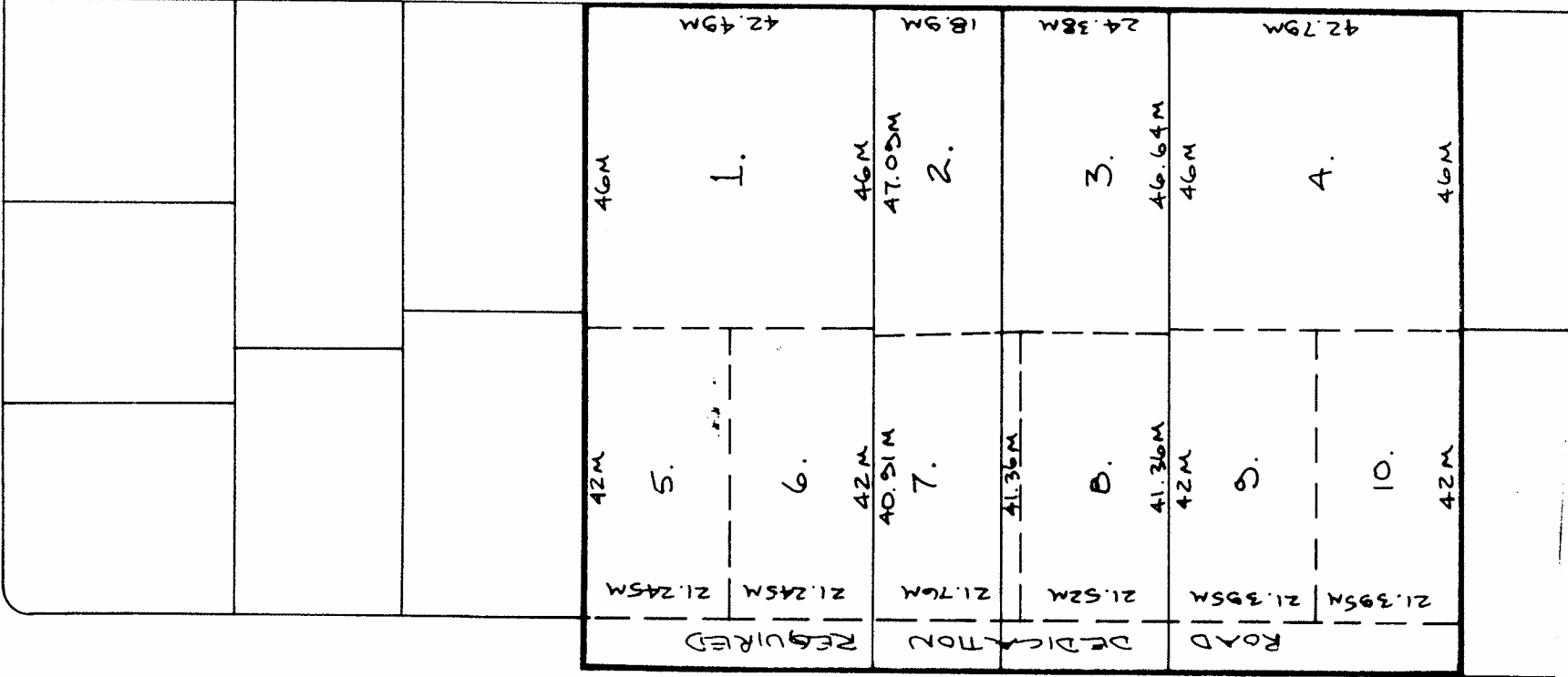

ROAD DEDICATION REQUIRED

PHILLIPS AVE. ROAD 'B'



1:1000M  
1986 APRIL  
C.M.M.

The Corporation of the District of Burnaby

## INTER-OFFICE COMMUNICATION

TO: APPROVING OFFICER DATE: 86 10 14

FROM: DIRECTOR ENGINEERING FILE: S/D 40/86

SUBJECT: SUBDIVISION SERVICING REQUIREMENTS  
SUBDIVISION REFERENCE #40/86, DL 44  
PHILLIPS AVENUE AND LYNNDALE CRESCENT, DESIGN NO. 860516

The following is a list of required works as detailed on the design drawings prepared by Vector Engineering Ltd. and received by the Director Engineering, as required by the Subdivision Control Bylaw:

- 1) Roads: Construct Lynndale Crescent abutting the site as shown on Design #860516, sheet 1 of 2.
- 2) Sanitary Sewer: Construct a sanitary sewer main within an easement as shown on Design #860516, sheet 2 of 2.
- 3) Channel Lining: Construct channel lining within an easement, on the existing water course as shown on Design #860516, sheet 2 of 2.
- 4) Boulevard Grass and Tree Planting: Install boulevard grass and trees on Lynndale Crescent as required by the Planning Department.
- 5) Easements: Are required.
- 6) "As Built" Drawings: Are required for all works completed under an accepted engineering design.

KGW:ml

cc: ( ) Estimator  
( ) Assistant Director Engineering, Design



DIRECTOR ENGINEERING