

RE: CLASS "D" NEIGHBOURHOOD PUBLIC HOUSE APPLICATION
5820 MARINE DRIVE
LIQUOR LICENSE APPLICATION NO. 1/85
(Item 8, Report No. 27, 1985 April 09)

ACTING MUNICIPAL MANAGER'S RECOMMENDATION:

1. THAT the recommendation of the Director Planning & Building Inspection be adopted.

* * * * *

TO: MUNICIPAL MANAGER 1985 June 05
FROM: DIRECTOR PLANNING & BUILDING INSPECTION
SUBJECT: CLASS "D" NEIGHBOURHOOD PUBLIC HOUSE APPLICATION
5820 MARINE DRIVE
LIQUOR LICENSE APPLICATION #1/85
(Refer to attached sketch)

RECOMMENDATIONS:

1. THAT Council resolve to approve the subject Neighbourhood Public House and that a copy of Council's resolution and this report be sent to the General Manager of the Liquor Control & Licensing Branch in Victoria.
2. THAT copies of the Survey Report (as required) be sent to the General Manager of the Liquor Control & Licensing Branch.
3. THAT a copy of this report be sent to the neighbourhood pub applicants, Mr. D. Chung and Mr. D. Herd.

REPORT

1.0 BACKGROUND:

- 1.1 On 1985 April 09 Council received a report outlining the proposed methodology for the required neighbourhood pub survey and the bids received from three marketing firms. On that occasion, Council endorsed the selection of Watts Marketing Research Ltd. to conduct the pub survey for a fee not to exceed \$6,285.00.
- 1.2 The public survey has now been completed and it is now in order to submit the survey results and any additional information to Council for consideration. Copies of the survey information was carried out by the research firm are available for review by Council and the public in the Planning & Building Inspection Department. A copy of the survey results will be forwarded to the General Manager of the Liquor Administration Branch in Victoria.

2.0 SURVEY RESULTS:

A total of 1677 ballots were distributed to eligible voters within the prescribed area of which 1364, or 81.39% of the total ballot count was returned. The survey results have been determined as follows:

YES VOTES = 973 or 71.3%

NO VOTES = 391 or 28.7%

3.0 GENERAL COMMENTS:

- 3.1 The Planning & Building Inspection Department contacted the Burnaby Detachment of the R.C.M.P. and the Burnaby School Board to determine their views on the neighbourhood pub proposal. These agencies expressed no objections to the proposed pub.
- 3.2 The subject property on which the proposed pub will be established is presently occupied by a retail lumber supply establishment. Existing improvements will be removed from the site in order to construct a new freestanding building which will accommodate the pub facility. The current zoning of the site is C2 Community Commercial District which includes a neighbourhood pub as a permitted use subject to compliance with the Government Liquor Act regulations.
- 3.3 The applicant has submitted preliminary development plans which must be processed through the Preliminary Plan Approval and Building Permit procedures. The plans illustrated that all vehicular access will be from Marine Drive with the provision of sufficient surface parking to comply with the zoning bylaw regulations. The pub facility will accommodate 65 patrons.
- 3.4 In view of the foregoing information and specifically the favourable results of the resident survey, it is appropriate for Council to approve the subject neighbourhood pub application. Council's favourable resolution on the pub would then be sent to the General Manager of the Provincial Liquor Control & Licensing Branch in Victoria.

PDS/js

Attachment

A.L. Parr,
DIRECTOR PLANNING &
BUILDING INSPECTION

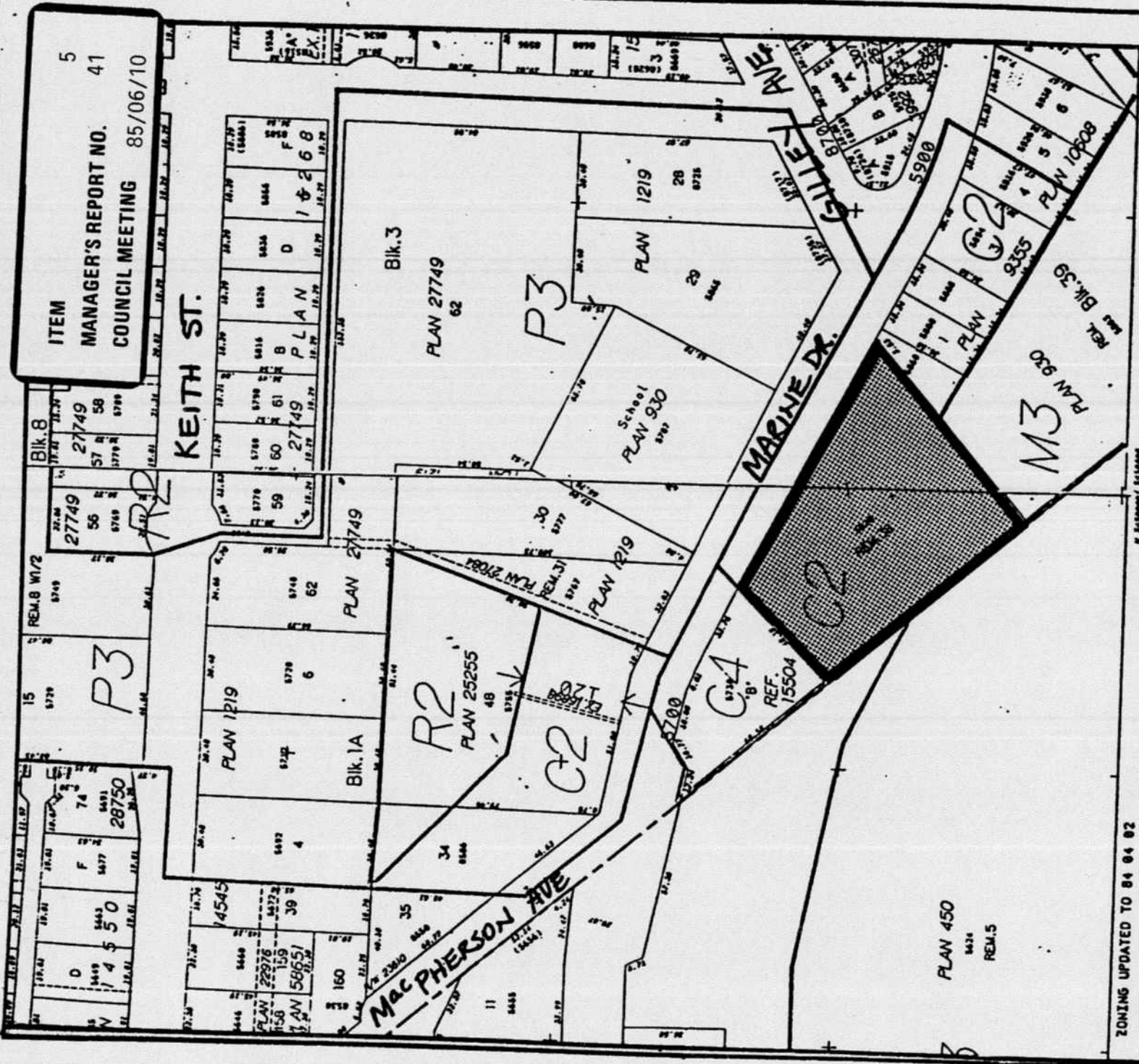

ITEM 5
 MANAGER'S REPORT NO. 41
 COUNCIL MEETING 85/06/10

ZONING OVERLAY - PL
 ENGINEERING DEPARTMENT
 U.T.M. GRID ZONE 10, 1975
 PHOTOGRAPHICALLY REDUCED TO 1:2000
 SCALE 1/10.500800.5450000
 ZONING UPDATED TO 84 04 02

Date

1985 JUNE

Scale

1:2000

Drawn By



Burnaby Planning Department

NEIGHBOURHOOD PUB REF# 1/85
 5820 MARINE DRIVE

