

ITEM 4
MANAGER'S REPORT NO. 73
COUNCIL MEETING 84/11/19

RE: SUBDIVISION REFERENCE NO. 104/84
351 N. ELLESMERE AVENUE
DESIGNATED CONSERVATION AREA - NORTH SIDE OF CAPITOL HILL

MUNICIPAL MANAGER'S RECOMMENDATION:

1. THAT the recommendation of the Approving Officer be adopted.

* * * * *

TO: MUNICIPAL MANAGER 1984 November 13
FROM: APPROVING OFFICER
SUBJECT: SUBDIVISION REFERENCE #104/84
351 N. ELLESMERE AVENUE
DESIGNATED CONSERVATION AREA - NORTH SIDE OF CAPITOL HILL

RECOMMENDATION:

1. THAT this report be received for information.

REPORT

The Planning & Building Inspection Department is in receipt of an application to subdivide the captioned property into two single-family dwelling lots. The site is located within the current boundary of the Council-designated conservation area on the north side of Capitol Hill. (See Sketch #1 attached) However, adoption of the revised boundary, as presented in our report entitled "North Side of Capitol Hill Conservation Area Boundary Review" would result in the subject property being excluded from the Conservation Area. (See Sketch #2 attached) Council, on 1984 March 26, tabled the report pending submission of further information.

Given that our review of the Conservation Area proposes exclusion of the subject property; water and sanitary sewers are available to serve the site; and physical vehicular access is also available, it is proposed to circulate the subdivision application unless otherwise directed by Council.

A. L. Parr
APPROVING OFFICER

AD/nb
att.

ITEM 4
MANAGER'S REPORT NO. 73
COUNCIL MEETING 84/11/19

112

108

- PRIVATE DWELLING
- EXISTING PARK AND/OR MUNICIPAL PROPERTY
- PRIVATELY OWNED
- UNDEVELOPED PROPERTY
- GARDENS ROAD
- ACCESS

SKETCH #1

180/180 B

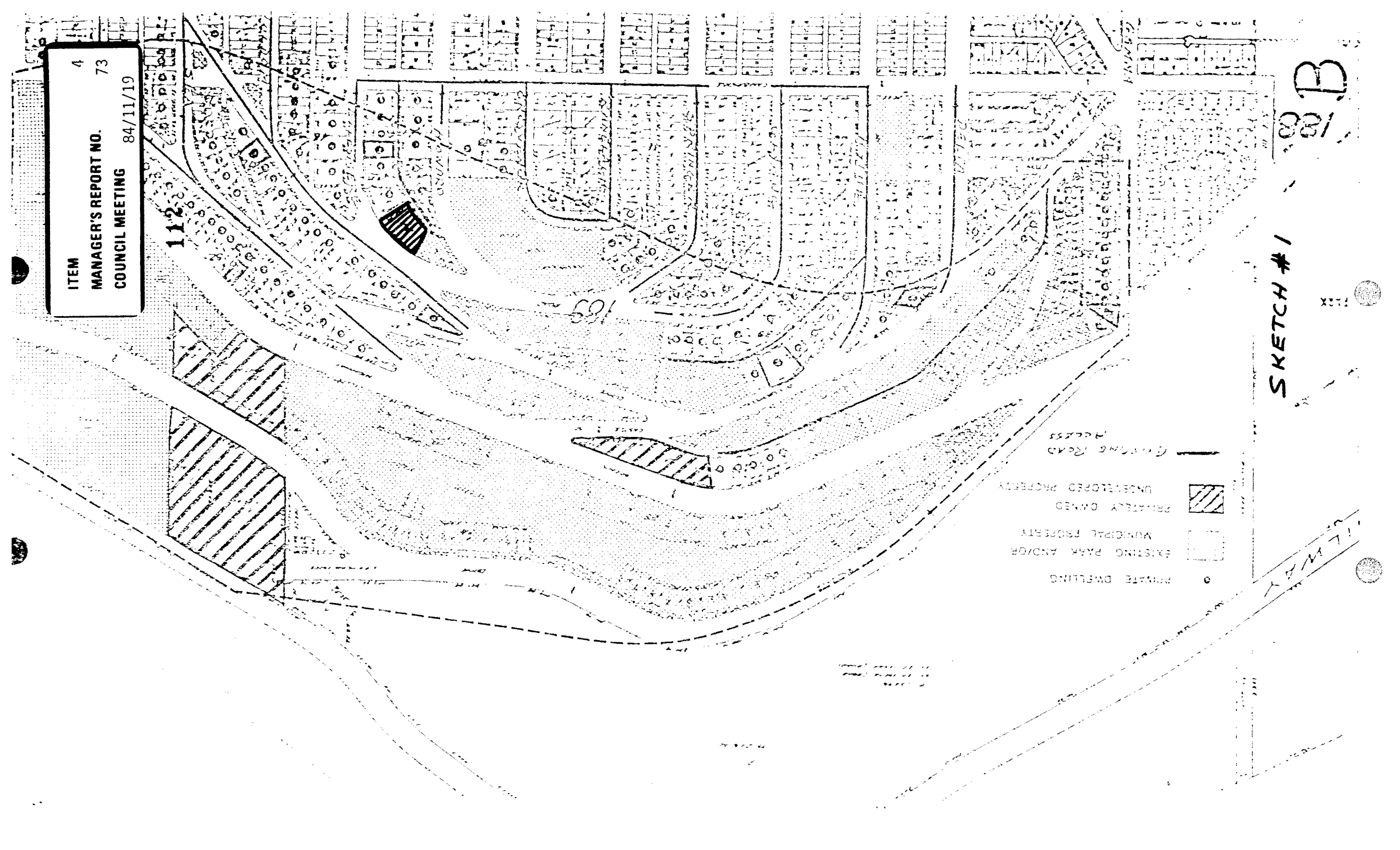

ITEM 4
 MANAGER'S REPORT NO. 73
 COUNCIL MEETING 8/11/19

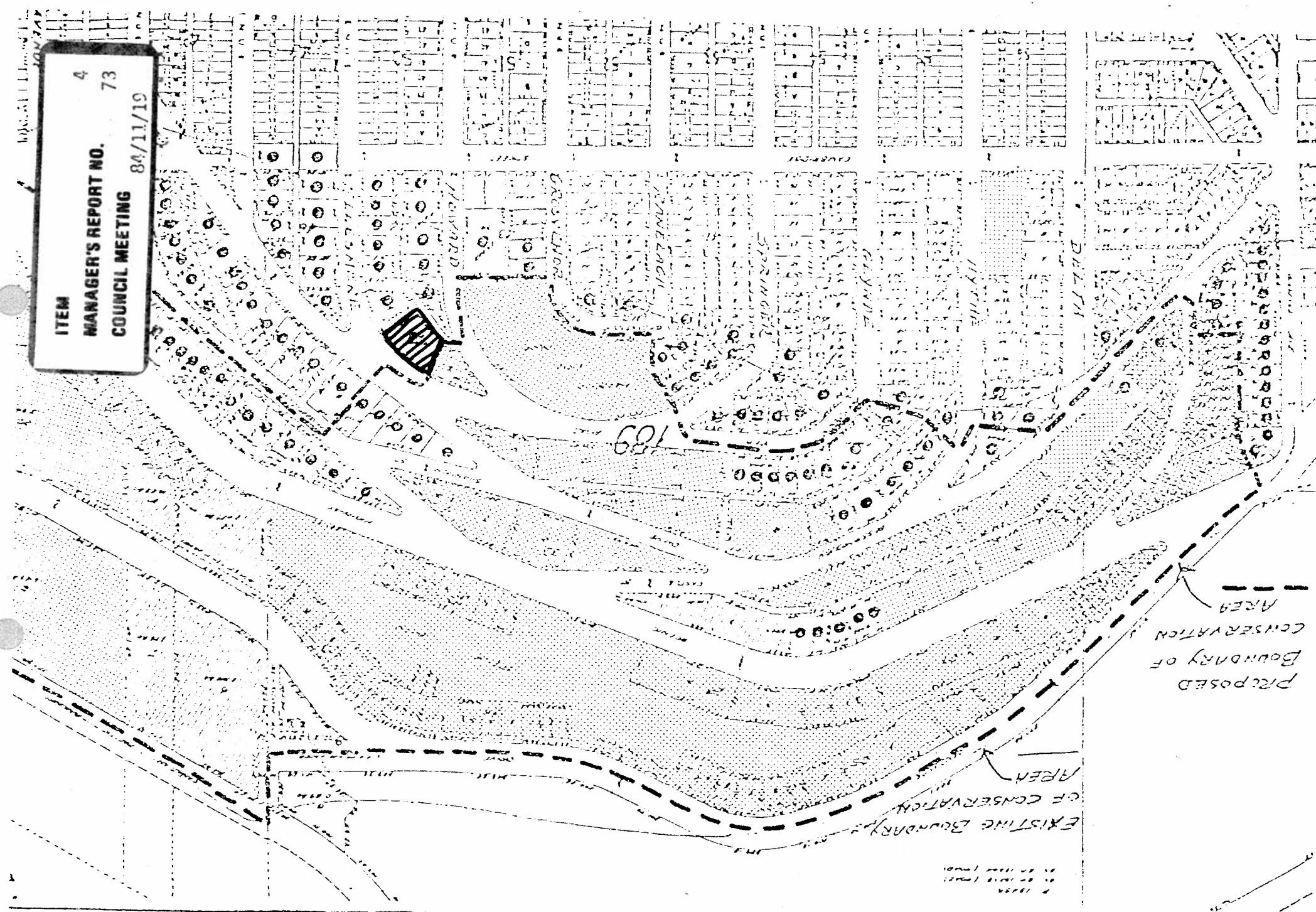

NORTH SIDE OF CAPITOL HILL

SKETCH #2.

- PROPERTY BOUNDARIES
- ▭ PROPOSED CONSERVATION AREA
- ▭ EXISTING CONSERVATION AREA
- ▭ PRIVATELY OWNED PROPERTY
- ▭ UNDEVELOPED PROPERTY

D

