

RE: LANDFILL ENCROACHMENT ON MUNICIPAL LANDS  
LOTS 18, 19, & 20, D.L. 155B, GROUP 1, PLAN 1248, NWZ  
(ITEM 22, SUPPLEMENTARY REPORT NO. 48, 1984 JULY 23)

ITEM SUPPLEMENTARY 11  
MANAGER'S REPORT NO. 55  
COUNCIL MEETING 1984 09 10

MUNICIPAL MANAGER'S RECOMMENDATION:

1. THAT the recommendation of the Director Planning & Building Inspection be adopted.

\* \* \* \* \*

TO: MUNICIPAL MANAGER  
1984 September 06

FROM: DIRECTOR PLANNING & BUILDING INSPECTION  
Our File: 02.120.4

SUBJECT: LANDFILL ENCROACHMENT ON MUNICIPAL LANDS;  
LOTS 18, 19 & 20, D.L. 155B, GROUP 1, PLAN 1248, N.W.D.

RECOMMENDATIONS:

1. "THAT Council amend the attached Order which was issued to Meadowland Peat Ltd. and Stadco Forest Products Ltd. pursuant to Section 5 of the Soil Conservation Act to require the remedial works associated with items (a)(i), (ii), (iii) and (b) of the Order to be completed by 1984 October 21 rather than 1984 September 07."

R E P O R T

BACKGROUND

Council, on 1984 July 23, received the Manager's Report No. 48, Supplementary Item 22 and approved the issuance of the attached Order. Pursuant to Council's instructions this Order was delivered to Meadowland Peat Ltd. and Stadco Forest Products Ltd. on 1984 July 30.

EXISTING SITUATION

Staff has been advised that Meadowland Peat will be acting for both parties with respect to actually undertaking and completing the necessary remedial measures outlined in the Order. Subsequent to the issuance of this Order we were advised that it may be necessary to request an extension to the 1984 September 07 completion date outlined in the Order because of the difficulty in obtaining sufficient quantities of fill to complete the necessary works. On 1984 September 06 we received a formal request from Meadowland Peat Ltd. to extend the time for completion of these works to 1984 October 21.

We have discussed this matter with Meadowland Peat Ltd. and are satisfied that they do intend to comply with the Order and furthermore, that their request for a six week time extension is reasonable given the current availability of fill material.

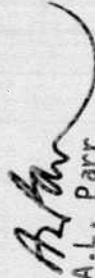
  
A.L. Parr  
DIRECTOR PLANNING &  
BUILDING INSPECTION

PB/mcb  
Attach:

cc: Chief Public Health Inspector  
Municipal Solicitor  
Director Engineering

ITEM SUPPLEMENTARY	11
MANAGER'S REPORT NO.	55
COUNCIL MEETING	1984 09 10

ORDER

The Council of the Corporation of the District of Burnaby pursuant to Section 5 of the Soil Conservation Act hereby orders

Meadowland Peat Ltd.  
(5070 Keith Street, Burnaby, B.C.)

Stadco Forest Products Ltd.  
(5450 Byrne Road, Burnaby, B.C.)

to rehabilitate the lands situate lying and being in the Municipality of Burnaby and more particularly described as:

Lot 18, D.L. 155B, Group 1, Plan 1248, N.W.D.  
Lot 19, D.L. 155B, Group 1, Plan 1248, N.W.D.  
Lot 20, D.L. 155B, Group 1, Plan 1248, N.W.D.

by forthwith complying with the procedures contained in the attached report from MacLeod Geotechnical Ltd. dated 1984 May 04 and, without limiting the generality of the foregoing, to do the following:

- (a) i) Establish a perimeter soil berm and cutoff trench as shown on the attached Figures 2, 3 & 4.
- ii) Re-establish a new site grade by spreading the existing fill over the site and filling the existing depressions. This regrading should be done with some caution so as not to initiate fires within the building debris fill. In addition, the filling should be done from the property edges to the centre so as to avoid generation of a water displacement wave which could cause a sudden discharge of leachate into the nearby ditches.
- iii) Cover the new site grade with a minimal thickness (0.6 m) of relatively impervious soil (till, clay, silt) immediately after regrading the site. The completed surface should slope slightly to the perimeter of the property.
- It is essential that the implementation of Item (a) i), ii), iii) be inspected and certified by a Geotechnical Engineer, preferably from MacLeod Geotechnical Ltd. Staff from the Burnaby Environmental Health Department and the Ministry of Environment will also be available from inspections as required.
- In addition, during the spreading and regrading process the Geotechnical Engineer should be on site to direct the removal of materials (if any) found in the fill considered to be deleterious to the environment.
- (b) A regular monitoring program of water within drainage ditches adjacent to the property to determine the effects of the proposed Stage I remedial works on the water quality within the ditch. This program should also be carried out during any additional site filling work within the property.
- The Burnaby Environmental Health Department will develop the details of this monitoring program. Provision will have to be made for the recovery of costs if this work is undertaken by the Burnaby Environmental Health Department.

(c) Prior to initiating landfill on the Municipal properties a final geotechnical assessment will need to be carried out to determine the success of the remedial program.

Once the site has been regraded, perimeter soil berms installed and the new site grade covered with impervious soil, it will be advantageous to continue a controlled fill program to bring these lands up to the required design grade for future development. This program would be undertaken by Municipal forces or by private contractors on a tree fill basis under the direction and supervision of the Director Engineering. Prior to embarking on this subsequent fill program the success of the remedial program would be reviewed by a Geotechnical Engineer and if any additional measures are found necessary to alleviate any residual environmental or development problems which remain, measures would be established to correct the situation. This review and additional remedial works (if any) would be the responsibility of Meadowland Peat and Stadco Forest Products.

The remedial works associated with items (a) (i), (ii), (iii) and (b) above are to be completed to the satisfaction of the Soil Conservation Enforcement Officer (Director Planning & Building Inspection Department) by 1984 September 07

DATED this 27 day of July, 1984.

The Council of The Corporation of the  
District of Burnaby

  
MUNICIPAL CLERK - AUTHORIZED SIGNATORY

BYRNE CREEK

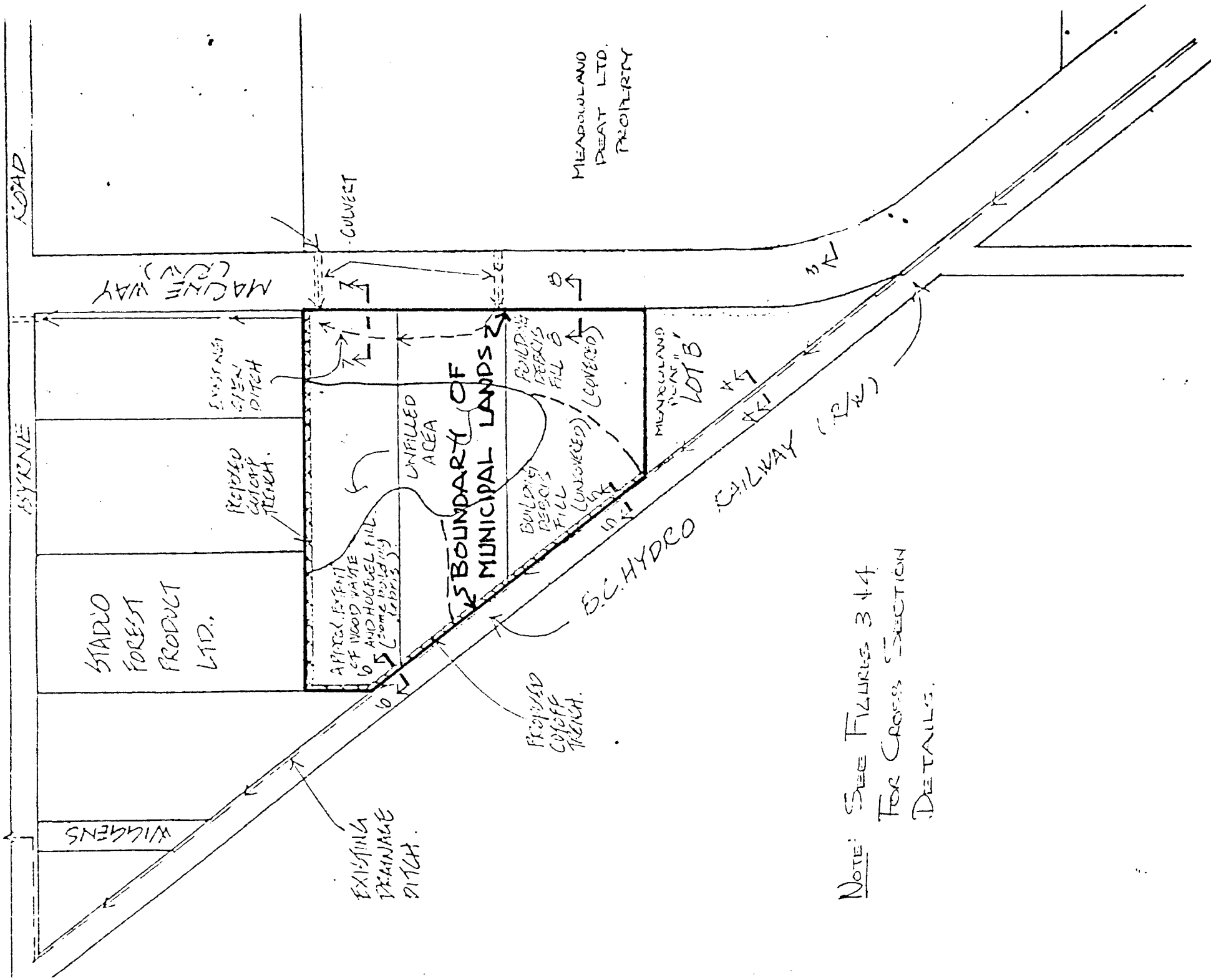

NOTE: SEE FIGURES 3 & 4  
 FOR CROSS SECTION  
 DETAILS.

FIGURE 2  
 1984 JULY 06  
 1:3600 RB



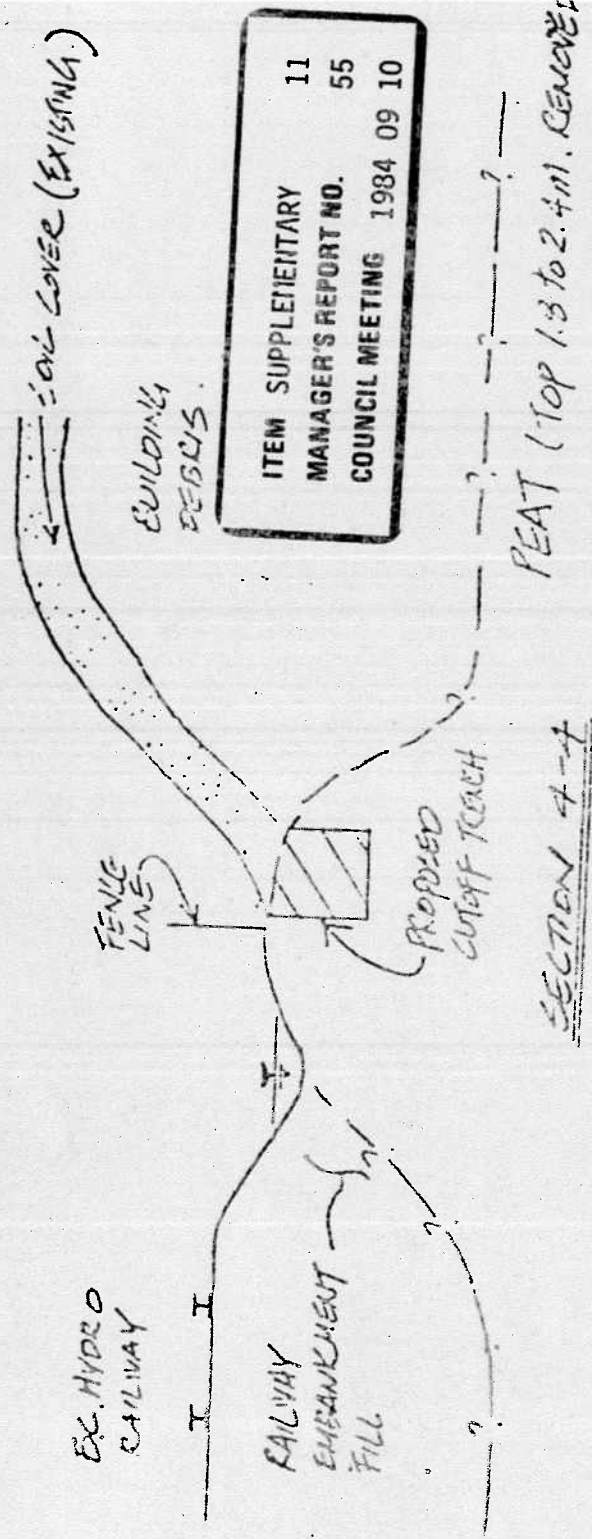

ITEM	11
SUPPLEMENTARY	55
MANAGER'S REPORT NO.	1984 09 10
COUNCIL MEETING	

SECTION 4-4

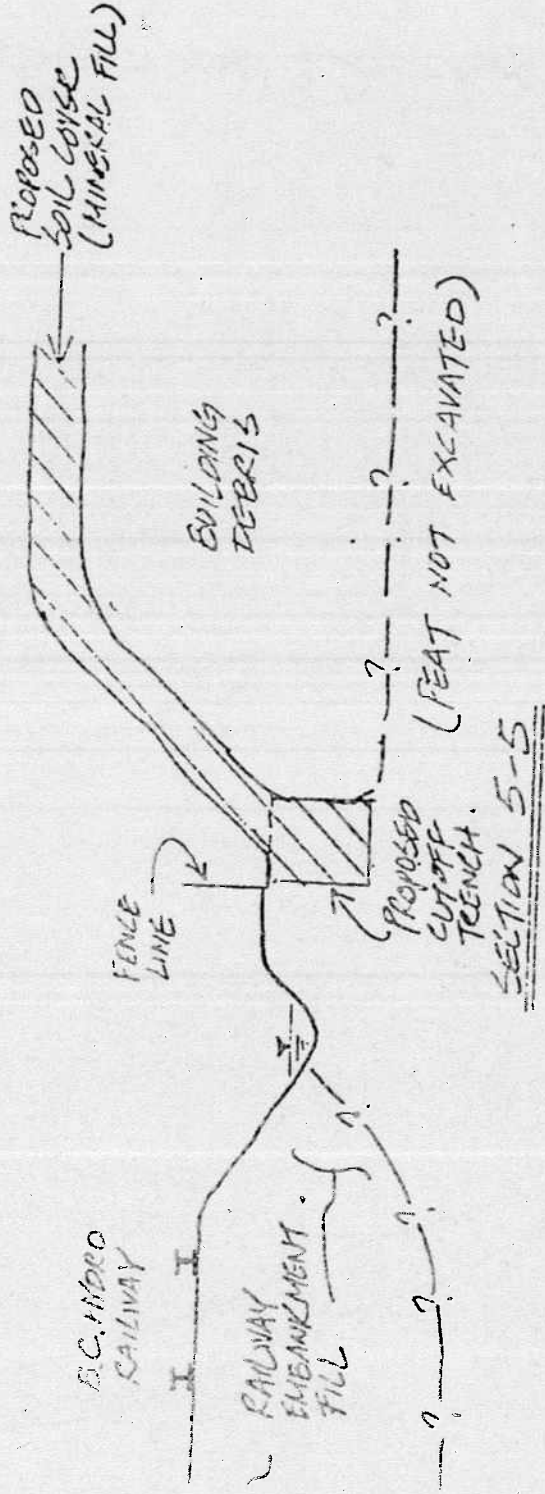

SECTION 5-5

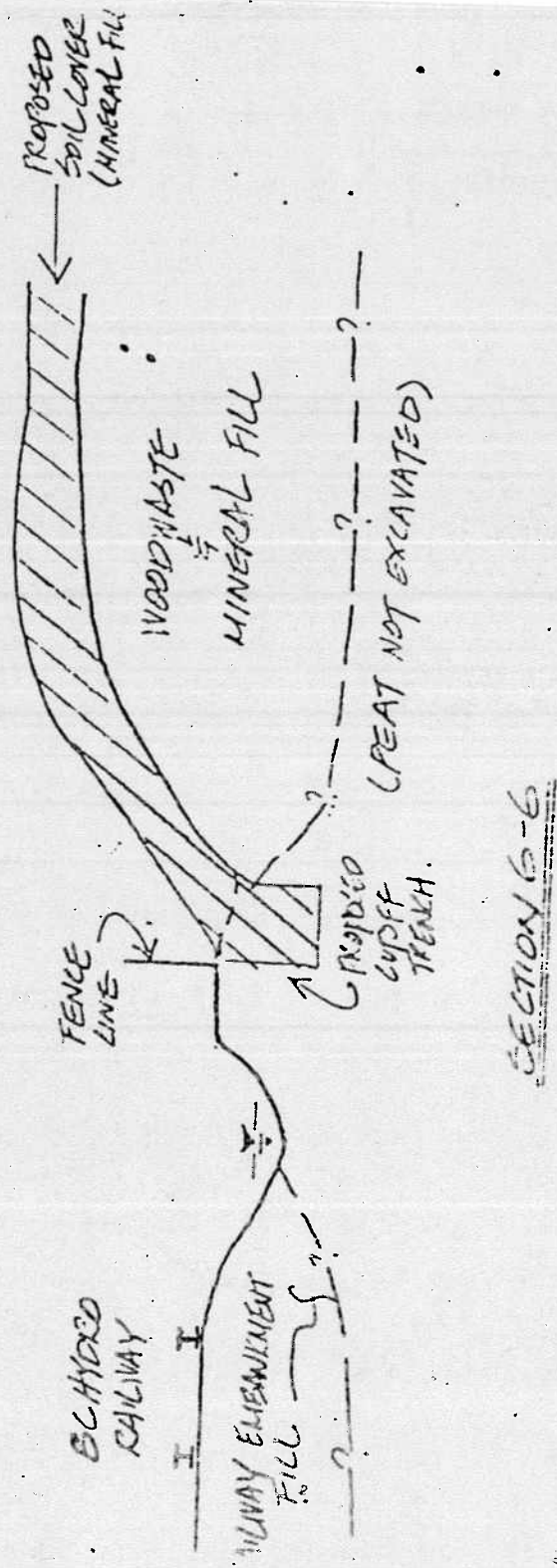

SECTION 6-6

CROSS SECTION  
DETAILS.

FIGURE 3

1984 JULY 06

PB

1:120

ITEM SUPPLEMENTARY 11  
MANAGER'S REPORT NO. 55  
COUNCIL MEETING 1984 09 10

126

1984 July 06  
PR 1:120

FIGURE 4

# CROSS SECTION DETAILS

SECTION 7-7

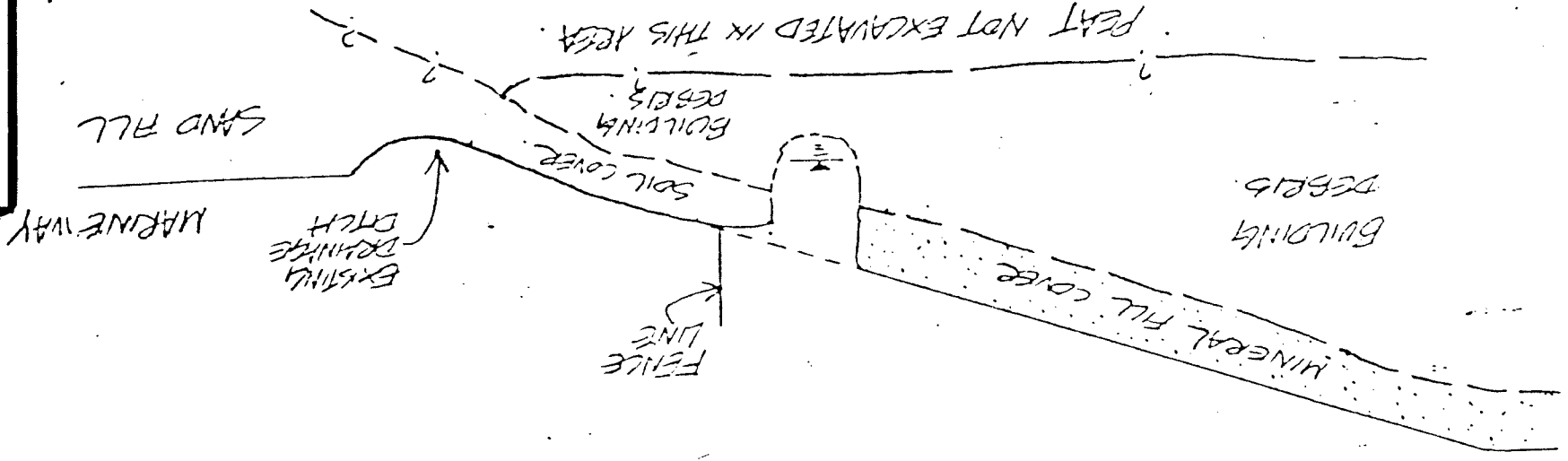

SECTION 8-8

