

RE: SCHOOL BOARD REQUEST TO LEASE PORTION OF CONFEDERATION PARK

MUNICIPAL MANAGER'S RECOMMENDATION:

1. THAT the recommendations of the Director Recreation & Cultural Services be adopted.

* * * * *

ITEM	14
MANAGER'S REPORT NO.	51
COUNCIL MEETING	1983 08 08

1983 AUGUST 02

TO : MUNICIPAL MANAGER
FROM: DIRECTOR RECREATION & CULTURAL SERVICES
RE : SCHOOL BOARD REQUEST TO LEASE PORTION OF CONFEDERATION PARK

RECOMMENDATIONS:

1. THAT Council approve the leasing of approximately ½ acre of Confederation Park as shown on Sketch #OP6-1-52s to the Burnaby School Board for the purpose of developing a playground adjacent to Confederation Park Elementary School.
2. THAT Council instruct the Municipal Solicitor to prepare a lease agreement for a 5 year period at the rate of \$1.00 per year, and authorize the Municipal Clerk to execute the same on behalf of the Municipality.

REPORT

The Burnaby School Board has recently requested permission from the Parks and Recreation Commission to lease approximately ½ acre of Confederation Park to develop a playground for the use of the children at Confederation Park Elementary School.

The site requested is adjacent to the School and is separated from the remainder of Confederation Park by a roadway. The area is shown on the attached Sketch #OP6-1-52s.

Over the past few years the Department has done some clean up and clearing of the subject property at the School's request as the property is mainly used by the school children. A lease on the site will enable the School Board to develop and maintain the site to accommodate the School's needs.

The intent would be to lease the property for a 5 year period at \$1.00 per year and leasing would be subject to an appropriate lease agreement to be drawn by the Municipal Solicitor.

The Commission considered the request of the School Board at its meeting of 1983 August 03 and approved the following recommendations:

1. THAT the Commission approve the leasing of approximately ½ acre of Confederation Park as shown on Sketch #OP6-1-52s to the Burnaby School Board for the purpose of developing a playground adjacent to Confederation Park Elementary School.
2. THAT the lease be drawn by the Municipal Solicitor for a 5 year period at the rate of \$1.00 per year.
3. THAT the Commission so recommend to Council.

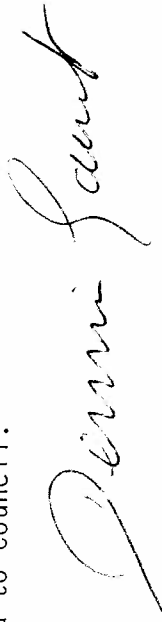

PAL:ps
Attach.

DENNIS GAUNT
Director Recreation &
Cultural Services

cc: Legal & Lands Department

ITEM 14
MANAGER'S REPORT NO. 51
COUNCIL MEETING 1983 08 08

PORTION OF CONFEDERATION PARK PROPOSED FOR LEASE TO SCHOOL BOARD

LEGEND
Park/Municipal Lands
School Board Lands
Area Proposed for Lease
to School Board
Road Allowances (Closed)



DRAWN BY: S. GREEN
DATE: 1983 JULY
SCALE: 1:2000m
DRAWING NO.: OP. 6-1-52s

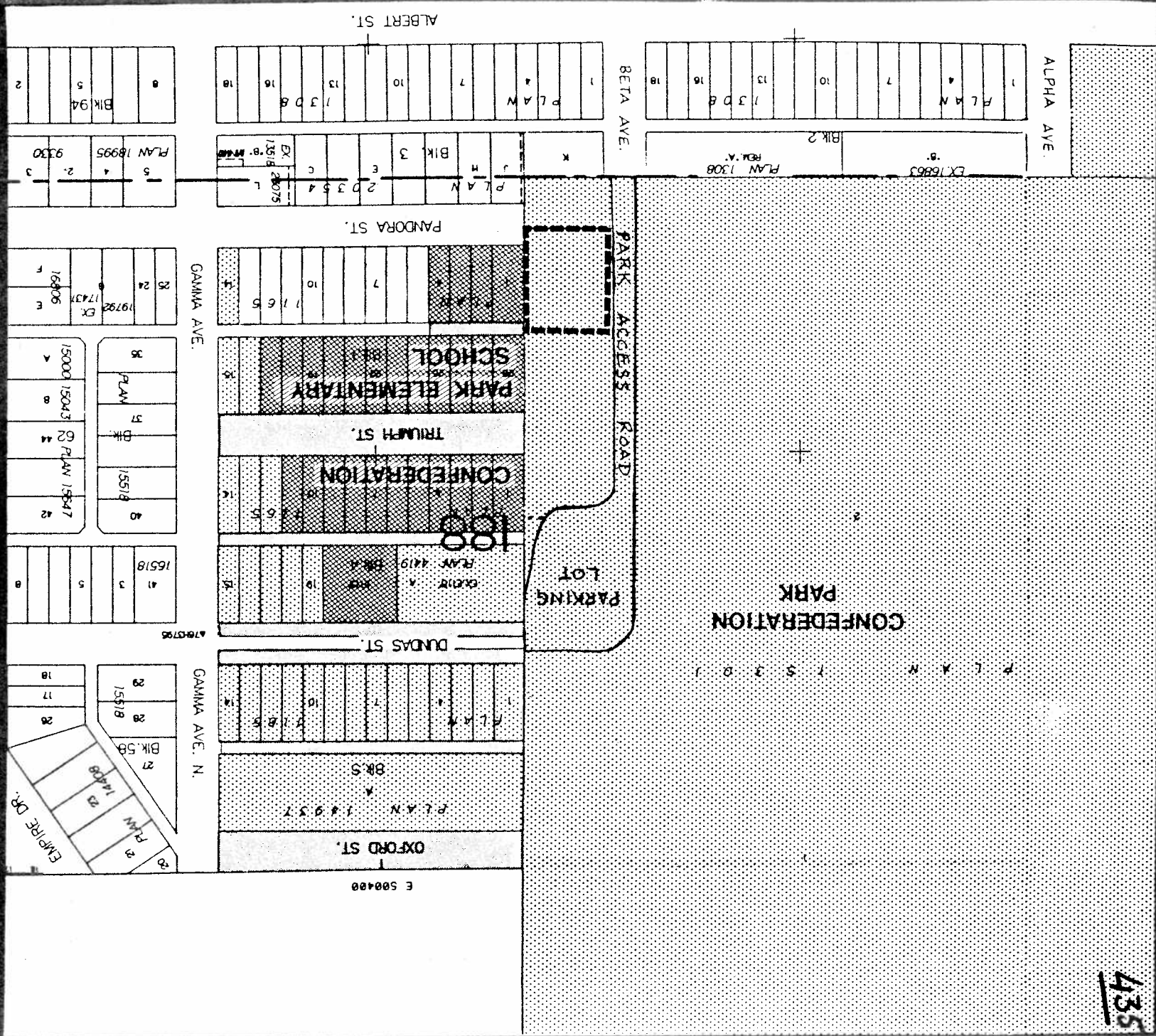

435