

ITEM	1
MANAGER'S REPORT NO.	51
COUNCIL MEETING	1981 10 26

RE: REZONING REFERENCE #103/80  
 7459 TWELFTH AVENUE  
PROPOSED TWELFTH AVENUE CUL-DE-SAC

MUNICIPAL MANAGER'S RECOMMENDATION:

1. THAT the recommendation of the Director of Planning be adopted.

\* \* \* \* \*

TO: MUNICIPAL MANAGER  
 FROM: DIRECTOR OF PLANNING  
 SUBJECT: REZONING REFERENCE #103/80 - 7459 - 12th Avenue (at Kingsway)  
Proposed Twelfth Avenue Cul-de-sac.

DATE: 1981 OCTOBER 7TH

RECOMMENDATION:

1. THAT the proposed cul-de-sac on Twelfth Avenue as illustrated on the attached sketch be constructed as a prerequisite to Rezoning Reference #103/80.

REPORT

The subject rezoning proposal is intended to accommodate a low density multiple family development in conformity with RM1 zoning regulations. When this development proposal was reported to Council on 1981 February 02, the proposed requirement to construct a cul-de-sac on Twelfth Avenue was deleted from the rezoning; however, the land dedication for a cul-de-sac was maintained as a prerequisite and the staff was directed to report further about the cul-de-sac.

This cul-de-sac was recommended as a measure to prevent traffic from Kingsway using Twelfth Avenue as a short cut to Canada Way thereby avoiding the traffic signal on Tenth Avenue. The Planning Department and Traffic Safety Committee have received a number of complaints from

residents and representatives of the St. Thomas More High School and Twelfth Avenue School about vehicles travelling this street at high speeds. This traffic is of particular concern due to the residential, park and school land uses along the street. Pedestrians, particularly children, must frequently cross this street at various points to gain access to these facilities.

At the Public Hearing held on 1981 May 26, strong support was given for the cul-de-sac. Three delegations spoke in favour, a petition containing 149 signatures in favour was submitted and the project architect, on behalf of the rezoning applicant, concurred with the recommendation that the cul-de-sac be constructed. The Public Hearing Minutes are attached to the Third Reading memo for this rezoning, which appears on this agenda.

It is our conclusion that the construction of this cul-de-sac is the appropriate solution to solve the problem of traffic travelling through the neighbourhood and that this construction should be completed in relation to Rezoning Reference #103/80.

*ALP*

CBR/mdw

Attachment

C. C. Municipal Engineer.

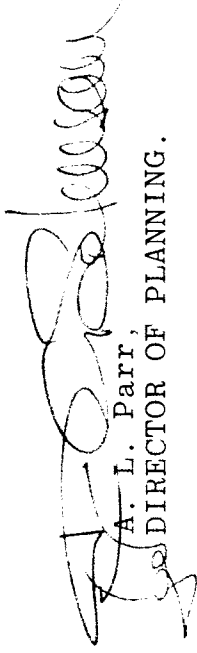

A. L. Parr,  
DIRECTOR OF PLANNING.

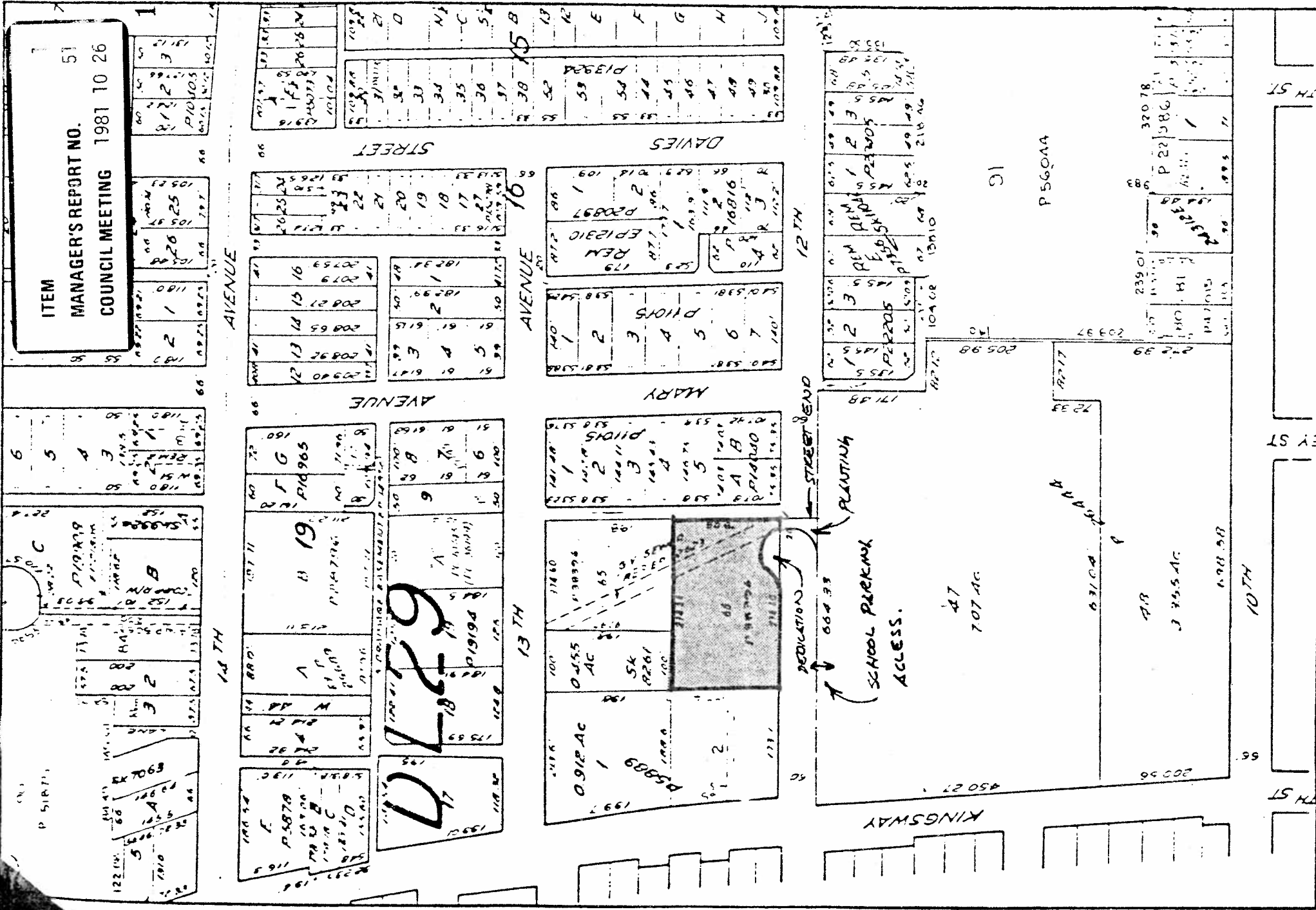

ITEM 51  
 MANAGER'S REPORT NO. 1981 10 26  
 COUNCIL MEETING



Burnaby Planning Department

Date JAN 1981

Scale 1" = 200'

Drawn By  
 ITEM 6  
 MANAGER'S REPORT NO. 9  
 COUNCIL MEETING 1981 02 02

DE ZONINK REFERENCE #101/80

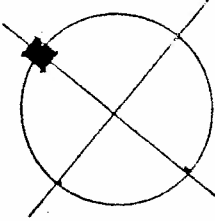

103

SKETCH 1

