

Re: PROPOSED BUSINESS PARK  
N. E. QUADRANT - CANADA WAY AND WILLINGDON

Following is a report from the Director of Planning regarding the proposed development of a municipal property at Canada Way and Willingdon.

RECOMMENDATION:

1. THAT the recommendations of the Director of Planning be adopted.

\* \* \* \*

1981 February 17.

TO: MUNICIPAL MANAGER

FROM: DIRECTOR OF PLANNING

SUBJECT: PROPOSED BUSINESS PARK  
N. E. QUADRANT - CANADA WAY AND WILLINGDON

RECOMMENDATIONS:

1. THAT staff be authorized to advertise the parcel for sale together with the upset price which will be accepted for it.
2. THAT upon completion of the C.U.P.E. strike, a rezoning report be prepared and a public hearing date be set in order to rezone the site from M1 to CD (M5 guidelines).
3. THAT Teleglobe Canada be advised when the site in which they are interested is to be made available for sale.

REPORT

Late in 1980, Mr. P. Bloxham the Commercial and Industrial Coordinator, provided Teleglobe Canada with information on potential sites within Burnaby that would be suitable for the location of Teleglobe's Regional Office and plant facility.

Teleglobe Canada is a high technology industry in the field of international communications, requiring a site on which to construct a 45,000 sq. ft. building to accommodate equipment and office space for operating personnel.

Included in the eleven potential areas provided to Teleglobe Canada was the municipally owned site at Canada Way and Willingdon which is currently being prepared for development as a Business Park.

A letter has now been received from Teleglobe Canada indicating that they are interested in acquiring a serviced site of approximately 3 acres within the municipal development located on Beta Avenue immediately adjacent to Imperial Square, as shown on the attached Figure A. This site is compatible with the overall plan prepared for this area.

Teleglobe Canada would be a desirable addition to the employment base of Burnaby; and it is therefore proposed that steps be taken to avoid undue delay resulting from the work stoppage. To this end, a survey plan will be prepared; and due to the absence of municipal staff an appraisal has been ordered from a consultant in order to determine the upset price for the property, the results of which will be made available to Council prior to initiating the sale. The costs associated with the preparation of a survey plan and appraisal will be charged to Code 70 of the Capital Improvement Program - Land Assembly and Development.

In the meanwhile it would be desirable for the Municipal Council to provide Teleglobe with an indication of municipal support for their plan to locate in Burnaby.



A. L. Parr,  
DIRECTOR OF PLANNING.

ALP:bp  
Attach.

c.c. Legal and Lands Department  
Engineering Department

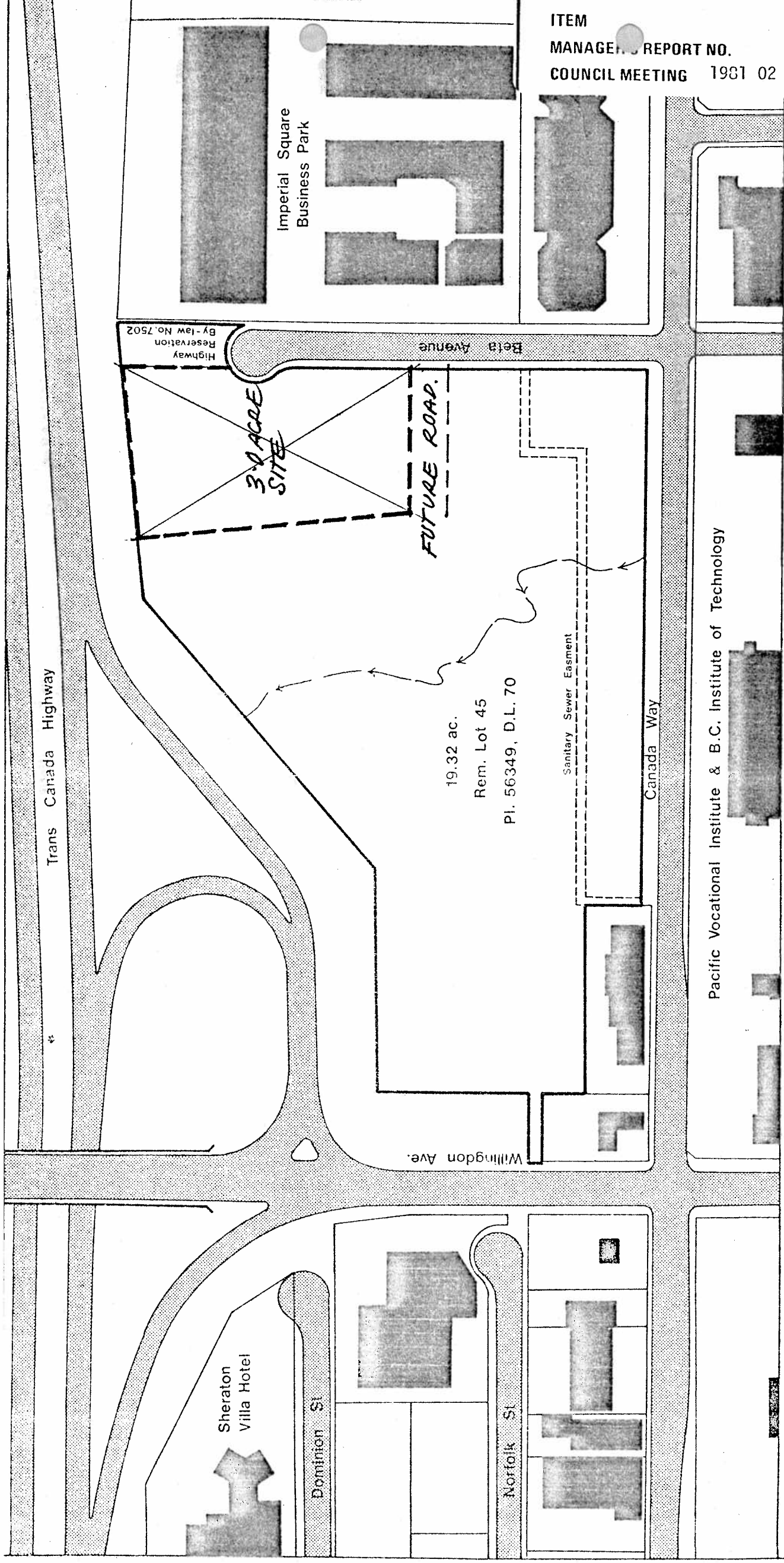

ITEM  
 MANAGEMENT REPORT NO. 6  
 COUNCIL MEETING 1981 02 23

Figure A

PROPOSED SUBDIVISION  
 OF 3 ACRE SITE.  
 FEBRUARY 1981.

Site for Proposed Business Park

N.E. Quadrant - Canada Way & Willingdon

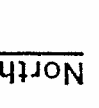

Scale: 1" = 200'

1980 July