

ITEM	1
MANAGER'S REPORT NO.	33
COUNCIL MEETING	1981 07 13

RE: PROPOSED CLOSURE OF A WATERCOURSE
SUBDIVISION REFERENCE #18/81

Following is a report from the Approving Officer regarding the proposed enclosure of a watercourse.

RECOMMENDATION:

1. THAT the recommendation of the Approving Officer be adopted.

TO: MUNICIPAL MANAGER	PLANNING DEPARTMENT
FROM: APPROVING OFFICER	1981 JUNE 29
RE: SUBDIVISION REFERENCE #18/81 (D.L. 59, BLK. 9, PCL. 'B' (EX.PL. 9840) WATERCOURSE	PLAN 3795

RECOMMENDATION:

1. THAT Council authorize the enclosure of the watercourse through the subject subdivision in a manner satisfactory to the Municipal Engineer.

SUMMARY:

Due to the location of an existing watercourse in the above referenced subdivision and its conflict with proposed lots, it is necessary that the watercourse be enclosed within the subdivision.

REPORT

Council, on 1980 December 01, authorized the enclosure of a watercourse through properties at Lawrence Drive, Lawrence Street, Phillips Avenue and Lougheed Highway (Subdivision Reference #84/80).

We are in receipt of an application to subdivide the subject property which is adjacent to the aforementioned subdivision as shown on the attached sketch.

A watercourse traverses the site which will restrict developable areas of the proposed lots. A site visit revealed that the watercourse is shallow, is approximately 1 m wide and is fairly well defined. The site area around the watercourse is well treed and undeveloped. Any aesthetic value and naturalness that the watercourse presently offers would be lost if it were relocated as most of the surrounding trees and vegetation would be destroyed in the process.

We therefore, have no alternative but to recommend that the watercourse be enclosed within the subdivision in a manner satisfactory to the Municipal Engineer.

A. L. Parr,
APPROVING OFFICER

CW:ad
Att.
cc: Municipal Engineer

D.L. 59
 BLK. 9
 PCL. "B" (EX. PL. 9840)
 PLAN 3795

S.D. REF. #18/81

ZONING: R2

ITEM	1
MANAGER'S REPORT NO.	33
COUNCIL MEETING	1981 07 13

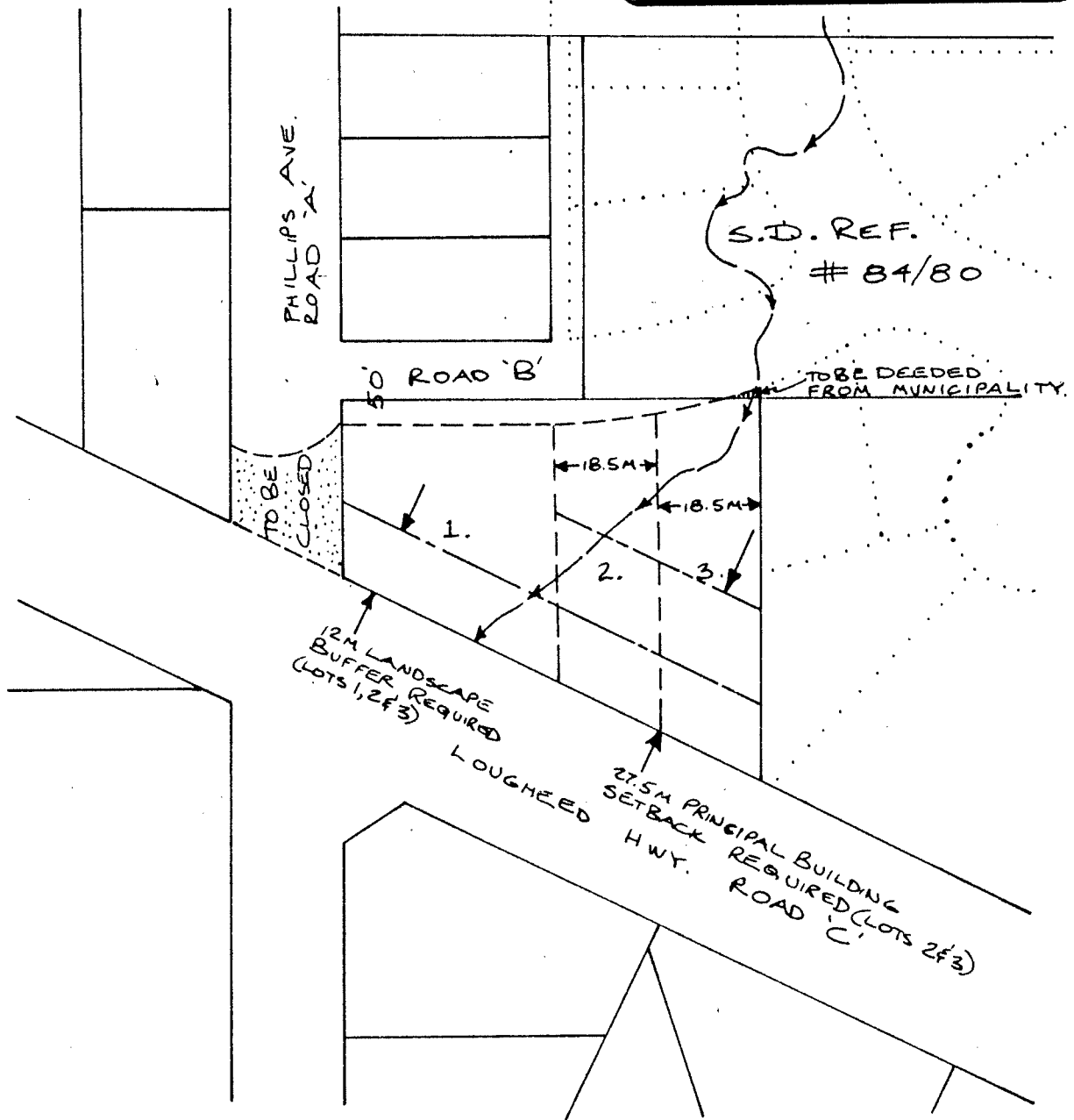

NOTE: ① SURVEYOR'S PLOT PLAN REQUIRED FOR EXISTING BUILDINGS ON PROPOSED LOT 1.



SCALE: 1" = 100'
 1981 JUNE C.W.