

ITEM	10
MANAGER'S REPORT NO.	36
COUNCIL MEETING	1980 05 12

Re: BONSOR PARK EXPANSION  
 BUILDING DEMOLITION - 6789 JUBILEE AVENUE  
LOT 25, S $\frac{1}{2}$ , BLOCK 25, D.L. 152, PLAN 2000, N.W.D.

Following is the report of the Parks and Recreation Administrator regarding the above subject.

RECOMMENDATION:

1. THAT the report of the Parks and Recreation Administrator be adopted.

\* \* \* \*

1980 May 08

TO: MUNICIPAL MANAGER  
 FROM: ADMINISTRATOR, PARKS AND RECREATION  
 RE: BONSOR PARK EXPANSION  
 BUILDING DEMOLITION - 6789 JUBILEE AVENUE  
LOT 25, S $\frac{1}{2}$ , BLK 25, D.L. 152, PLAN 2000 N.W.D.

Recommendation:

1. THAT Council authorize the demolition of the commercial structure at 6789 Jubilee Avenue, Lot 25, S $\frac{1}{2}$ , Blk. 25, D.L. 152, Plan 2000, N.W.D.

REPORT

The subject property, shown on attached sketch, was acquired on 1980 January 21 as part of the Bonsor Park expansion. Current plans for this expansion anticipate development of this site in 1983.

The commercial structure on the property would require a new roof, new flooring and repairs to the plumbing fixtures before it could be re-rented. Furthermore, the Legal and Lands Department advise that as the tenancy would be limited to two years, they would have difficulty securing a tenant. In view of these circumstances, the Parks and Recreation Commission, at its meeting of 1980 May 07, approved the demolition of the commercial structure at 6789 Jubilee Avenue, the necessary funds being available in the Parks and Recreation Land Acquisition budget.

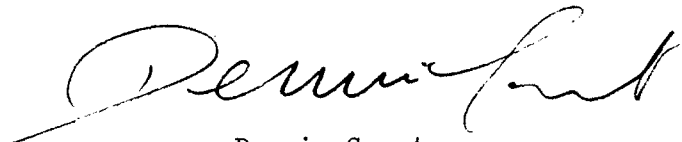

Dennis Gaunt,  
 Administrator

AG:df  
Attach.

c.c. Municipal Solicitor  
 Municipal Treasurer  
 Purchasing Agent

ITEM 10  
 MANAGER'S REPORT NO. 36  
 COUNCIL MEETING 1980 05 12

123

18.93 Ac.

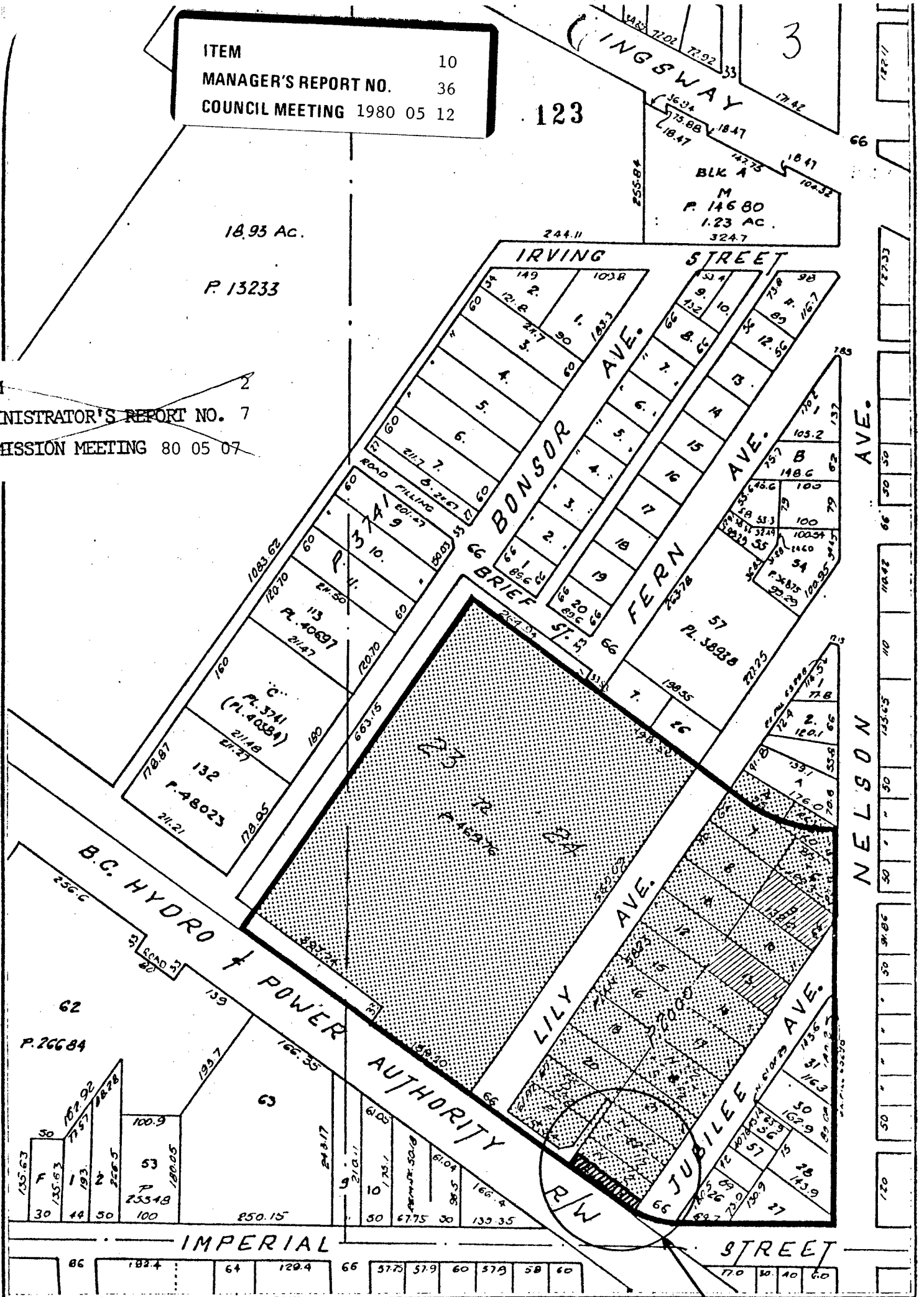

P. 13233

ITEM 2  
 ADMINISTRATOR'S REPORT NO. 7  
 COMMISSION MEETING 80 05 07

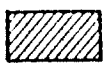

Subject Property

# BONSOR PARK - - STAGE 2.~

-  Proposed Acquisition
-  Existing Park
-  Proposed Park Area

ATTACHMENT NO:1

Scale: 1" = 200'

