

ITEM	5
MANAGER'S REPORT NO.	73
COUNCIL MEETING	1979 10 29

Re: INSTALLATION OF A BURNABY ENTRANCE SIGN AND
ASSOCIATED LANDSCAPING
7810 - 7880 KINGSWAY
(ST. THOMAS MORE HIGH SCHOOL AND OUR LADY OF MERCY CHURCH)

Following is a report from the Parks and Recreation Administrator regarding a proposal to execute a lease for the installation of an entrance sign on Kingsway.

The low maintenance landscaping would consist primarily of trees and shrubs in bark mulch fronted by a grass strip with a small flower bed around the sign. A provision in the amount of \$1,350 will be set aside in the 1980 budget for this work.

RECOMMENDATION:

1. THAT the recommendation contained in the report from the Parks and Recreation Administrator be adopted.

* * * * *

TO: MUNICIPAL MANAGER

FROM: PARKS & RECREATION ADMINISTRATOR 1979 October 18.

RE: INSTALLATION OF BURNABY ENTRANCE SIGN AND
ASSOCIATED LANDSCAPING - 7810 - 7880 KINGSWAY
ADJACENT TO KINGSWAY BETWEEN 10TH AND 12TH AVENUES
LOTS 47 and 48, BLOCK 10, PLAN 26444.

RECOMMENDATION:

1. THAT Council authorize execution of an appropriate long-term lease with St. Thomas More High School and Our Lady of Mercy Church for a nominal sum of \$1.00 per year for the property outlined in the Director of Planning's Report dated 1979 September 25, for the purpose of installing a Burnaby Entrance Sign.

REPORT

The attached report from the Director of Planning dated 1979 September 25 was received by the Parks and Recreation Commission at its meeting of 1979 October 17, and approved.

This is a continuation of the Burnaby Beautification Committee's Entrance Sign Program and funds are available in the Committee's 1979 budget. Maintenance will be the responsibility of the Parks and Recreation Department.

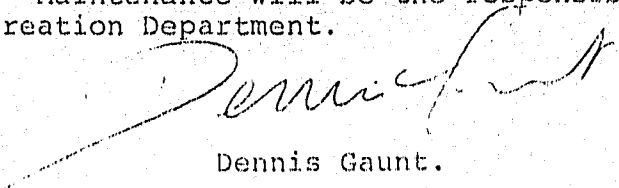
Dennis Gaunt.

AG

c.c. Director of Planning
Legal & Lands
Burnaby Beautification Committee

ITEM	5
MANAGER'S REPORT NO.	73
COUNCIL MEETING	1979 10 29

ITEM	7
ADMINISTRATOR'S REPORT NO.	20
COMMISSION MEETING	79 10 17

PLANNING DEPARTMENT
1979 September 25

114

TO: PARKS AND RECREATION ADMINISTRATOR
FROM: DIRECTOR OF PLANNING
SUBJECT: INSTALLATION OF BURNABY ENTRANCE SIGN AND ASSOCIATED LANDSCAPING - 7810 - 7880 KINGSWAY ADJACENT TO KINGSWAY BETWEEN 10TH & 12TH AVENUES LOTS 47 AND 48, BLOCK 10, PLAN 26444

RECOMMENDATIONS:

1. THAT the Parks and Recreation Commission endorse the proposed lease and entry sign/landscaping project and recommend approval to the Municipal Council.

REPORT

Pursuant to the Burnaby Beautification Committee's program involving the installation of entry signs at major entrance points of the Municipality, the Committee on 1979 May 03 authorized two of its members to meet with officials of the St. Thomas More High School and Our Lady of Mercy Church regarding the possibility of installing an entrance sign and landscaping on their respective properties adjacent to Kingsway.

The proposed entrance sign and landscaping together will cover an area approximately 9.75 m (32 ft.) wide and 155.2 m (510 ft.) long (refer to attached Sketch). An appropriate plan illustrating the location of the entrance sign and landscaping details has been prepared and submitted to the Church and School authorities who have agreed in principle to the proposal on the understanding that the said area would be leased to the Municipality.

The monies required to install the works will be obtained from the Burnaby Beautification Committee's 1979 Operational Budget under item 2 - "Entry Signs". It is intended that the leased area will be maintained by the Parks and Recreation Department, as are the other three entry sign locations.

In order to implement this proposal, it will be necessary for the Municipal Council to authorize the preparation of an appropriate long-term lease with the Church and School. The lease should include a 99-year term for a nominal sum of \$1.00 per year, and should require the Municipality to maintain the specified area.

AW
PDS:11

A. L. PARR
DIRECTOR OF PLANNING

Attachment

cc: Burnaby Beautification Committee

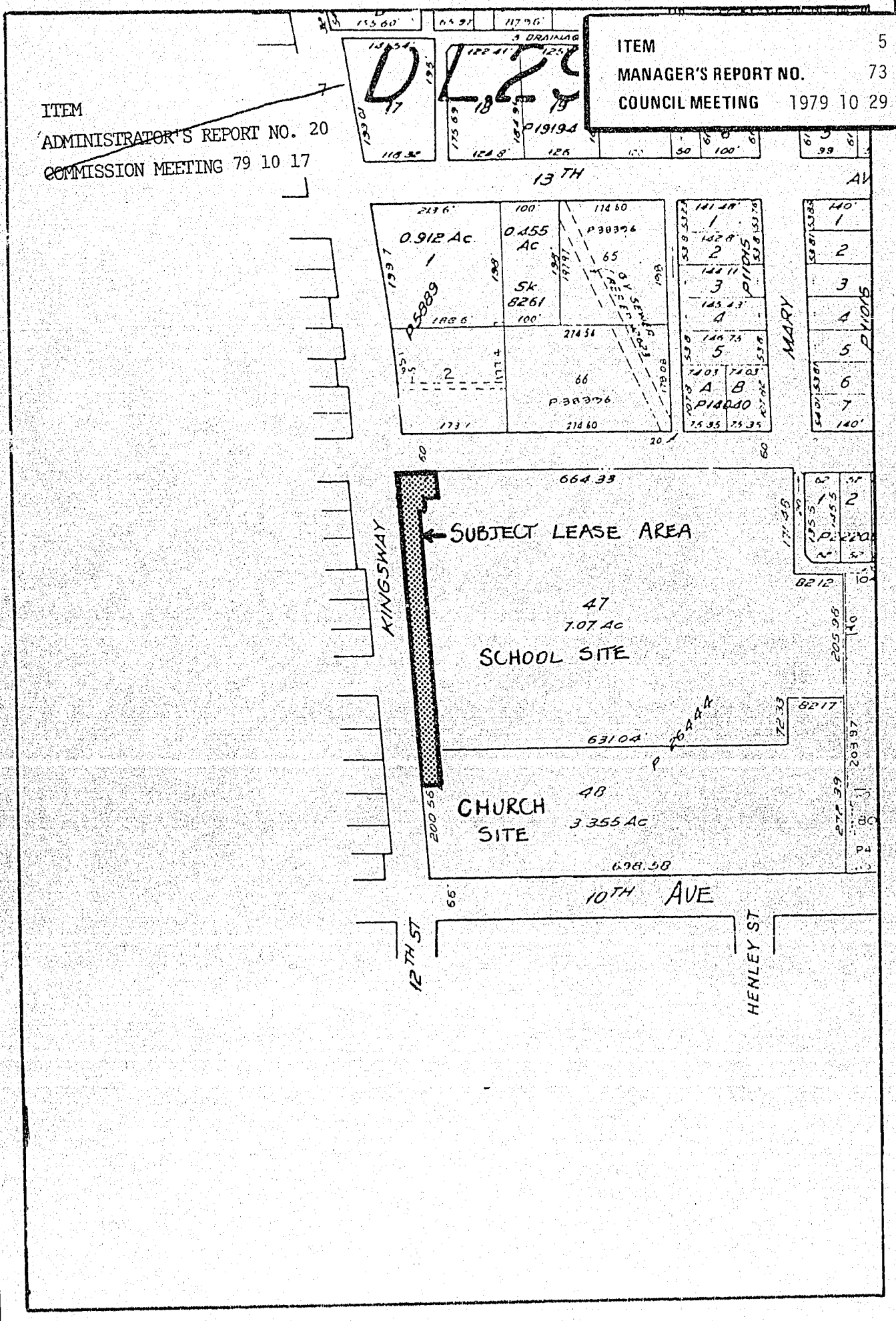

ITEM
ADMINISTRATOR'S REPORT NO. 20
COMMISSION MEETING 79 10 17

ITEM 5
MANAGER'S REPORT NO. 73
COUNCIL MEETING 1979 10 29

Date
1979/OCT

Scale
1:2400

Drawn By

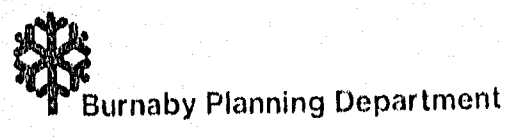

SKETCH

