

ITEM	16
MANAGER'S REPORT NO.	12
COUNCIL MEETING	1979 02 12

RE: MYRTLE STREET ROAD IMPROVEMENTS  
BETWEEN INGLETON AVENUE AND GILMORE AVENUE

Following is a report from the Director of Planning regarding proposed road improvements to a portion of Myrtle Street.

Attached is a statement of funds that are available for servicing of land.

RECOMMENDATION:

1. THAT the recommendation of the Director of Planning be adopted.

\*\*\*\*\*

TO: MUNICIPAL MANAGER 1979 FEBRUARY 07  
 FROM: DIRECTOR OF PLANNING OUR FILE: 08.640  
 X. REF.: 02.264  
 SUBJECT: MYRTLE STREET ROAD IMPROVEMENTS  
 BETWEEN INGLETON AVENUE AND GILMORE AVENUE

RECOMMENDATION:

1. THAT Council authorize the release of the necessary monies from the Land Development and Assembly Fund to be allocated for the improvement of Myrtle Street as described in this report.

REPORT

1.0 BACKGROUND INFORMATION:

- 1.1 In consideration of Rezoning Reference #37/73 involving Municipally-owned properties that were intended to be developed for light industrial uses as part of a land exchange between the Municipality and Vanant Development Company, Council on 1973 October 01 authorized the expenditure of \$88,100 for preservicing the site (see attached sketch). These monies were intended to be recovered from the sale of Municipal properties located to the west of the site which would also be serviced by the works to be constructed. Subsequently, Council on 1976 June 21 gave Final Adoption to Rezoning Reference #8/76 involving the sale of the adjacent Municipal properties.

ITEM 16  
 MANAGER'S REPORT NO. 12  
 COUNCIL MEETING 1979 02 12

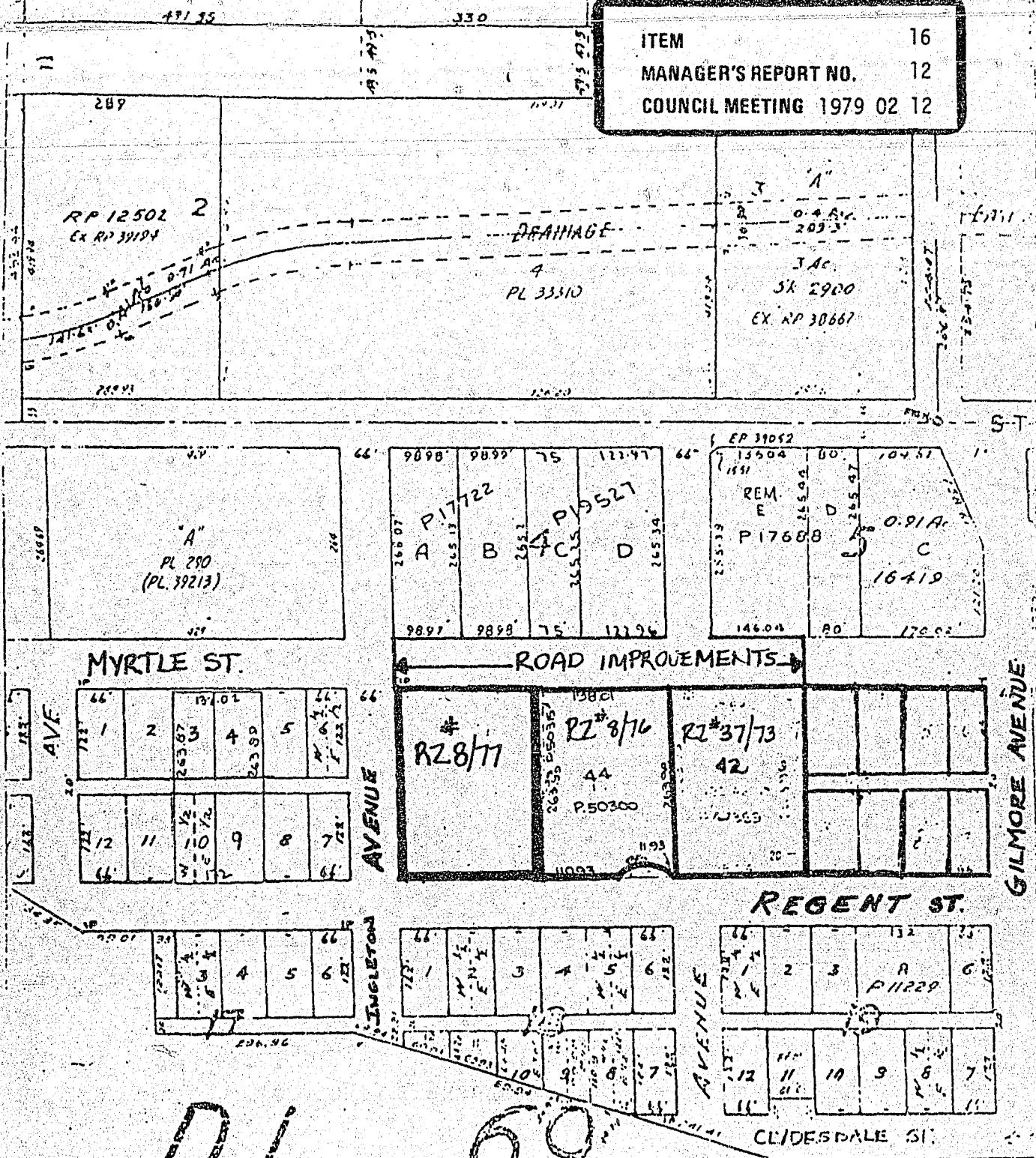

DL 69

TRANS CANADA HWY.

P 26625

ACQUIRED BY  
 DEPT OF HWY

Date  
 1979/JAN.



Burnaby Planning Department



Scale  
 1:2400

SKETCH # 1