

ITEM	5
MANAGER'S REPORT NO.	83
COUNCIL MEETING	1979 12 10

RE: CONSTRUCTION OF A FENCE  
 LOT 47, BLOCK 24, D.L. 6, GROUP 1, PLAN 25211, N.W.D.  
 9730 SULLIVAN STREET (HALL)

Following is a report from the Municipal Solicitor regarding the proposed construction of a new fence on a property on Sullivan Street.

As noted in a report which Council received on 1979 August 27 (Item 4, In-Camera Report No. 58), the municipality had an opportunity to purchase that portion of the subject property which was required for the completion of the Reese Avenue right-of-way to a standard width of 66 feet between Sullivan and Cameron Streets. The purchase was subsequently executed with an understanding that the municipality would relocate the cedar fence that was situated on this particular portion of the property.

This report is being referred to Council because what is being proposed (construction of a new fence) is a deviation from what was adopted in the form of a recommendation (relocation of a fence) when this matter was previously considered on 1979 August 27.

RECOMMENDATION:

1. THAT the recommendation of the Municipal Solicitor be adopted.

\* \* \* \* \*

NOVEMBER 27, 1979

TO: MUNICIPAL MANAGER  
 FROM: MUNICIPAL SOLICITOR  
 RE: REESE AVE. RIGHT OF WAY BETWEEN CAMERON & SULLIVAN STREETS,  
 COMMUNITY PLAN AREA "G", PTN OF 9730 SULLIVAN STREET (HALL),  
 LOT 47, BLK 24, D.L. 6, GRP. 1, PLAN 25211, N.W.D.

RECOMMENDATION:

1. THAT 122 Lineal foot fence, 4 ft. high be erected at 9730 Sullivan Street at a cost to the Municipality of \$1,200.00.

REPORT

Council at its meeting of August 27, 1979 received an "In-Camera" report from the Director of Planning (Item 4 Manager's Report 58). A recommendation was adopted authorizing the acquisition of 181.5 m<sup>2</sup> (1,952 sq. ft.) of the subject property as shown cross-hatched on the attached sketch for the sum of \$7,808.00 plus the relocation of an existing fence. Due to the condition of the existing fence, Mr. Hall has now requested that a new solid 4 ft. high cedar fence be constructed by the Municipality. We have estimated the cost of the new fence at \$1,200.00. Combined with cost of labour and the replacement of posts etc. the cost of moving the existing fence could be as much as a new fence. This additional sum brings the total acquisition cost up to \$9,008.00, or \$4.61 per sq. ft.. This is consistent with the residential land values in the area.

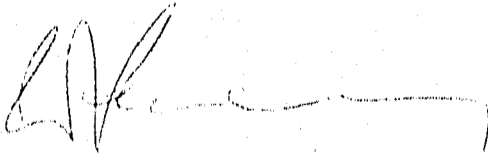

W.L. Stirling  
 MUNICIPAL SOLICITOR

FAE:sc  
attachment

cc: Municipal Treasurer  
 Director of Planning  
 Chief Building Inspector

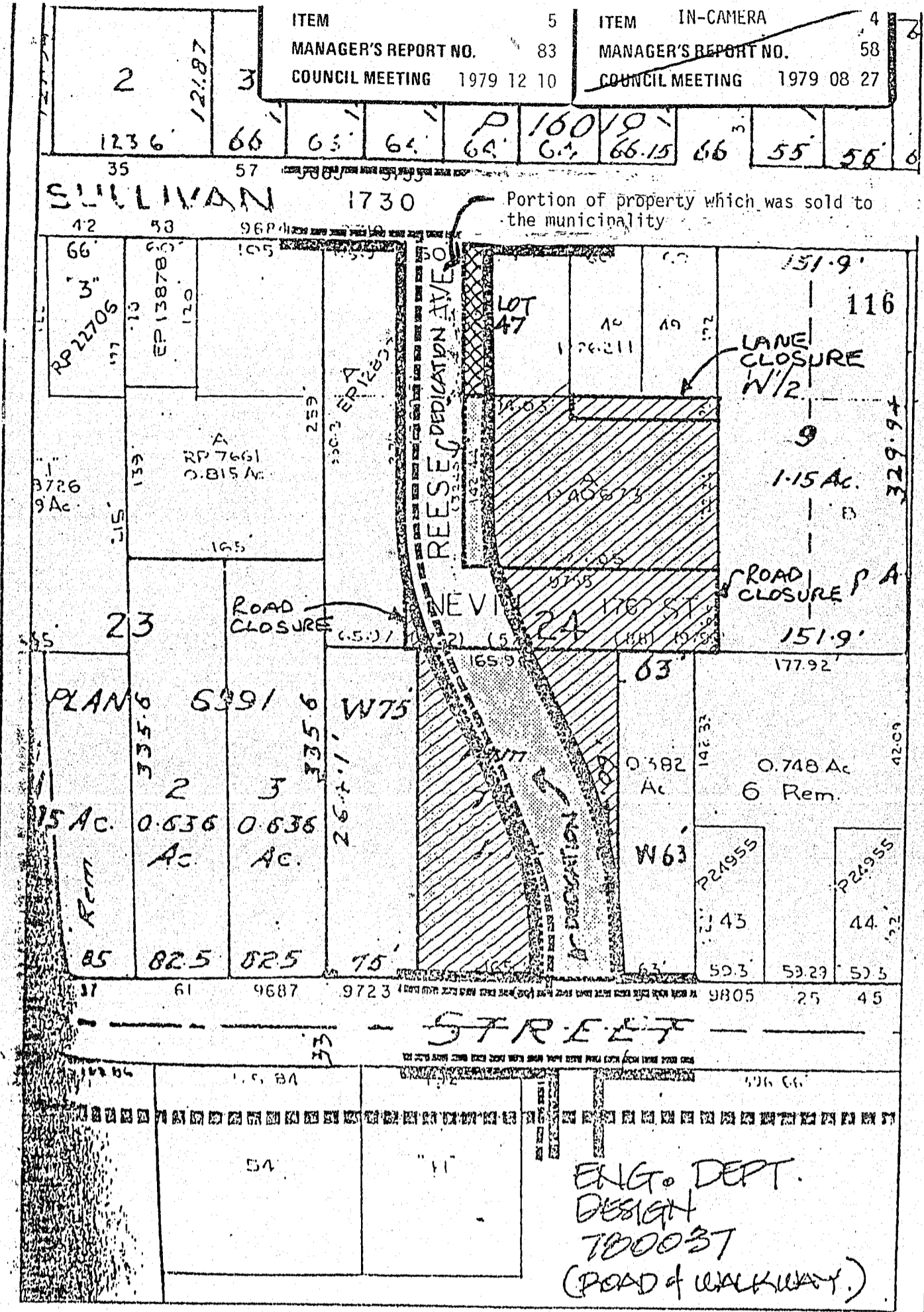

Date  
JUNE 79

Scale  
1" = 100'

Drawn By



Burnaby Planning Department  
 PUBLIC WALKWAY IN REESE AVE. R/W  
 ROAD EXCHANGE BYLAW



AFTER ROAD EXCHANGE BYLAW  
 RESULTING MUNICIPAL OWNERSHIP.

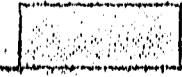

CURRENTLY  
 MUNICIPALLY OWNED

R.C. REF. # 11/79  
 D.L.G.

SKETCH # 2.

