

Re: SUBDIVISION REFERENCE #56/75  
HIGHWAY EXCHANGE BY-LAW

ITEM	20
MANAGER'S REPORT NO.	50
COUNCIL MEETING	Aug. 3/76

Following is a report from the Director of Planning, dated July 28, 1976, dealing with the relocation of the road allowance designated "A" on the attached sketch and the dedication of a portion of Municipal land to provide access to Road "A" as prerequisites to final approval of the above noted subdivision.

The necessary transactions would be effected by the passage of a highway exchange by-law and the developer has agreed to pay the Corporation the sum of \$10,500 and has submitted the necessary by-law plans, etc.

RECOMMENDATION:

1. THAT Council approve the introduction of a highway exchange by-law as outlined in the Director of Planning's report.

\* \* \* \*

PLANNING DEPARTMENT  
July 28, 1976

TO: MUNICIPAL MANAGER  
FROM: DIRECTOR OF PLANNING  
SUBJECT: SUBDIVISION REFERENCE #56/75  
HIGHWAY EXCHANGE BYLAW

One of the prerequisites to final approval of the above noted subdivision is the relocation of the road allowance designated "A" on the attached sketch. It is also required that a portion of municipal land be dedicated to provide access to Road "A" from Morley Drive and that access to Road "A" from Canada Way be disallowed by the introduction of a cul-de-sac and road closure. It is proposed that all of the above transactions be effected by the passage of a highway exchange bylaw. The Land Agent has estimated the difference in value between the areas being exchanged at \$10,500. This amount of compensation is to be paid to the Corporation. The developer has agreed to the payment of this amount and has submitted the necessary bylaw plans, etc.

RECOMMENDATION:

THAT Council approve the introduction of a highway exchange bylaw as outlined above.

  
A. L. Parr  
DIRECTOR OF PLANNING

HR:hr  
Attch.

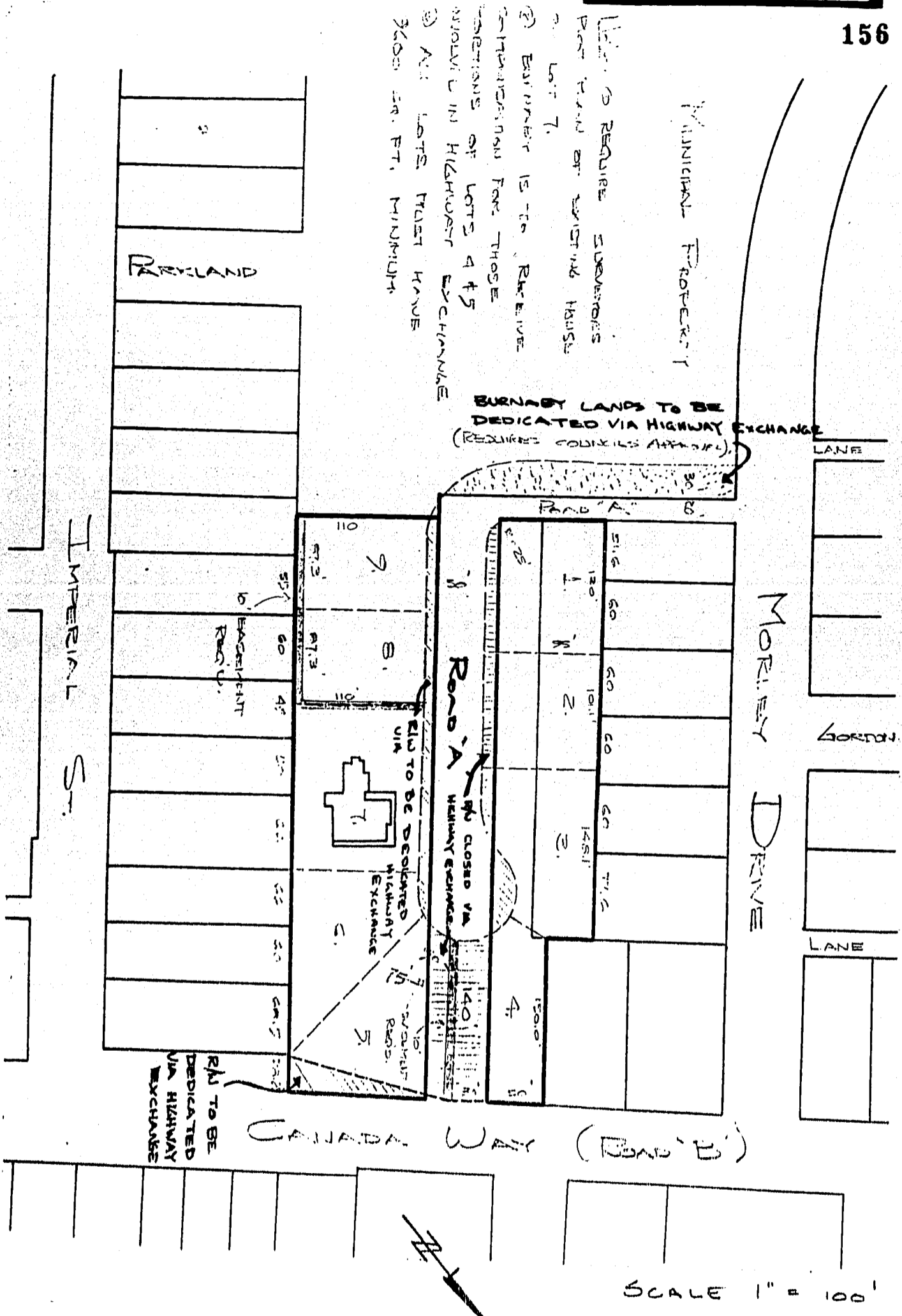

① ALL LOTS MUST HAVE 3000 SQ. FT. MINIMUM

② BURNABY 15.70 RECEIVE CERTIFICATIONS FOR THOSE PORTIONS OF LOTS 4 & 5 ADJACENT IN HIGHWAY EXCHANGE

③ ALL LOTS MUST HAVE 3000 SQ. FT. MINIMUM

BURNABY LANDS TO BE DEDICATED VIA HIGHWAY EXCHANGE (REQUIRES COUNCIL'S APPROVAL)

ROAD A

CANADA WAY (ROAD B)

MORLEY DRIVE

IMPERIAL ST.

BURNABY

LANE

GORDON

LANE

SCALE 1" = 100'

