

Re: LETTER FROM VICTOR AND MURIEL LOVE
PROPERTY AT 8720 GOVERNMENT ROAD
(ITEM 9, REPORT NO. 71, NOVEMBER 8, 1976)

ITEM	8
MANAGER'S REPORT NO.	75
COUNCIL MEETING	Nov. 22/76

Appearing on the agenda for the November 22, 1976 meeting of Council is a letter from Victor and Muriel Love regarding their property at 8720 Government. Following is a report from the Director of Planning on this matter.

RECOMMENDATION:

1. THAT a copy of this report be sent to Victor and Muriel Love.

* * * *

Planning Department
November 17, 1976

File #03.402/10
PA-86-P-72

TO: MUNICIPAL MANAGER
FROM: DIRECTOR OF PLANNING
RE: LOVE PROPERTY - PARCEL "B", PLAN 17411, BLOCK 12, D.L. 10, PLAN 3054,
8720 GOVERNMENT ROAD

The following report item has been prepared in response to the letter of November 9, 1976 from Victor and Muriel Love which was addressed to the Mayor and Council.

As mentioned in our report of November 5, 1976, the subject property was included as part of the Burnaby Lake Regional Park Complex in the North-East Burnaby Study of 1966 and the Park Sites Review report of 1967, both of which were approved by the Council. Since that time, a number of further actions have been taken which reaffirm these earlier decisions.

The Burnaby Lake Development Committee, composed of representatives of the Municipal Council, the Parks and Recreation Commission, and the GVRD, approved the overall boundaries of the Central Valley Park System, which included Parcel "B", on March 29, 1972. The area covered by this system is shown on the attached Map "A".

ITEM	8
MANAGER'S REPORT NO.	75
COUNCIL MEETING	Nov. 22/76

Love Property
Parcel "B", Plan 17411, Block 12, D.L. 10, Plan 3054-8/20 Government Road
Page 2

120

These recommended park boundaries were adopted by the Council on April 24, 1972, and subsequently confirmed by the passing of an amendment to the Official Regional Plan which extended the PRK-2 (Future Park Development Area) classification to the Burlington-Northern Railway on the east and the Freeway on the south, an area which included the subject property. The present Regional Plan development designations in the Burnaby Lake area are outlined on Map "B".

A further action taken by the Burnaby Lake Development Committee, and one which was subsequently approved by both the Council and the GVRD, was the division of areas of jurisdiction and responsibility within the boundaries of the Burnaby Lake Regional Park Complex. These are shown on Map "C".

It appears that it is this aspect of the Burnaby Lake Regional Park Plan which has caused some confusion, as evidenced in the letter from Victor and Muriel Love. As Map "C" indicates, Cariboo Road forms the easterly boundary between the areas of Municipal and GVRD jurisdiction within the Regional Park.

Thus, the statement that the "Regional Park boundary does not go east of Cariboo Road" and "the subject property is outside of and east of the Regional Park boundaries", refer to this jurisdictional division and not to the overall boundaries of the Central Valley Park System which, as indicated above, have been firmly established by previous actions of the Burnaby Lake Development Committee, the Council and the GVRD.

This is for the information of the Council.

A. L. Farr
DIRECTOR OF PLANNING

RBC/dm
attachments
cc Assistant Director-Long Range
Planning and Research

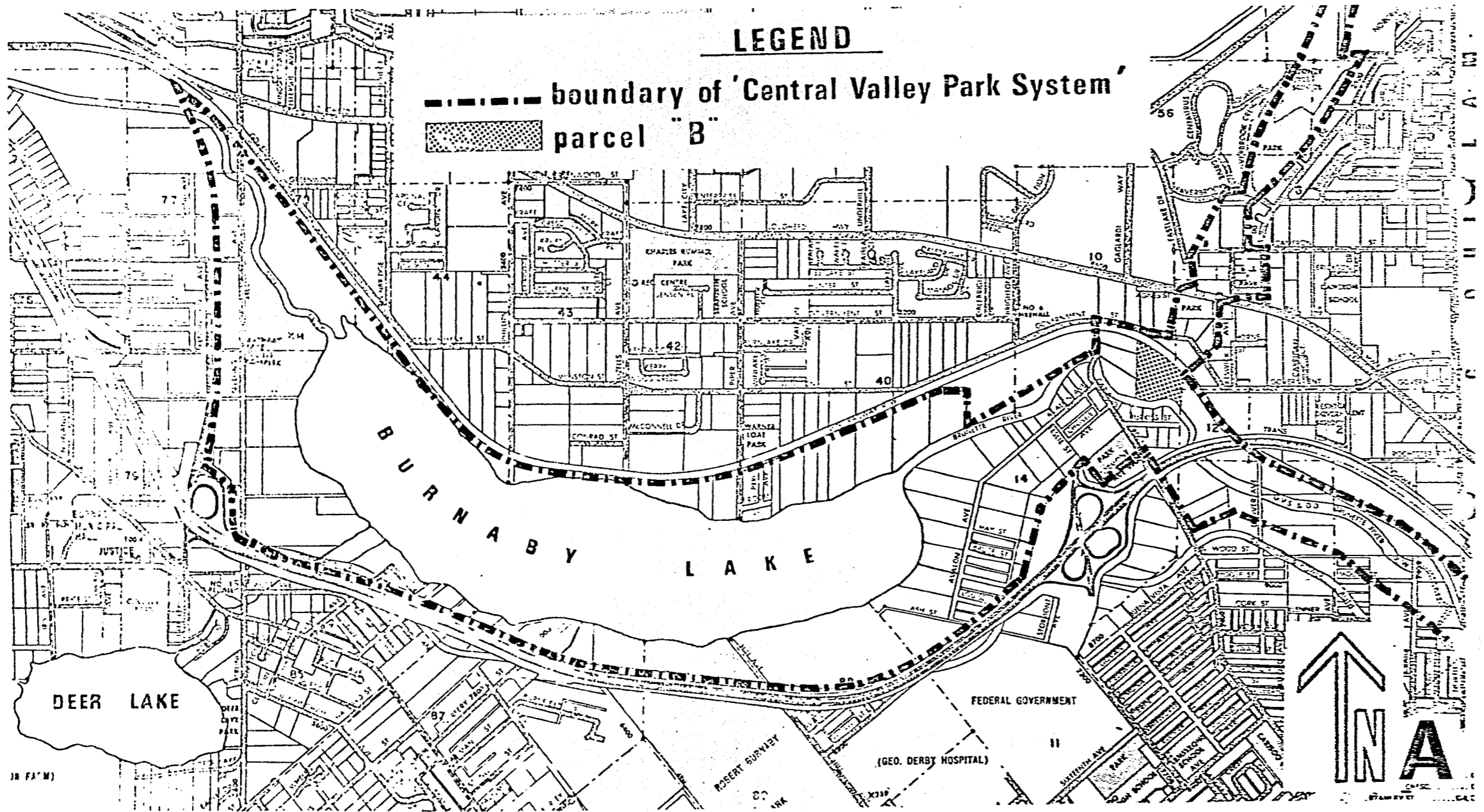

LEGEND

- boundary of 'Central Valley Park System'
- ▨ parcel "B"

ITEM	8
MANAGER'S REPORT NO.	75
COUNCIL MEETING	Nov. 22/76

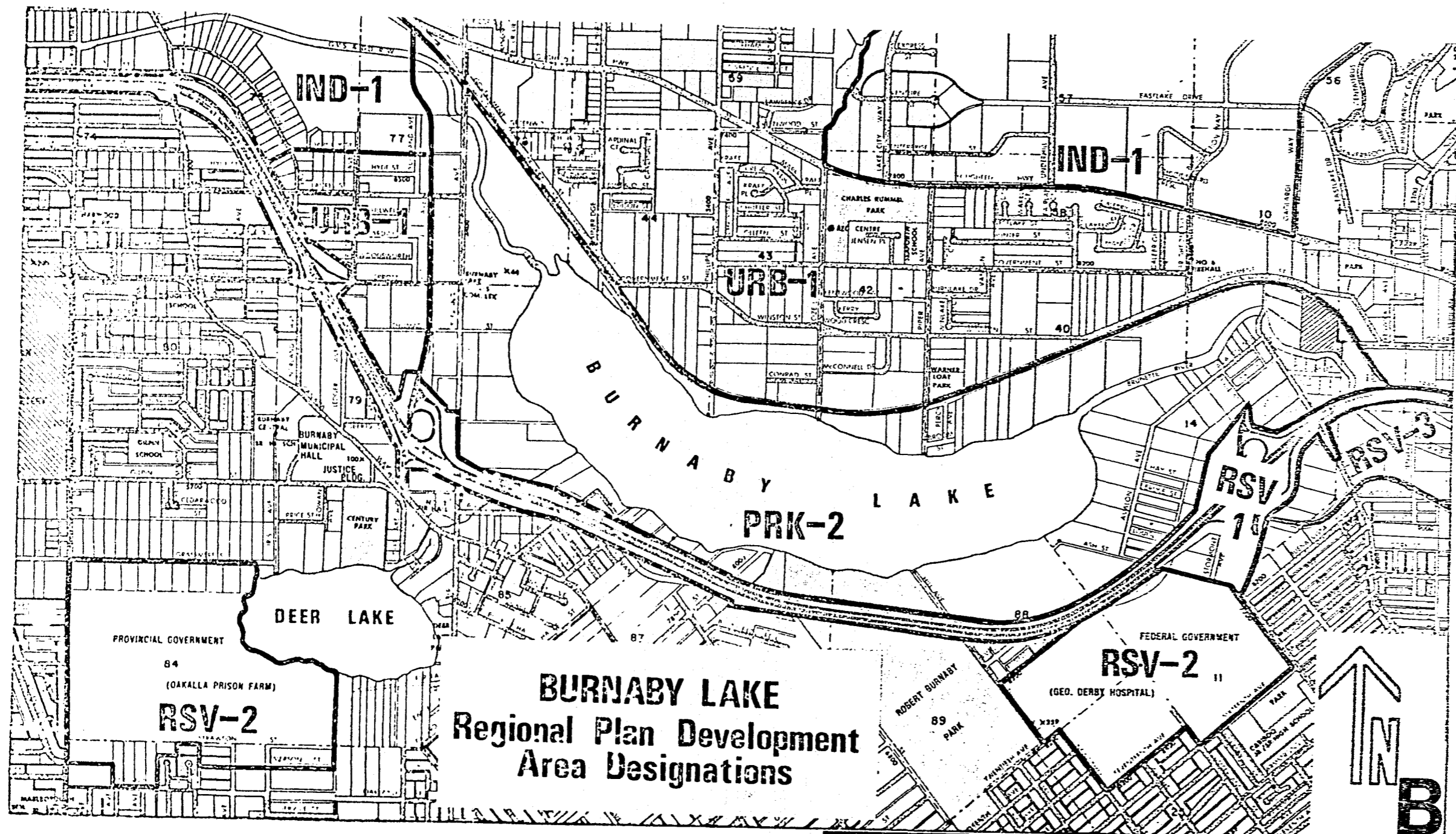

BURNABY LAKE
 Regional Plan Development
 Area Designations



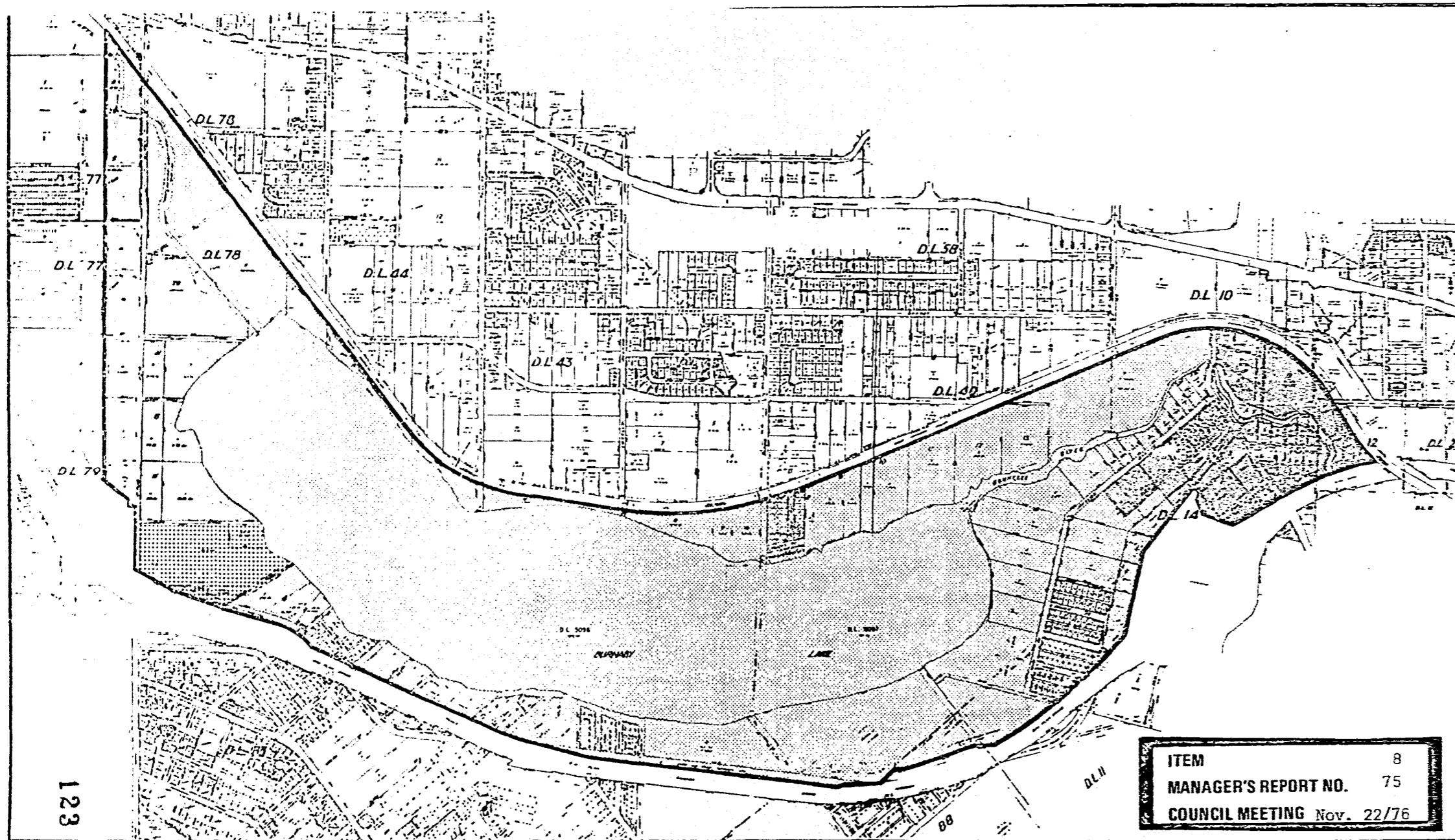

ITEM	8
MANAGER'S REPORT NO.	75
COUNCIL MEETING	Nov. 22/76

DRWG. NO. A-2169
 122



ITEM	8
MANAGER'S REPORT NO.	75
COUNCIL MEETING	Nov. 22/76



-  BURNABY LAKE REGIONAL PARK
-  REGIONAL PARKS JURISDICTION
-  MUNICIPAL JURISDICTION
-  JOINT JURISDICTION

BURNABY LAKE REGIONAL PARK
13

C