

19. Re: Eagle Creek in Subdivision Reference #130/73

Following is a report from the Director of Planning regarding the subject Creek.

On October 9, 1973 when Council debated a report on the piping of watercourses, staff was directed to present to Council for consideration prior to approval any proposed subdivision or development on property involving watercourses.

RECOMMENDATION:

THAT Council affirm the Planning Department's requirements to retain Eagle Creek in an open condition through the lands involved in Subdivision Reference #130/73.

PLANNING DEPARTMENT
23 JANUARY, 1974

SUBJECT: EAGLE CREEK
NATURAL WATERCOURSE IN SUBDIVISION #130/73

The subject property is located between Government Street and Charles Rummel Park at the end of Jensen Place as shown on the attached sketch.

The subject watercourse, Eagle Creek, traverses the southwest corner of the property, and is contained upon an easement controlled by the Greater Vancouver Sewer and Drainage District. Eagle Creek originates on Burnaby Mountain and eventually flows into Burnaby Lake through Warner Loat Park, picking up drainage from a number of parcels. That it be retained open is therefore not only recommended by the Planning Department, but mandatory in the opinion of the Sewer and Drainage District. No improvements to the channel are considered necessary since it is fully maintained by the Sewer and Drainage District.

As a condition of subdivision approval, the developer was required to dedicate property for park purposes, (see attached) alongside the creek with access to Jensen Place. This was required with a view to preservation of the creek as well as access to Charles Rummel Park by the residents of Jensen Place. The above is given for Council's information.

RECOMMENDATION

THAT Council affirm the Planning Department's requirement to retain Eagle Creek in an open condition through the lands involved in Subdivision Reference #130/73.

Respectfully submitted,

A. L. Parr,
DIRECTOR OF PLANNING

HR:ea
Attchmt.

ITEM 19
 MANAGER'S REPORT NO. 7
 COUNCIL MEETING Jan. 28/74

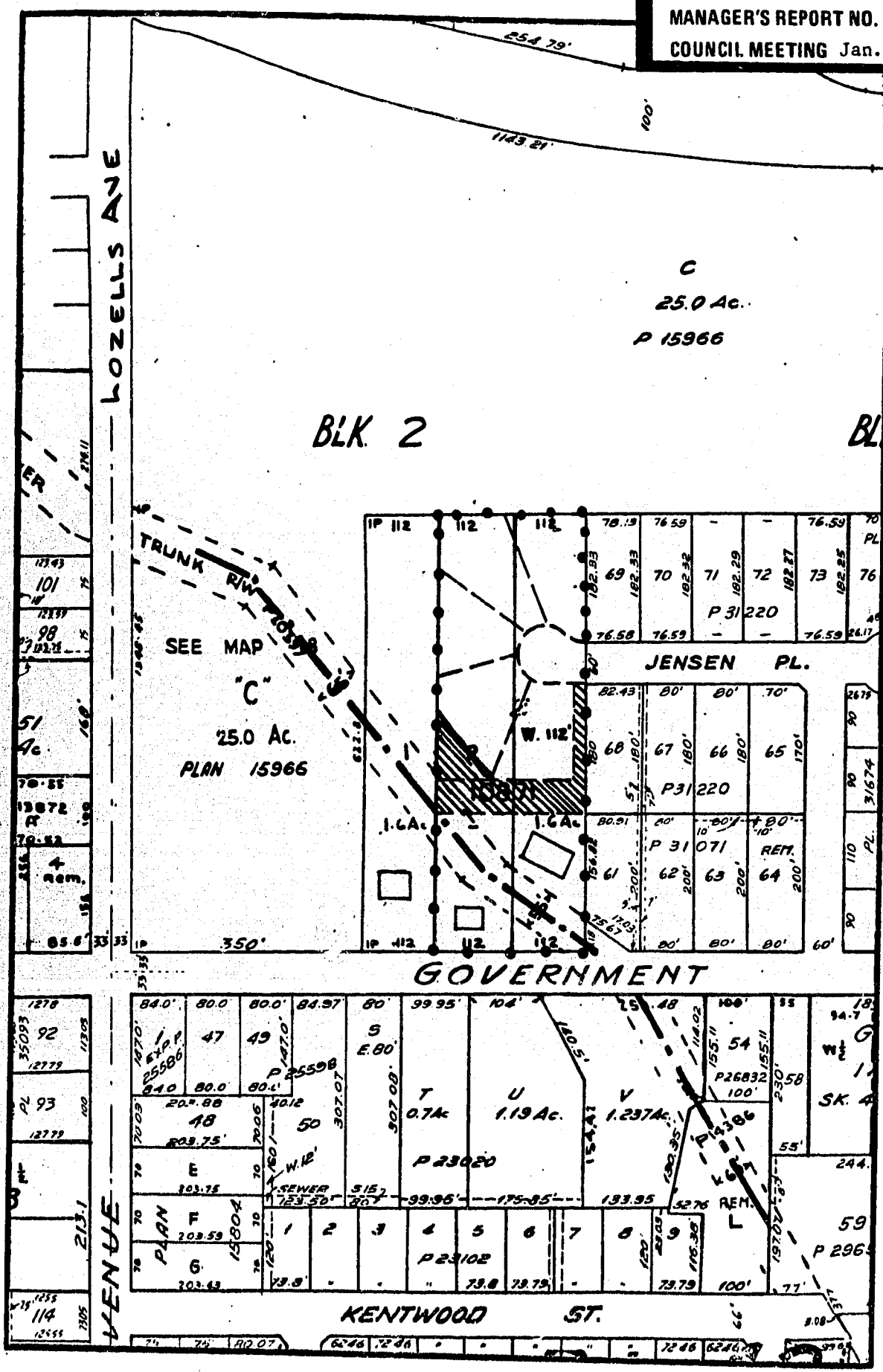

SUBJECT LOT
 EAGLE CREEK - - - - -
 PARK DEDICATION [hatched box]

↑
 N
 SCALE 1" = 200'