

Re: Letter dated March 13, 1974 from Mr. Paul B. Vandervoort and  
Others, 231 North Sea Avenue  
No Parking On East Side of 200 Block North Sea Avenue

Appearing on the Agenda for the March 25, 1974 meeting of Council is a letter from Mr. Paul B. Vandervoort and others objecting to "No Parking Any Time" signs on the east side of the 200 Block North Sea Avenue (see attached sketch).

Photographs of the subject area will be available for viewing by members of Council, should they so wish, at the meeting of March 25, 1974.

Following is the report of the Municipal Engineer with respect to the subject signs.

RECOMMENDATIONS:

THAT the subject no parking signs be removed; and

THAT Mr. P. Vandervoort and others requesting removal of the subject signs be provided with a copy of this report.

\* \* \* \* \*

TO: MUNICIPAL MANAGER

MARCH 20, 1974

FROM: MUNICIPAL ENGINEER

RE: NO PARKING ANYTIME ON EAST SIDE OF 200 BLOCK N. SEA

On February 4, 1974 the Engineering Department received a telephone complaint from a Mrs. Linn of 230 North Sea Avenue regarding vehicles parking in front of her home. She claimed that because her property was somewhat lower than the road that she and her neighbour have had to have cars that have slid onto their lots removed. Not having any record of these accidents we naturally accepted her word that she was stating a fact.

To resolve her complaint and to improve the site distance to the delineator posts on the curve approach to Highfield we posted a no parking anytime restriction from the south property line of 230 North Sea Avenue to the corner of the Highfield pavement. Also taken into account was the fact that the restriction only covered her frontage.

Since the no parking signs were erected we have received numerous and repeated phone calls and visits from those residents of Sea Avenue who are objecting to the loss of this additional parking for their vehicles. We should advise the Council at this time that the complainants of this parking restriction have parking in front of their own homes as well as their own off street parking facilities.

In checking the list of streets noted with Mr. Vandervoort's letter of March 13, 1974 to Council as having traffic dangers and parking problems, we would advise that in most cases we were able to find violations of the Provincial Motor Vehicle Act (M.V.A.). The sections of the M.V.A. being violated most consistently were:

Section 180(a) Except when necessary to avoid conflict with traffic or to comply with the law or the directions of a peace officer or traffic control device, no person shall stop, stand, or park a vehicle on a sidewalk or boulevard.

The definition of a boulevard is that area between the curb lines of a roadway or the lateral lines of a roadway or the shoulder thereof and the adjacent property line.

Section 178(2) No person shall park a vehicle so as to obstruct the free passage of traffic on the highway.

The list of streets submitted and the violations are listed below.

1. Corner of Bessborough Drive & North Holdom  
"parking around curve restricts sight distance"
2. 5500 & 5600 Block Bessborough Drive  
"5500 Block is vacant.  
5600 Block, vehicles parking on the north side must park on pavement, vehicles on south side park on a 3' shoulder and would encroach onto pavement - no vehicles observed."
3. Capital Drive - between Pandora and Ellesmere  
"20' centre-lined pavement, narrow shoulders. Parkers would violate Section 178(2) M.V.A. - no parkers observed."
4. 5100 Block Empire Drive  
"28' interim curb standard, marked with centre-line. Parkers are in violation of Section 178(2) M.V.A."
5. 5800 Block Highfield Drive  
"Asphalt curb north side, parkers behind curb in violation of Section 180(a) M.V.A."
6. Corner of Harbour View and N. Glynde  
"Vehicles parking behind asphalt curb on west side.  
Violation of Section 180(a) M.V.A."
7. 400 Block N. Springer  
"Vehicles parking behind asphalt curb on north side.  
Violation 180(a) M.V.A. Vehicles parked on pavement on south side on inside of curve restrict sight distance."
8. N. Warwick - between Dundas and Highfield Drive  
"Vehicles parking behind asphalt curb on east side in violation of Section 180(a) M.V.A."
9. Corner of South Sea and Dundas  
"Vehicles parked behind asphalt curb on east side in violation of Section 180(a) M.V.A."

We would advise the Council that the violations to the above Section of the M.V.A. and in particular Section 180(a) can be found throughout the Municipality. Because of the magnitude of the problem we have only taken action where we have had complaints to do so.

While checking the above violations it was brought to our attention that the entire east side of the Sea Avenue pavement between Highfield and Dundas Street has a rolled asphalt curb. In addition to the curb the 20 foot pavement is centre-lined. This would make any vehicle parked behind the curb in violation of Section 180(a) M.V.A. All vehicles parked on the pavement side of the curb are in violation of Section 178(2) M.V.A.

Because of the above restrictions on Sea Avenue we feel that the present no parking signs are not necessary and, in fact, could infer that parking was allowed on the boulevard area south of 230 N. Sea Avenue.

As regards the complainants' request to remove the three most southerly delineator posts, it is our opinion that these posts are required to show the change in alignment of Sea Avenue when approaching Highfield Drive. We do not recommend removal of the posts.

RECOMMENDATION:

THAT the existing no parking signs be removed from the east side of Sea Avenue.  
THAT all parties involved in the disputed parking be advised of those sections of the M.V.A. pertinent to their complaint.

HB:wlb

  
MUNICIPAL ENGINEER

33

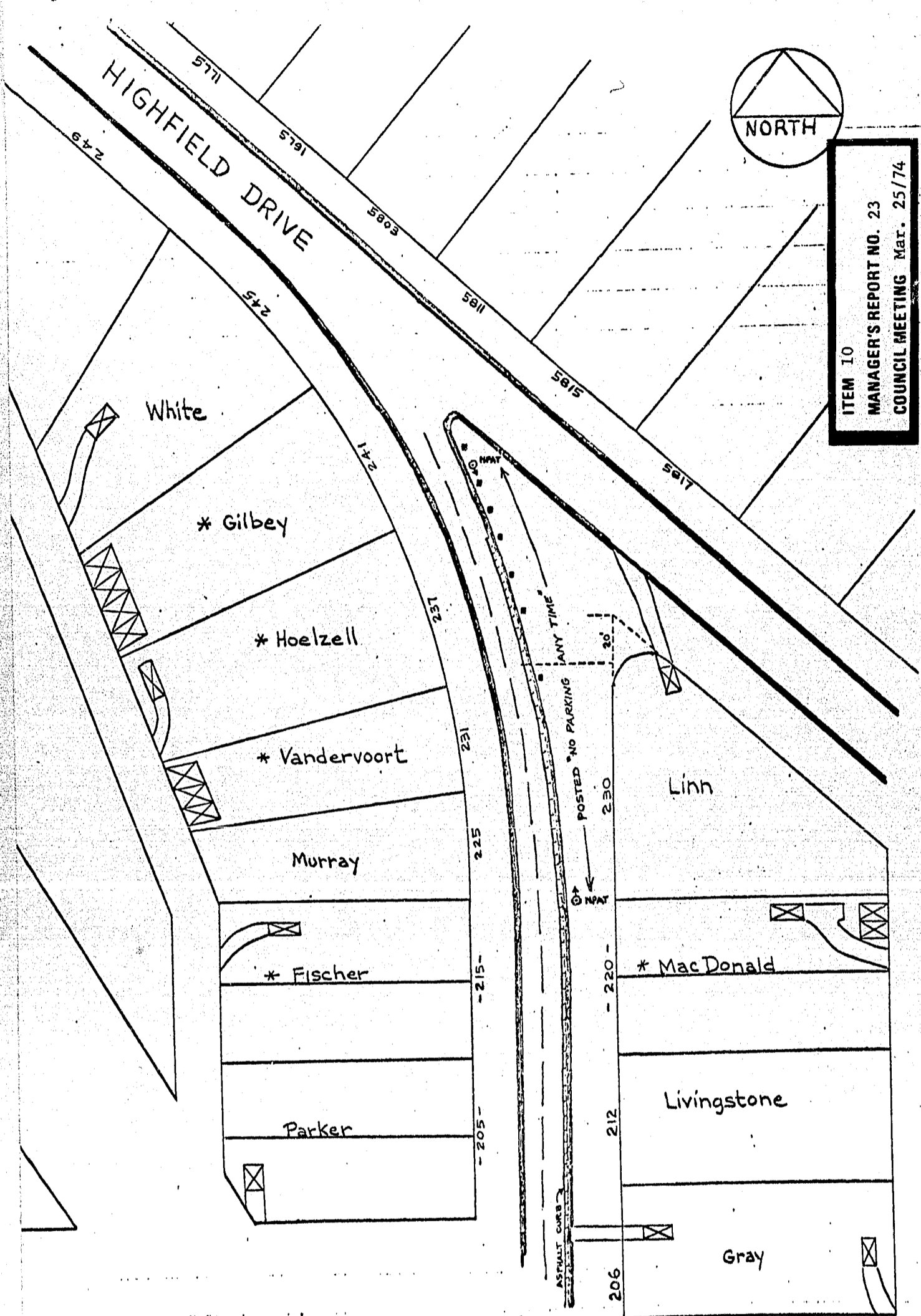

ITEM 10  
 MANAGER'S REPORT NO. 23  
 COUNCIL MEETING Mar. 25/74

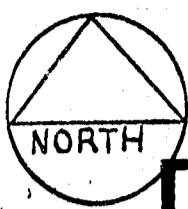

- LEGEND**
- off street parking
  - Delineator post
  - No parking sign
  - Asphalt curb
  - Resident signed petition

DWM 20.9.74

N. SEA AVE.