

ITEM 10  
MANAGER'S REPORT NO. 15  
COUNCIL MEETING Feb. 25/74

Re: Petition for Removal of Brush  
Westridge School Area

Appearing on the Agenda for the February 25, 1974 meeting of Council is a petition requesting the removal of brush in the vicinity of Westridge School. Following is a report from the Engineer on this matter.

RECOMMENDATION:

THAT the petitioners be advised that the Engineering Department will undertake to remove the light brush which is located on the unopened sections of Ellerslie Avenue and Invergarry Avenue, and Corporation owned property between Hastings Street and the Westridge School as indicated on the attached sketch.

\* \* \* \* \*

TO: MUNICIPAL MANAGER  
FROM: MUNICIPAL ENGINEER

FEBRUARY 21, 1974

RE: PETITION FROM PROPERTY OWNERS IN THE VICINITY  
OF WESTRIDGE SCHOOL - BUSHES IN THE AREA OF THE SCHOOL

In connection with a petition received from property owners complaining of the hazard to the safety of small children arising from the existence of brush in the vicinity of Westridge School, this will confirm that we have inspected the area to the north and the east of Westridge School and find that the brush and trees in question are situated on unopened portions of Ellerslie Avenue and Invergarry Avenue and Corporation property between Hastings Street and the Westridge School as shown on the attached sketch.

We would not recommend the removal of the light growth of trees in the area, however, we can undertake to remove the light cover of brush in the area around the trees and would suggest that the removal of this bush would leave only a light growth of trees which would not create any hazard to the safety of school children.

RECOMMENDATION:

THAT the petitioners be advised that the Engineering Department will undertake to remove the light brush which is located on the unopened sections of Ellerslie Avenue and Invergarry Avenue and Corporation owned property between Hastings Street and the Westridge School as indicated on the attached sketch.

VK:wlb  
cc: ( ) Land Agent  
Att.

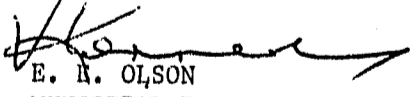
  
E. N. OLSON  
MUNICIPAL ENGINEER

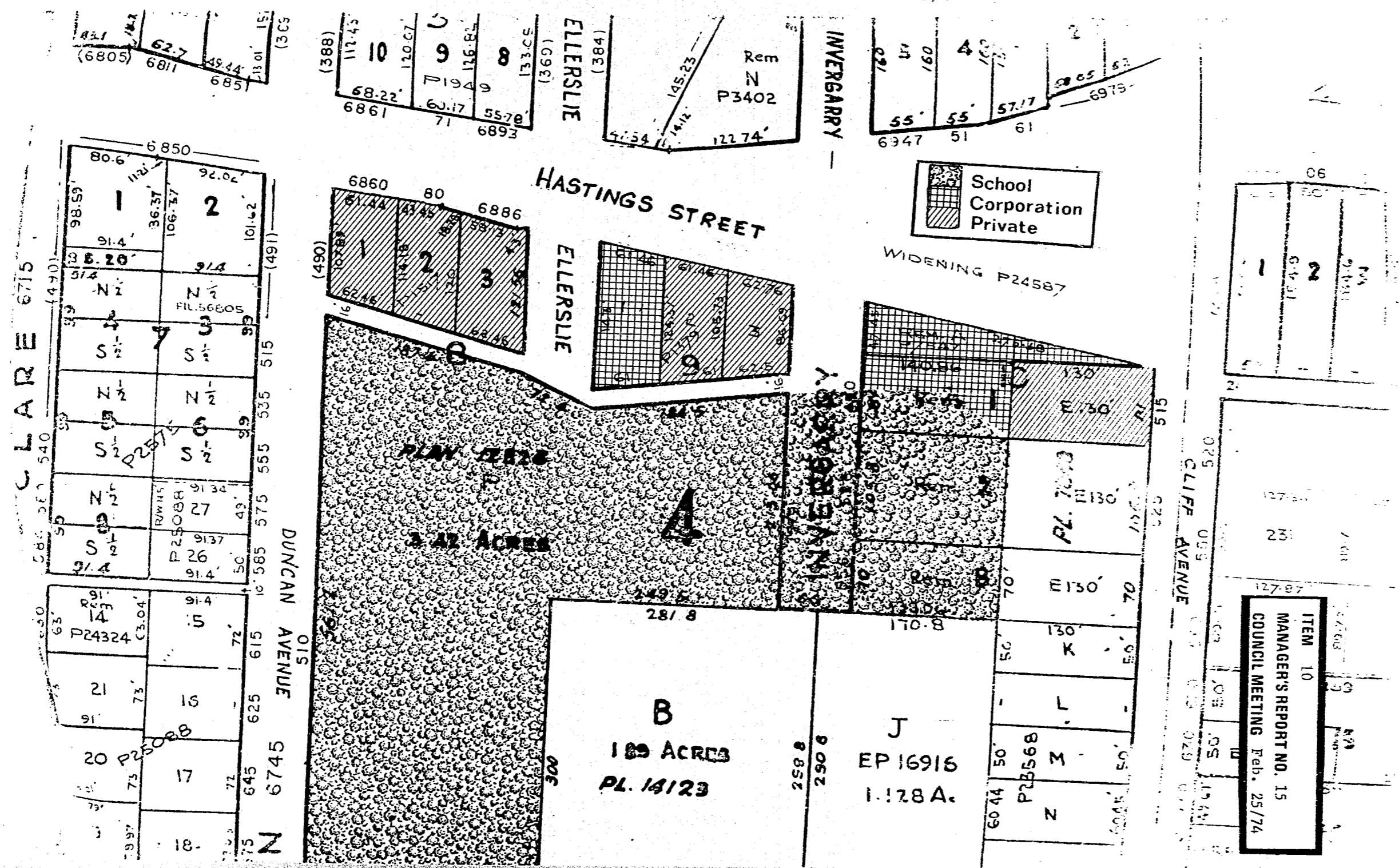

ITEM 10  
 MANAGER'S REPORT NO. 15  
 COUNCIL MEETING Feb. 25/74