

ITEM 17  
MANAGER'S REPORT NO. 15  
COUNCIL MEETING Feb. 26/73

17. Re: Preliminary Plan Approval #2073  
Chevron Canada Limited

Following is a report from the Director of Planning regarding a minor extension of asphalt tanks on Chevron Canada Limited property adjacent to Willingdon Avenue (see attachments).

RECOMMENDATION:

THAT authorization be given to issue a Preliminary Plan Approval for the subject extension of three existing asphalt tanks.

\* \* \* \* \*

PLANNING DEPARTMENT

FEBRUARY 23, 1973

OUR FILE: 13.250/188/189

RE: PRELIMINARY PLAN APPROVAL #2073  
CHEVRON CANADA LTD.

Plans have been received for a very minor extension of 3 existing asphalt tanks located in the north portion of the Refinery site some 150 feet west of Willingdon. Photographs and plans of the installation will be available for viewing at the Council meeting.

These tanks are located well within the developed portion of the Refinery and are presently 17'8" in height. The proposal is to extend the tanks by approximately 15' in height and to insulate and clad them in horizontal corrugated aluminium as on the existing tanks. In addition minor changes to the piping system are involved to meet the new elevations and stairways are to be replaced.

This work is all within the developed refinery area considerably removed from the nearest residence. As shown on the cross sections, these tanks will not be visible from up slope.

This proposed construction is not related to the larger Refinery Expansion which the various Departments are working on. The Planning Department is prepared to issue Preliminary Plan Approval on the proposal but it is felt that Council should be made aware of the proposal before the approval is granted.

Respectfully submitted,

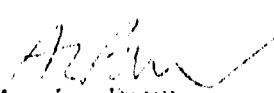
  
A. L. Parr,  
DIRECTOR OF PLANNING

LNA/mp

ITEM 17  
 MANAGER'S REPORT NO. 15  
 COUNCIL MEETING Feb. 26/72

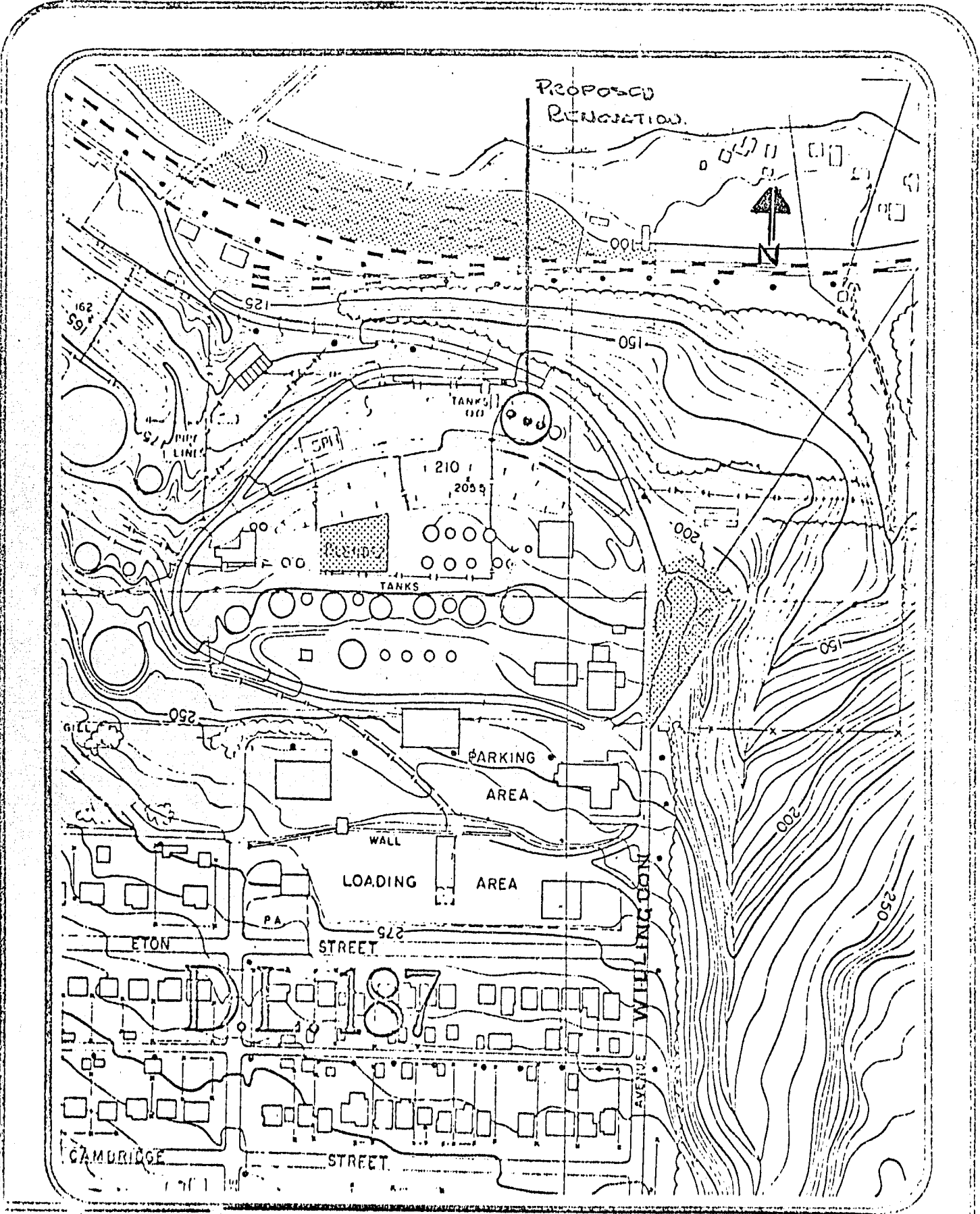

SCALE	SCALE
DRAWN	1" = 200'
DATE	

BURNABY PLANNING DEPARTMENT

ITEM 17

MANAGER'S REPORT NO. 15

COUNCIL MEETING Feb. 26/71

- ASPHALT DRIVE -

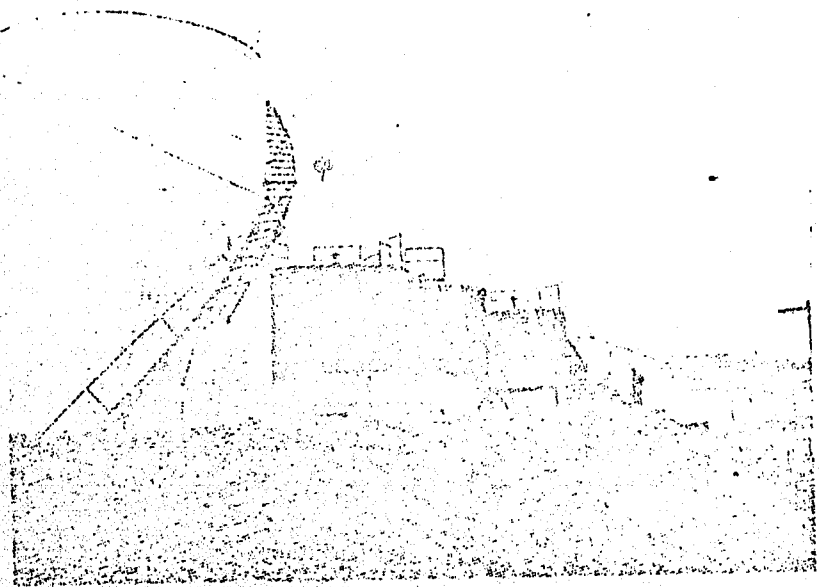

VIEW LOOKING SOUTH-  
WEST FROM WILLINGDON  
EXTENSION ROAD

THREE BLACK TANKS ARE  
TO BE EXTENDED 15' TO  
MATCH HEIGHT OF TANK  
IN FOREGROUND (77)



VIEW LOOKING NORTH



VIEW LOOKING EAST.