

21. Re: Letter - Mrs. K. Keel, 7427 Holly Street  
Municipal Purchase of Houses on Holly Street  
Richmond Park Acquisition

Appearing on the Agenda for the October 30, 1972, Council meeting is a letter from Mrs. K. Keel concerning the proposed Municipal purchase of her house on Holly Street.

Council and the Parks and Recreation Commission have authorized the acquisition of properties on Holly Street for the purpose of expanding Richmond Park. The area of concern to Mrs. Keel will be used for the construction of a covered lacrosse box and construction of either a new building or an adjunct to an existing building. An economical analysis of the factors involved will more specifically determine the nature and scope of the latter project.

The necessary acquisitions, which are included in the Parks Land Acquisition Program dated June, 1972, will be acquired in two stages. The first stage will involve acquisitions on the north side of Holly Street. The second stage, which will be twice as large as the first, will extend the park from Holly Street to Vista Crescent (see attached sketch). It is anticipated that the negotiations will be completed by 1975 so that development can be started in that year.

The Land Agent advises that two Stage 1 acquisitions have been negotiated and will be referred to the Commission and Council for approval this Wednesday and next Monday respectively.

RECOMMENDATIONS:

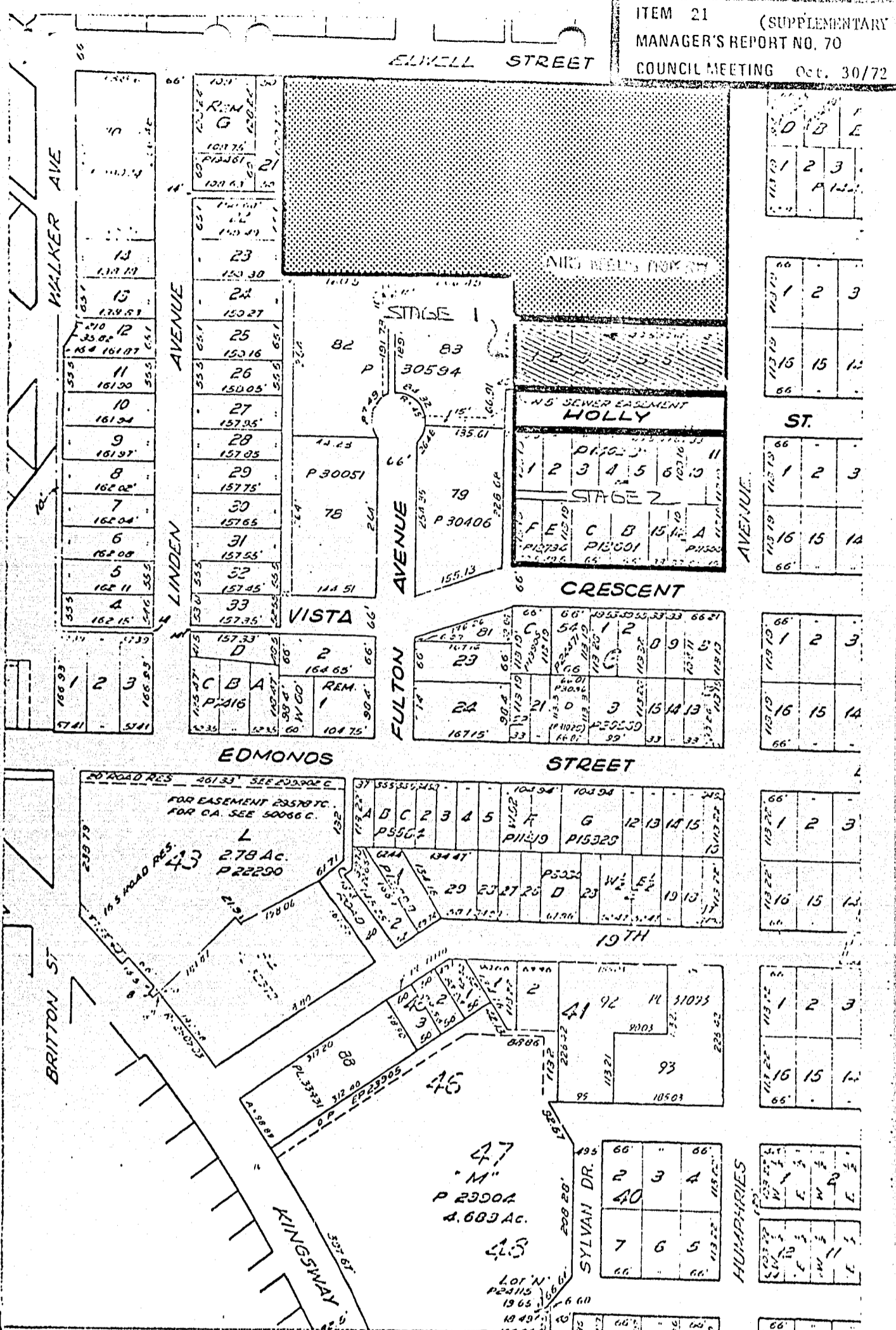

THAT negotiations for acquisition of lands that are necessary for the expansion of Richmond Park be continued, keeping in mind the anticipated construction target of 1975; and

THAT a copy of this report be sent to the Parks and Recreation Commission for information purposes only.



0	1	2
1	2	3
4	5	6
7	8	9
10	11	12
13	14	15
16	15	14
17	18	19
20	21	22
23	24	25
26	27	28
29	30	31
32	33	34
35	36	37
38	39	40
41	42	43
44	45	46
47	48	49
50	51	52
53	54	55
56	57	58
59	60	61
62	63	64
65	66	67
68	69	70
71	72	73
74	75	76
77	78	79
80	81	82
83	84	85
86	87	88
89	90	91
92	93	94
95	96	97
98	99	100

**RICHMOND PARK**

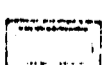
-  Proposed Acquisition
-  Existing Park and/or Municipal Property
-  Proposed Park Area

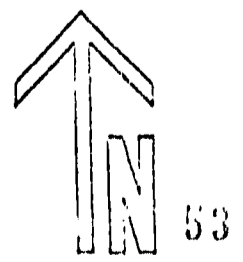

March, 1972.

Scale: 1" = 200'