

CITY OF BURNABY

BYLAW NO. 9997

A BYLAW to amend Bylaw No. 4742, being
Burnaby Zoning Bylaw 1965

WHEREAS application for rezoning has been made to the Council;

AND WHEREAS the Council has held a public hearing thereon after duly giving notice of the hearing as prescribed by sections 956 and 957 of the Municipal Act R.S.B.C. 1979;

NOW THEREFORE the Council of the City of Burnaby ENACTS as follows:

1. This Bylaw may be cited as BURNABY ZONING BYLAW 1965, AMENDMENT BYLAW NO. 63, 1993.
2. The map (hereinafter called "Map 'A'") attached to and forming an integral part of Bylaw No. 4742, being Burnaby Zoning Bylaw 1965, and designated as the Official Zoning Map of the City of Burnaby, is hereby amended according to the Map (hereinafter called "Maps 'B'"), marginally numbered R.Z. 2011 annexed to this Bylaw, and in accordance with the explanatory legend, notations, references and boundaries designated, described, delimited and specified in particularity shown upon said Maps 'B', and the various boundaries and districts shown upon said Maps 'B', respectively are an amendment of and in substitution for the respective districts, designated and marked on said Map 'A' insofar as the same are changed, modified or varied thereby, and the said Map 'A' shall be deemed to be and is hereby declared to be amended accordingly and the said Map 'B' is hereby declared to be and shall form an

integral part of said Map 'A' as if originally incorporated therein and shall be interpreted accordingly.

Read a first time this 10th day of JANUARY 1994

Read a second time this 7th day of FEBRUARY 1994

Read a third time this 24th day of JULY 1995

Received the approval of the Minister of Transportation and Highways

this 9th day of AUGUST 1995

RECONSIDERED AND ADOPTED THIS 6th day of JANUARY 1997



MAYOR



CLERK

**BYLAW NUMBER 9997 BEING A BYLAW TO AMEND
BYLAW NUMBER 4742 BEING THE BURNABY ZONING BYLAW 1965**

PROPERTY REZONED TO:

R9 RESIDENTIAL DISTRICT

MAP "B"

LEGAL: LOT C, D.L. 85, GROUP 1, N.W.D. PLAN 4949; LOT B, D.L. 85, GROUP 1, N.W.D. PLAN 4949; LOT A EXC. E. 87 FEET, D.L. 85, GROUP 1, N.W.D. PLAN 4949; E. 87 FEET OF LOT A, D.L. 79/85, GROUP 1, N.W.D. PLAN 4949

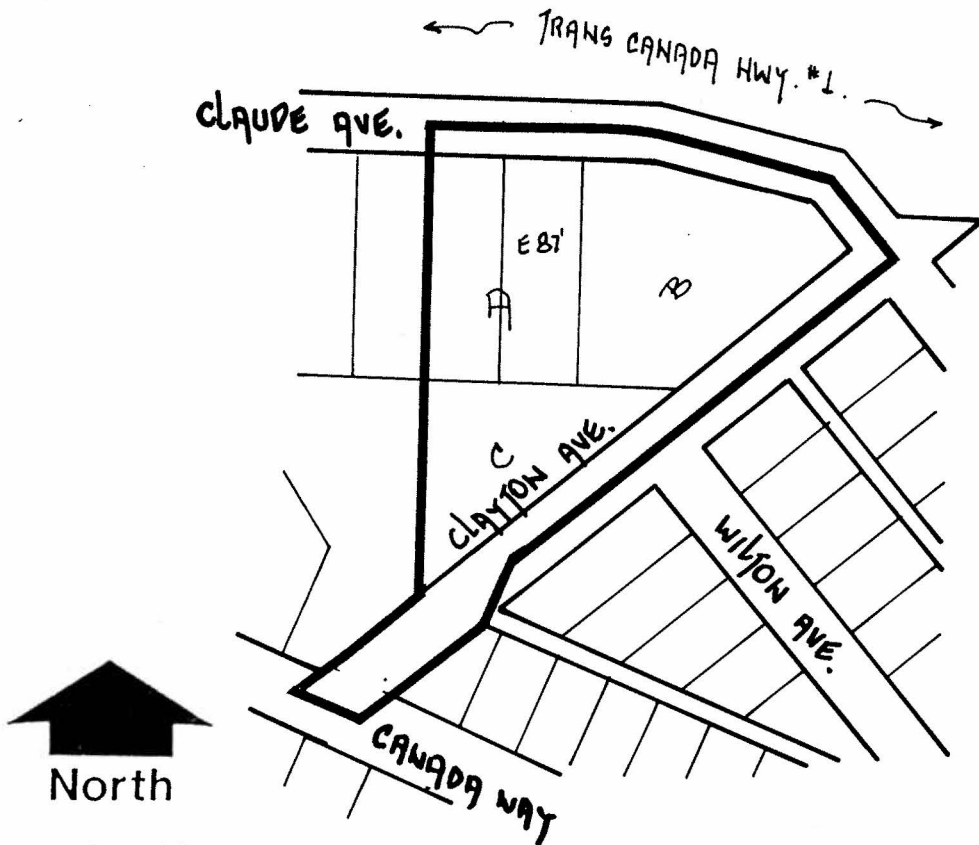

THE AREA(S) SHOWN ABOVE OUTLINED IN BLACK (——) IS (ARE) REZONED:

FROM: R4 RESIDENTIAL DISTRICT

TO: R9 RESIDENTIAL DISTRICT

PLANNING DEPARTMENT

SCALE	N.T.S.
DRAWN	J.P.C.
DATE	JANUARY 1994



OFFICIAL ZONING MAP

No. RZ 2011