

CITY OF BURNABY

BYLAW NO. 9878

A BYLAW to amend Bylaw No. 4742, being Burnaby Zoning Bylaw 1965, as amended by Bylaw No. 5744, being Burnaby Zoning Bylaw 1965, Amendment Bylaw No. 34, 1990

WHEREAS application for rezoning has been made to the Council;

AND WHEREAS the Council has held a public hearing thereon after duly giving notice of the hearing as prescribed by Sections 956 and 957 of the Municipal Act R.S.B.C. 1979;

NOW THEREFORE the Council of the City of Burnaby ENACTS as follows:

1. This Bylaw may be cited as BURNABY ZONING BYLAW 1965, AMENDMENT BYLAW NO. 18, 1993.
2. The Map (hereinafter called "Map 'A'"), attached to and forming an integral part of Bylaw No. 4742, being "Burnaby Zoning Bylaw 1965", and designated as the Official Zoning Map of the City of Burnaby, is hereby amended according to the Map (hereinafter called "Map 'B'"), marginally numbered R.Z. 1969, annexed to this Bylaw, and in accordance with the explanatory legend, notations, references and boundaries designated, described, delimited and specified in particularity shown upon said Map 'B'; and the various boundaries and districts shown upon said Map 'B' respectively are an amendment of and in substitution for the respective districts, designated and marked on said Map 'A' insofar as the same are changed, modified or varied thereby, and the said Map 'A' shall be deemed to be and is hereby declared to be amended accordingly and the said Map 'B' is hereby declared to be and shall form an integral part of said Map 'A', as if originally incorporated therein and shall be interpreted accordingly.

3. Bylaw No. 5744 is amended by adding thereto, immediately after section 3, the following:

"4. The Comprehensive Development Plan entitled "MIDDLEGATE CELL SITE" prepared by ROGERS CANTEL INC. and on file in the office of the Director Planning and Building, is deemed to be attached to and form part of this Bylaw and any development on the lands rezoned by this Bylaw shall be in conformity with the said Comprehensive Development Plan."

Read a first time this 5th day of April 1993

Read a second time this 3rd day of May 1993

Read a third time this 10th day of May 1993

Reconconsidered and adopted this 17th day of May 1993

  
MAYOR

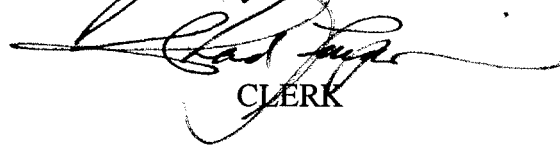
  
CLERK

# BYLAW NUMBER 9878 BEING A BYLAW TO AMEND BYLAW NUMBER 4742 BEING THE BURNABY ZONING BYLAW 1965

**PROPERTY REZONED TO:**

MAP "B"

"AMENDED" CD COMPREHENSIVE DEVELOPMENT (BASED ON RM4 MULTIPLE FAMILY RESIDENTIAL DISTRICT AND P2 ADMINISTRATION AND ASSEMBLY DISTRICT [FOR THE ANTENNAE USE] GUIDELINES AND IN ACCORDANCE WITH THE DEVELOPMENT PLAN ENTITLED "MIDDLEGATE CELL SITE" PREPARED BY ROGERS CANTEL INC.)

LEGAL: PORTION OF LOT 102, D.L. 30, GROUP 1, N.W.D. PLAN 50955

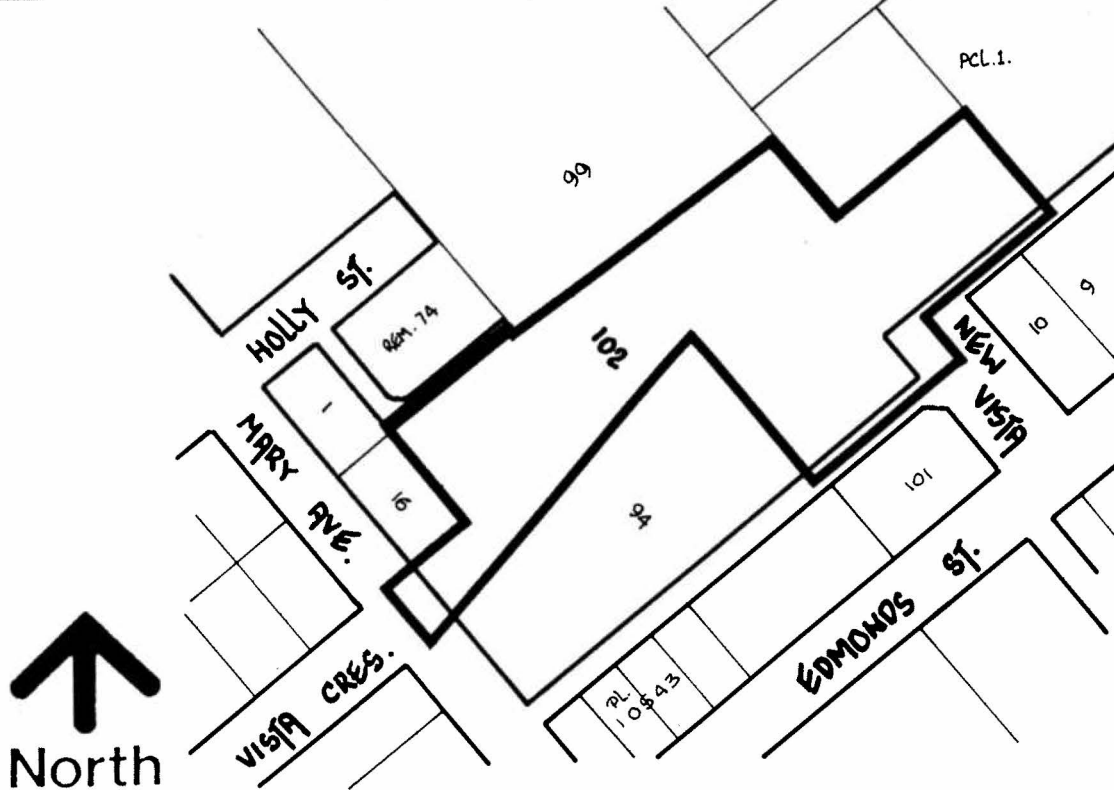

**THE AREA(S) SHOWN  
ABOVE OUTLINED  
IN BLACK (———)  
IS (ARE) REZONED:**

**FROM:** CD COMPREHENSIVE DEVELOPMENT DISTRICT (BASED ON RM4 MULTIPLE FAMILY RESIDENTIAL DISTRICT GUIDELINES)

**TO:** CD COMPREHENSIVE DEVELOPMENT DISTRICT (BASED ON RM4 MULTIPLE FAMILY RESIDENTIAL DISTRICT AND P2 ADMINISTRATION AND ASSEMBLY DISTRICT [FOR THE ANTENNAE USE] GUIDELINES AND IN ACCORDANCE WITH THE DEVELOPMENT PLAN ENTITLED "MIDDLEGATE CELL SITE" PREPARED BY ROGERS CANTEL INC.)

<b>PLANNING DEPARTMENT</b>	
SCALE	N.T.S.
DRAWN	J.P.C.
DATE	APRIL 1993



**OFFICIAL ZONING MAP**

No. RZ 1969