

CITY OF BURNABY

BYLAW NO. 9876

A BYLAW to amend Bylaw No. 4742, being
Burnaby Zoning Bylaw 1965

WHEREAS application for rezoning has been made to the Council;



AND WHEREAS the Council has held a public hearing thereon after duly giving notice of the time and place of such hearing as prescribed by Sections 956 and 957 of the Municipal Act, R.S.B.C. 1979;

NOW THEREFORE the Council of the City of Burnaby ENACTS as follows:

1. This Bylaw may be cited as BURNABY ZONING BYLAW 1965, AMENDMENT BYLAW NO. 16, 1993.
2. The Map (hereinafter called "Map 'A'"), attached to and forming an integral part of Bylaw No. 4742, being "Burnaby Zoning Bylaw 1965", and designated as the Official Zoning Map of the City of Burnaby, is hereby amended according to the Map (hereinafter called "Map 'B'"), marginally numbered R.Z. 1967, annexed to this Bylaw, and in accordance with the explanatory legend, notations, references and boundaries designated, described, delimited and specified in particularity shown upon said Map 'B'; and the various boundaries and districts shown upon said Map 'B' respectively are an amendment of and in substitution for the respective districts, designated and marked on said Map 'A' insofar as the same are changed, modified or varied thereby, and the said Map 'A' shall be deemed to be and is hereby declared to be amended accordingly and the said Map 'B' is hereby declared to be and shall form an integral part of said Map 'A', as if originally incorporated therein and shall be interpreted accordingly.
3. The Comprehensive Development Plan entitled "SARDIS COURT" prepared by GRAHAM F. CROCKART ARCHITECT and on file in the office of the Director Planning and Building, is deemed to be attached to and form part of this Bylaw and any development on

the lands rezoned by this Bylaw shall be in conformity with the said Comprehensive Development Plan.

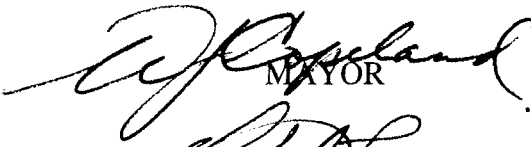
Read a first time this 5th day of APRIL 1993
Read a second time this 3rd day of MAY 1993
Read a third time this 26th day of JULY 1993
Reconsidered and adopted this 27th day of SEPT. 1993

MAYOR

CLERK

**BYLAW NUMBER 9876 BEING A BYLAW TO AMEND
BYLAW NUMBER 4742 BEING THE BURNABY ZONING BYLAW 1965**

PROPERTY REZONED TO:

MAP "B"

CD COMPREHENSIVE DEVELOPMENT DISTRICT (BASED ON RM3 MULTIPLE FAMILY RESIDENTIAL DISTRICT USE AND DENSITY, AND A MAXIMUM UNIT DENSITY OF 124 UNITS PER HECTARE, AND METROTOWN AREA 11 DEVELOPMENT PLAN GUIDELINES, AND IN ACCORDANCE WITH THE DEVELOPMENT PLAN ENTITLED "SARDIS COURT" PREPARED BY GRAHAM F. CROCKART ARCHITECT)

LEGAL: LOTS 13, 14 AND 15, BLK. 36, D.L. 34, GROUP 1, N.W.D. PLAN 1355

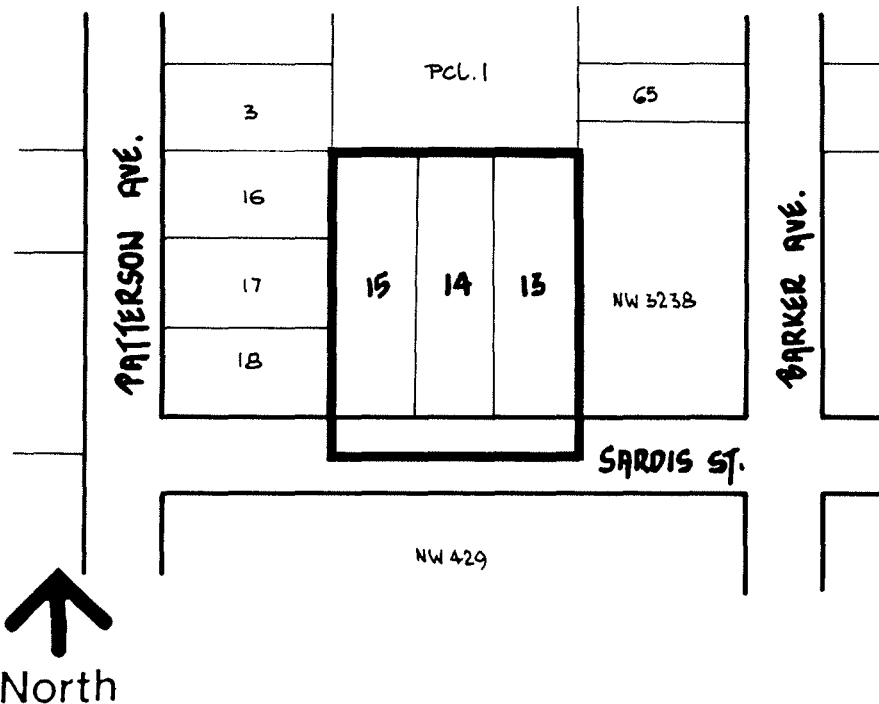

**THE AREA(S) SHOWN
ABOVE OUTLINED
IN BLACK (———)
IS (ARE) REZONED:**

FROM: R5 RESIDENTIAL DISTRICT

TO: CD COMPREHENSIVE DEVELOPMENT DISTRICT (BASED ON RM3 MULTIPLE FAMILY RESIDENTIAL DISTRICT USE AND DENSITY, AND A MAXIMUM UNIT DENSITY OF 124 UNITS PER HECTARE, AND METROTOWN AREA 11 DEVELOPMENT PLAN GUIDELINES, AND IN ACCORDANCE WITH THE DEVELOPMENT PLAN ENTITLED "SARDIS COURT" PREPARED BY GRAHAM F. CROCKART ARCHITECT)

**PLANNING
DEPARTMENT**

SCALE 1:2000

DRAWN J.P.C.

DATE APRIL 1993



City of
Burnaby

OFFICIAL ZONING MAP

No. RZ 1967