

CITY OF BURNABY

BYLAW NO. 9817

A BYLAW to amend Bylaw No. 4742, being  
Burnaby Zoning Bylaw 1965

WHEREAS application for rezoning has been made to the Council;

AND WHEREAS the Council has held a public hearing thereon after duly giving notice of the hearing as prescribed by sections 956 and 957 of the Municipal Act R.S.B.C. 1979;

NOW THEREFORE the Council of the City of Burnaby ENACTS as follows:

1. This Bylaw may be cited as BURNABY ZONING BYLAW 1965, AMENDMENT BYLAW NO. 53, 1992.
2. The map (hereinafter called "Map 'A'") attached to and forming an integral part of Bylaw No. 4742, being Burnaby Zoning Bylaw 1965, and designated as the Official Zoning Map of the City of Burnaby, is hereby amended according to the Map (hereinafter called "Map 'B'"), marginally numbered R.Z. 1952 annexed to this Bylaw, and in accordance with the explanatory legend, notations, references and boundaries designated, described, delimited and specified in particularity shown upon said Map 'B', and the various boundaries and districts shown upon said Map 'B', respectively are an amendment of and in substitution for the respective districts, designated and marked on said Map 'A' insofar as the same are changed, modified or varied thereby, and the said Map 'A' shall be deemed to be and is hereby declared to be amended accordingly and the said Map 'B' is hereby declared to be and shall form an integral part of said Map 'A' as if originally incorporated therein and shall be interpreted accordingly.

Read a first time this	30th day of NOVEMBER	1992
Read a second time this	4th day of JANUARY	1993
Read a third time this	19th day of APRIL	1993
Reconsidered and adopted this	21st day of JUNE	1993

  
MAYOR

  
CLERK

BYLAW NUMBER 9817 BEING A BYLAW TO AMEND  
 BYLAW NUMBER 4742 BEING THE BURNABY ZONING BYLAW 1965

PROPERTY REZONED TO: RM2 MULTIPLE FAMILY RESIDENTIAL DISTRICT

LEGAL: LOT "A", DISTRICT LOT 95, GROUP 1, N.W.D., PLAN 5404;  
 LOT 4, BLOCK "B", DISTRICT LOT 95, GROUP 1, N.W.D., PLAN 1264

MAP 'B'

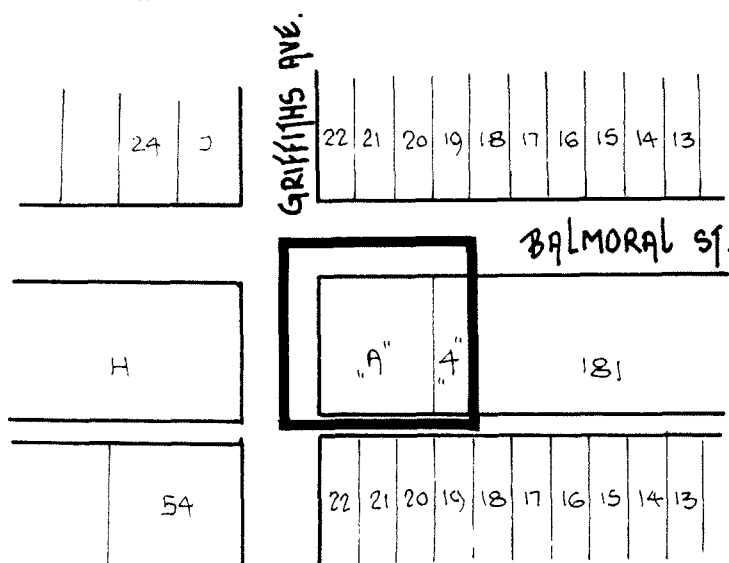

THE AREA(S) SHOWN ABOVE  
 OUTLINED IN BLACK (—)  
 IS (ARE) REZONED:

FROM: R5 RESIDENTIAL DISTRICT  
 TO: RM2 MULTIPLE FAMILY RESIDENTIAL DISTRICT

PLANNING DEPARTMENT	THE CORPORATION OF THE DISTRICT OF BURNABY	
SCALE	1:2000	OFFICIAL ZONING MAP
DRAWN	J.P.C.	
DATE	NOVEMBER 1992	
		No. RZ 1952