

CITY OF BURNABY

BYLAW NO. 9816

A BYLAW to amend Bylaw No. 4742, being  
Burnaby Zoning Bylaw 1965



WHEREAS application for rezoning has been made to the Council;

AND WHEREAS the Council has held a public hearing thereon after duly giving notice of the hearing as prescribed by sections 956 and 957 of the Municipal Act R.S.B.C. 1979;

NOW THEREFORE the Council of the City of Burnaby ENACTS as follows:

1. This Bylaw may be cited as BURNABY ZONING BYLAW 1965, AMENDMENT BYLAW NO. 52, 1992.
2. The map (hereinafter called "Map 'A'") attached to and forming an integral part of Bylaw No. 4742, being Burnaby Zoning Bylaw 1965, and designated as the Official Zoning Map of the City of Burnaby, is hereby amended according to the Map (hereinafter called "Map 'B'"), marginally numbered R.Z. 1951 annexed to this Bylaw, and in accordance with the explanatory legend, notations, references and boundaries designated, described, delimited and specified in particularity shown upon said Map 'B', and the various boundaries and districts shown upon said Map 'B', respectively are an amendment of and in substitution for the respective districts, designated and marked on said Map 'A' insofar as the same are changed, modified or varied thereby, and the said Map 'A' shall be deemed to be and is hereby declared to be amended accordingly and the said Map 'B' is hereby declared to be and shall form an integral part of said Map 'A' as if originally incorporated therein and shall be interpreted accordingly.

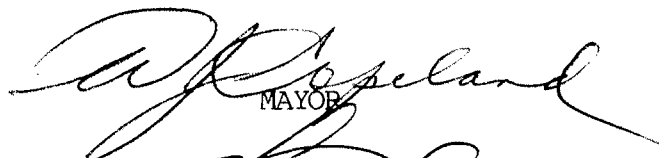
Read a first time this 30th day of NOVEMBER 1992  
Read a second time this 15th day of DECEMBER 1992  
Read a third time this 4th day of JANUARY 1993  
Reconsidered and adopted this 10th day of MAY 1993

  
MAYOR  
  
CLERK

BYLAW NUMBER 9816 BEING A BYLAW TO AMEND  
BYLAW NUMBER 4742 BEING THE BURNABY ZONING BYLAW 1965

PROPERTY REZONED TO: R1A RESIDENTIAL DISTRICT

LEGAL: LOTS 175 AND 176, DISTRICT LOT 86, GROUP 1, PLAN 26395

MAP 'B'

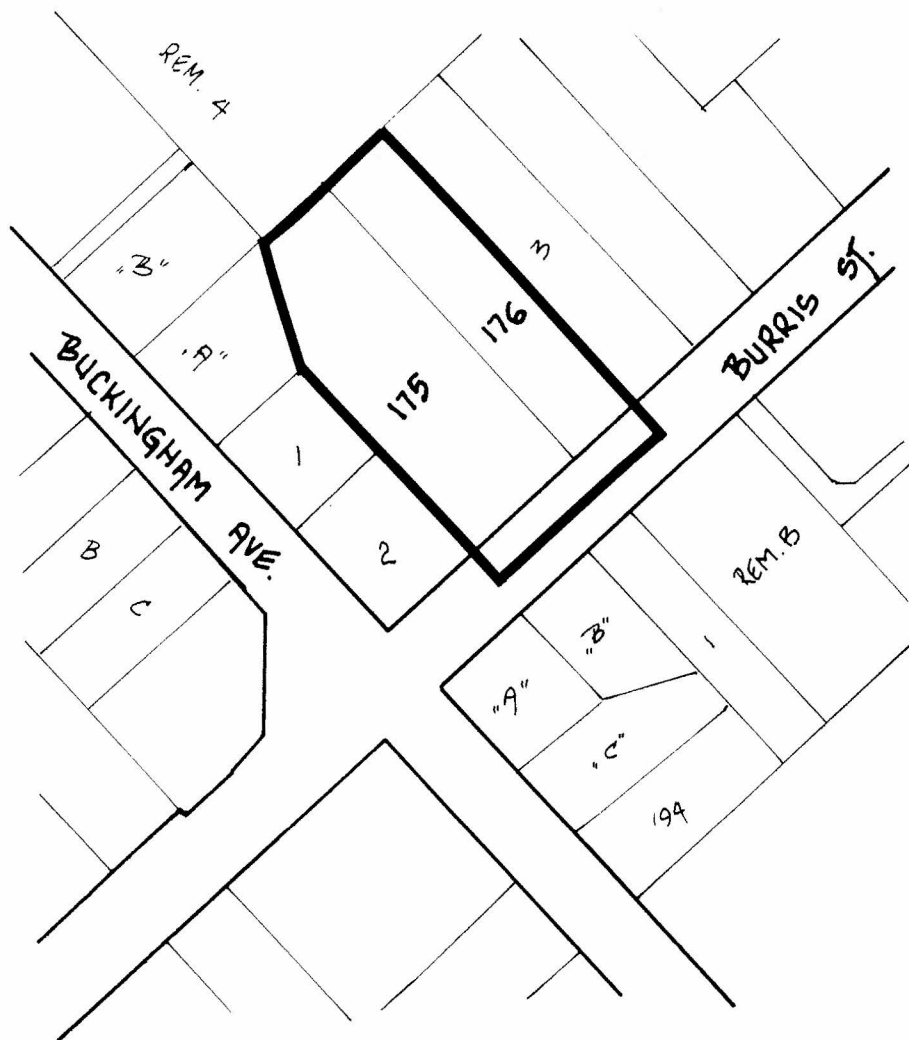

THE AREA(S) SHOWN ABOVE  
OUTLINED IN BLACK (—)  
IS (ARE) REZONED:

FROM: R1 RESIDENTIAL DISTRICT  
TO: R1A RESIDENTIAL DISTRICT

PLANNING  
DEPARTMENT

THE CORPORATION OF THE DISTRICT OF BURNABY

SCALE 1:2000

DRAWN J.P.C.

DATE NOVEMBER 1992

OFFICIAL ZONING MAP

No. RZ 1951