

THE CORPORATION OF THE DISTRICT OF BURNABY

BYLAW NO. 9775

A BYLAW to amend Bylaw No. 9310, being Burnaby Zoning Bylaw 1965, Amendment Bylaw No. 80, 1989

WHEREAS application for rezoning has been made to the Council.

AND WHEREAS the Council has held a public hearing thereon after duly giving notice of the hearing as prescribed by Sections 956 and 957 of the Municipal Act R.S.B.C. 1979.

NOW THEREFORE the Council of The Corporation of the District of Burnaby ENACTS as follows:

1. This Bylaw may be cited as BURNABY ZONING BYLAW 1965, AMENDMENT BYLAW NO. 36, 1992.

2. Bylaw No. 9310 is amended by adding thereto, immediately after section 3, the following:

"4. The Comprehensive Development Plan entitled "B.C. TEL MOBILITY SKYSIGN" prepared by IMPERIAL SIGN LTD. and on file in the office of the Director Planning and Building Inspection, is deemed to be attached to and form part of this Bylaw and any development on the lands rezoned by this Bylaw shall be in conformity with the said Comprehensive Development Plan."

Read a first time this	10th	day of	AUGUST	1992
Read a second time this	8th	day of	SEPTEMBER	1992
Read a third time this	28th	day of	SEPTEMBER	1992
Reconsidered and adopted this	5th	day of	OCTOBER	1992

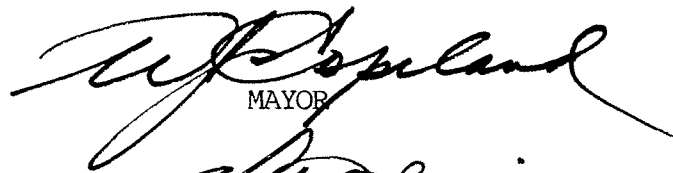

MAYOR

CLERK

BYLAW NUMBER 9775 BEING A BYLAW TO AMEND RZ #31/92
 BYLAW NUMBER 4742 BEING THE BURNABY ZONING BYLAW 1965

PROPERTY REZONED TO: "AMENDED" CD COMPREHENSIVE DEVELOPMENT DISTRICT (BASED ON M5 MANUFACTURING DISTRICT GUIDELINES AND IN ACCORDANCE WITH THE DEVELOPMENT PLAN ENTITLED "BC TEL MOBILITY SKYSIGN" PREPARED BY IMPERIAL SIGN LTD.)

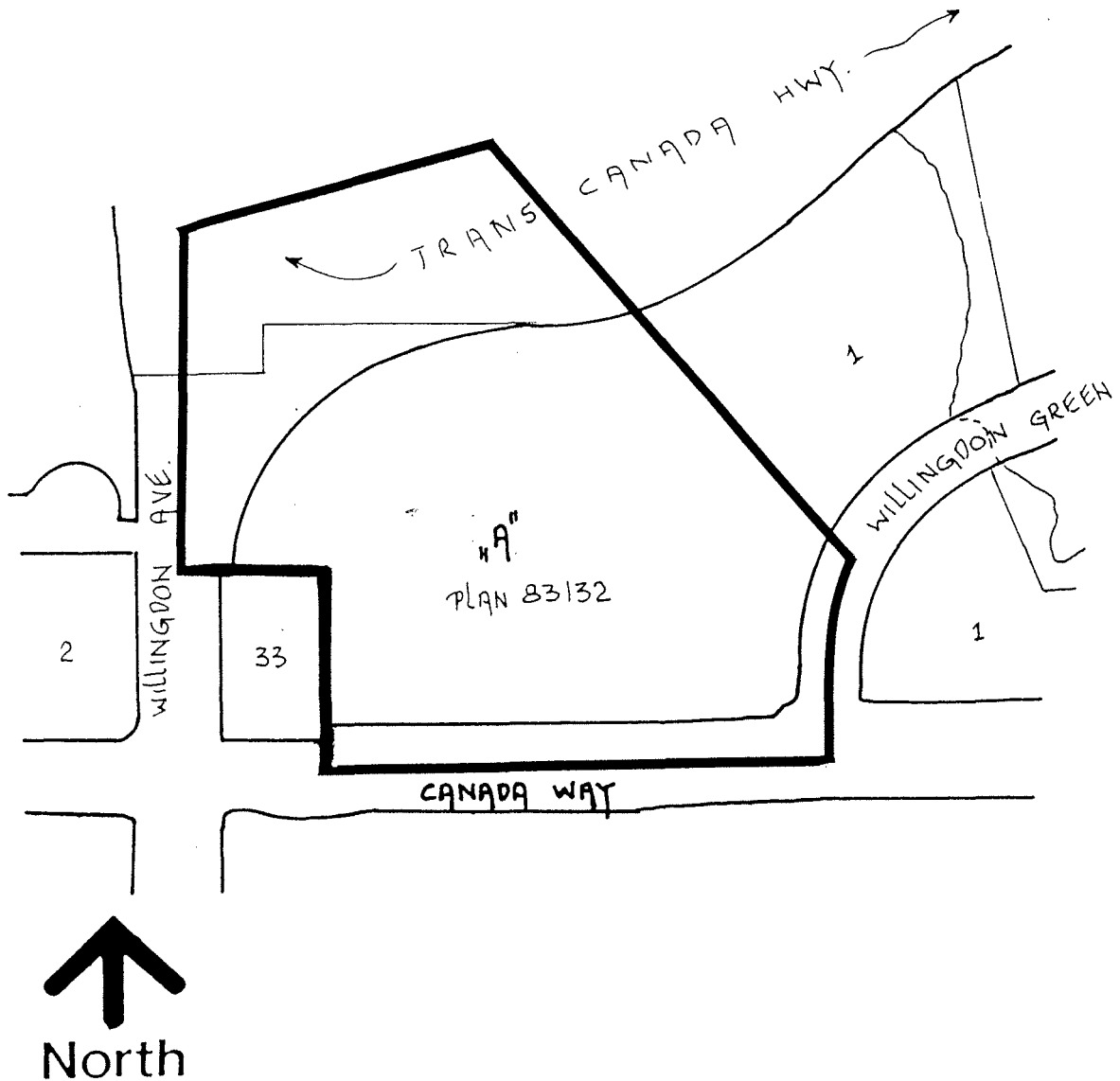
LEGAL: LOT A EX. PART ROAD ON PLAN 86632, D.L. 70, GROUP 1, PLAN 83132



THE AREA(S) SHOWN ABOVE
 OUTLINED IN BLACK (—)
 IS (ARE) REZONED:

FROM: CD COMPREHENSIVE DEVELOPMENT DISTRICT (BASED ON M5 MANUFACTURING DISTRICT GUIDELINES)

TO: "AMENDED" CD COMPREHENSIVE DEVELOPMENT DISTRICT (BASED ON M5 MANUFACTURING DISTRICT GUIDELINES AND IN ACCORDANCE WITH THE DEVELOPMENT PLAN ENTITLED "BC TEL MOBILITY SKYSIGN" PREPARED BY IMPERIAL SIGN LTD.)

PLANNING DEPARTMENT	THE CORPORATION OF THE DISTRICT OF BURNABY	
SCALE	N.1:5.	OFFICIAL ZONING MAP
DRAWN	J.P.C.	
DATE	AUGUST 1992	
		No. RZ 1938