

THE CORPORATION OF THE DISTRICT OF BURNABY

BYLAW NO. 9657

A BYLAW to amend Bylaw No. 8957, being
Burnaby Zoning Bylaw 1965,
Amendment Bylaw No. 14, 1988

WHEREAS application for rezoning has been made to the Council.

AND WHEREAS the Council has held a public hearing thereon after duly giving notice of the hearing as prescribed by Sections 956 and 957 of the Municipal Act R.S.B.C. 1979.

NOW THEREFORE the Council of The Corporation of the District of Burnaby ENACTS as follows:

1. This Bylaw may be cited as BURNABY ZONING BYLAW 1965, AMENDMENT BYLAW NO. 49, 1991.
2. Bylaw No. 8957 is amended by repealing section 3 and substituting therefor the following:

"3. The Comprehensive Development Plan entitled CARIBOO HEIGHTS HOUSING CO-OP prepared by GOMBEROFF POLICZER ARCHITECTS and on file in the office of the Director Planning and Building Inspection, is deemed to be attached to and form part of this Bylaw and any development on the lands rezoned by this Bylaw shall be in conformity with the said Comprehensive Development Plan."

Read a first time this	7th	day of	OCTOBER	1991
Read a second time this	4th	day of	NOVEMBER	1991
Read a third time this	13th	day of	JULY	1992
Reconsidered and adopted this	10th	day of	AUGUST	1992

MAYOR

CLERK

BYLAW NUMBER 9657 BEING A BYLAW TO AMEND RZ #16/91
 BYLAW NUMBER 4742 BEING THE BURNABY ZONING BYLAW 1965

PROPERTY REZONED TO:

MAP B

"AMENDED" CD COMPREHENSIVE DEVELOPMENT DISTRICT (BASED ON CARIBOO HEIGHTS COMMUNITY PLAN GUIDELINES AND RM1 MULTIPLE FAMILY RESIDENTIAL DISTRICT GUIDELINES AND IN ACCORDANCE WITH THE DEVELOPMENT PLAN ENTITLED "CARIBOO HEIGHTS HOUSING CO-OP" PREPARED BY GOMBEROFF POLICZER ARCHITECTS)

LEGAL: PTN. OF LOT 3, D.L. 13 AND 14, PLAN 68061; PTN OF LOT 2, EXC. PART ON STATUTORY RIGHT-OF-WAY PLAN 26009, OF LOT 5, BLOCK 2, D.L. 14, PLAN 3047; PTN. OF LOT 4, EXC. PART ON STATUTORY RIGHT-OF-WAY PLAN 26009, BLOCK 2, D.L. 14, PLAN 3047; PTN. OF BLK. 37 EXC. PARTS SUBDIVIDED BY PLAN 4375, EXPL. PLAN 9242 AND EXPL. PLAN 13199, D.L. 13, PLAN 3046

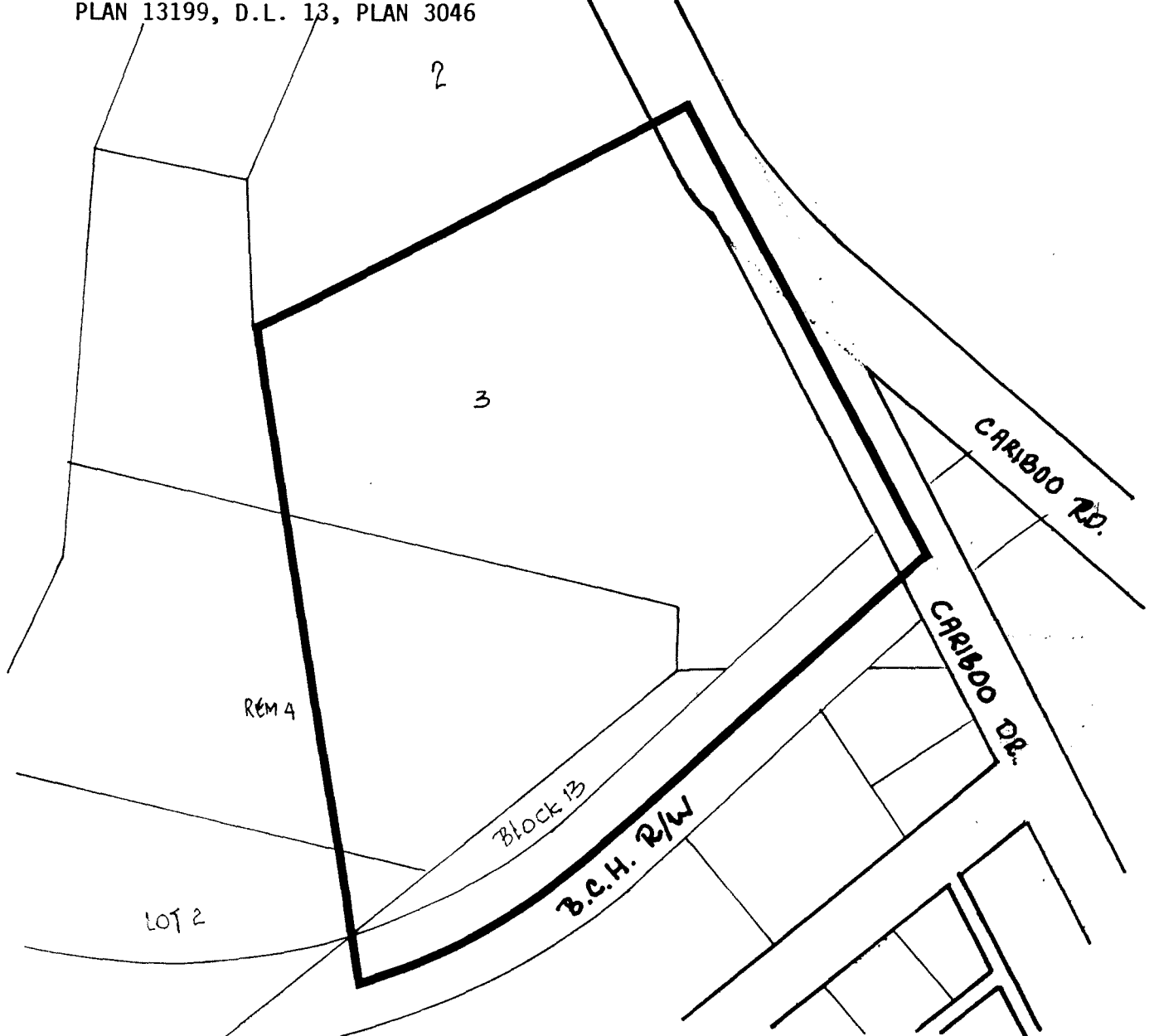

THE AREA(S) SHOWN ABOVE
 OUTLINED IN BLACK (—)
 IS (ARE) REZONED:

FROM: CD COMPREHENSIVE DEVELOPMENT DISTRICT
 (BASED ON CARIBOO HEIGHTS COMMUNITY PLAN GUIDELINES)
 TO: "AMENDED" CD COMPREHENSIVE DEVELOPMENT DISTRICT
 (BASED ON CARIBOO HEIGHTS COMMUNITY PLAN GUIDELINES
 AND RM1 DISTRICT GUIDELINES, AND IN ACCORDANCE
 WITH THE DEVELOPMENT PLAN ENTITLED "CARIBOO HEIGHTS
 HOUSING CO-OP" PREPARED BY GOMBEROFF POLICZER
 ARCHITECTS)

PLANNING DEPARTMENT	
SCALE	1:2000
DRAWN	J.P.C.
DATE	SEPTEMBER 1991

THE CORPORATION OF THE DISTRICT OF BURNABY

OFFICIAL ZONING MAP

No. RZ 1900